

04-337662

File

6/27/78. P.C.C.  
C.B.V.

~~6/27/78~~  
6/27/78  
6/30/78

# PERMIT

P 28241  
A 23871

SEWAGE DISPOSAL SYSTEM

MARYLAND STATE DEPARTMENT OF HEALTH\*

HOWARD COUNTY

ELLICOTT CITY

## INDEXED

DISTRICT 4th

DATE 6/22/78

Mitchell - Wiley IS PERMITTED TO INSTALL X ALTER

ADDRESS \_\_\_\_\_ PHONE \_\_\_\_\_

SUBDIVISION Brantly ROAD 3369 Brantly Road LOT 22

PROPERTY OWNER Brantly Associates

ADDRESS \_\_\_\_\_

SPECIFICATIONS 4 bedrooms

SEPTIC TANK CAPACITY 1250 GALLONS

DRAIN FIELD \_\_\_\_\_ DEPTH \_\_\_\_\_ FEET, BOTTOM AREA \_\_\_\_\_ SQ. FT.

DEEP TRENCH \_\_\_\_\_ DEPTH \_\_\_\_\_ FEET, BOTTOM AREA \_\_\_\_\_ SQ. FT.

SEEPAGE PITS \_\_\_\_\_ ABSORBENT SIDE-WALL AREA 145 SQ. FT. per bedroom

INLET PIPE 3 1/2 FT. BELOW ORIGINAL GRADE. MAXIMUM DEPTH 10 FT. BELOW ORIGINAL GRADE

EFFECTIVE DEPTH AT \_\_\_\_\_ FT. BELOW ORIGINAL GRADE.

LOCATE DISPOSAL AREA 15 FT. FROM 200' LOT LINE AND 90 FT. FROM 100' LOT LINE AS SEEN WHEN FACING LOT FROM

TRENCH-begin the trench 5 ft. from the edge of the dry well and follow the contour of the land. The trench will be 2 ft. wide, 10 ft. deep, and contain 6 1/2 ft. of stone.

PLANS APPROVED BY Moorefield DATE 8/22/77

COVER NO WORK UNTIL INSPECTED AND APPROVED.

NEITHER THE HOWARD COUNTY COUNCIL NOR THE HEALTH DEPARTMENT IS RESPONSIBLE FOR THE SUCCESSFUL OPERATION OF ANY SYSTEM.

NOTE: IF TRENCH IS USED CALL FOR INSPECTION BEFORE PLACING GRAVEL IN TRENCH.

NOTE: NO DRY WELL SHALL EXCEED 15 FOOT IN DIAMETER.

NOTE: ALL PIPE FROM HOUSE TO DISPOSAL AREA MUST BE CAST IRON.

PERMIT VOID AFTER THREE YEARS.

NOTE: INSTALL STAND PIPE ON SEPTIC TANK AND DRY WELL. STAND PIPES MUST BE 6 INCHES IN DIAMETER. CAST IRON, CONCRETE OR TERRAZO ACCEPTED.

**\*INSTALLER IS RESPONSIBLE FOR OBTAINING FINAL APPROVAL ON THIS PERMIT.**

A 23871

A23871

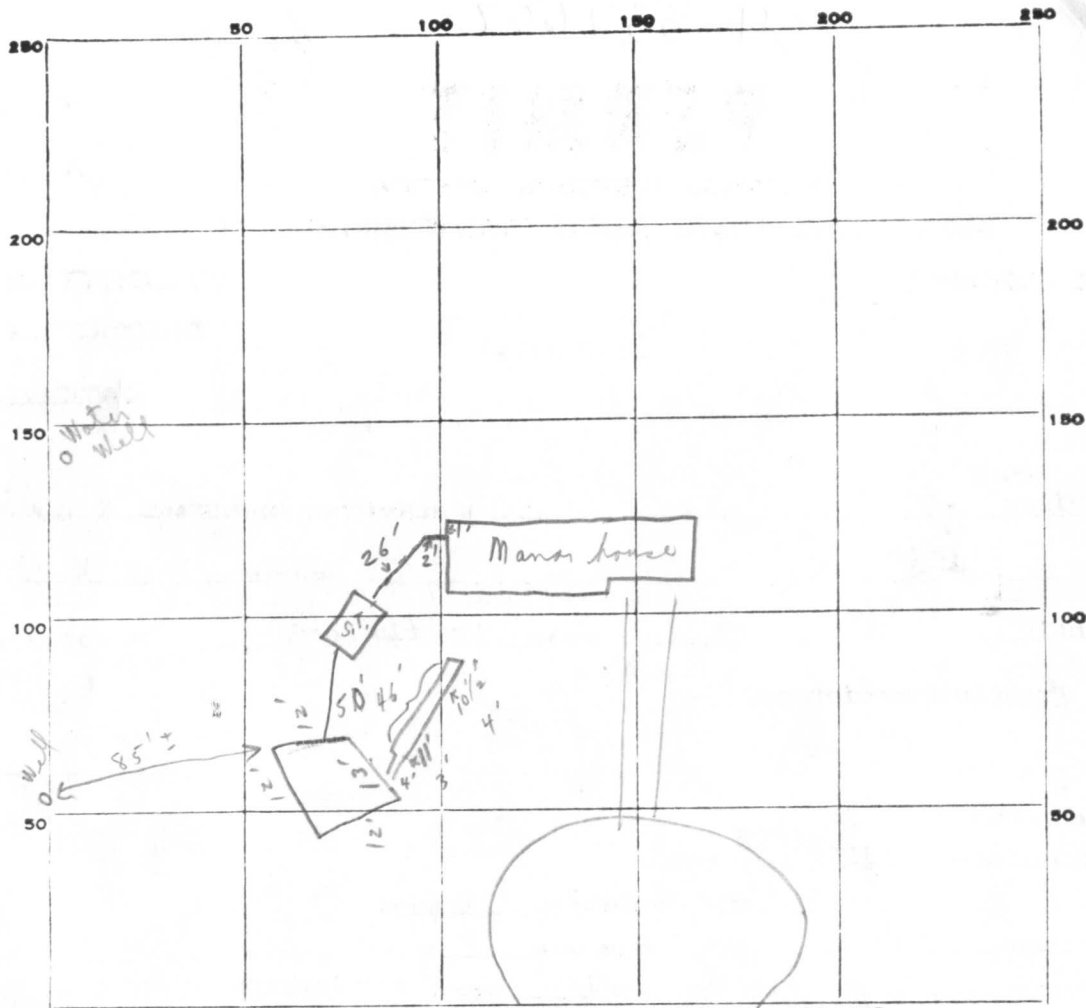

INDICATE NORTH. - NAME ADJOINING ROADWAY AS BASE LINE.

PERMIT CARD Yes by dry well  
 SEPTIC TANK, LEVEL ok CLEANOUTS 

S.T.	D.W.
① No	① No

  
 DISTRIBUTION BOX, LEVEL N/A

Trench  
 THE FIELD, DEPTH 10' + FT. TRENCH WIDTH - FT.

GRAVEL DEPTH 6.5 +' IN. TOTAL LENGTH 46 FT.  
 NUMBER OF TRENCHES 1 TOTAL BOTTOM AREA -

SEEPAGE PITS, INSIDE DIAMETER outside perimeter 49 FT. DEPTH BELOW INLET 6.5 FT. (2)

ABSORBENT AREA 6.17 ± SQ. FT.

REMARKS 6/27/78 ① Trench only ok for stone. 6/30/78 C.I. pipe all the way to dry well.  
 C.B.S

DATE SYSTEM APPROVED 6/30/78 as per above INSPECTOR C.B. & [Signature]

# APPLICATION

A 23871

SEWAGE DISPOSAL TESTING

P \_\_\_\_\_

STATE OF MARYLAND - DEPARTMENT OF HEALTH AND MENTAL HYGIENE

HOWARD COUNTY HEALTH DEPARTMENT  
ENVIRONMENTAL HEALTH SERVICES  
P. O. BOX 476, ELLICOTT CITY, MARYLAND 21043  
TELEPHONE: 465-5000, EXT. 356

DISTRICT Fourth

DATE Aug. 17, 1976

TO: THE COUNTY HEALTH OFFICER  
ELLICOTT CITY, MARYLAND

I, HEREBY, APPLY FOR THE NECESSARY TEST IN ORDER TO CONSTRUCT (OR RECONSTRUCT) A SEWAGE DISPOSAL SYSTEM.

PROPERTY OWNER Brantly Associates  
c/o H. F. Cole & Company, Inc.  
ADDRESS 218 Teachers Building PHONE 730-0810  
Columbia, Md. 21044

PROPERTY LOCATION:

SUBDIVISION Brantly LOT NO. 21

ROAD AND DESCRIPTION Road "A" (cul-de-sac joining Brantly Rd)

SIZE OF LOT 45,000 s.f. TYPE BLDG. 3 or 4 bedroom  
NUMBER OF BEDROOMS

IF NOT SINGLE RESIDENCE DESCRIBE \_\_\_\_\_

THE SYSTEM INSTALLED UNDER THIS APPLICATION IS ACCEPTABLE ONLY UNTIL PUBLIC FACILITIES BECOME AVAILABLE.

SIGNATURE OF APPLICANT /s/ Hugh Cole

APPROVED BY \_\_\_\_\_ FOR \_\_\_\_\_ DATE \_\_\_\_\_  
(KIND OF SYSTEM)

REJECTED BY \_\_\_\_\_ FOR \_\_\_\_\_ DATE \_\_\_\_\_  
(KIND OF SYSTEM)

HOLD PENDING FURTHER TESTS \_\_\_\_\_ DATE \_\_\_\_\_

REASONS FOR REJECTION OR HOLDING \_\_\_\_\_

# THIS IS NOT A PERMIT

A23871

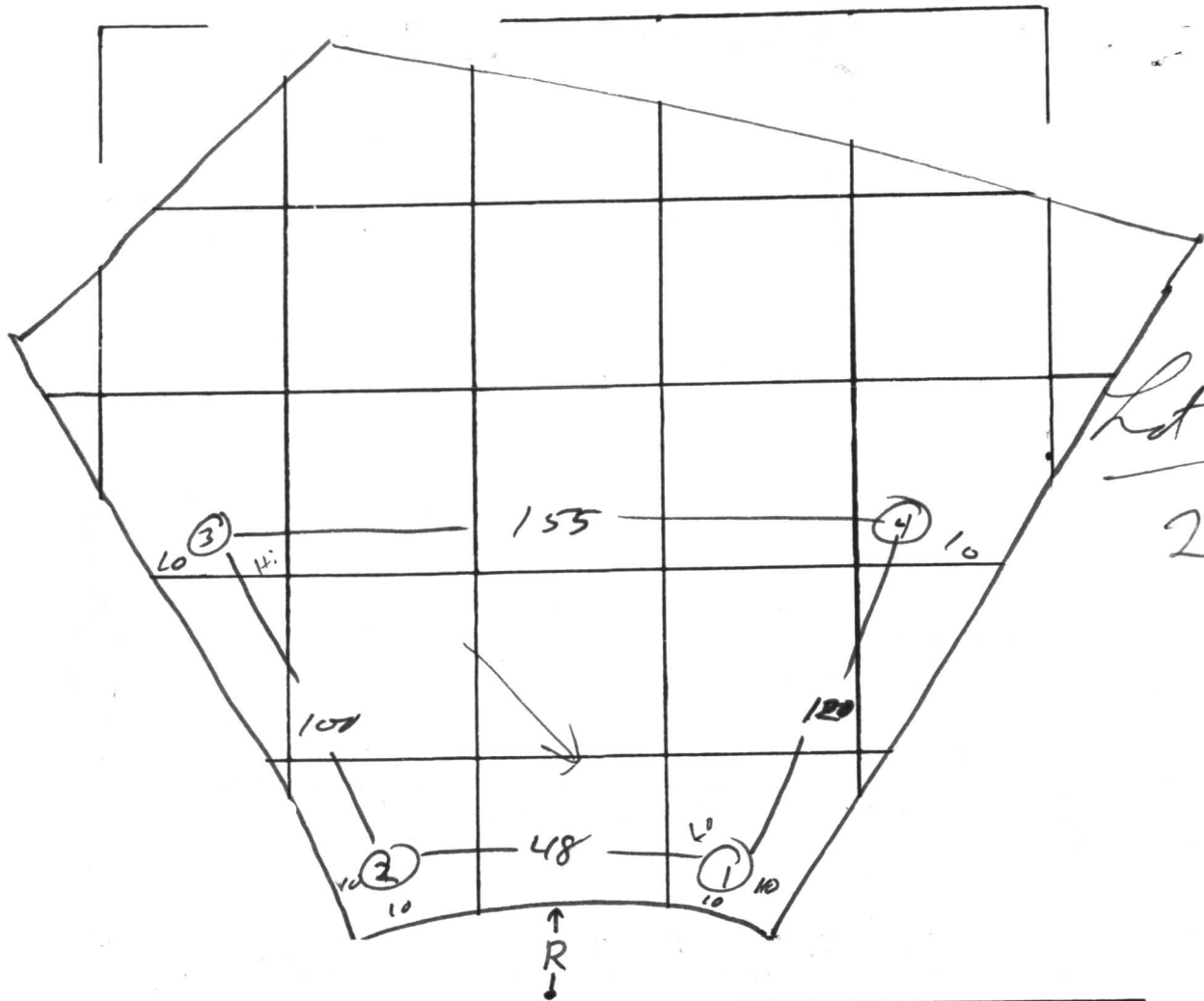

DATE	TEST NO.	DEPTH	PRE-WET		TEST - 1" DROP		TIME
			START	STOP	START	STOP	
10/19/76	1	4	11 <sup>30</sup>	11 <sup>37</sup>	11 <sup>37</sup>	11 <sup>43</sup>	6
	1A	14	11 <sup>30</sup>	11 <sup>35</sup>	11 <sup>35</sup>	11 <sup>40</sup>	5
	2	4½	11 <sup>32</sup>	11 <sup>35</sup>	11 <sup>35</sup>	11 <sup>47</sup>	12
	2A	14	11 <sup>35</sup>	11 <sup>55</sup>	11 <sup>55</sup>	12 <sup>15</sup>	20
	3	3½	11 <sup>44</sup>	11 <sup>52</sup>	11 <sup>52</sup>	11 <sup>56</sup>	4
	3A	14	11 <sup>44</sup>	11 <sup>52</sup>	11 <sup>52</sup>	12 <sup>07</sup>	11
	4	14	vis		same		

REMARKS \_\_\_\_\_

TYPE OF SOIL \_\_\_\_\_

TESTED BY R.M. ALSO PRESENT: Brittingham

C 1 **4369** SEQUENCE NO. (WRA USE ONLY)

1 2 3 (SEQ. NO.) 6  
 (THIS NUMBER IS TO BE PUNCHED IN COLS. 3 & 6 ON ALL CARDS)

**STATE OF MARYLAND**  
**WATER RESOURCES ADMINISTRATION**  
 TAWES STATE OFFICE BLDG., ANNAPOLIS, MD. 21401  
**WELL COMPLETION REPORT**

THIS REPORT MUST BE SUBMITTED WITHIN 30 DAYS AFTER WELL COMPLETION

FILL IN THIS FORM COMPLETELY

COUNTY NUMBER **A23871**

DATE RECEIVED (WRA USE ONLY)

DATE WELL COMPLETED March 8, 78

DEPTH OF WELL 225

22 (TO NEAREST FOOT) 26

PERMIT NO. FROM "PERMIT TO DRILL WELL"  
**40-73-2589**

28 29 30 31 32 33 34 35 36 37

DRILLERS IDENTIFICATION NO. 235

OWNER Brandy Associates LAST NAME FIRST NAME

STREET OR RFD 2181 Lochmeade Road POST OFFICE Beltsville 208

**WELL LOG**

STATE THE KIND OF FORMATIONS PENETRATED, THEIR COLOR, DEPTH, THICKNESS AND IF WATER BEARING

DESCRIPTION (USE ADDITIONAL SHEETS IF NECESSARY)	FEET		CHECK IF WATER BEARING
	FROM	TO	
<u>Bear Shale</u>	<u>52</u>	<u>53</u>	
<u>gray granite</u>	<u>53</u>	<u>225</u>	

**GROUTING RECORD**

WELL HAS BEEN GROUTED (CIRCLE APPROPRIATE BOX) YES  NO

TYPE OF GROUTING MATERIAL (CIRCLE BOX):  
 CEMENT  BENTONITE CLAY

NO. OF BAGS 15 NO. OF POUNDS 1414

GALLONS OF WATER 90

DEPTH OF GROUT SEAL (TO NEAREST FOOT)  
 FROM 0 FT. TO 57 FT.  
 (ENTER 0 IF FROM SURFACE)

**CASING RECORD**

INSERT APPROPRIATE CODE BELOW

STEEL  CONCRETE   
 PLASTIC  OTHER

MAIN CASING TYPE 52 NOMINAL DIAMETER TOP (MAIN) CASING (NEAREST INCH) 6 TOTAL DEPTH OF MAIN CASING (NEAREST FOOT) 53

**OTHER CASING (IF USED)**

DIAMETER (INCH)	DEPTH (FEET) FROM	TO
<u>60</u>	<u>61</u>	<u>63</u>
<u>61</u>	<u>63</u>	<u>64</u>
<u>63</u>	<u>64</u>	<u>66</u>
<u>64</u>	<u>66</u>	<u>70</u>

**SCREEN RECORD**

INSERT APPROPRIATE CODE BELOW

STEEL  BRASS OR BRONZE  OPEN HOLE   
 PLASTIC  OTHER

**DEPTH (NEAREST WHOLE FOOT)**

FROM	TO
<u>8</u>	<u>21</u>
<u>23</u>	<u>36</u>
<u>38</u>	<u>51</u>

SLOT SIZE 1,     2,     3,    

DIAMETER OF SCREEN 56 (NEAREST INCH) FROM     TO    

GRAVEL PACK    

IF WELL DRILLED WAS A FLOWING WELL CIRCLE BOX

WRA USE ONLY (NOT TO BE FILLED IN BY DRILLER)

T  (E.R.O.S.) W  Q

70  72  74 75 76

TELESCOPE CASING LOG INDICATOR OTHER DATA AVAILABLE

**PUMPING TEST**

HOURS PUMPED (TO NEAREST HOUR) 2

PUMPING RATE (GALLONS PER MINUTE TO NEAREST GALLON) 10

METHOD USED TO MEASURE PUMPING RATE    

WATER LEVEL: (DISTANCE FROM LAND SURFACE)  
 BEFORE PUMPING 35 (NEAREST FOOT)  
 WHEN PUMPING 5 (NEAREST FOOT)

TYPE OF PUMPED USED (CIRCLE APPROPRIATE BOX) (FOR PUMPING TEST)  
 AIR  PISTON  TURBINE  
 CENTRIFUGAL  ROTARY  OTHER (DESCRIBE BELOW)  
 JET  SUBMERSIBLE

**PUMP INSTALLED**

TYPE OF PUMP (WRITE APPROPRIATE LETTER IN BOX - SEE ABOVE: A, C, J, P, R, S, T, O) 29

DRILLER WILL INSTALL PUMP (CIRCLE APPROPRIATE BOX) YES  NO

CAPACITY:  
 GALLONS PER MINUTE (TO NEAREST GALLON) 31 35  
 PUMP HORSE POWER 37 41  
 PUMP COLUMN LENGTH (NEAREST FOOT) 43 47

**CASING HEIGHT** (CIRCLE APPROPRIATE BOX AND ENTER CASING HEIGHT)

ABOVE } LAND SURFACE (NEAREST FOOT)  
 BELOW } 2

**LOCATION OF WELL ON LOT**

SHOW PERMANENT STRUCTURE SUCH AS BUILDINGS, SEPTIC TANKS, AND/OR OTHER LAND MARKS AND INDICATE NOT LESS THAN TWO DISTANCES (MEASUREMENTS TO WELL).

left lot line  
40ft  
well  
30ft  
back lot line

**CIRCLE APPROPRIATE BOXES**

A WELL WAS ABANDONED AND SEALED WHEN THIS WELL WAS COMPLETED

E ELECTRIC LOG OBTAINED

P TEST WELL CONVERTED TO PRODUCTION WELL

I HEREBY CERTIFY THAT I HAVE COMPLIED WITH ALL CONDITIONS STATED ON THE ABOVE-CAPTIONED "PERMIT TO DRILL WELL", AND THAT INFORMATION CONTAINED IN THIS REPORT IS TRUE, ACCURATE, AND COMPLETE TO THE BEST OF MY KNOWLEDGE, INFORMATION AND BELIEF.

DRILLERS NAME Joseph Wayne

(PLEASE PRINT) SIGNATURE Joseph Wayne

A23871

3 Act  
8 Act  
6 Act

N76°57'07"E-268.99'

Lot 28  
1,289 Act

Gar. El.  
410.33

MANOR HOUSE  
P.F. 412.17  
B.F. 404.00

Gar. El.  
411.84

Inv. @ Well - 410.66

1,250 Gal. Septic Tank  
Fin. Gr. T./Tank 412.09  
Inv. In 410.50  
Inv. Out 410.17

Trench - Inv. 407.89

Dry Well  
El. @ Perc. Test 411.39  
Top Fin. Gr. 411.30  
Inv. 407.89

N56°00'27"E-100.00'

S29°19'28"E-194.74'

APP 4-26-78  
*[Signature]*

SEE SHEET 2 OF 3

