

PERMIT

SEWAGE DISPOSAL SYSTEM

MARYLAND STATE DEPARTMENT OF HEALTH

HOWARD COUNTY

ELLICOTT CITY

DISTRICT 2nd

DATE 5/24/77

P 25934

A 23576

INDEXED

Paul Anderson

IS PERMITTED TO INSTALL X ALTER

ADDRESS 10382 Baloo. Nat'l Pike, Ellicott City, Md.

PHONE 465-6425

A SEWAGE DISPOSAL-SYSTEM LOCATED AT

SUBDIVISION

ROAD

off Route 40

LOT

PROPERTY OWNER Richard E. & Doris Jean Barth

ADDRESS same as above

SPECIFICATIONS 3 bedrooms

DRAIN FIELD DEPTH FEET, BOTTOM AREA SQ. FT.

SEEPAGE PITS ABSORBENT SIDE-WALL AREA SQ. FT.

SEPTIC TANK CAPACITY 1000 GALLONS

FOR GARBAGE GRINDER, INCREASE DISPOSAL AREA 22% & TANK CAPACITY 50%.

OTHER DRY WELL-300 sq. feet of absorbent sidewall area to begin 5 feet below original grade. Maximum depth permitted for dry well is 11 feet below original grade. Come off dry well 5 feet (earth buffer solid) trench to be 2 feet wide, 50 feet long, 11 feet deep with 6 feet gravel under pipe. Trench to follow contour of ground. Dry Well to be 170 feet from rear lot line and 36 feet from right side as seen when facing from Route 40. CALL FOR INSPECTION OF TRENCH BEFORE GRAVEL IS INSTALLED.

NOTE: ALL PIPE FROM HOUSE TO DISPOSAL AREA MUST BE CAST IRON. PERMIT VOID AFTER 3 YEARS.

NOTE: INSTALL STAND PIPES ON SEPTIC TANK AND DRY WELL. STAND PIPES MUST BE 6 INCHES IN DIAMETER. CAST IRON, CONCRETE OR TERRA COTTA ACCEPTED.

PLANS APPROVED BY David J. O'Neill

DATE 9/15/76

FILL SEPTIC TANK AND DISTRIBUTION BOX WITH WATER BEFORE CALLING FOR AN INSPECTION. COVER NO WORK UNTIL INSPECTED AND APPROVED.

NEITHER THE HOWARD COUNTY COMMISSIONERS NOR THE HEALTH DEPARTMENT IS RESPONSIBLE FOR THE SUCCESSFUL OPERATION OF ANY SYSTEM.

A 23576

Recall 6/6/77 to see if connected to town  
5/20/77 after 10:00 A.M.  
5/27/77

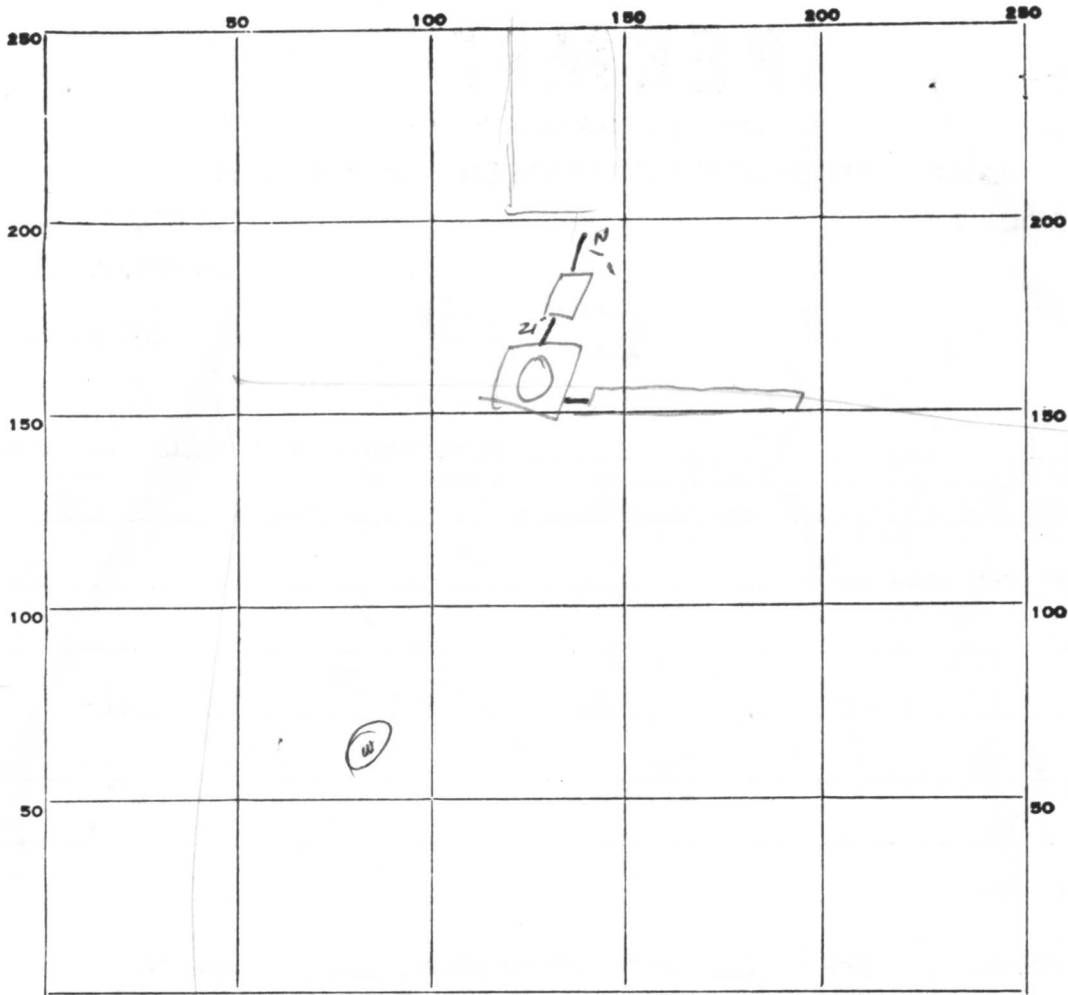

INDICATE NORTH. - NAME ADJOINING ROADWAY AS BASE LINE.

DW  
 17' eff  
 170 1/2'  
 13 1/2  
 13 1/2  
 15  
 15  
 ---  
 55 X  
 10  
 3/8

PERMIT CARD NO

SEPTIC TANK, LEVEL

CLEANOUTS NO 1 NO

DISTRIBUTION BOX, LEVEL \_\_\_\_\_

TILE FIELD, DEPTH 11-12 FT. TRENCH WIDTH 2 FT.

GRAVEL DEPTH 2-8' IN. TOTAL LENGTH 50 FT.

TR: 350  $\phi$

NUMBER OF TRENCHES 1 TOTAL BOTTOM AREA 200

DW 47

SEEPAGE PITS, INSIDE DIAMETER 49' FT. DEPTH BELOW INLET 2' FT.

ABSORBENT AREA 679 SQ. FT.

$\frac{329 \phi}{+TR 350}$   
 679

REMARKS Needs pipe + cleanouts 0704 5/25/76

Location OK  
27 May 77 - install cleanouts & connect to base Rtn.

DATE SYSTEM APPROVED 22 June 77 INSPECTOR Morales

C 1 **4023** SEQUENCE NO. (WRA USE ONLY)

1 2 3 (SEQ. NO.) 6  
 (THIS NUMBER IS TO BE PUNCHED IN COLS. 3-6 ON ALL CARDS)

**STATE OF MARYLAND**  
**WATER RESOURCES ADMINISTRATION**  
 TAWES STATE OFFICE BLDG., ANNAPOLIS, MD. 21401  
**WELL COMPLETION REPORT**

THIS REPORT MUST BE SUBMITTED WITHIN 30 DAYS AFTER WELL COMPLETION

FILL IN THIS FORM COMPLETELY

COUNTY NUMBER **23576**

DATE RECEIVED (WRA USE ONLY) \_\_\_\_\_

DATE WELL COMPLETED **4-20-91**

DEPTH OF WELL **180** (TO NEAREST FOOT)

PERMIT NO. FROM "PERMIT TO DRILL WELL"  
**40-73-1986**

DRILLERS IDENTIFICATION NO. **42**

OWNER: **Barth Richard** LAST NAME FIRST NAME  
 STREET OR RFD: **PINE ORCHARD** POST OFFICE: **ELICOTT CITY MD.**

**WELL DESCRIPTION**

WELL LOG  
 STATE THE KIND OF FORMATIONS PENETRATED, THEIR COLOR, DEPTH, THICKNESS AND IF WATER BEARING

DESCRIPTION (USE ADDITIONAL SHEETS IF NECESSARY)	FEET		CHECK IF WATER BEARING
	FROM	TO	
Top Soil	0	2	
SHALEY	2	8	
SHALE	8	35	
BROWN SLATE	35	40	
BLUE SLATE	40	180	

OK AS 4-20-91

**GROUTING RECORD**

WELL HAS BEEN GROUTED (CIRCLE APPROPRIATE BOX)  YES  NO

TYPE OF GROUTING MATERIAL (CIRCLE BOX):  
 CEMENT  BENTONITE CLAY

NO. OF BAGS **7** NO. OF POUNDS **70**

GALLONS OF WATER **36**

DEPTH OF GROUT SEAL (TO NEAREST FOOT) **30**

**CASING RECORD**

CASING TYPES:  STEEL  CONCRETE  PLASTIC  OTHER

MAIN CASING TYPE **ST** NOMINAL DIAMETER TOP (MAIN) CASING (NEAREST INCH) **6** TOTAL DEPTH OF MAIN CASING (NEAREST FOOT) **41**

OTHER CASING (IF USED)

DIAMETER (INCH)	DEPTH (FEET) FROM	TO

**SCREEN RECORD**

SCREEN TYPE OR OPEN HOLE:  STEEL  BRASS OR BRONZE  OPEN HOLE  PLASTIC  OTHER

DEPTH (NEAREST WHOLE FOOT) FROM **38** TO **180**

SLOT SIZE 1, \_\_\_\_\_ 2, \_\_\_\_\_ 3, \_\_\_\_\_

DIAMETER OF SCREEN **56** (NEAREST INCH) FROM \_\_\_\_\_ TO \_\_\_\_\_

GRAVEL PACK \_\_\_\_\_

IF WELL DRILLED WAS A FLOWING WELL CIRCLE BOX  **68 F**

WRA USE ONLY (NOT TO BE FILLED IN BY DRILLER)

TELESCOPE CASING  LOG INDICATOR  OTHER DATA AVAILABLE

**PUMPING TEST**

HOURS PUMPED (TO NEAREST HOUR) **2**

PUMPING RATE (GALLONS PER MINUTE TO NEAREST GALLON) **4**

METHOD USED TO MEASURE PUMPING RATE **BUCKET**

WATER LEVEL: (DISTANCE FROM LAND SURFACE)  
 BEFORE PUMPING **40** (NEAREST FOOT)  
 WHEN PUMPING **180** (NEAREST FOOT)

TYPE OF PUMPED USED (CIRCLE APPROPRIATE BOX) (FOR PUMPING TEST)  
 AIR  PISTON  TURBINE  
 CENTRIFUGAL  ROTARY  OTHER (DESCRIBE BELOW)  
 JET  SUBMERSIBLE

**PUMP INSTALLED**

TYPE OF PUMP (WRITE APPROPRIATE LETTER IN BOX - SEE ABOVE: A, C, J, P, R, S, T, O) \_\_\_\_\_

DRILLER WILL INSTALL PUMP (CIRCLE APPROPRIATE BOX)  YES  NO

CAPACITY:  
 GALLONS PER MINUTE (TO NEAREST GALLON) \_\_\_\_\_  
 PUMP HORSE POWER \_\_\_\_\_  
 PUMP COLUMN LENGTH (NEAREST FOOT) \_\_\_\_\_

CASING HEIGHT (CIRCLE APPROPRIATE BOX AND ENTER CASING HEIGHT)  
 ABOVE LAND SURFACE  BELOW **2** (NEAREST FOOT)

**LOCATION OF WELL ON LOT**

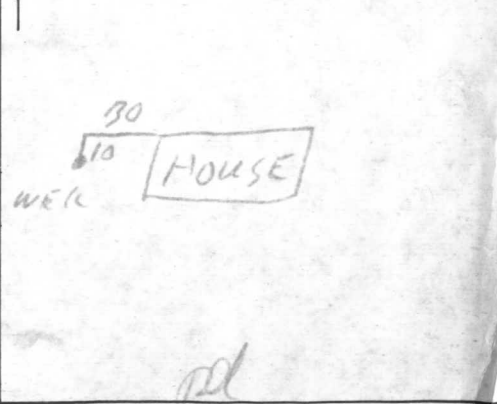

**CIRCLE APPROPRIATE BOXES**

A WELL WAS ABANDONED AND SEALED WHEN THIS WELL WAS COMPLETED

E ELECTRIC LOG OBTAINED

P TEST WELL CONVERTED TO PRODUCTION WELL

I HEREBY CERTIFY THAT I HAVE COMPLIED WITH ALL CONDITIONS STATED ON THE ABOVE-CAPTIONED "PERMIT TO DRILL WELL", AND THAT INFORMATION CONTAINED IN THIS REPORT IS TRUE, ACCURATE, AND COMPLETE TO THE BEST OF MY KNOWLEDGE, INFORMATION AND BELIEF.

DRILLERS NAME \_\_\_\_\_

(PLEASE PRINT) **L F ENSTERMANN**

SIGNATURE \_\_\_\_\_

HOWARD COUNTY  
HEALTH DEPT.

MAY 13 9 34 AM '77

DIVISION OF  
ENVIRONMENTAL  
HEALTH

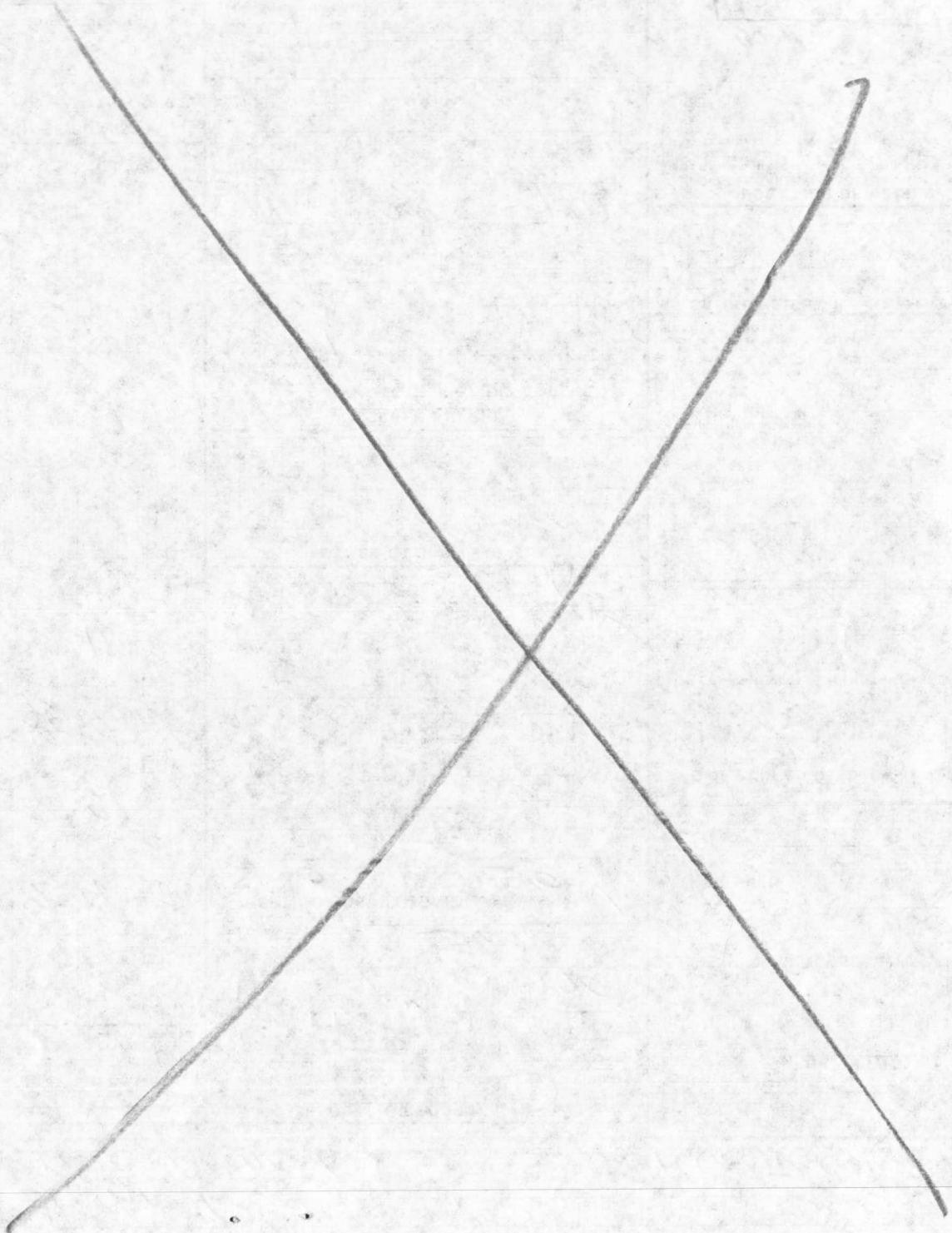

Fill out in triplicate.  
Make \$10.00 check payable:  
Howard County Health Dept. - Sanitation

# APPLICATION

*Boundary plat must be signed by Reg. Engr. or Board Surveyors.*

A 23576

P \_\_\_\_\_

## SEWAGE DISPOSAL TESTING

STATE OF MARYLAND - DEPARTMENT OF HEALTH AND MENTAL HYGIENE

HOWARD COUNTY HEALTH DEPARTMENT  
ENVIRONMENTAL HEALTH SERVICES

DISTRICT 2nd

P. O. BOX 476, ELLICOTT CITY, MARYLAND 21043  
TELEPHONE: 465-5000, EXT. 356

DATE 7/20/76

*dig 4-13' Lined  
10,000 ft.  
8/17/76  
9:30 A.M.*

*Septic Tank 1000 gallons, Drywell to 300 sq ft of absorbent sidewall area to begin 5 ft below original grade.*

*Maximum depth permitted for DW is 11 ft below original grade. Come off DW 5' (earth buffer, solid) trench to be 2' wide, 50' long, 11' deep with 6' gravel under pipe line and 36" from Rt side as seen when facing from Rt 40.*

TO: THE COUNTY HEALTH OFFICER  
ELLICOTT CITY, MARYLAND \*Call for inspection of trench before gravel is added.

I, HEREBY, APPLY FOR THE NECESSARY TEST IN ORDER TO CONSTRUCT (OR RECONSTRUCT) A SEWAGE DISPOSAL SYSTEM.

PROPERTY OWNER Richard E. Barth & Doris Jean Barth

ADDRESS 10382 Baltimore Natl. Pike PHONE 465-6425  
Ellicott City, Md. 21043

PROPERTY LOCATION:  
SUBDIVISION None LOT NO. -

ROAD AND DESCRIPTION Private Road, 20 ft Road, owned by applicant  
Liber CMP #717 Folio 235 off Rt. 40 @ ESSO Station

SIZE OF LOT 60,048 sq. ft. TYPE BLDG. Dwelling - 3 Bed Rm  
NUMBER OF BEDROOMS

IF NOT SINGLE RESIDENCE DESCRIBE \_\_\_\_\_

THE SYSTEM INSTALLED UNDER THIS APPLICATION IS ACCEPTABLE ONLY UNTIL PUBLIC FACILITIES BECOME AVAILABLE.

SIGNATURE OF APPLICANT Richard E Barth BLDG. PERMIT SIGNED AND RETURNED 4/22/77

APPROVED BY RJON (For RAB) FOR DW Trench DATE 9/15/76  
(KIND OF SYSTEM)

REJECTED BY \_\_\_\_\_ FOR \_\_\_\_\_ DATE \_\_\_\_\_  
(KIND OF SYSTEM)

HOLD PENDING FURTHER TESTS \_\_\_\_\_ DATE \_\_\_\_\_

REASONS FOR REJECTION OR HOLDING \_\_\_\_\_

*Baltimore Gas & Electric Co. easement Liber WHH #362 Folio 637*

# THIS IS NOT A PERMIT

A 23576

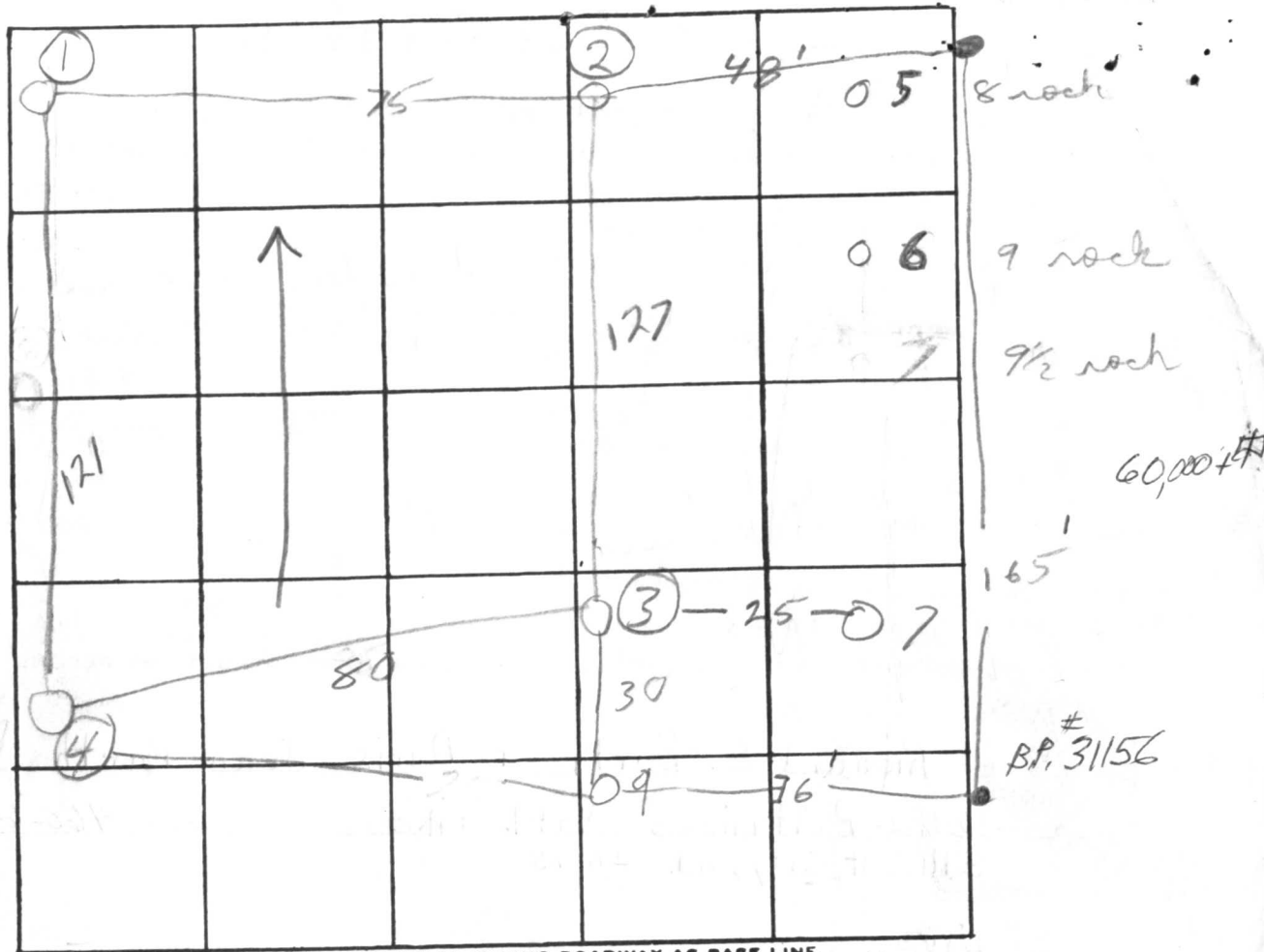

INDICATE NORTH. - NAME ADJOINING ROADWAY AS BASE LINE.

EXXON = RT 40

DATE	TEST NO.	DEPTH	PRE-WET		TEST - 1" DROP		TIME
			START	STOP	START	STOP	
2/17/76	1	5	1037	stop	test	no perk	30 minutes
"	1a	13	1037	1042	1042	1102	20
"	4	4	1044	1048	1048	1053	5
"	4a	13	1046	1047	1047	1101	14
"	3	Visual @	12 ft				
	2	5	1110	1112	1112	1116	4
	2a	13	1110	1115	1115	1124	9
	1 1/2 shelf	5 ft	1113	1115	1115	1121	6
	9	17 ft	Visual				

Clay 0  
4  
Roller Rock  
13  
Clay 4  
Roller Rock

REMARKS \_\_\_\_\_

TYPE OF SOIL \_\_\_\_\_

TESTED BY

R. Riggs + P/04

ALSO PRESENT:

Lyock Personnel