

Approved
GLO
26 June 79

6/26/79
be ready around noon

PERMIT

SEWAGE DISPOSAL SYSTEM

MARYLAND STATE DEPARTMENT OF HEALTH*

HOWARD COUNTY

ELLICOTT CITY

DISTRICT 5th

DATE 6/26/79

INDEXED

P 29950
A Repair

Jack Fyock IS PERMITTED TO INSTALL ALTER X

ADDRESS 13775 Triadelphia Road, Glenelg, Md. PHONE 988-9270

SUBDIVISION _____ ROAD Murphy Road - Route 29 - right on LOT _____

PROPERTY OWNER (?) Route 216 - left on Murphy

ADDRESS Murphy Road, Road - 8th house on left.

SPECIFICATIONS

- SEPTIC TANK CAPACITY _____ GALLONS
- DRAIN FIELD _____ DEPTH _____ FEET, BOTTOM AREA _____ SQ. FT.
- DEEP TRENCH _____ DEPTH _____ FEET, BOTTOM AREA _____ SQ. FT.
- SEEPAGE PITS _____ ABSORBENT SIDE-WALL AREA _____ SQ. FT.
- INLET PIPE _____ FT. BELOW ORIGINAL GRADE. MAXIMUM DEPTH _____ FT. BELOW ORIGINAL GRADE.
- EFFECTIVE DEPTH AT _____ FT. BELOW ORIGINAL GRADE.
- LOCATE DISPOSAL AREA _____ FT. FROM _____ LOT LINE AND _____ FT. FROM _____ LOT LINE AS SEEN WHEN FACING LOT FROM

REPAIR - Call for an appointment when ground is routed up and Sanitarian will recommend repair system.

PLANS APPROVED BY Palmer F. Wine DATE 6/25/79

COVER NO WORK UNTIL INSPECTED AND APPROVED.

NEITHER THE HOWARD COUNTY COUNCIL NOR THE HEALTH DEPARTMENT IS RESPONSIBLE FOR THE SUCCESSFUL OPERATION OF ANY SYSTEM.

- NOTE: IF TRENCH IS USED CALL FOR INSPECTION BEFORE PLACING GRAVEL IN TRENCH.
- NOTE: NO DRY WELL SHALL EXCEED 15 FOOT IN DIAMETER.
- NOTE: ALL PIPE FROM HOUSE TO DISPOSAL AREA MUST BE CAST IRON.
- PERMIT VOID AFTER THREE YEARS.
- NOTE: INSTALL STAND PIPE ON SEPTIC TANK AND DRY WELL. STAND PIPES MUST BE 6 INCHES IN DIAMETER. CAST IRON, CONCRETE OR TERRA COTTA ACCEPTED.

***INSTALLER IS RESPONSIBLE FOR OBTAINING FINAL APPROVAL ON THIS PERMIT.**

P
29950

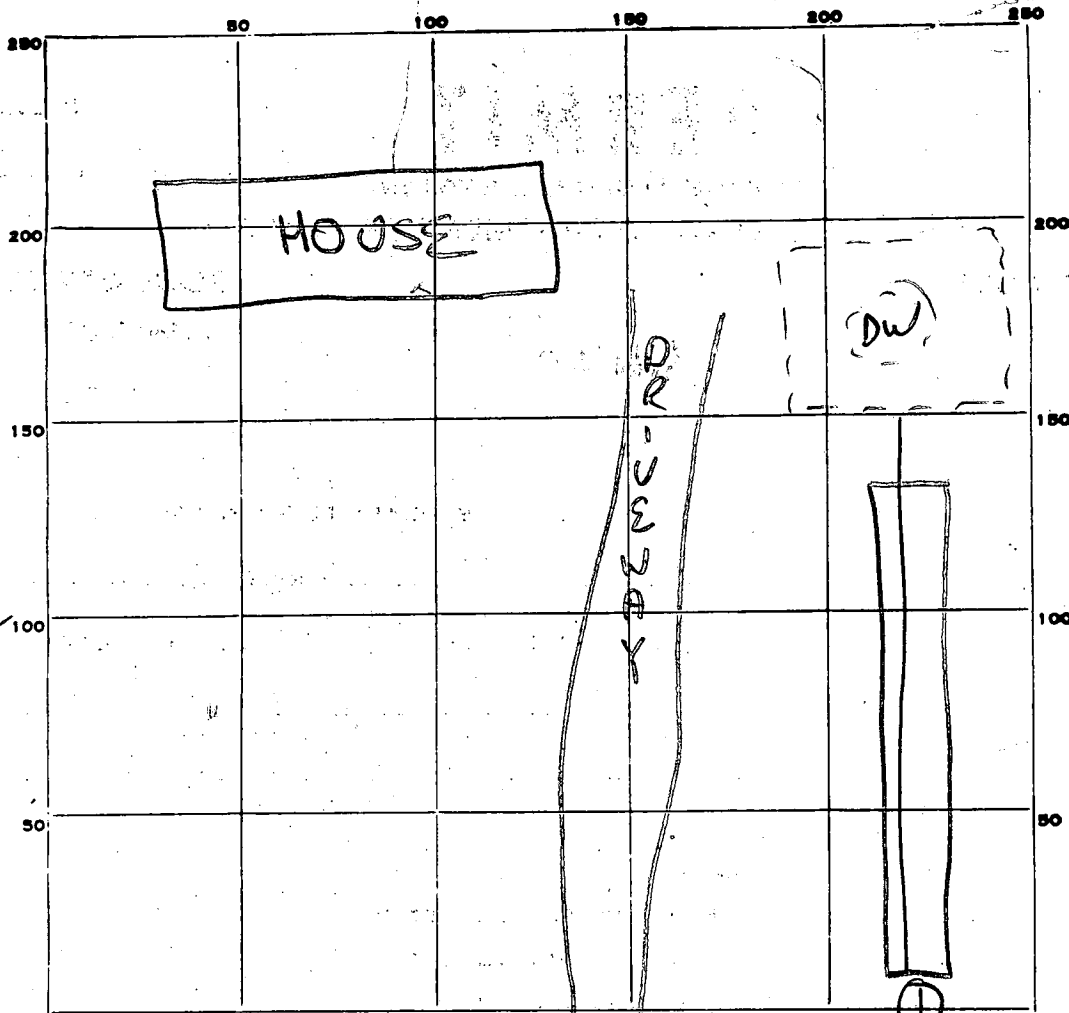

INDICATE NORTH - NAME ADJOINING ROADWAY AS BASE LINE.

MURPHY RD

PERMIT CARD

SEPTIC TANK, LEVEL _____

CLEANOUTS _____

DISTRIBUTION BOX, LEVEL _____

TILE FIELD, DEPTH 10 FT. TRENCH WIDTH 2 FT.

GRAVEL DEPTH 8 FT. TOTAL LENGTH ±65 FT.

NUMBER OF TRENCHES 1 TOTAL BOTTOM AREA ±520

SEEPAGE PITS, INSIDE DIAMETER _____ FT. DEPTH BELOW INLET _____ FT.

ABSORBENT AREA _____ SQ. FT.

REMARKS 26 June 79 - Visual hole ① - 14" DRY
 Trench OK for stone. Trench partially graveled
26 June 79 - Final OK. ①

DATE SYSTEM APPROVED 6/26/79

INSPECTOR G. Keller