

5/29/79

PERMIT

P 29872

A REPAIR

SEWAGE DISPOSAL SYSTEM

MARYLAND STATE DEPARTMENT OF HEALTH*

HOWARD COUNTY

01-157663

ELLICOTT CITY

DISTRICT 2nd 1st

INDEXED

DATE 5/28/79

Mr. Robert Amesbury

IS PERMITTED TO INSTALL ALTER X

ADDRESS 6144 Montgomery Road, Elkridge, Md.

PHONE _____

SUBDIVISION _____ ROAD 6144 Montgomery Road

LOT _____

PROPERTY OWNER Robert Amesbury

ADDRESS same as above

SPECIFICATIONS 3 bedrooms

SEPTIC TANK CAPACITY 1000 GALLONS

DRAIN FIELD _____ DEPTH _____ FEET, BOTTOM AREA _____ SQ. FT.

DEEP TRENCH _____ DEPTH _____ FEET, BOTTOM AREA _____ SQ. FT.

SEEPAGE PITS _____ ABSORBENT SIDE-WALL AREA _____ SQ. FT.

INLET PIPE _____ FT. BELOW ORIGINAL GRADE. MAXIMUM DEPTH _____ FT. BELOW ORIGINAL GRADE

EFFECTIVE DEPTH AT _____ FT. BELOW ORIGINAL GRADE.

LOCATE DISPOSAL AREA _____ FT. FROM _____ LOT LINE AND _____ FT. FROM _____ LOT LINE AS SEEN WHEN

FACING LOT FROM

REPAIR-ADDITION OF A 50 FT. TRENCH.

DIG TWO VISUAL HOLES, 50 TO 100 FT APART
SO THAT SANITARIAN CAN RECOMMEND REPAIR
SYSTEM RH

PLANS APPROVED BY DWM/DJO'N:ds

DATE 5/28/79

COVER NO WORK UNTIL INSPECTED AND APPROVED.

NEITHER THE HOWARD COUNTY COUNCIL NOR THE HEALTH DEPARTMENT IS RESPONSIBLE FOR THE SUCCESSFUL OPERATION OF ANY SYSTEM.

NOTE: IF TRENCH IS USED CALL FOR INSPECTION BEFORE PLACING GRAVEL IN TRENCH.

NOTE: NO DRY WELL SHALL EXCEED 15 FOOT IN DIAMETER.

NOTE: ALL PIPE FROM HOUSE TO DISPOSAL AREA MUST BE CAST IRON.

PERMIT VOID AFTER THREE YEARS.

NOTE: INSTALL STAND PIPE ON SEPTIC TANK AND DRY WELL. STAND PIPES MUST BE 6 INCHES IN DIAMETER. CAST IRON, CONCRETE OR TERRA COTTA ACCEPTED.

***INSTALLER IS RESPONSIBLE FOR OBTAINING FINAL APPROVAL ON THIS PERMIT.**

P
29872

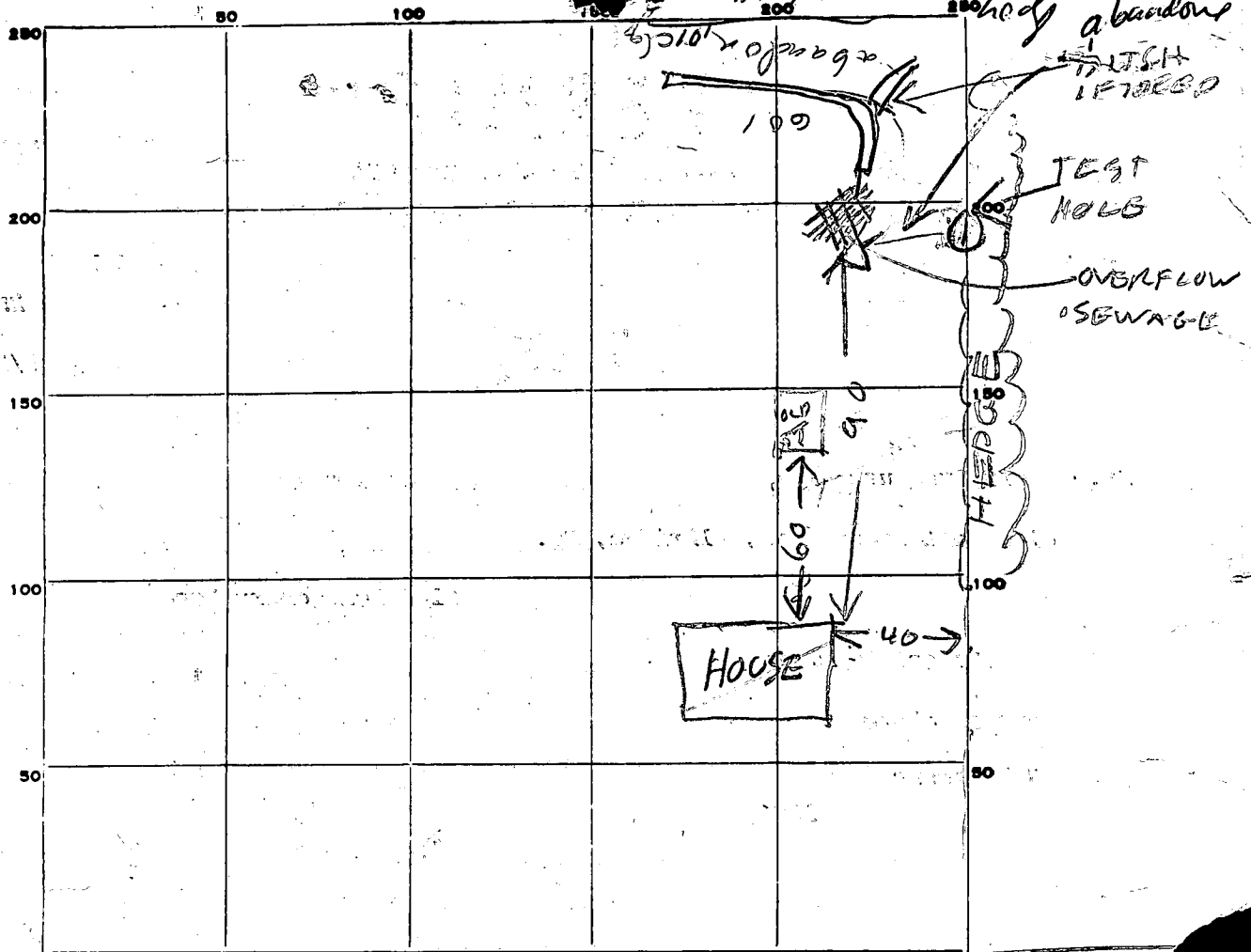

INDICATE NORTH - NAME ADJOINING ROADWAY AS BASE LINE.
 ← TO EKRIDGE MONTGOMERY RD

PERMIT CARD YES

SEPTIC TANK, LEVEL _____ CLEANOUTS _____

DISTRIBUTION BOX, LEVEL _____

TILE FIELD, DEPTH 4-7 FT. TRENCH WIDTH 2 FT.

GRAVEL DEPTH 2 1/2 - 5 1/2 IN. TOTAL LENGTH 60' FT.

NUMBER OF TRENCHES 1 one side TOTAL BOTTOM AREA 240

SEEPAGE PITS, INSIDE DIAMETER _____ FT. DEPTH BELOW INLET _____ FT.

ABSORBENT AREA _____ SQ. FT.

REMARKS 5/29/79 Test Hole (1) 4 FT DEEP WITH WATER IN
BOTTOM PROBABLY FROM YESTERDAY'S RAIN RH
Best soil bottom 1' last 15' - good sand
side of last 40' sandy-clay-gravel, after heavy
rain dry RJM 9/15/79

DATE SYSTEM APPROVED 9/15/79 INSPECTOR [Signature]

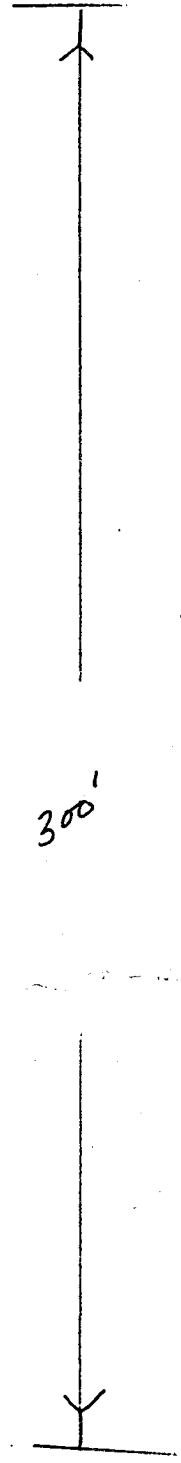
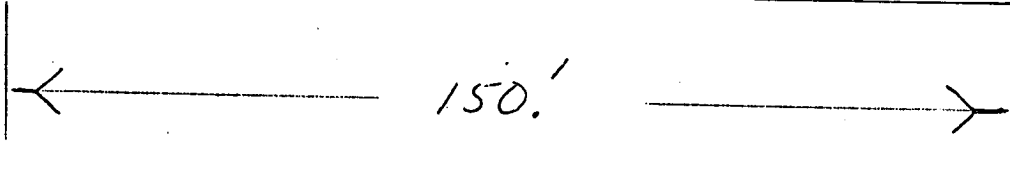
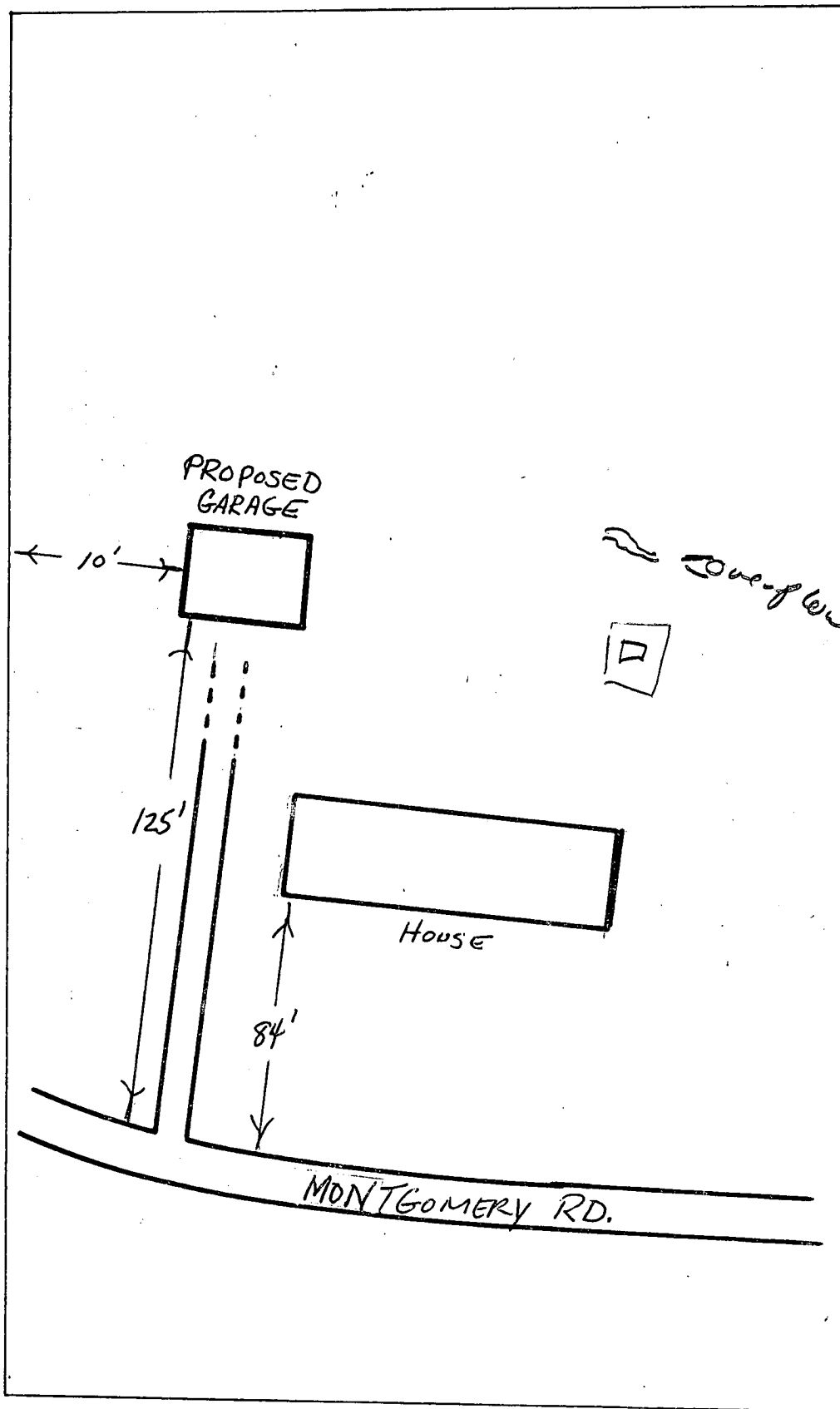

2' wide

3' stone

360