

2:00  
8/10/79

Approved 8/10/79  
J. Stayer  
P 29844

# PERMIT

SEWAGE DISPOSAL SYSTEM

MARYLAND STATE DEPARTMENT OF HEALTH\*

HOWARD COUNTY

01-169904

ELLICOTT CITY

DISTRICT 2nd

DATE 5/17/79

INDEXED

A REPAIR

Mr. William Jenkins IS PERMITTED TO INSTALL ALTER X

ADDRESS 5632 Montgomery Road, Ellicott City, Md. PHONE \_\_\_\_\_

SUBDIVISION \_\_\_\_\_ ROAD 5632 Montgomery Road LOT \_\_\_\_\_

PROPERTY OWNER William Jenkins

ADDRESS same as above

SPECIFICATIONS

SEPTIC TANK CAPACITY \_\_\_\_\_ GALLONS

DRAIN FIELD \_\_\_\_\_ DEPTH \_\_\_\_\_ FEET, BOTTOM AREA \_\_\_\_\_ SQ. FT.

DEEP TRENCH \_\_\_\_\_ DEPTH \_\_\_\_\_ FEET, BOTTOM AREA \_\_\_\_\_ SQ. FT.

SEEPAGE PITS \_\_\_\_\_ ABSORBENT SIDE-WALL AREA \_\_\_\_\_ SQ. FT.

INLET PIPE \_\_\_\_\_ FT. BELOW ORIGINAL GRADE. MAXIMUM DEPTH \_\_\_\_\_ FT. BELOW ORIGINAL GRADE

EFFECTIVE DEPTH AT \_\_\_\_\_ FT. BELOW ORIGINAL GRADE.

LOCATE DISPOSAL AREA \_\_\_\_\_ FT. FROM \_\_\_\_\_ LOT LINE AND \_\_\_\_\_ FT. FROM \_\_\_\_\_ LOT LINE AS SEEN WHEN FACING LOT FROM

Installation of 2000 gallon sealed tank with alarm device/DWM.

PLANS APPROVED BY Donald W. Monaghan DATE 5/17/79

COVER NO WORK UNTIL INSPECTED AND APPROVED.

NEITHER THE HOWARD COUNTY COUNCIL NOR THE HEALTH DEPARTMENT IS RESPONSIBLE FOR THE SUCCESSFUL OPERATION OF ANY SYSTEM.

NOTE: IF TRENCH IS USED CALL FOR INSPECTION BEFORE PLACING GRAVEL IN TRENCH.

NOTE: NO DRY WELL SHALL EXCEED 15 FOOT IN DIAMETER.

NOTE: ALL PIPE FROM HOUSE TO DISPOSAL AREA MUST BE CAST IRON.

PERMIT VOID AFTER THREE YEARS.

NOTE: INSTALL STAND PIPE ON SEPTIC TANK AND DRY WELL. STAND PIPES MUST BE 6 INCHES IN DIAMETER. CAST IRON, CONCRETE OR TERRAZO ACCEPTED.

**\*INSTALLER IS RESPONSIBLE FOR OBTAINING FINAL APPROVAL ON THIS PERMIT.**

P 29844

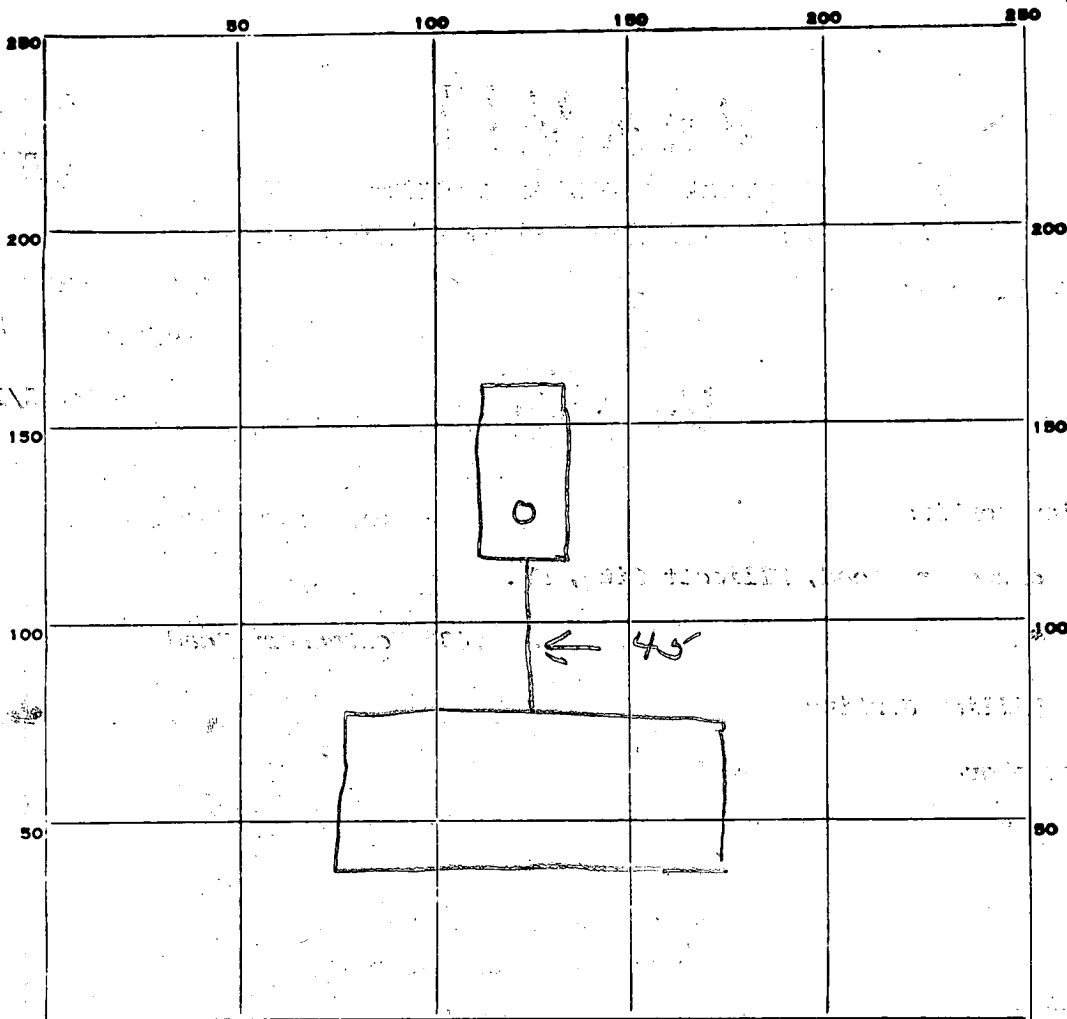

INDICATE NORTH. - NAME ADJOINING ROADWAY AS BASE LINE.

PERMIT CARD

SEPTIC TANK, LEVEL  2000 gal.

CLEANOUTS  cast iron

DISTRIBUTION BOX, LEVEL \_\_\_\_\_

TILE FIELD, DEPTH \_\_\_\_\_ FT. TRENCH WIDTH \_\_\_\_\_ FT.

GRAVEL DEPTH \_\_\_\_\_ IN. TOTAL LENGTH \_\_\_\_\_ FT.

NUMBER OF TRENCHES \_\_\_\_\_ TOTAL BOTTOM AREA \_\_\_\_\_

SEEPAGE PITS, INSIDE DIAMETER \_\_\_\_\_ FT. DEPTH BELOW INLET \_\_\_\_\_ FT.

ABSORBENT AREA \_\_\_\_\_ SQ. FT.

REMARKS

8/10/79 - OK to cover work. JS

DATE SYSTEM APPROVED

8/10/79

INSPECTOR

J. Stayer

# APPLICATION

A \_\_\_\_\_

P \_\_\_\_\_

## SEWAGE DISPOSAL TESTING

STATE OF MARYLAND - DEPARTMENT OF HEALTH AND MENTAL HYGIENE

DISTRICT 2nd

HOWARD COUNTY HEALTH DEPARTMENT  
ENVIRONMENTAL HEALTH SERVICES

DATE 3/6/75

P. O. BOX 476, ELLICOTT CITY, MARYLAND 21043  
TELEPHONE: 465-5000, EXT. 356

*Repair permit*  
*4/10/75*  
*4/13/75*  
*3/10/75*  
*4/30 A.M.*  
*6/11/75*  
*9:30*  
*5/24/75*  
*9:30*  
*6/20/75*  
*9:30*

*OK for 2000 gal sealed tank with alarm device*

TO: THE COUNTY HEALTH OFFICER  
ELLICOTT CITY, MARYLAND

I, HEREBY, APPLY FOR THE NECESSARY TEST IN ORDER TO CONSTRUCT (OR RECONSTRUCT) A SEWAGE DISPOSAL SYSTEM.

PROPERTY OWNER William Jenkins

ADDRESS 5632 Montgomery Road, Elkridge, Md. PHONE 796-1224

PROPERTY LOCATION:

SUBDIVISION \_\_\_\_\_ LOT NO. \_\_\_\_\_

ROAD AND DESCRIPTION 5632 Montgomery Road - 3rd house on right side from Old Montgomery Road

SIZE OF LOT \_\_\_\_\_ TYPE BLDG. \_\_\_\_\_ NUMBER OF BEDROOMS \_\_\_\_\_

IF NOT SINGLE RESIDENCE DESCRIBE \_\_\_\_\_

THE SYSTEM INSTALLED UNDER THIS APPLICATION IS ACCEPTABLE ONLY UNTIL PUBLIC FACILITIES BECOME AVAILABLE.

SIGNATURE OF APPLICANT /s/ Jenkins Brothers

APPROVED BY \_\_\_\_\_ FOR \_\_\_\_\_ DATE \_\_\_\_\_  
(KIND OF SYSTEM)

REJECTED BY Frank Skene FOR \_\_\_\_\_ DATE 4/21/78  
(KIND OF SYSTEM)

HOLD PENDING FURTHER TESTS \_\_\_\_\_ DATE \_\_\_\_\_

REASONS FOR REJECTION OR HOLDING 4/21/78 Poor soil type - all clay F.S.  
5/31/78 Hold for further tests.  
C.B.S.

# THIS IS NOT A PERMIT

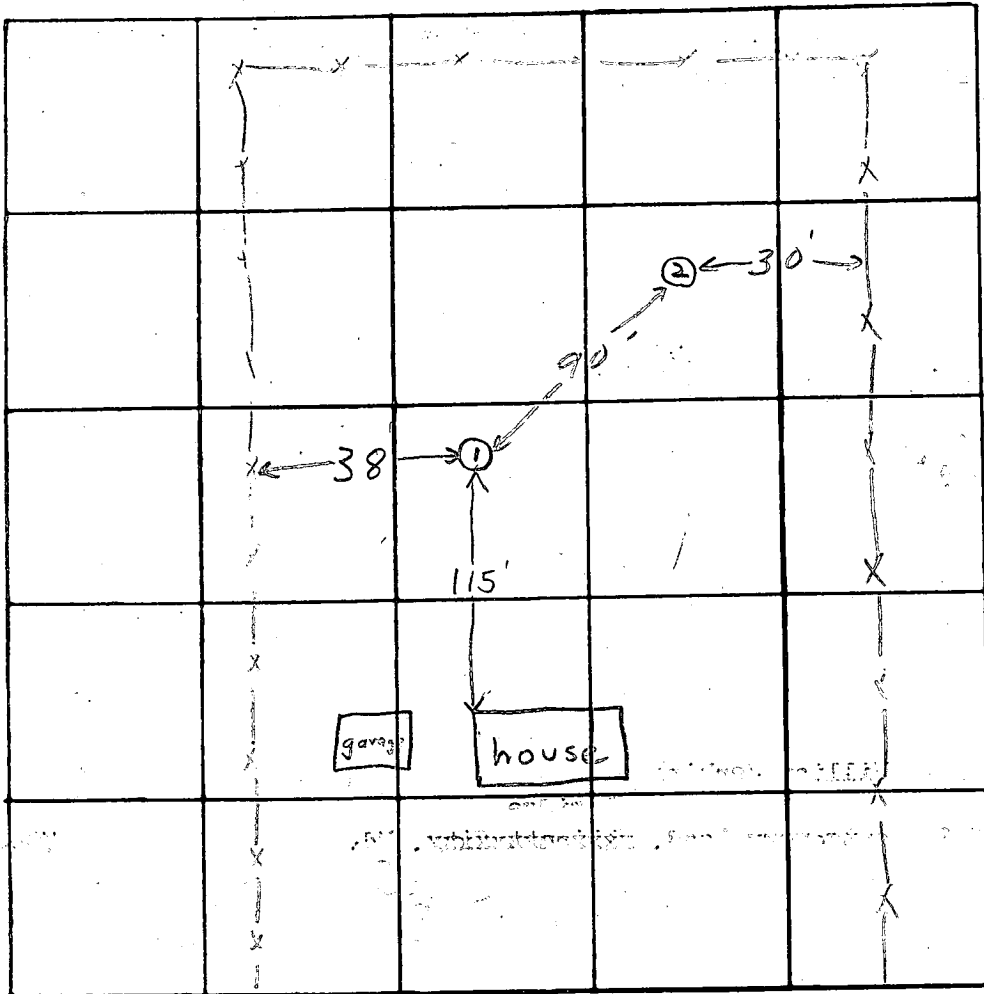
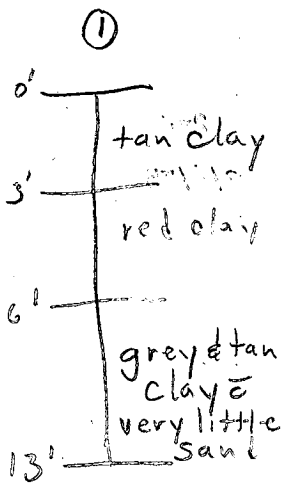

INDICATE NORTH - NAME ADJOINING ROADWAY AS BASE LINE.

Montgomery Road

DATE	TEST NO.	DEPTH	PRE-WET START	PRE-WET STOP	TEST - 1" DROP START	TEST - 1" DROP STOP	TIME
4/21/78	1	13'	Clay	0 → 13'			
	2	8'	Clay	0 → 8'			
			5/31/78	Recommend			

REMARKS

TYPE OF SOIL

TESTED BY

clay & clay loam

F.S.

(3) Need to get 2,000 gal. per D.W.M. in front

ALSO PRESENT:

Jenkins Bros. crew

To check old test in front