

4/20/79  
10:30 AM

05-365988

# PERMIT

P 29738

A Repair

APPROVED 4/20/79

SEWAGE DISPOSAL SYSTEM  
MARYLAND STATE DEPARTMENT OF HEALTH

HOWARD COUNTY

ELLICOTT CITY *Gck/cw*

DISTRICT \_\_\_\_\_

DATE 4/19/79

INDEXED

Jack Fyock \_\_\_\_\_ IS PERMITTED TO INSTALL \_\_\_\_\_ ALTER X

ADDRESS Glenelg, Md. PHONE \_\_\_\_\_

SUBDIVISION \_\_\_\_\_ ROAD 10151 Rodona Drive LOT \_\_\_\_\_

PROPERTY OWNER Schuchardt Rt. 29, right on Owen Brown Road, right on Old Columbia Pike, Rodona Drive on left.

ADDRESS 10151 Rodona Drive

SPECIFICATIONS

SEPTIC TANK CAPACITY \_\_\_\_\_ GALLONS  
DRAIN FIELD \_\_\_\_\_ DEPTH \_\_\_\_\_ FEET, BOTTOM AREA \_\_\_\_\_ SQ. FT.  
DEEP TRENCH \_\_\_\_\_ DEPTH \_\_\_\_\_ FEET, BOTTOM AREA \_\_\_\_\_ SQ. FT.  
SEEPAGE PITS \_\_\_\_\_ ABSORBENT SIDE-WALL AREA \_\_\_\_\_ SQ. FT.  
INLET PIPE \_\_\_\_\_ FT. BELOW ORIGINAL GRADE. MAXIMUM DEPTH \_\_\_\_\_ FT. BELOW ORIGINAL GRADE  
EFFECTIVE DEPTH AT \_\_\_\_\_ FT. BELOW ORIGINAL GRADE.  
LOCATE DISPOSAL AREA \_\_\_\_\_ FT. FROM \_\_\_\_\_ LOT LINE AND \_\_\_\_\_ FT. FROM \_\_\_\_\_ LOT LINE AS SEEN WHEN FACING LOT FROM

REPAIR-CALL FOR INSPECTION WHEN GROUND IS OPEEED UP SO SANITARIAN CAN RECOMMEND

REPAIR.

PLANS APPROVED BY Palmer F. Wine DATE 4/19/79

COVER NO WORK UNTIL INSPECTED AND APPROVED.

NEITHER THE HOWARD COUNTY COUNCIL NOR THE HEALTH DEPARTMENT IS RESPONSIBLE FOR THE SUCCESSFUL OPERATION OF ANY SYSTEM.

NOTE: IF TRENCH IS USED CALL FOR INSPECTION BEFORE PLACING GRAVEL IN TRENCH.

NOTE: NO DRY WELL SHALL EXCEED 15 FOOT IN DIAMETER.

NOTE: ALL PIPE FROM HOUSE TO DISPOSAL AREA MUST BE CAST IRON.

PERMIT VOID AFTER THREE YEARS.

NOTE: INSTALL STAND PIPE ON SEPTIC TANK AND DRY WELL. STAND PIPES MUST BE 6 INCHES IN DIAMETER. CAST IRON, CONCRETE OR TERRA COTTA ACCEPTED.

**\*INSTALLER IS RESPONSIBLE FOR OBTAINING FINAL APPROVAL ON THIS PERMIT.**

P 29738

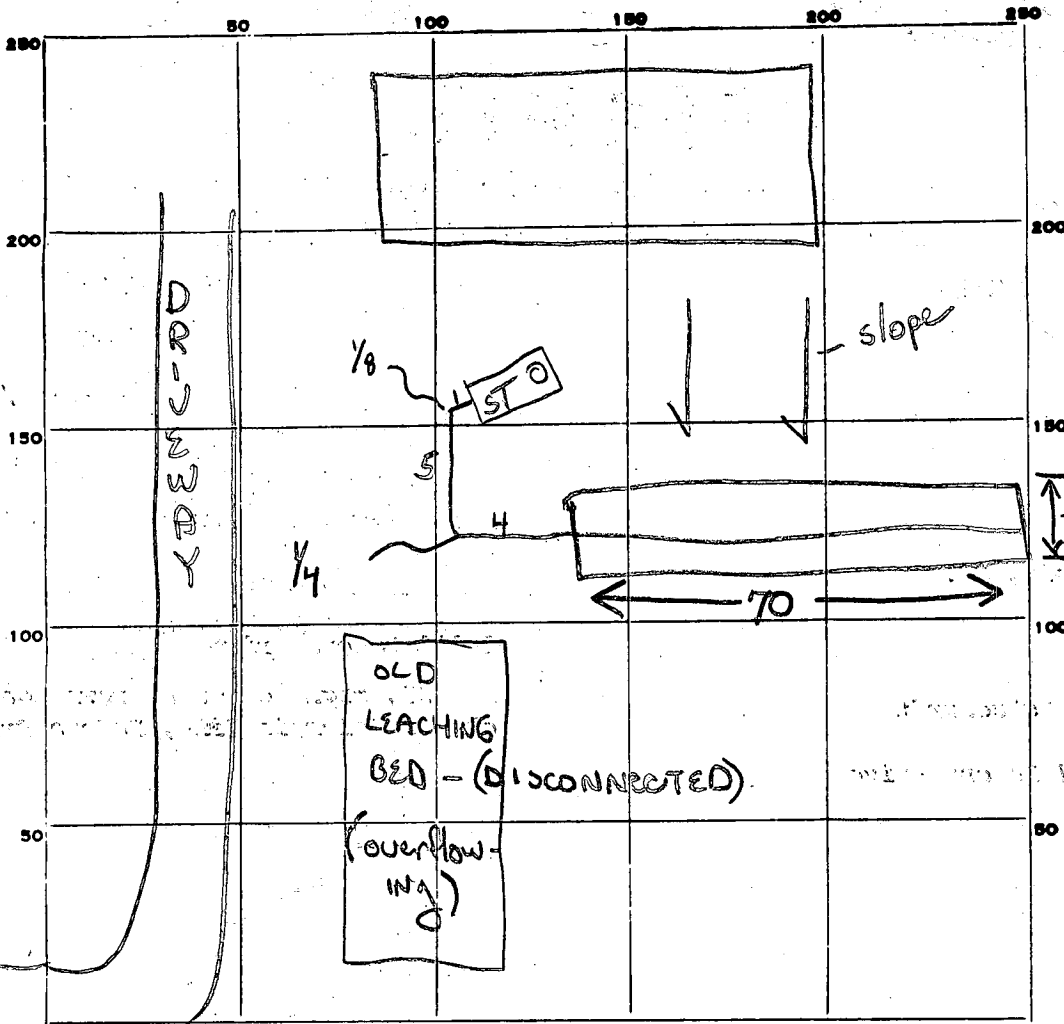

RODANO

INDICATE NORTH. - NAME ADJOINING ROADWAY AS BASE LINE.

PERMIT CARD \_\_\_\_\_

SEPTIC TANK, LEVEL \_\_\_\_\_ CLEANOUTS \_\_\_\_\_

DISTRIBUTION BOX, LEVEL \_\_\_\_\_

TILE FIELD, DEPTH 7 1/2 FT. TRENCH WIDTH 5 FT.

3 → 7 1/2 GRAVEL DEPTH \_\_\_\_\_ TOTAL LENGTH 70 FT.

NUMBER OF TRENCHES 1 TOTAL 1/2 SW AREA 315 TOTAL BOTTOM AREA 350

SEEPAGE PITS, INSIDE DIAMETER \_\_\_\_\_ FT. DEPTH BELOW INLET \_\_\_\_\_ FT.

ABSORBENT AREA ±665 SQ. FT.

REMARKS 20 Apr. 79 - 15 yrs old - 4BR - Good soil AT O.G. → 7 1/2.  
Rock deep. Call for final when gravel/pip added. (GLK)

20 Apr. 79 - TRENCH GRAVELED & PIPED TO 55'. System  
 can be backfilled providing owner "certifies" remaining  
 footage. (IS) (GLK)

INDEX AS APPROVED  
 NO RECORD OF FINAL INSP/APPROVAL AS OF 7/17/95 (CW)

DATE SYSTEM APPROVED 4/20/79 INSPECTOR GLK/CW