

~~4/30/79~~
~~4/27/79~~
9:30 P.M.

app. 4/12/79
29670

PERMIT

SEWAGE DISPOSAL SYSTEM

MARYLAND STATE DEPARTMENT OF HEALTH*

HOWARD COUNTY

ELLICOTT CITY

DISTRICT 3rd

DATE 4/5/79

INDEXED

Thomas Ohler

IS PERMITTED TO INSTALL _____ ALTER X

ADDRESS _____ PHONE 247-4799

SUBDIVISION Woodmark ROAD Pointer Hill Court LOT _____

PROPERTY OWNER Charles Lancellotta

ADDRESS Pointer Hill Court, Ellicott City, Md. Phone: 988-9148

SPECIFICATIONS

SEPTIC TANK CAPACITY _____ GALLONS
DRAIN FIELD _____ DEPTH _____ FEET; BOTTOM AREA _____ SQ. FT.
DEEP TRENCH _____ DEPTH _____ FEET; BOTTOM AREA _____ SQ. FT.
SEEPAGE PITS _____ ABSORBENT SIDE-WALL AREA _____ SQ. FT.
INLET PIPE _____ FT. BELOW ORIGINAL GRADE. MAXIMUM DEPTH _____ FT. BELOW ORIGINAL GRADE
EFFECTIVE DEPTH AT _____ FT. BELOW ORIGINAL GRADE.
LOCATE DISPOSAL AREA _____ FT. FROM _____ LOT LINE AND _____ FT. FROM _____ LOT LINE AS SEEN WHEN
FACING LOT FROM

REPAIR - Call for an appointment when ground is opened up and Sanitarian will recommend the repair system.

*(4/27/79 Rain was shown by digger. Hold for reschedule date)
Shallow trench 80' long, 5' wide, 5' deep with 3" B stove - following contour*

PLANS APPROVED BY Palmer F. Wine DATE 4/5/79 *(AK)*

COVER NO WORK UNTIL INSPECTED AND APPROVED.
NEITHER THE HOWARD COUNTY COUNCIL NOR THE HEALTH DEPARTMENT IS RESPONSIBLE FOR THE SUCCESSFUL OPERATION OF ANY SYSTEM.
NOTE: IF TRENCH IS USED CALL FOR INSPECTION BEFORE PLACING GRAVEL IN TRENCH.
NOTE: NO DRY WELL SHALL EXCEED 15 FOOT IN DIAMETER.
NOTE: ALL PIPE FROM HOUSE TO DISPOSAL AREA MUST BE CAST IRON.
PERMIT VOID AFTER THREE YEARS.
NOTE: INSTALL STAND PIPE ON SEPTIC TANK AND DRY WELL. STAND PIPES MUST BE 6 INCHES IN DIAMETER. CAST IRON, CONCRETE OR TERRA COTTA ACCEPTED.

***INSTALLER IS RESPONSIBLE FOR OBTAINING FINAL APPROVAL ON THIS PERMIT.**

P
29670

ORIGINAL SYSTEM
7 1/2 YRS. OLD

20 x 20 x 4'
2' stone

POINTER

Elevation

① → DW = +56

② → DW = +3

90
20

76
270

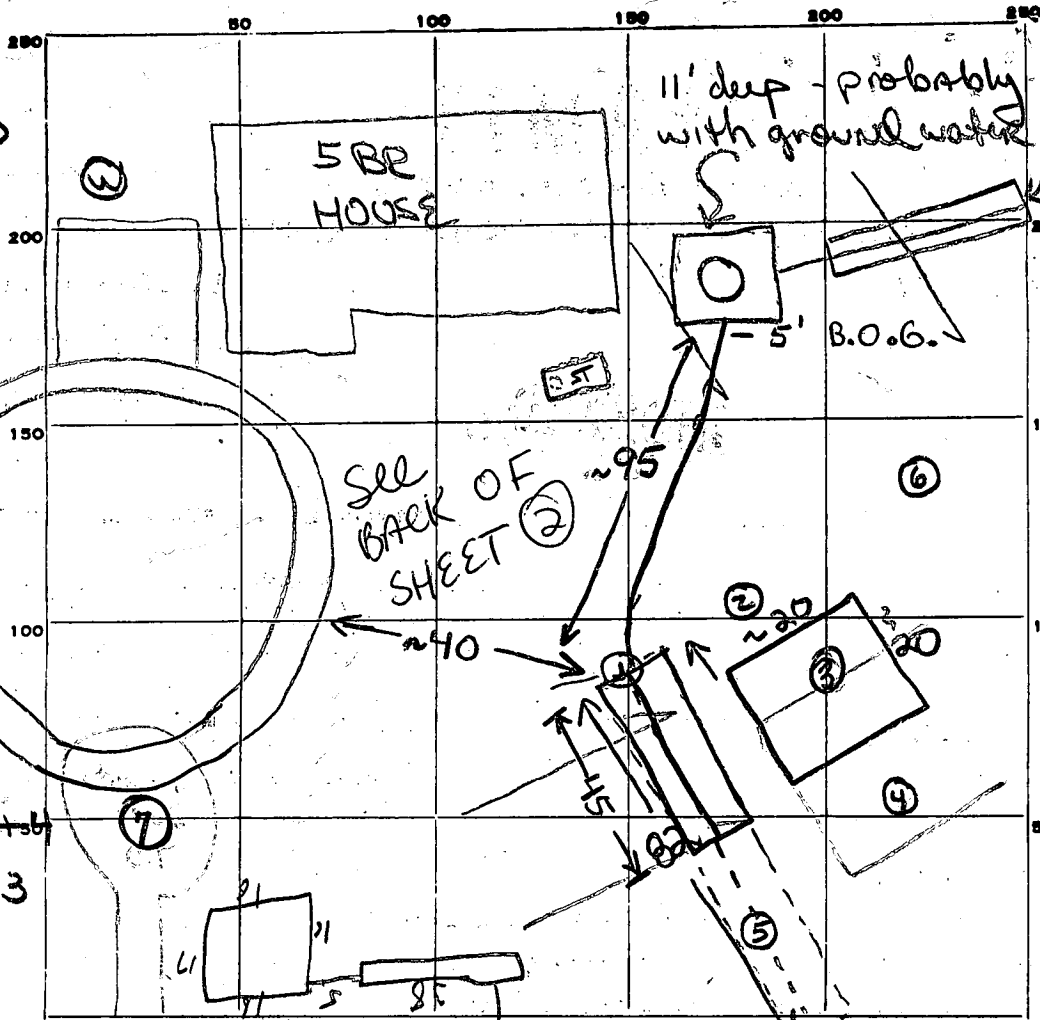

11' deep - probably in contact with ground water

overflow

SPRINGHEADS throughout lot

Holes ① → ⑥

with 15 to 30' of one another - (opened ON ARRIVAL 4/30)

variable clay layer WATER AS INDICATED

- 1 - 9' - DRY
- 2 - 9 1/2' - WATER
- 3 - 8' - WATER
- 4 - 7 1/2' - WATER
- 5 - 9' - WATER
- 6 - 4 1/2' - DRY

INDICATE NORTH. - NAME ADJOINING ROADWAY AS BASE LINE.

PERMIT CARD SPCS given 4/30/79

SEPTIC TANK, LEVEL _____

CLEANOUTS

ST	DW
✓	✓

CAST IRON

DISTRIBUTION BOX, LEVEL _____

TILE FIELD, DEPTH 5 1/2 FT. TRENCH WIDTH 6 FT.

GRAVEL DEPTH 2 1/2 * TOTAL LENGTH 45 FT.

NUMBER OF TRENCHES 1

TOTAL 1/2 SW AREA 110
TOTAL BOTTOM AREA 270 } 380 IN TRENCH

SEEPAGE PITS, INSIDE DIAMETER _____ FT. DEPTH BELOW INLET _____ FT.

ABSORBENT AREA _____ SQ. FT.

REMARKS 30 Apr 79 - SHALLOW TRENCH - 80' long, 5' wide, 5' deep with 3' of stone. Directed as indicated with the contour. Gave OK to gravel portion of trench. (GLK) 1 MAY 79 - Contacted by Mr. Ohler - phone during excavation spring head was hit at point (P). Instructed Ohler to backfill last 40' over spring head 3 to make up footage in backing had provided soil is suitable. (GLK) 1 MAY 79 see sheet 2

DATE SYSTEM APPROVED 7/2/79

INSPECTOR JM Manager

LANCELLOTA - POINTER HILL CT

Springheads throughout lot

1 MAY 79 - Site Visit - Trench excavated with portion backfilled to have a total usable length of 45' sidewall & bottom area of trench predominantly sandy loam.

Vicinity of hole ③
(center of bed)

Leaching bed excavated on arrival (~20x20x 3 1/2 - 4 1/2' deep) however, soil looks questionable.
(see test results)

Depth

3 1/2' 12¹³ → 12²¹ No drop

4' 12²¹ → 3/4" drop - then stopped

4 1/2' 12²⁰ → 12⁴⁰ 12⁴⁰ → 12⁵⁵ No drop

7 1/2' - WATER

} plastic sandy clay

Failing tests - STOP WORK (GLK)

1 MAY 79

Contacted DM, who made site visit & based on VISUAL hole

SMALL AMTS ROCK

⑦ (clayey silt to 3 1/2', silty sand loam to 12 1/2' DRY) made the following recommendations:

- installation of watertight pump pit equipped with dual pumps
- installation of 16 x 16 □ drywell with 9' effective (3' → 12') depth.
- use of trench (effective) & leaching bed (noneffective) as overflows in case of pump failure

Location as on back of this sheet. (GLK)

Gave OK to backfill sewer from old dry well to pump pit & to call for final when all work is complete.

1 MAY 79

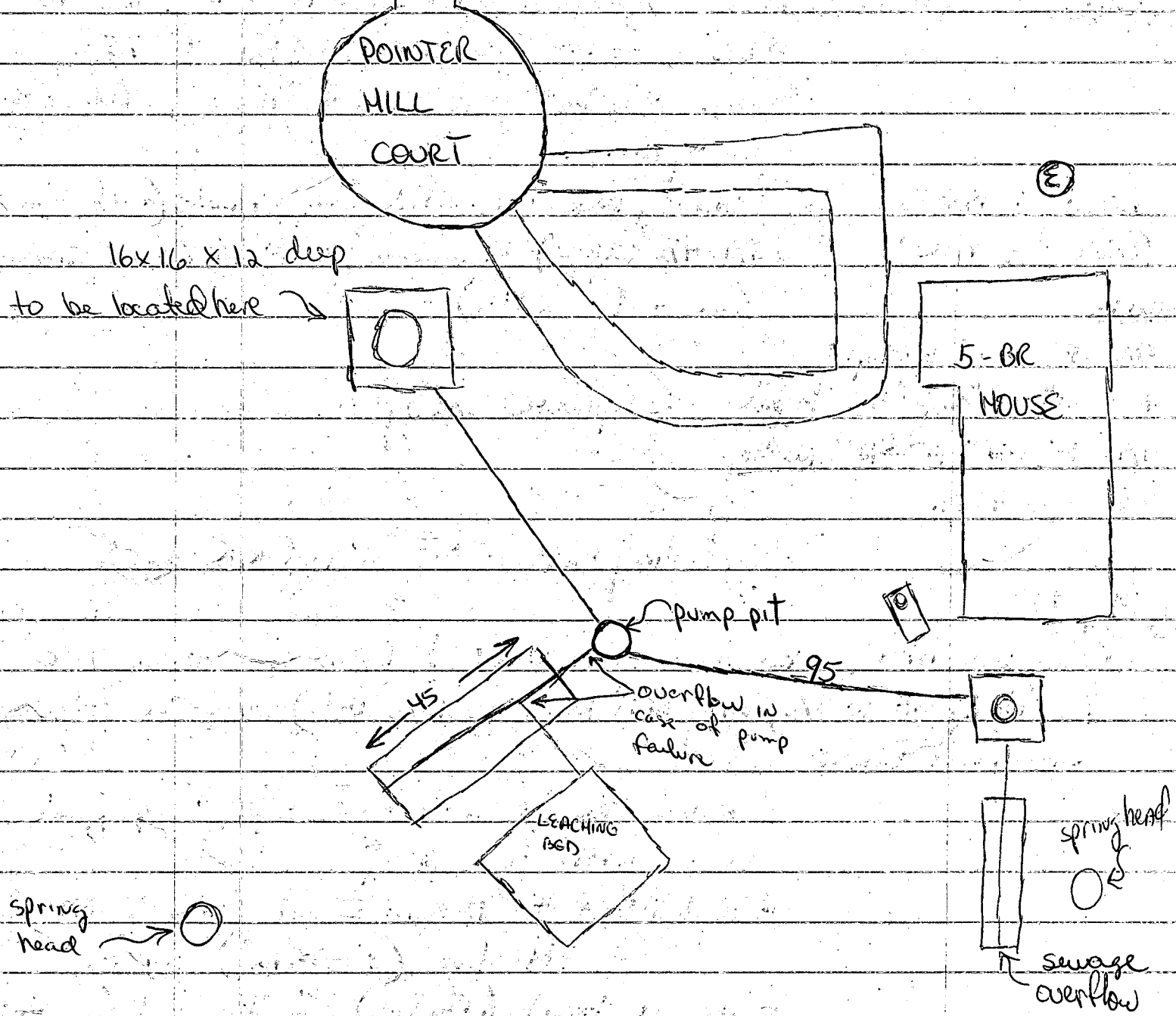

5-5-79 Dry Well depth changed to ft below grade with trench off. 200. sum