

~~27~~ / 79

if possible

27 / 79

Approved
(64)

27 Apr 79

PERMIT

SEWAGE DISPOSAL SYSTEM

MARYLAND STATE DEPARTMENT OF HEALTH*

P 29565

A Repair

HOWARD COUNTY

03-281949

ELLICOTT CITY

DISTRICT 2nd

INDEXED

DATE 3/13/79

Jack Fyock Schessler

IS PERMITTED TO INSTALL _____ ALTER X

ADDRESS 13775 Triadelphia Road, Glenelg, Md.

PHONE 988-9270

SUBDIVISION _____

ROAD 12745 11036 Frederick Road

PROPERTY OWNER Mrs. ~~Sadie~~ Marie Cavey

(Tenant - Mrs. Jeannie Graves)

ADDRESS 11036 Frederick Road, Ellicott City, Md. 21043

SPECIFICATIONS

SEPTIC TANK CAPACITY 1000 GALLONS

DRAIN FIELD _____ DEPTH _____ FEET, BOTTOM AREA _____ SQ. FT.

DEEP TRENCH _____ DEPTH _____ FEET, BOTTOM AREA _____ SQ. FT.

SEEPAGE PITS _____ ABSORBENT SIDE-WALL AREA _____ SQ. FT.

INLET PIPE _____ FT. BELOW ORIGINAL GRADE. MAXIMUM DEPTH _____ FT. BELOW ORIGINAL GRADE

EFFECTIVE DEPTH AT _____ FT. BELOW ORIGINAL GRADE.

LOCATE DISPOSAL AREA _____ FT. FROM _____ LOT LINE AND _____ FT. FROM _____ LOT LINE AS SEEN WHEN FACING LOT FROM

REPAIR - Call for an appointment when ground is opened up and Sanitarian will

recommend repair. 4/25/79 Pit 5ft deep - 5' wide 70' long

2ft of stone under pipe
old system the cut off - see n

PLANS APPROVED BY Palmer F. Wine

DATE 3/12/79

COVER NO WORK UNTIL INSPECTED AND APPROVED.

NEITHER THE HOWARD COUNTY COUNCIL NOR THE HEALTH DEPARTMENT IS RESPONSIBLE FOR THE SUCCESSFUL OPERATION OF ANY SYSTEM.

NOTE: IF TRENCH IS USED CALL FOR INSPECTION BEFORE PLACING GRAVEL IN TRENCH.

NOTE: NO DRY WELL SHALL EXCEED 15 FOOT IN DIAMETER.

NOTE: ALL PIPE FROM HOUSE TO DISPOSAL AREA MUST BE CAST IRON.

PERMIT VOID AFTER THREE YEARS.

NOTE: INSTALL STAND PIPE ON SEPTIC TANK AND DRY WELL. STAND PIPES MUST BE 6 INCHES IN DIAMETER. CAST IRON, CONCRETE OR TERRA COTTA ACCEPTED.

*INSTALLER IS RESPONSIBLE FOR OBTAINING FINAL APPROVAL ON THIS PERMIT.

P 29565

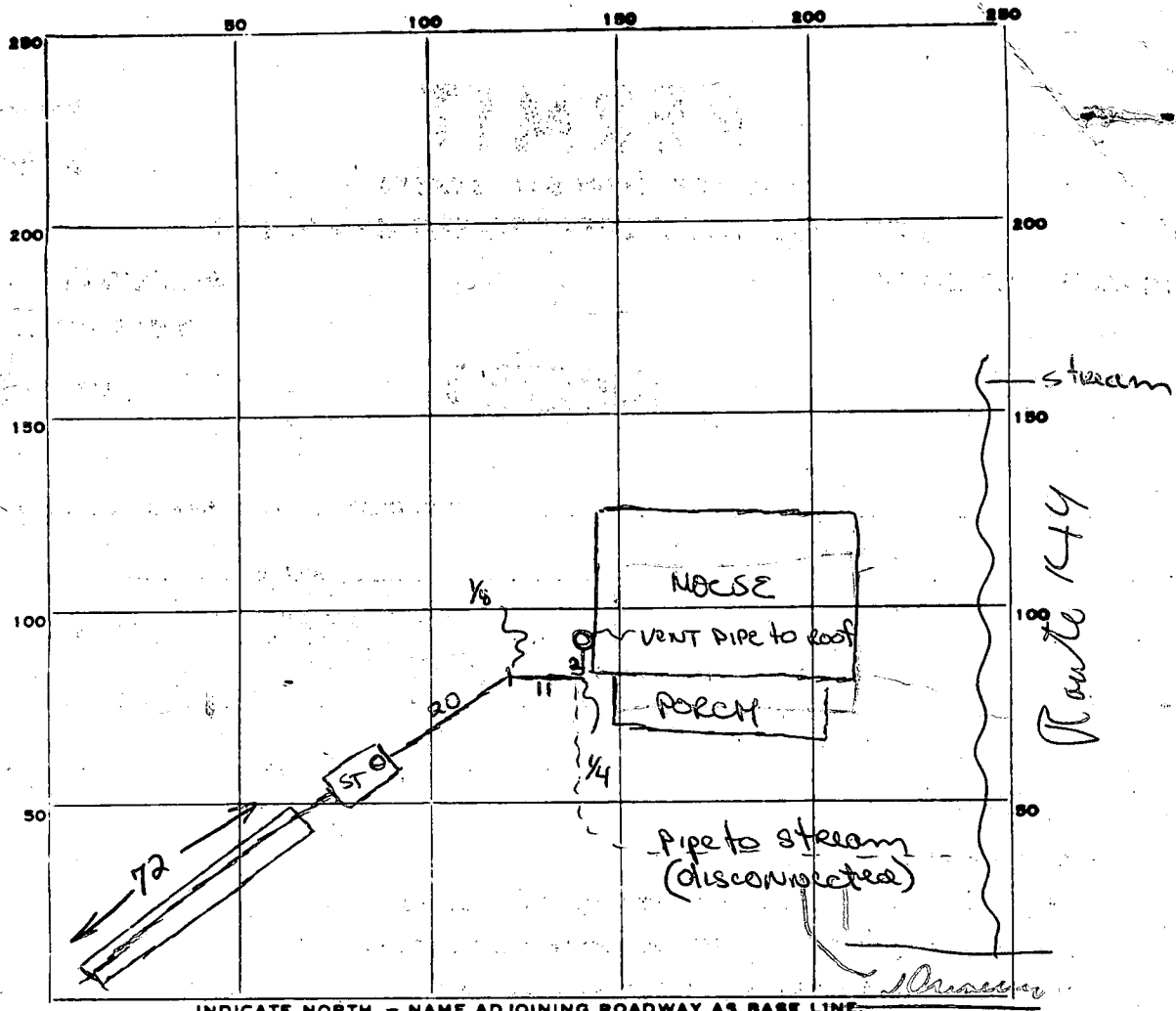

INDICATE NORTH. - NAME ADJOINING ROADWAY AS BASE LINE.

PERMIT CARD _____

SEPTIC TANK, LEVEL ✓ 1000 gal

CLEANOUTS ST ✓ terracotta

DISTRIBUTION BOX, LEVEL NA

TILE FIELD, DEPTH 5 FT. TRENCH WIDTH 5 FT.

GRAVEL DEPTH 2 ~~X~~ TOTAL LENGTH 72 FT.

NUMBER OF TRENCHES 1 TOTAL $\frac{1}{2}$ SW +140
TOTAL BOTTOM AREA +350

SEEPAGE PITS, INSIDE DIAMETER NA FT. DEPTH BELOW INLET _____ FT.

ABSORBENT AREA ± 490 SQ. FT.

REMARKS 26 Apr 79 - OK for stone (GLK)
26 Apr 79 3:15 - Trench partially graveled. call for final
when trench is graveled 3' piped. (GLK)
27 Apr 79 - Final OK (GLK)

DATE SYSTEM APPROVED 27 Apr 79

INSPECTOR G. Keller