

6/28/79
around noon
please

File

PERMIT

P 29955

REPAIR

SEWAGE DISPOSAL SYSTEM

MARYLAND STATE DEPARTMENT OF HEALTH*

HOWARD COUNTY

ELLICOTT CITY

DISTRICT 2nd

INDEXED

DATE 6/26/79

Jack Fyock

IS PERMITTED TO INSTALL ALTER X

ADDRESS _____ PHONE _____

SUBDIVISION _____ ROAD Centennial Lane LOT _____

PROPERTY OWNER Tucker at site

ADDRESS Centennial Lane, across from Centennial School.

SPECIFICATIONS

SEPTIC TANK CAPACITY _____ GALLONS

DRAIN FIELD _____ DEPTH _____ FEET, BOTTOM AREA _____ SQ. FT.

DEEP TRENCH _____ DEPTH _____ FEET, BOTTOM AREA _____ SQ. FT.

SEEPAGE PITS _____ ABSORBENT SIDE-WALL AREA _____ SQ. FT.

INLET PIPE _____ FT. BELOW ORIGINAL GRADE. MAXIMUM DEPTH _____ FT. BELOW ORIGINAL GRADE

EFFECTIVE DEPTH AT _____ FT. BELOW ORIGINAL GRADE.

LOCATE DISPOSAL AREA _____ FT. FROM _____ LOT LINE AND _____ FT. FROM _____ LOT LINE AS SEEN WHEN FACING LOT FROM

REPAIR-CALL FOR INSPECTION WHEN GROUND IS OPENED UP SO SANITARIAN CAN

RECOMMEND REPAIR.

PLANS APPROVED BY Palmer F. Wine DATE 6/26/89

COVER NO WORK UNTIL INSPECTED AND APPROVED.

NEITHER THE HOWARD COUNTY COUNCIL NOR THE HEALTH DEPARTMENT IS RESPONSIBLE FOR THE SUCCESSFUL OPERATION OF ANY SYSTEM.

NOTE: IF TRENCH IS USED CALL FOR INSPECTION BEFORE PLACING GRAVEL IN TRENCH.

NOTE: NO DRY WELL SHALL EXCEED 15 FOOT IN DIAMETER.

NOTE: ALL PIPE FROM HOUSE TO DISPOSAL AREA MUST BE CAST IRON.

PERMIT VOID AFTER THREE YEARS.

NOTE: INSTALL STAND PIPE ON SEPTIC TANK AND DRY WELL. STAND PIPES MUST BE 6 INCHES IN DIAMETER. CAST IRON, CONCRETE OR TERRA COTTA ACCEPTED.

***INSTALLER IS RESPONSIBLE FOR OBTAINING FINAL APPROVAL ON THIS PERMIT.**

P
29955

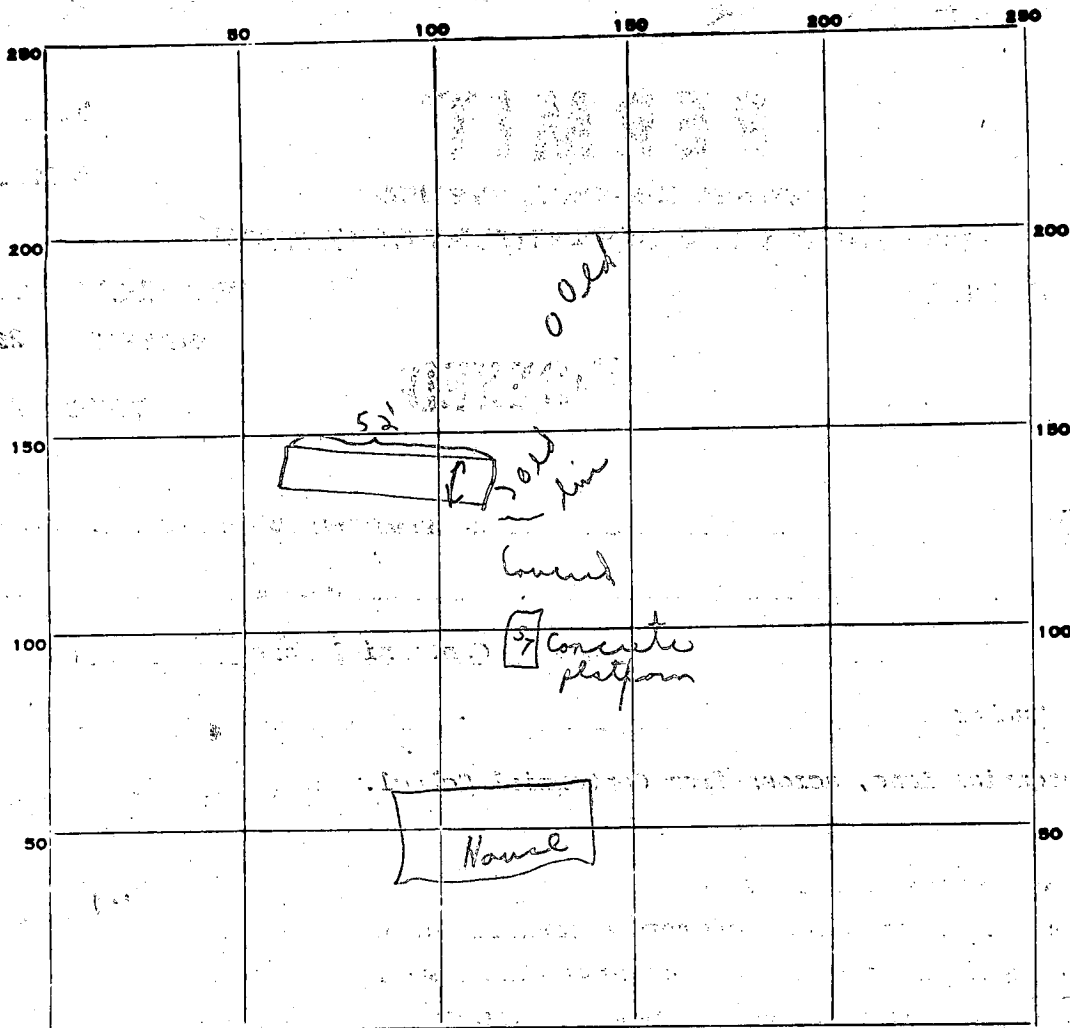

INDICATE NORTH. - NAME ADJOINING ROADWAY AS BASE LINE.

Centered on 108

PERMIT CARD Yes Centered on 108 S.T. D.W.
 SEPTIC TANK, LEVEL N/A school CLEANOUTS N/A N/A
 DISTRIBUTION BOX, LEVEL N/A stone stone
 TILE FIELD, DEPTH 6 on Mr. Tucker from his back porch 5 FT. TRENCH WIDTH 5 FT.
 GRAVEL DEPTH 4 IN. TOTAL LENGTH 52 FT.
 NUMBER OF TRENCHES 1 TOTAL BOTTOM AREA -
 SEEPAGE PITS, INSIDE DIAMETER outside perimeter FT. DEPTH BELOW INLET - FT.
 ABSORBENT AREA 780 SQ. FT.

REMARKS 6/28/79 Checked - found 10 papers on trench to 2' of surface @ wall plastic to new in gas Robert Fyock shales

DATE SYSTEM APPROVED 6/28/79 as per above INSPECTOR C. B. Tucker