

5/12/80

Approved 5/12/80  
J. Stager

# PERMIT

P 30649

SEWAGE DISPOSAL SYSTEM

A 29143

MARYLAND STATE DEPARTMENT OF HEALTH

HOWARD COUNTY

ELLICOTT CITY

## INDEXED

DISTRICT 5th.

DATE 4/23/80

Howard Pickett IS PERMITTED TO INSTALL X ALTER

ADDRESS Watersville Road, Mt. Airy, Md. 21771 PHONE 829-0543

SUBDIVISION \_\_\_\_\_ ROAD Sanner Road LOT \_\_\_\_\_

PROPERTY OWNER Johns Hopkins Applied Physics Lab. Ballfield Locker Room  
Johns Hopkins Road, Laurel, Md. 20810 PHONE: 953-7100

ADDRESS \_\_\_\_\_

### SPECIFICATIONS

SEPTIC TANK CAPACITY 1250 GALLONS

DRAIN FIELD \_\_\_\_\_ DEPTH \_\_\_\_\_ FEET, BOTTOM AREA \_\_\_\_\_ SQ. FT.

DEEP TRENCH \_\_\_\_\_ DEPTH \_\_\_\_\_ FEET, BOTTOM AREA \_\_\_\_\_ SQ. FT.

SEEPAGE PITS \_\_\_\_\_ ABSORBENT SIDE-WALL AREA \_\_\_\_\_ SQ. FT.

INLET PIPE \_\_\_\_\_ FT. BELOW ORIGINAL GRADE. MAXIMUM DEPTH \_\_\_\_\_ FT. BELOW ORIGINAL GRADE

EFFECTIVE DEPTH AT \_\_\_\_\_ FT. BELOW ORIGINAL GRADE.

LOCATE DISPOSAL AREA \_\_\_\_\_ FT. FROM \_\_\_\_\_ LOT LINE AND \_\_\_\_\_ FT. FROM \_\_\_\_\_ LOT LINE AS SEEN WHEN FACING LOT FROM

**DEEP TRENCH:** Begin the trench at a point 200 feet from the front property line and 50 feet from the edge of the existing parking lot (perc hole 1). The invert will enter the field at 4 feet below original grade and maximum trench depth will not exceed 10 feet. The trench will have a total length of 100 feet, be 2 ft. wide and contain 6 ft. of stone. Direct the trench away from and perpendicular to Sanner Road (perc hole #2) being sure to follow the contour of the land. (150 feet from the edge of Sanner Road)

PLANS APPROVED BY George Keller DATE 11/21/79

COVER NO WORK UNTIL INSPECTED AND APPROVED.

NEITHER THE HOWARD COUNTY COUNCIL NOR THE HEALTH DEPARTMENT IS RESPONSIBLE FOR THE SUCCESSFUL OPERATION OF ANY SYSTEM.

NOTE: IF TRENCH IS USED CALL FOR INSPECTION BEFORE PLACING GRAVEL IN TRENCH.

NOTE: NO DRY WELL SHALL EXCEED 15 FOOT IN DIAMETER.

NOTE: ALL PIPE FROM HOUSE TO DISPOSAL AREA MUST BE CAST IRON.

PERMIT VOID AFTER THREE YEARS.

NOTE: INSTALL STAND PIPE ON SEPTIC TANK AND DRY WELL. STAND PIPES MUST BE 6 INCHES IN DIAMETER. CAST IRON, CONCRETE OR TERRA COTTA ACCEPTED.

**\*INSTALLER IS RESPONSIBLE FOR OBTAINING FINAL APPROVAL ON THIS PERMIT.**

A 29143

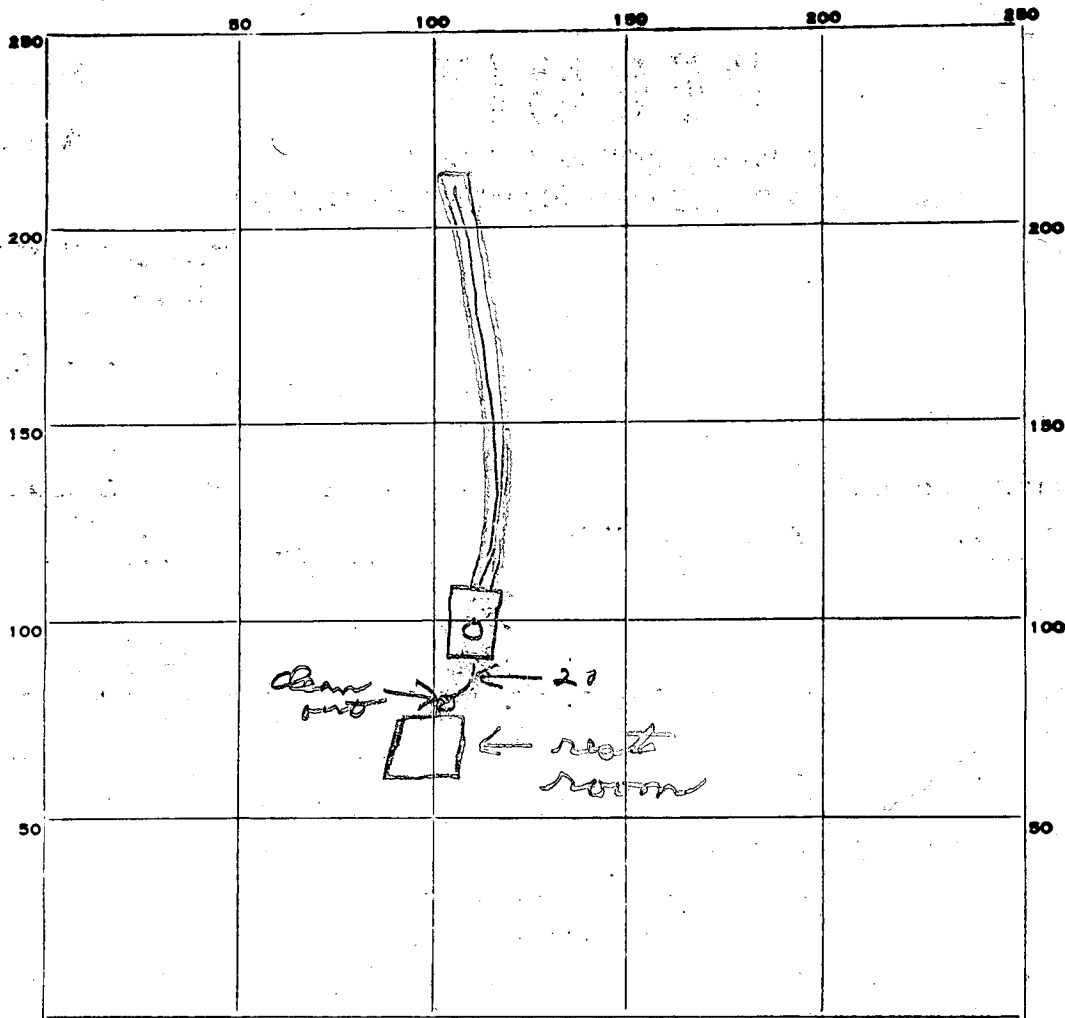

INDICATE NORTH. - NAME ADJOINING ROADWAY AS BASE LINE.

*Sanner Rd.*

PERMIT CARD

SEPTIC TANK, LEVEL

CLEANOUTS *ST*

DISTRIBUTION BOX, LEVEL

*terra cotta*

TILE FIELD, DEPTH 10 FT. TRENCH WIDTH 2 FT.

GRAVEL DEPTH 6'-6.5' IN. TOTAL LENGTH 100 FT.

NUMBER OF TRENCHES 1 TOTAL BOTTOM AREA 600

SEEPAGE PITS, INSIDE DIAMETER \_\_\_\_\_ FT. DEPTH BELOW INLET \_\_\_\_\_ FT.

ABSORBENT AREA 600<sup>+</sup> SQ. FT.

REMARKS 5/5/80 OK to add gravel in trench. Jd  
5/8/80 OK TO COVER FROM FAR END OF TRENCH TO 8' OF SEPTIC  
TANK. LEFT NEW CARD.

*C.B.S.*

5/12/80 OK to cover all work. Jd

DATE SYSTEM APPROVED 5/12/80

INSPECTOR *J. Stayer*

needs 2 holes per p7w

# APPLICATION

1/2 78  
1:30 p.m.

A 29143

SEWAGE DISPOSAL TESTING

STATE OF MARYLAND - DEPARTMENT OF HEALTH AND MENTAL HYGIENE

P \_\_\_\_\_

HOWARD COUNTY HEALTH DEPARTMENT  
ENVIRONMENTAL HEALTH SERVICES  
P.O. BOX 476 ELLICOTT, MARYLAND 21043  
TELEPHONE: 992-2330

DISTRICT \_\_\_\_\_

DATE 11/2/78

*specs on attached sheet*

BLDG. PERMIT SIGNED  
AND RETURNED 9-17-79  
*Serial # 41230*

TO: THE COUNTY HEALTH OFFICER  
ELLICOTT CITY, MARYLAND

I HEREBY APPLY FOR THE NECESSARY TEST IN ORDER TO CONSTRUCT (OR RECONSTRUCT) A SEWAGE DISPOSAL SYSTEM.

PROPERTY OWNER Johns Hopkins Applied Physics Lab.

ADDRESS John Hopkins Road, Laurel, Md. 20810 PHONE 953-7100

19A2

PROPERTY LOCATION ATTN: Arthur Stucki

SUBDIVISION \_\_\_\_\_ LOT NO. \_\_\_\_\_

ROAD AND DESCRIPTION Sanner Road at Ballfield and Tennis Courts - see Albert

SIZE OF LOT 365 Acres TYPE BLDG Molesworth  
~~Tennis Court Toilet~~  
Ballfield Toilet

THE SYSTEM INSTALLED UNDER THIS APPLICATION IS ACCEPTABLE ONLY UNTIL PUBLIC FACILITIES BECOME AVAILABLE.

I FULLY UNDERSTAND THE FEE CONNECTED WITH THE FILING OF THIS PERC TEST APPLICATION IS NON-REFUNDABLE UNDER

ANY CIRCUMSTANCES. BLDG. PERMIT SIGNED  
AND RETURNED 6/11/79  
Plant Engineer Serial No. 37743

SIGNATURE OF APPLICANT 

APPROVED BY G Keller FOR ANY DATE 21 NOV. 78

REJECTED BY \_\_\_\_\_ FOR \_\_\_\_\_ DATE \_\_\_\_\_

HOLD PENDING FURTHER TESTS \_\_\_\_\_ DATE \_\_\_\_\_

REASONS FOR REJECTION OR HOLDING Hold for elevations (GUD) 21 MAR 79

Elevations approved (GUD) 11 MAY 79

# THIS IS NOT A PERMIT

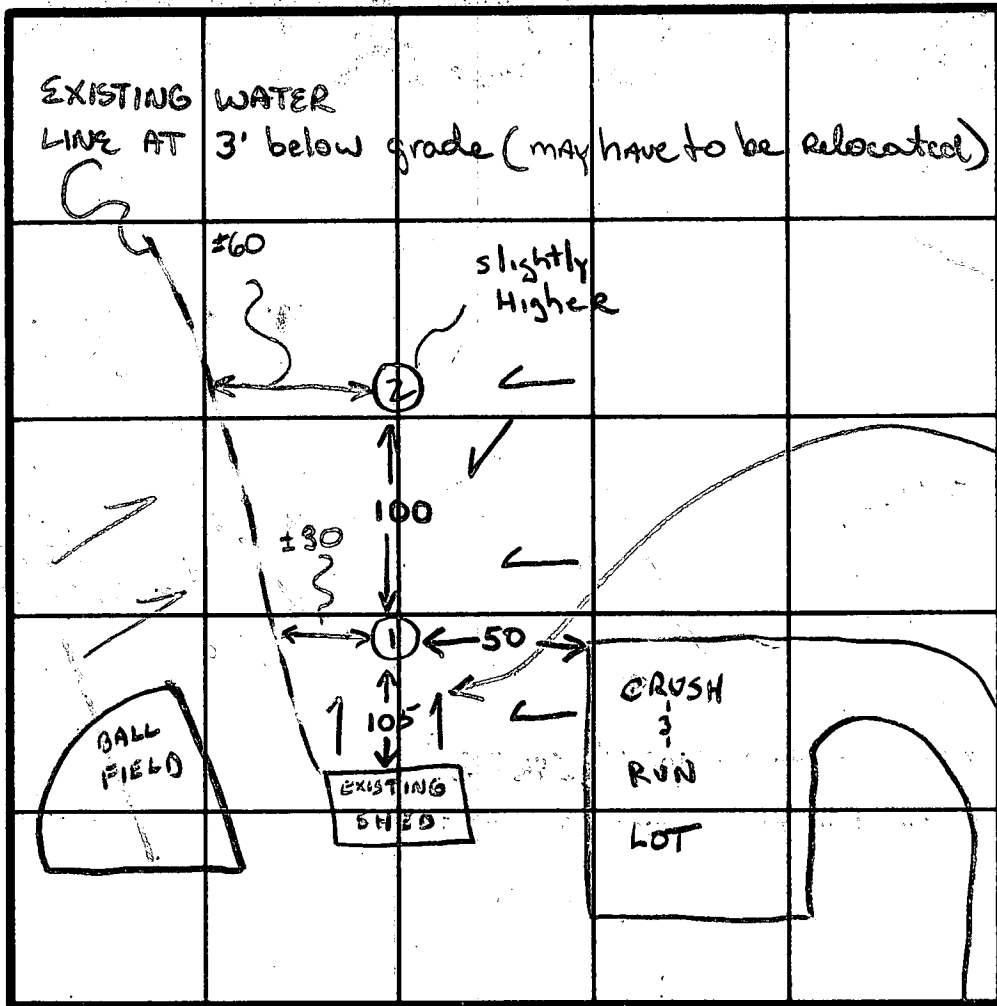

INDICATE NORTH - NAME ADJOINING ROADWAY AS BASE LINE.

SANNER RD

DATE	TEST NO.	DEPTH	PRE-WET		TEST - 1" DROP		TIME
			START	STOP	START	STOP	
11/21/79	15	4'	12 48	12 56	12 56	1 08	12
	10	12'	12 48	12 50	12 50	12 54	4
	25	4'	12 58	1 00	1 00	1 05	5
	20	12'	12 58	1 04	1 04	1 16	12

good soil at 2' →

REMARKS Spring → Fall - evenings  
2 toilets 3 handsinks (urinal) ~ 100 people

TYPE OF SOIL see profile

TESTED BY GLK ALSO PRESENT Molesworth

JAPL - Ballfield Facilities

21 MAR 79

(GLK)

Septic TANK: 1250 gallons

DEEP TRENCH: Begin the trench at a point 200' (\*) from the front prop. line & 50' from the edge of the existing parking lot (perc hole 1). (150' from the edge of Sawyer Road) The invert will enter the field AT 4' below original grade & maximum trench depth will not exceed 10'. The trench will have a total length of ~~100~~ 100', be 2' wide & contain 6' of stone. Direct the trench AWAY from, and perpendicular to Sawyer Road (perc hole 2) being sure to follow the contour of the land.

George L. Keller

2 inspections

21 MAR 79  
(GLK)

According to Molesworth

max. # people = 100

facilities = 2 toilets, 2 hand sinks, 1 URINAL

frequency = Spring to Fall

Picnic PARKS 5 gal/person

toilet waste only

500 gal/day

avg time  $\approx$  8 mins

8 mins = 1.5 gal/ft<sup>2</sup>/day

$$\begin{array}{r}
 333 \text{ ft}^2 \\
 15 \overline{) 5000} \\
 \underline{45} \phantom{0} \\
 50 \\
 \underline{45} \\
 50
 \end{array}$$

safety factor of 1.5

$$\begin{array}{r}
 333 \\
 1.5 \\
 \hline
 1665 \\
 333 \\
 \hline
 4995
 \end{array}$$

1250 septic tank

calculate on basis of 500'

4-10 = 85' of trench

6' of stone

1" = 20'

Approved Elevations  
10 MAY 79  
GLK

S A N N E R ROAD

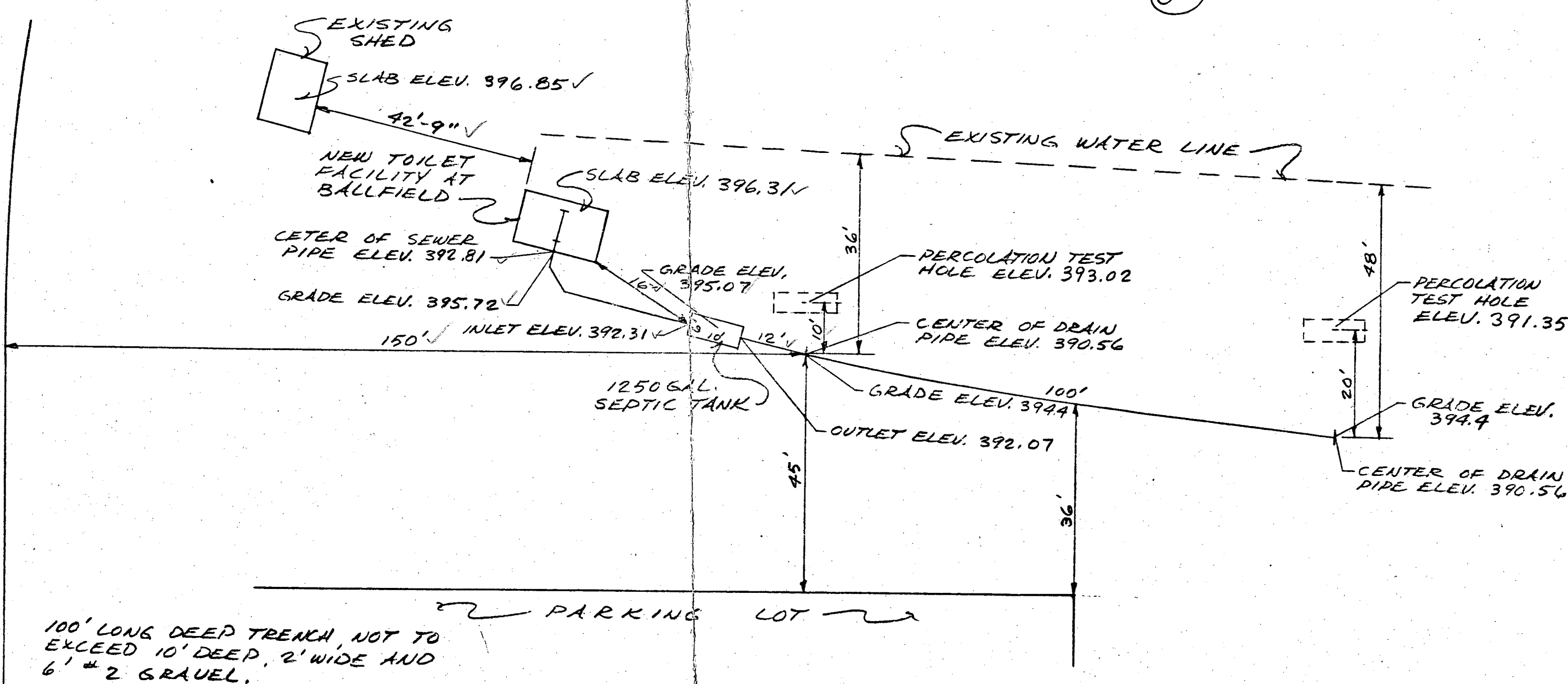

I CERTIFY THE ABOVE MEASUREMENTS AND ELEVATIONS ARE ACTUAL AND CORRECT FOR THIS PROPERTY.

SIGNED: Albert Holzman  
DATE: 5/3/79

PLAN OF SEPTIC FIELD AT BALLFIELD  
THE JOHNS HOPKINS UNIVERSITY  
APPLIED PHYSICS LABORATORY  
HOWARD COUNTY, MARYLAND

Review of Elevations  
for SHAPL - Ballfield

10 MAY 79

(GLK)

12/8

Building → Septic Tank 392.81 → 392.31

0.50' / 30' RUN = ~ 0.20" / ft OK

Septic Tank → Field 392.07 → 390.56

1.51' / 12' = ~ 1.5" / ft OK

Invert to field Grade 394.40

Pipe 390.56

3.84 below O.G.