

11/6/78
11/8/78

app - 11-878
D

PERMIT

P 28158

A Repair

SEWAGE DISPOSAL SYSTEM

MARYLAND STATE DEPARTMENT OF HEALTH*

HOWARD COUNTY

04-324080

ELLCOTT CITY

DISTRICT 4th

DATE 6/7/78

INDEXED

Herman Sirk IS PERMITTED TO INSTALL _____ ALTER X

ADDRESS 2555 Jennings Chapel Road, Woodbine, Md. PHONE 489-4724

SUBDIVISION _____ ROAD 3420 Hipsley Mill Road LOT _____

PROPERTY OWNER Elmer Muth

ADDRESS 3420 Hipsley Mill Road

SPECIFICATIONS

807

SEPTIC TANK CAPACITY _____ GALLONS
DRAIN FIELD _____ DEPTH _____ FEET, BOTTOM AREA _____ SQ. FT.
DEEP TRENCH _____ DEPTH _____ FEET, BOTTOM AREA _____ SQ. FT.
SEEPAGE PITS _____ ABSORBENT SIDE-WALL AREA _____ SQ. FT.
INLET PIPE _____ FT. BELOW ORIGINAL GRADE. MAXIMUM DEPTH _____ FT. BELOW ORIGINAL GRADE
EFFECTIVE DEPTH AT _____ FT. BELOW ORIGINAL GRADE.
LOCATE DISPOSAL AREA _____ FT. FROM _____ LOT LINE AND _____ FT. FROM _____ LOT LINE AS SEEN WHEN
FACING LOT FROM

REPAIR - Call for an appointment when ground is opened up and Sanitarian will
recommend repair system.

PLANS APPROVED BY Palmer F. Wine DATE 6/7/78

COVER NO WORK UNTIL INSPECTED AND APPROVED.

NEITHER THE HOWARD COUNTY COUNCIL NOR THE HEALTH DEPARTMENT IS RESPONSIBLE FOR THE SUCCESSFUL OPERATION OF ANY SYSTEM.

NOTE: IF TRENCH IS USED CALL FOR INSPECTION BEFORE PLACING GRAVEL IN TRENCH.

NOTE: NO DRY WELL SHALL EXCEED 15 FOOT IN DIAMETER.

NOTE: ALL PIPE FROM HOUSE TO DISPOSAL AREA MUST BE CAST IRON.

PERMIT VOID AFTER THREE YEARS.

NOTE: INSTALL STAND PIPE ON SEPTIC TANK AND DRY WELL. STAND PIPES MUST BE 6 INCHES IN DIAMETER. CAST IRON, CONCRETE OR TERRA
COTTA ACCEPTED.

***INSTALLER IS RESPONSIBLE FOR OBTAINING FINAL APPROVAL ON THIS PERMIT.**

P 28158

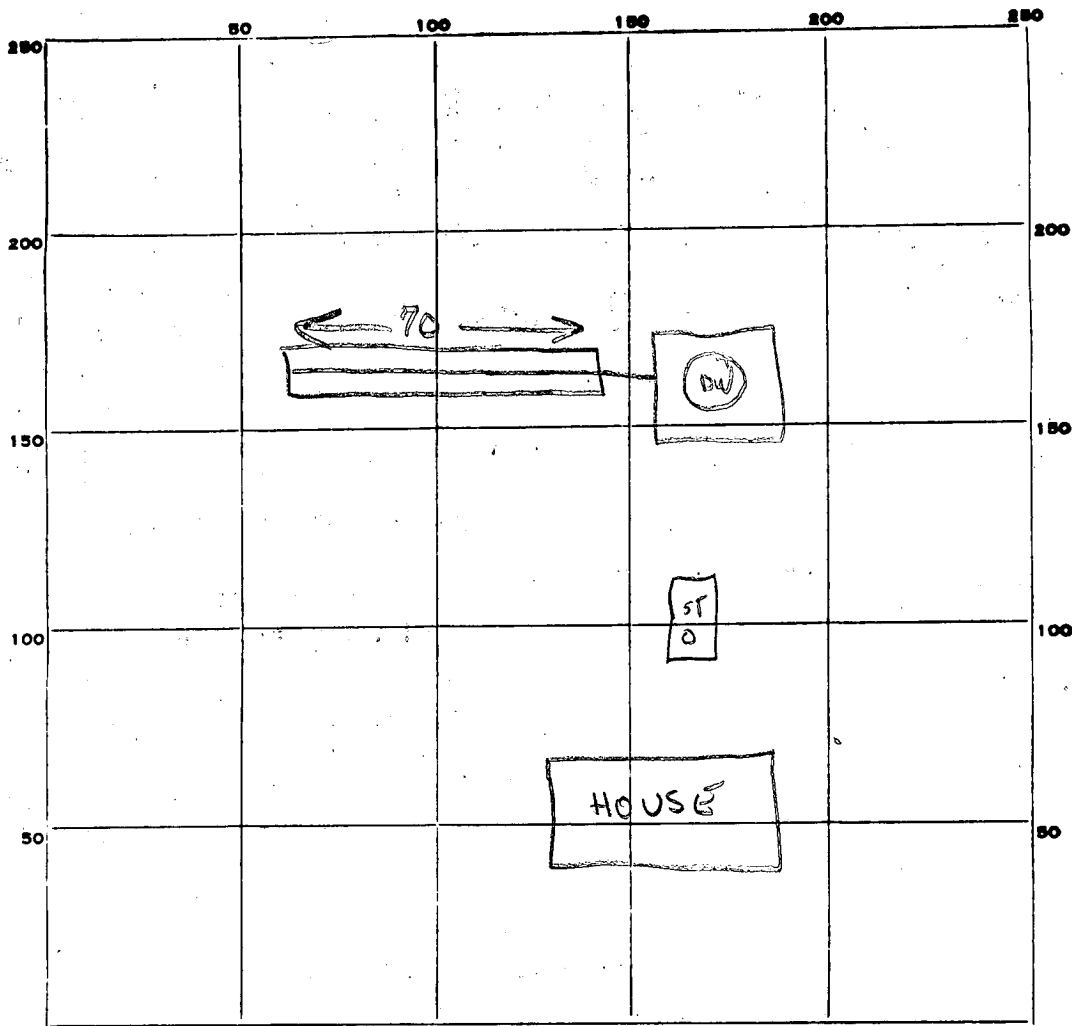

INDICATE NORTH. - NAME ADJOINING ROADWAY AS BASE LINE.

HIPSLEY'S MILL ROAD

PERMIT CARD

SEPTIC TANK, LEVEL _____

CLEANOUTS _____

DISTRIBUTION BOX, LEVEL _____

TILE FIELD, DEPTH 12 FT. TRENCH WIDTH 2 FT.

GRAVEL DEPTH _____ ~~IN~~ TOTAL LENGTH 70 FT.

NUMBER OF TRENCHES _____ TOTAL BOTTOM AREA 1/2 SW

SEEPAGE PITS, INSIDE DIAMETER _____ FT. DEPTH BELOW INLET _____ FT.

ABSORBENT AREA _____ SQ. FT.

REMARKS 6 Nov 78 - Call for final when 7' of stone is added to trench. (GLK)

DATE SYSTEM APPROVED 11/8/78

INSPECTOR W. Monaghan