

6/2/78
12:30 P.M.
6/12/78 - app'd F.S.

05-360021

PERMIT

P 28115
A Repair

SEWAGE DISPOSAL SYSTEM
MARYLAND STATE DEPARTMENT OF HEALTH*

HOWARD COUNTY

INDEXED

ELLICOTT CITY

DISTRICT 5th

DATE 5/31/78

System to have an 80 ft trench
12" x 14" x 2 ft deep invert at 6', 6 ft of stone
RAB June 2 '78
Theodore & Agnes Meyer

IS PERMITTED TO INSTALL _____ ALTER

ADDRESS _____ PHONE _____

SUBDIVISION _____ ROAD 11909 Hall Shop Road LOT _____

PROPERTY OWNER Agnes Meyer

ADDRESS 11909 Hall Shop Road, Clarksville, Md. 21029 Phone: 988-9271

SPECIFICATIONS
SEPTIC TANK CAPACITY _____ GALLONS
DRAIN FIELD _____ DEPTH _____ FEET, BOTTOM AREA _____ SQ. FT.
DEEP TRENCH _____ DEPTH _____ FEET, BOTTOM AREA _____ SQ. FT.
SEEPAGE PITS _____ ABSORBENT SIDE-WALL AREA _____ SQ. FT.
INLET PIPE _____ FT. BELOW ORIGINAL GRADE. MAXIMUM DEPTH _____ FT. BELOW ORIGINAL GRADE
EFFECTIVE DEPTH AT _____ FT. BELOW ORIGINAL GRADE.
LOCATE DISPOSAL AREA _____ FT. FROM _____ LOT LINE AND _____ FT. FROM _____ LOT LINE AS SEEN WHEN FACING LOT FROM

REPAIR - Call for an appointment when ground is opened up and Sanitarian will recommend repair system.

PLANS APPROVED BY Palmer F. Wine DATE 5/31/78

COVER NO WORK UNTIL INSPECTED AND APPROVED.

NEITHER THE HOWARD COUNTY COUNCIL NOR THE HEALTH DEPARTMENT IS RESPONSIBLE FOR THE SUCCESSFUL OPERATION OF ANY SYSTEM.

- NOTE: IF TRENCH IS USED CALL FOR INSPECTION BEFORE PLACING GRAVEL IN TRENCH.
- NOTE: NO DRY WELL SHALL EXCEED 15 FOOT IN DIAMETER.
- NOTE: ALL PIPE FROM HOUSE TO DISPOSAL AREA MUST BE CAST IRON.
- PERMIT VOID AFTER THREE YEARS.
- NOTE: INSTALL STAND PIPE ON SEPTIC TANK AND DRY WELL. STAND PIPES MUST BE 6 INCHES IN DIAMETER. CAST IRON, CONCRETE OR TERRAZO ACCEPTED.

BLDG. PERMIT SIGNED AND RETURNED
5/31/78
Serial # 50111
F.P.M.

*INSTALLER IS RESPONSIBLE FOR OBTAINING FINAL APPROVAL ON THIS PERMIT.

28115

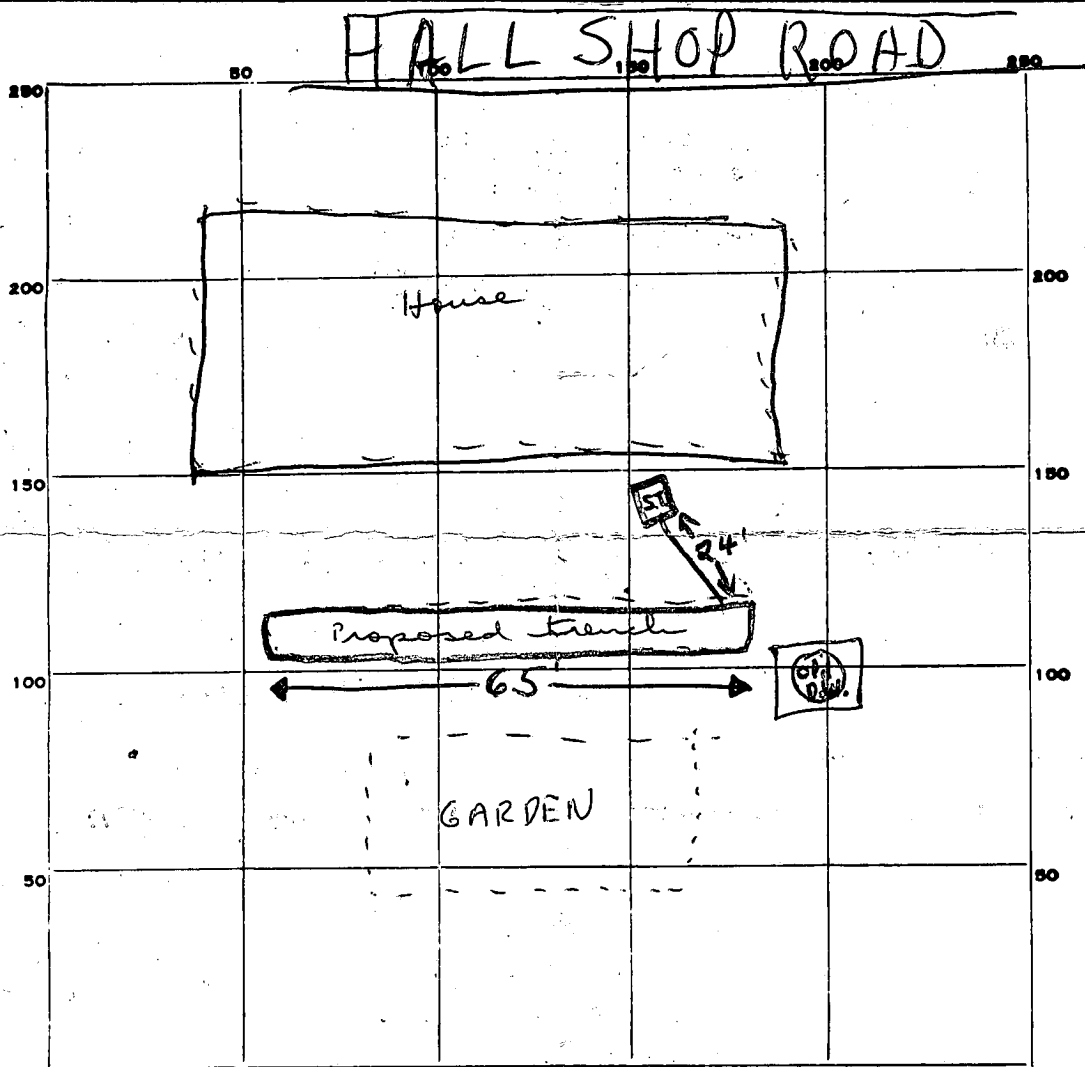

INDICATE NORTH - NAME ADJOINING ROADWAY AS BASE LINE.

PERMIT CARD signed final O.K. F.S.

SEPTIC TANK, LEVEL existing CLEANOUTS existing | n.a.

DISTRIBUTION BOX, LEVEL n.a.

TILE FIELD, DEPTH 12-14 FT. TRENCH WIDTH 2 FT.

GRAVEL DEPTH ~7-8 FT. TOTAL LENGTH 65 FT.

NUMBER OF TRENCHES 1 1/2 SIDEWALL TOTAL BOTTOM AREA ±390 sq. ft.

SEEPAGE PITS, INSIDE DIAMETER — FT. DEPTH BELOW INLET — FT.

ABSORBENT AREA ±390 SQ. FT.

REMARKS 6/12/78 Septic system repaired by Howard Edwards; spoke to Mrs Meyer; see attached sheet O.K. & per D.W.M., F.S.

DATE SYSTEM APPROVED 6/12/78 INSPECTOR Frank Skinner

Accomplished Trench:

65 feet long

12 to 14 feet deep

Stone filled in hole to level 6 ft. perforated pipe
laid level stone on top of pipe paper on top of stone.
Bypassed old dry well.

Required Trench:

60 ft. long

12 ft. deep

6 ft. stone

perforated pipe

Mrs. Theodore L. Meyer

192.06'

LOT AREA
43,586 SQ. FT.

42'

249.09'

113'

32' POOL

DRAIN FIELD
INSTALLED 1978

51'

16'

2'

OLD DRY WELL

COLLAPSED
SEALED - BACK FILLED
WITH DIRT

13'

SEPTIC TANK

47'

HOUSE

FRONT

NORTH

30'

60'

244-79'

175.74

NO OVERFLOW SEEN.
LOCATION OK.

CW & RH 7-7-82