

5/19/78
around 12:30 p.m.

PERMIT

P 28063
A Repeal

SEWAGE DISPOSAL SYSTEM

MARYLAND STATE DEPARTMENT OF HEALTH*

HOWARD COUNTY

05-353882

ELLICOTT CITY

DISTRICT 5th

DATE 5/18/78

INDEXED

Jenkins Bros. IS PERMITTED TO INSTALL ALTER X

ADDRESS _____ PHONE _____

SUBDIVISION _____ ROAD 7173 Mink Hollow Rd. LOT _____

PROPERTY OWNER Holt

ADDRESS 7173 Mink Hollow Rd.

SPECIFICATIONS

SEPTIC TANK CAPACITY _____ GALLONS

DRAIN FIELD _____ DEPTH _____ FEET, BOTTOM AREA _____ SQ. FT.

DEEP TRENCH _____ DEPTH _____ FEET, BOTTOM AREA _____ SQ. FT.

SEEPAGE PITS _____ ABSORBENT SIDE-WALL AREA _____ SQ. FT.

INLET PIPE _____ FT. BELOW ORIGINAL GRADE. MAXIMUM DEPTH _____ FT. BELOW ORIGINAL GRADE

EFFECTIVE DEPTH AT _____ FT. BELOW ORIGINAL GRADE.

LOCATE DISPOSAL AREA _____ FT. FROM _____ LOT LINE AND _____ FT. FROM _____ LOT LINE AS SEEN WHEN FACING LOT FROM

Deep ditch 60 ft. long, 2 ft. wide, 10 ft. deep filled with 6ft. of stone. Place the ditch about 80 ft. behind the house. Start the ditch off the lower dry well. Two inspections of the ditch needed.

PLANS APPROVED BY R. H Odges DATE 5/18/78

COVER NO WORK UNTIL INSPECTED AND APPROVED.

NEITHER THE HOWARD COUNTY COUNCIL NOR THE HEALTH DEPARTMENT IS RESPONSIBLE FOR THE SUCCESSFUL OPERATION OF ANY SYSTEM.

NOTE: IF TRENCH IS USED CALL FOR INSPECTION BEFORE PLACING GRAVEL IN TRENCH.

NOTE: NO DRY WELL SHALL EXCEED 15 FOOT IN DIAMETER.

NOTE: ALL PIPE FROM HOUSE TO DISPOSAL AREA MUST BE CAST IRON.

PERMIT VOID AFTER THREE YEARS.

NOTE: INSTALL STAND PIPE ON SEPTIC TANK AND DRY WELL. STAND PIPES MUST BE 6 INCHES IN DIAMETER. CAST IRON, CONCRETE OR TERRA COTTA ACCEPTED.

***INSTALLER IS RESPONSIBLE FOR OBTAINING FINAL APPROVAL ON THIS PERMIT.**

P28063

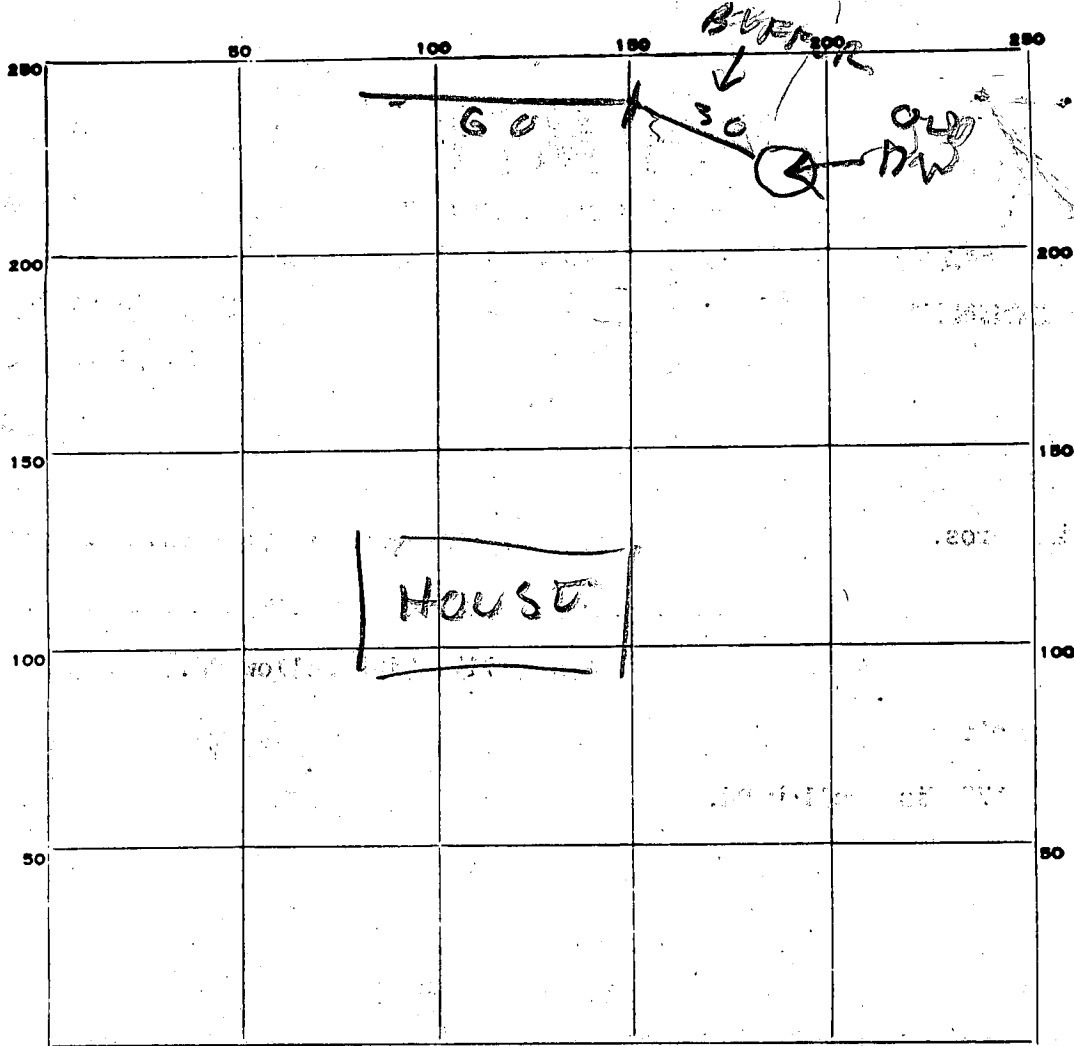

INDICATE NORTH. - NAME ADJOINING ROADWAY AS BASE LINE.

PERMIT CARD _____

SEPTIC TANK, LEVEL _____

CLEANOUTS _____

DISTRIBUTION BOX, LEVEL _____

TILE FIELD, DEPTH 10 FT FT. TRENCH WIDTH 2 1/2 FT.

GRAVEL DEPTH 7 FT IN. TOTAL LENGTH 60 FT.

NUMBER OF TRENCHES 1 TOTAL BOTTOM AREA 420

SEEPAGE PITS, INSIDE DIAMETER _____ FT. DEPTH BELOW INLET _____ FT.

ABSORBENT AREA _____ SQ. FT.

REMARKS 5/19/78 - OWNER INSPECTED DITCH
BEFORE STONE & PIPE PUT IN RIT

DATE SYSTEM APPROVED 5/19/78

INSPECTOR

Raymond Hodges

5/18/78
1:30 p.m.
Repair

APPLICATION

A Repair

SEWAGE DISPOSAL TESTING

STATE OF MARYLAND - DEPARTMENT OF HEALTH AND MENTAL HYGIENE

HOWARD COUNTY HEALTH DEPARTMENT
ENVIRONMENTAL HEALTH SERVICES
P. O. BOX 476, ELLICOTT CITY, MARYLAND 21043
TELEPHONE: 465-5000, EXT. 356

DISTRICT _____

DATE _____

DEEP DITCH 60 FT LONG 2 FT WIDE
10 FT DEEP FILLED WITH 6 FT OF STONE
PLACED DITCH ABOUT 80 FT BEHIND
THE HOUSE START THE DITCH OFF
TO THE LOWER DRY WELL

ELLICOTT CITY, MARYLAND TWO INSPECTIONS OF DITCH
I, HEREBY, APPLY FOR THE NECESSARY TEST IN ORDER TO CONSTRUCT (OR RECONSTRUCT) A SEWAGE
DISPOSAL SYSTEM. **NEEDED**

PROPERTY OWNER Holt
ADDRESS 2173 Mink Hollow Rd. PHONE 286 2475

PROPERTY LOCATION:
SUBDIVISION _____ LOT NO. _____

ROAD AND DESCRIPTION off Rt. 216 on Mink Hollow Rd. -
go down road - see a backhoe on left hand side

SIZE OF LOT _____ TYPE BLDG 3 BEDROOMS
IF NOT SINGLE RESIDENCE DESCRIBE 4 DEN ON

THE SYSTEM INSTALLED UNDER THIS APPLICATION IS ACCEPTABLE ONLY UNTIL PUBLIC FACILITIES BECOME AVAILABLE.

SIGNATURE OF APPLICANT _____
APPROVED BY Raymond Hodges FOR DITCH DATE 5/18/78
(KIND OF SYSTEM)

REJECTED BY _____ FOR _____ DATE _____
(KIND OF SYSTEM)

HOLD PENDING FURTHER TESTS _____ DATE _____

REASONS FOR REJECTION OR HOLDING _____

THIS IS NOT A PERMIT

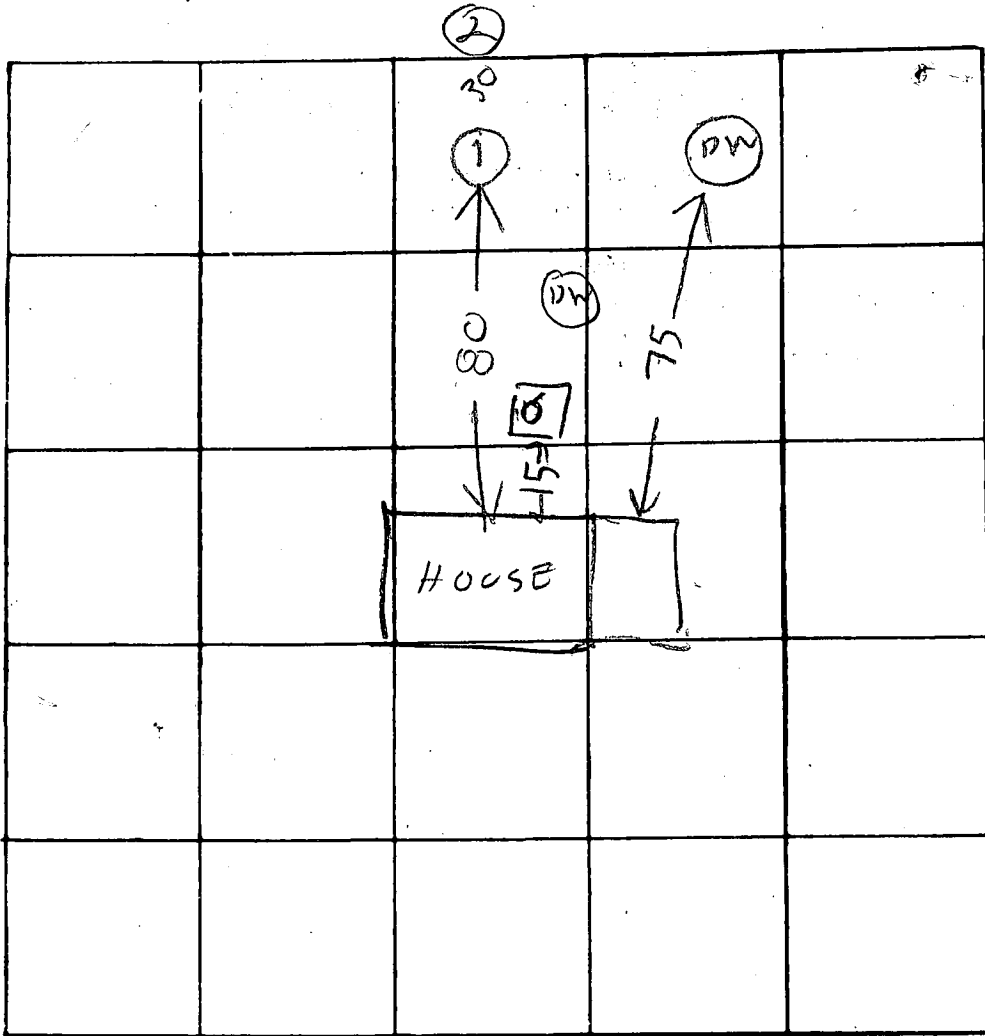

2260

| DATE | TEST NO. | DEPTH | PRE-WET | | TEST - 1" DROP | | TIME |
|---------|----------|-------|---------|------|----------------|------|------|
| | | | START | STOP | START | STOP | |
| 5/19/70 | ① | 10 | TOP | 4 FT | CLAY | | |
| | | | 13 FT | 6 FT | SANDY | DRY | |
| 3:30 PM | 2 | 10 | TOP | | | | |
| | | | | | | | |
| | | | | | | | |
| | | | | | | | |
| | | | | | | | |
| | | | | | | | |
| | | | | | | | |
| | | | | | | | |
| | | | | | | | |
| | | | | | | | |

80
6/480
80
00
60
6/360

REMARKS AT 3:30 PM DIGGER HIT ROCK & COULD NOT DIG 80 FT LONG DITCH OK TO DIG NEAR TEST HOLE ②

TYPE OF SOIL _____

TESTED BY B. HODGES

ALSO PRESENT: J. JENKINS CO BACKHOE
2 JIM HOLT OWNER