

*5/19/78*  
*1:30 P.M.*  
*5/23/78 - after lunch please*

# PERMIT

P 28054  
A REPAIR

SEWAGE DISPOSAL SYSTEM  
MARYLAND STATE DEPARTMENT OF HEALTH\*

HOWARD COUNTY

ELLICOTT CITY

DISTRICT \_\_\_\_\_

**INDEXED**

DATE 5/17/78

Earthworm Enterprises-C. Spengler IS PERMITTED TO INSTALL ALTER

ADDRESS 9829 Town & Country Blvd., Apt. F. PHONE \_\_\_\_\_

SUBDIVISION \_\_\_\_\_ ROAD \_\_\_\_\_ LOT 71

PROPERTY OWNER Cecil Gordon

ADDRESS 10824 Hill Top Lane, Columbia, Md. 21044

SPECIFICATIONS

SEPTIC TANK CAPACITY \_\_\_\_\_ GALLONS  
DRAIN FIELD \_\_\_\_\_ DEPTH \_\_\_\_\_ FEET, BOTTOM AREA \_\_\_\_\_ SQ. FT.  
DEEP TRENCH \_\_\_\_\_ DEPTH \_\_\_\_\_ FEET, BOTTOM AREA \_\_\_\_\_ SQ. FT.  
SEEPAGE PITS \_\_\_\_\_ ABSORBENT SIDE-WALL AREA \_\_\_\_\_ SQ. FT.  
INLET PIPE \_\_\_\_\_ FT. BELOW ORIGINAL GRADE. MAXIMUM DEPTH \_\_\_\_\_ FT. BELOW ORIGINAL GRADE  
EFFECTIVE DEPTH AT \_\_\_\_\_ FT. BELOW ORIGINAL GRADE.  
LOCATE DISPOSAL AREA \_\_\_\_\_ FT. FROM \_\_\_\_\_ LOT LINE AND \_\_\_\_\_ FT. FROM \_\_\_\_\_ LOT LINE AS SEEN WHEN FACING LOT FROM

REPAIR-CALL FOR APPOINTMENT WHEN GROUND IS OPENED UP SO SANITARIAN CAN RECOMMEND

REPAIR. Trench - 70' long 11' deep - gravel from 4' -> 11'  
O.K. to gravel trench as it is dug F. Skinner

PLANS APPROVED BY F. Skinner DATE 5/19/78

COVER NO WORK UNTIL INSPECTED AND APPROVED.

NEITHER THE HOWARD COUNTY COUNCIL NOR THE HEALTH DEPARTMENT IS RESPONSIBLE FOR THE SUCCESSFUL OPERATION OF ANY SYSTEM.

NOTE: IF TRENCH IS USED CALL FOR INSPECTION BEFORE PLACING GRAVEL IN TRENCH.

NOTE: NO DRY WELL SHALL EXCEED 15 FOOT IN DIAMETER.

NOTE: ALL PIPE FROM HOUSE TO DISPOSAL AREA MUST BE CAST IRON.

PERMIT VOID AFTER THREE YEARS.

NOTE: INSTALL STAND PIPE ON SEPTIC TANK AND DRY WELL. STAND PIPES MUST BE 6 INCHES IN DIAMETER. CAST IRON, CONCRETE OR TERRA COTTA ACCEPTED.

**\*INSTALLER IS RESPONSIBLE FOR OBTAINING FINAL APPROVAL ON THIS PERMIT.**

*P28054*

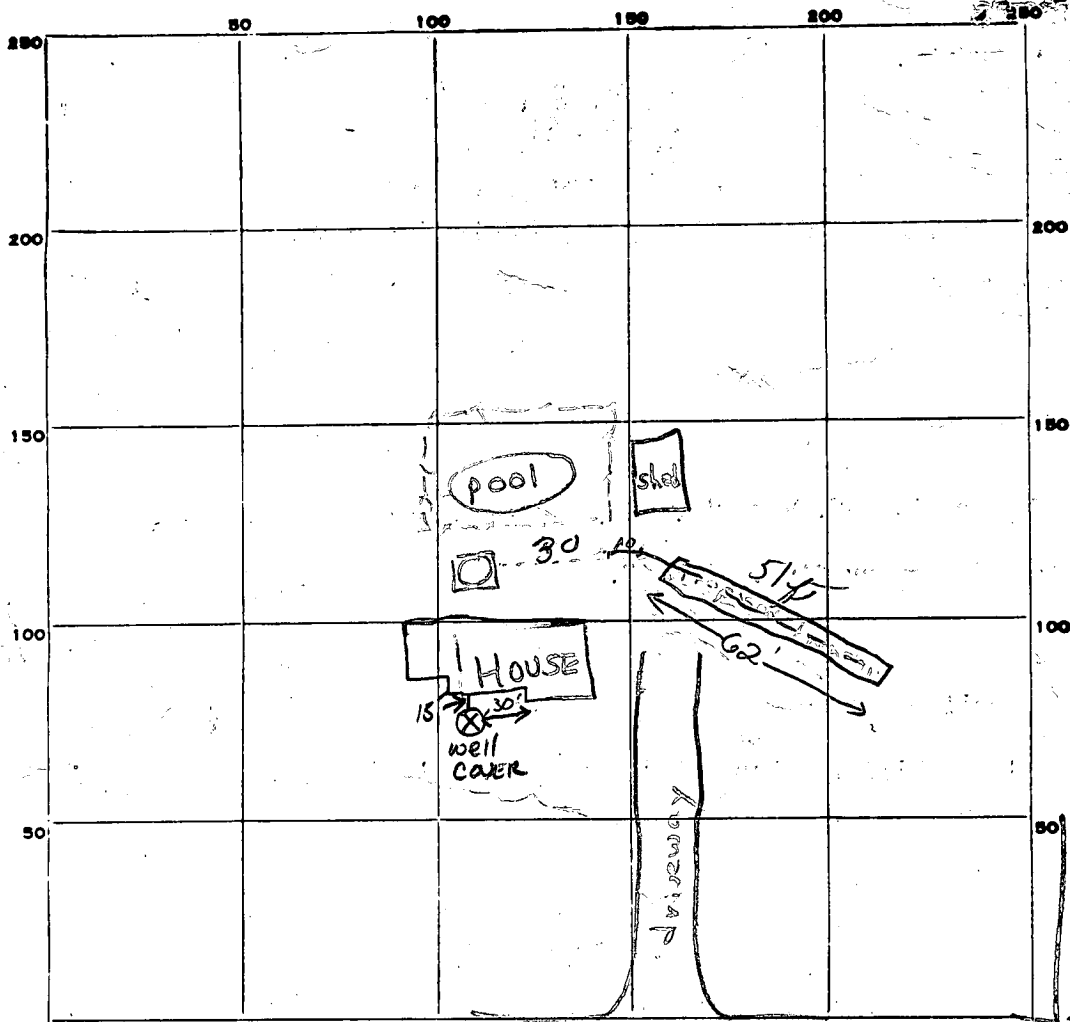

INDICATE NORTH. - NAME ADJOINING ROADWAY AS BASE LINE.

Hill Top Rd.

Cedar Lane

PERMIT CARD \_\_\_\_\_

SEPTIC TANK, LEVEL n.a

CLEANOUTS n.a

DISTRIBUTION BOX, LEVEL n.a

TILE FIELD, DEPTH 11 FT. TRENCH WIDTH 2 FT.

GRAVEL DEPTH 7 1/2 → 8 FT. TOTAL LENGTH 62 FT.

NUMBER OF TRENCHES 1  $\frac{1}{2}$  SIDEWALL TOTAL BOTTOM AREA 465 1/2

SEEPAGE PITS, INSIDE DIAMETER \_\_\_\_\_ FT. DEPTH BELOW INLET 7 1/2 FT.

ABSORBENT AREA ±465 SQ. FT.

REMARKS 5/19/78 O.K to gravel trenches it is dug, owner will verify depth 7.5  
5/22/78 extend trench to 60 ft length ✓  
5/23/78 O.K to cover all work T.S.

DATE SYSTEM APPROVED 5/23/78

INSPECTOR Frank Skinner

APPROX. AREA OF ST/DW/TRENCH LOCATED - HIGH GRASS IN AREA OF ST/TRENCH → NO C/O LOCATED; DW LOCATED - AREA SETTLED W/ HIGH GRASS, PART OF TRENCH IS LOCATED ON ADJACENT LOT WHICH IS BEING SOLD BY DIVERSIFIED HOMES. UNABLE TO DETERMINE IF SYSTEM IS FUNCTIONING - WATER OFF AND HOUSE UNOCCUPIED FOR 1-2 MONTHS.

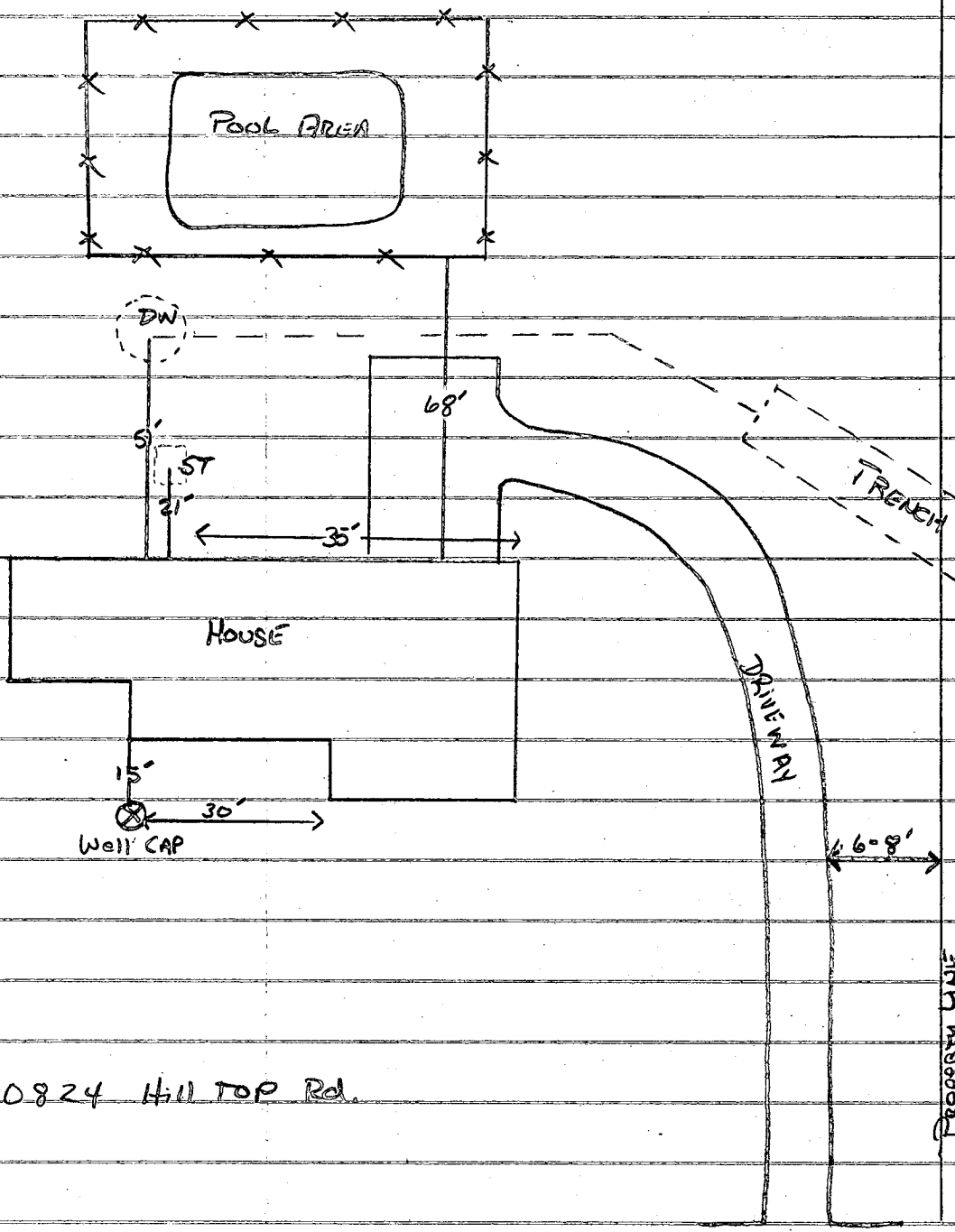

10824 Hill Top Rd.

HILL TOP Rd.