

HOUSE CONNECTION ~~12/24/78~~  
needed ~~10/30/78~~  
7 MAR 79

5/1/79 ✓  
house connections

# PERMIT

File  
P 29083  
A 28790

12/21/78  
System ~~1st~~

SEWAGE DISPOSAL SYSTEM  
MARYLAND STATE DEPARTMENT OF HEALTH\*

HOWARD COUNTY  
WELL # HO-73-2991  
EAST ROAD

03-298 413

ELLICOTT CITY  
DISTRICT 4th  
DATE 10/10/78

## INDEXED

Jack Fyock IS PERMITTED TO INSTALL  ALTER

ADDRESS 13775 Triadelphia Road, Glenelg, Md. PHONE 988-9270

SUBDIVISION \_\_\_\_\_ ROAD 13550 Old Frederick Road LOT \_\_\_\_\_

PROPERTY OWNER James H. Welling

ADDRESS 13550 Old Frederick Road, Sykesville, Md. 21784 Phone: 489-4102

SPECIFICATIONS 3 bedrooms

SEPTIC TANK CAPACITY 1000 GALLONS

DRAIN FIELD \_\_\_\_\_ DEPTH \_\_\_\_\_ FEET, BOTTOM AREA \_\_\_\_\_ SQ. FT.

DEEP TRENCH \_\_\_\_\_ DEPTH \_\_\_\_\_ FEET, BOTTOM AREA \_\_\_\_\_ SQ. FT.

SEEPAGE PITS  ABSORBENT SIDE-WALL AREA 150 SQ. FT. sidewall area per bedroom.

INLET PIPE 4 FT. BELOW ORIGINAL GRADE. MAXIMUM DEPTH 11 FT. BELOW ORIGINAL GRADE

EFFECTIVE DEPTH AT \_\_\_\_\_ FT. BELOW ORIGINAL GRADE.

LOCATE DISPOSAL AREA 85 FT. FROM Old Frederick Road LOT LINE AND 100 FT. FROM left LOT LINE AS SEEN WHEN

FACING LOT FROM Old Frederick Road. (Use hole that is plus .54 elevation as shown on plat; hole 2 on perc data.)

4H12

~~2-40 trenches - same depths & location~~  
~~inspect before gravel installed Fyock - change to original specs.~~

PLANS APPROVED BY James H. Stayer & Donald W. Monaghan DATE 10/10/78

COVER NO WORK UNTIL INSPECTED AND APPROVED.

NEITHER THE HOWARD COUNTY COUNCIL NOR THE HEALTH DEPARTMENT IS RESPONSIBLE FOR THE SUCCESSFUL OPERATION OF ANY SYSTEM.

NOTE: IF TRENCH IS USED CALL FOR INSPECTION BEFORE PLACING GRAVEL IN TRENCH.

NOTE: NO DRY WELL SHALL EXCEED 15 FOOT IN DIAMETER.

NOTE: ALL PIPE FROM HOUSE TO DISPOSAL AREA MUST BE CAST IRON.

PERMIT VOID AFTER THREE YEARS.

NOTE: INSTALL STAND PIPE ON SEPTIC TANK AND DRY WELL. STAND PIPES MUST BE 6 INCHES IN DIAMETER. CAST IRON, CONCRETE OR TERRA COTTA ACCEPTED.

BLDG. PERMIT SIGNED tenant house  
AND RETURNED 11/13/78  
serial # 37788

\*INSTALLER IS RESPONSIBLE FOR OBTAINING FINAL APPROVAL ON THIS PERMIT.

A 28790

49  
6  
294  
25  
319  
84  
25  
24  
49  
403

12  
x 17  
34  
154  
319  
173

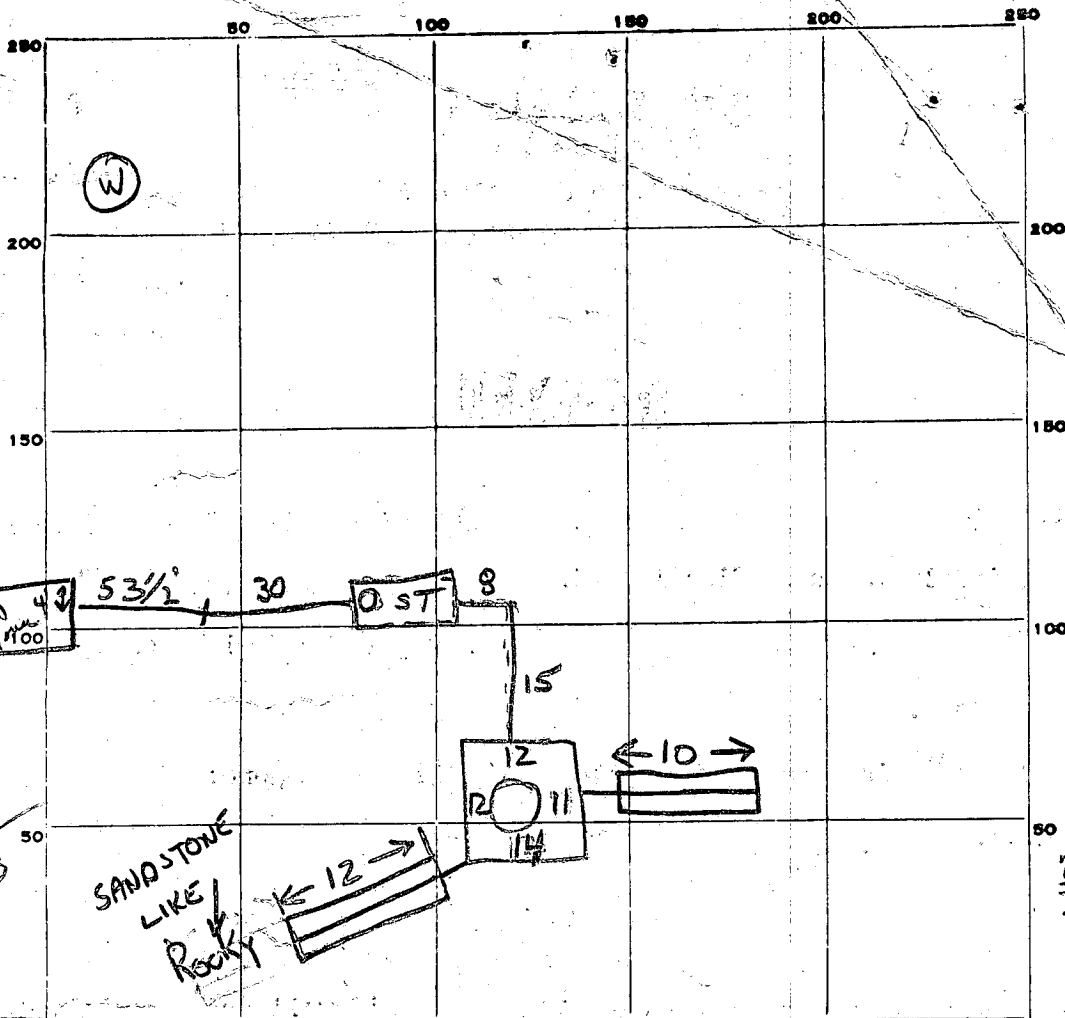

7 MAR 79 Welling stated he will call when house connection is made. (GLK)

INDICATE NORTH. - NAME ADJOINING ROADWAY AS BASE LINE.

OLD FREDERICK RD.

PERMIT CARD  New cap left c.B. ST/DW  
 SEPTIC TANK, LEVEL  CLEANOUTS  terra cotta  
 DISTRIBUTION BOX, LEVEL

TILE FIELD, DEPTH 11 FT. TRENCH WIDTH \_\_\_\_\_ FT.  
 GRAVEL DEPTH 7 FT. TOTAL LENGTH 22 FT.  
 NUMBER OF TRENCHES 1 TOTAL <sup>1/2 SW</sup> BOTTOM AREA 154  
 SEEPAGE PITS, INSIDE DIAMETER 49 FT. DEPTH BELOW INLET 6 1/2 FT. 154  
 ABSORBENT AREA ± 473 SQ. FT. 319  
 73

REMARKS 27 Oct 78 - short on area - need to extend trench 10'. (GLK)  
 OK for gravel in 1st trench (GLK)  
 27 Oct 78 - OK for gravel in 2nd trench. Call when house connection installed. (GLK)  
 27 Oct 78 - OK to cover system. Call when house connection installed. (GLK) ✓ 5/1/79 c.B.  
 10 Nov 79 - Welling stated foundations poured. no plumbing - unable to predict completion (GLK)  
 DATE SYSTEM APPROVED 5/1/79 as per above INSPECTOR C.B. Streeker

02598 SEQUENCE NO. (DWR USE ONLY)

STATE OF MARYLAND DEPARTMENT OF WATER RESOURCES STATE OFFICE BLDG., ANNAPOLIS, MARYLAND 21401 WELL COMPLETION REPORT

THIS REPORT MUST BE SUBMITTED WITHIN 30 DAYS AFTER WELL COMPLETION. FILL IN THIS FORM COMPLETELY. COUNTY NUMBER 2978

DATE WELL COMPLETED 6-26-72 DEPTH OF WELL 80

PERMIT NO. FROM "PERMIT TO DRILL WELL" 40-72-0250

OWNER Wellington LAST NAME STREET OR RFD 13550 Old Frederick Rd POST OFFICE

DRILLERS IDENTIFICATION NO. 42

WELL LOG table with columns: DESCRIPTION, FEET (FROM, TO), CHECK IF WATER BEARING. Includes handwritten entries for Asphalt, Gravel, and Sandstone.

WELL DESCRIPTION section including GROUTING RECORD, CASING RECORD, SCREEN RECORD, and OTHER CASING.

PUMPING TEST section including hours pumped, pumping rate, water level, and pump installed details.

CIRCLE APPROPRIATE BOXES section with checkboxes for well status, electric log, and test well conversion.

DIAMETER OF SCREEN, GRAVEL PACK, and IF WELL DRILLED WAS A FLOWING WELL CIRCLE BOX section.

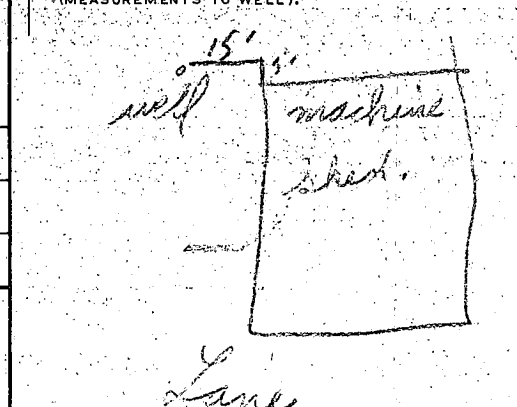





RECEIVED

SEP 29 11 02 AM '78

HOWARD COUNTY  
HEALTH DEPT.  
ELICOTT CITY, MD.

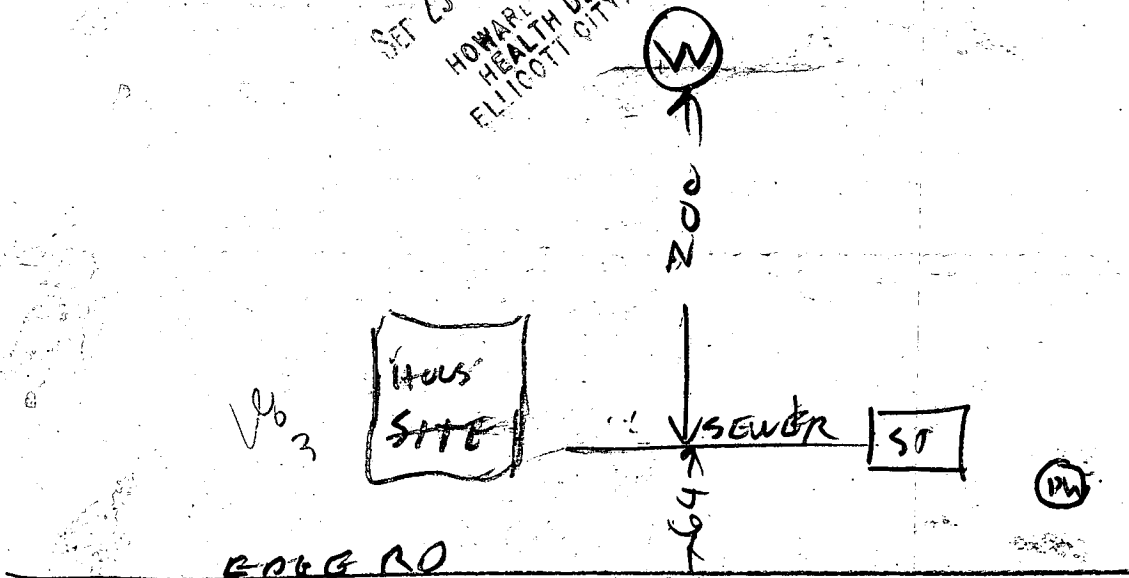

11, 178

- ① LOCATION OK
- ② 26 FT CASING WITH 2 FT OUT OF GROUND
- ③ 21 FT OPEN HOLE MEASURED WITH A STRING
- ④ 5 BAGS
- ⑤ WELL OK

R HODGES

CALL ZONING - SET OK.

Recorded

# APPLICATION

A 28790

SEWAGE DISPOSAL TESTING

STATE OF MARYLAND - DEPARTMENT OF HEALTH AND MENTAL HYGIENE

P \_\_\_\_\_

HOWARD COUNTY HEALTH DEPARTMENT  
ENVIRONMENTAL HEALTH SERVICES  
P.O. BOX 476 ELLICOTT, MARYLAND 21043  
TELEPHONE: 992-2330

*Septic Tank - 3 bedrooms - 1000 gal*

DISTRICT 4th

DATE 9/1/78

*Dry Well - 150 ft <sup>per bedroom</sup> absorbent sidewall area  
to be dug below the first 4 ft of original grade. Max depth permitted  
for DW is 11 ft below orig. grade.*

*Locate Dry Well about 85' from Old Fred. Rd and about  
100 ft from left prop line as seen when facing lot from  
Old Fred Rd (use hole that is +.54 elevation  
on show on plat  
hole 2 on prev date*

TO: THE COUNTY HEALTH OFFICER  
ELLICOTT CITY, MARYLAND

I HEREBY APPLY FOR THE NECESSARY TEST IN ORDER TO CONSTRUCT (OR RECONSTRUCT) A SEWAGE DISPOSAL SYSTEM.

PROPERTY OWNER James H. Welling

ADDRESS 13550 Old Frederick Road; Sykesville, Md. 21784 PHONE 489-4102

PROPERTY LOCATION:

SUBDIVISION \_\_\_\_\_ LOT NO. \_\_\_\_\_

ROAD AND DESCRIPTION 13550 Old Frederick Road

SIZE OF LOT 122 acres TYPE BLDG. new Tenant House - 3 bedrooms

THE SYSTEM INSTALLED UNDER THIS APPLICATION IS ACCEPTABLE ONLY UNTIL PUBLIC FACILITIES BECOME AVAILABLE.

I FULLY UNDERSTAND THE FEE CONNECTED WITH THE FILING OF THIS PERC TEST APPLICATION IS NON-REFUNDABLE UNDER ANY CIRCUMSTANCES.

SIGNATURE OF APPLICANT James H. Welling

APPROVED BY J. Stayer FOR \_\_\_\_\_ DATE 10/10/78

REJECTED BY \_\_\_\_\_ FOR \_\_\_\_\_ DATE 9/22/78

HOLD PENDING FURTHER TESTS \_\_\_\_\_ DATE \_\_\_\_\_

REASONS FOR REJECTION OR HOLDING ROCK - WATER - PERC AREA TOO SMALL TO  
MOVE HOLES 9/22/78 -

AREA PERC OK - 10/9/78

# THIS IS NOT A PERMIT

SOIL PROFILE

0-3 FT  
CLAY,  
SAND  
3-12 FT  
SAND,  
CLAY,  
SMALL  
STONES

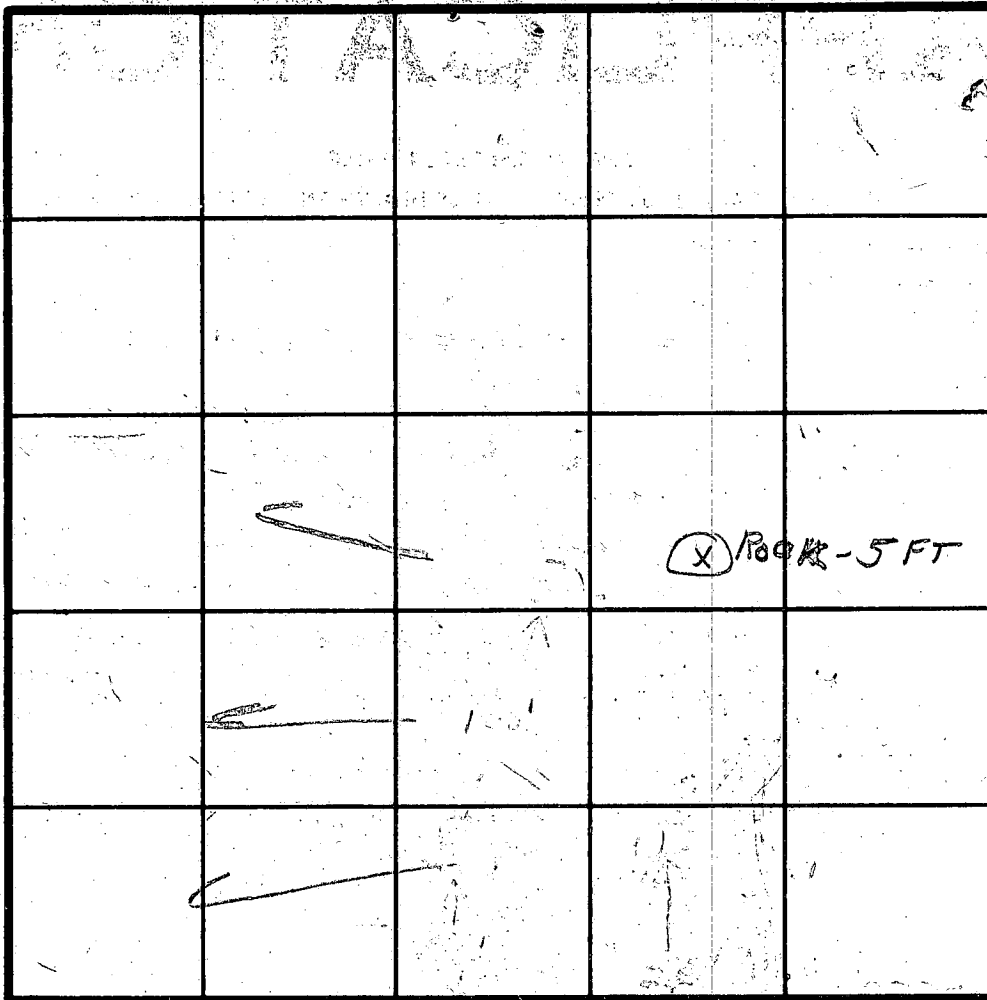

INDICATE NORTH - NAME ADJOINING ROADWAY AS BASE LINE.

OLD FREDRICK RD

DATE	TEST NO.	DEPTH	PRE-WET		TEST - 1" DROP		TIME	
			START	STOP	START	STOP		
10/9/78	1S	4	9:30	9:33	9:33	9:36	3	
	1D	12	9:29	9:32	9:32	9:36	4	
	2S	4	10:05	10:11	10:11	10:20	9	
	2D	12	10:05	10:10	10:10	10:14	4	
	3S	3	10:35	10:46	10:46	11:10	24	
	3D	11	10:35	10:44	10:44	10:55	11	
	(4S)	4	10:54	- FAILED 1ST INCH				
	4D	13	10:54	11:00	11:00	11:06	6'	
	5S	5	11:30	11:35	11:35	11:41	6	

REMARKS SEPTIC FIRST - HOUSE TO BE BUILT UP TO 4 FT LEVEL FOR SYSTEM TO WORK

TYPE OF SOIL \_\_\_\_\_

TESTED BY \_\_\_\_\_

ALSO PRESENT \_\_\_\_\_

MR WELLS

J. H. WELLING PROPERTY

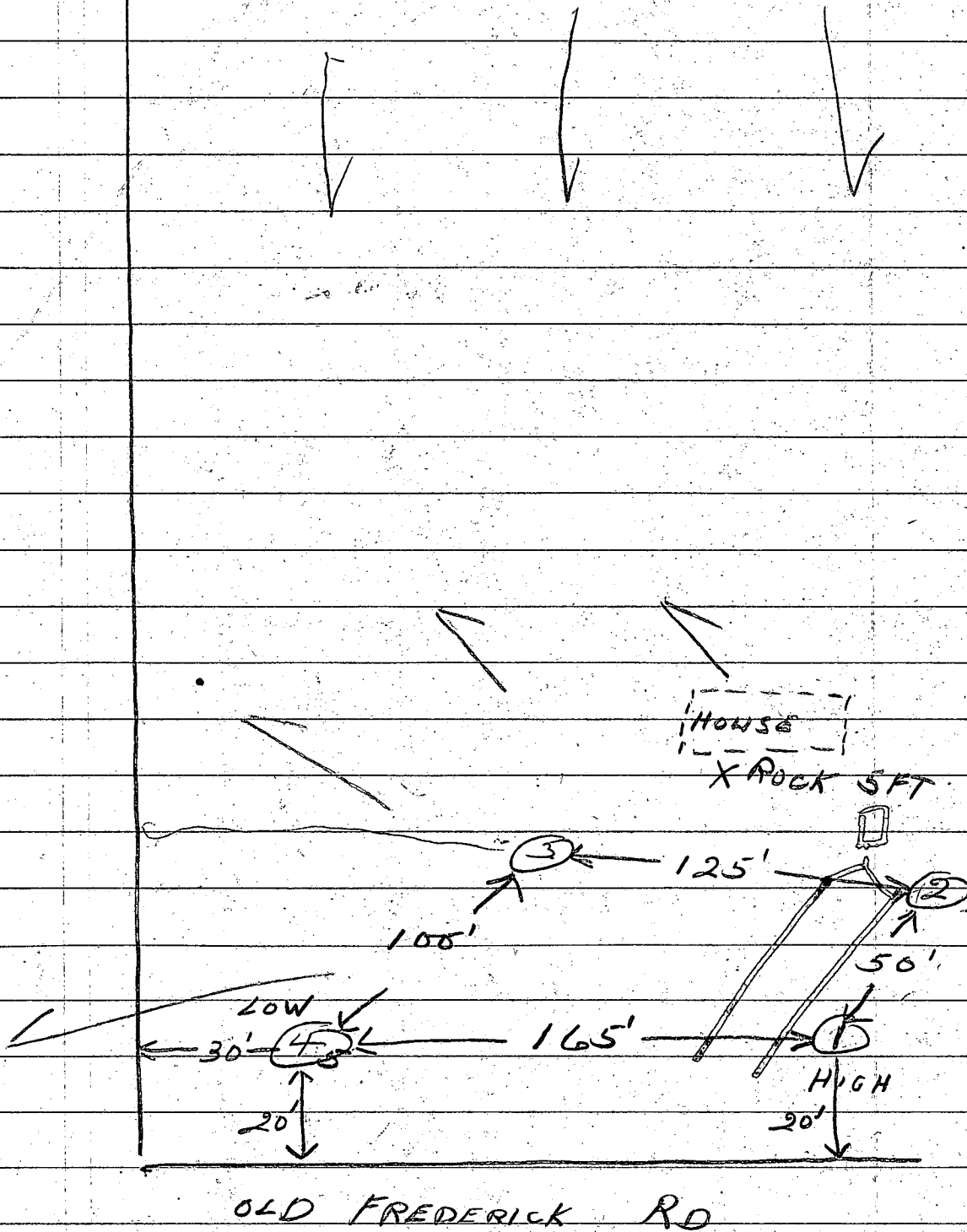

Walker M. Dawson Farm

Wellington Farm



This is to certify the  
Elevation of the Perk  
test holes for our  
tenant house.

10-18-78

*James H. Welling*

