

12/20/77

# PERMIT

P. 27328  
A. Repair

SEWAGE DISPOSAL SYSTEM

MARYLAND STATE DEPARTMENT OF HEALTH\*

HOWARD COUNTY

ELLICOTT CITY

DISTRICT 3rd

**INDEXED**

DATE 12/13/77

03-282899

Howard Edwards IS PERMITTED TO INSTALL ALTER X

ADDRESS 6645 Mink Hollow Road, Highland, Md. 20777 PHONE 596-6309

SUBDIVISION Woodmark ROAD 12225 Fawnhaven Court LOT 33, Blk. B, Sec. 2

PROPERTY OWNER Crompton

ADDRESS \_\_\_\_\_

**SPECIFICATIONS**

SEPTIC TANK CAPACITY \_\_\_\_\_ GALLONS

DRAIN FIELD \_\_\_\_\_ DEPTH \_\_\_\_\_ FEET, BOTTOM AREA \_\_\_\_\_ SQ. FT.

DEEP TRENCH \_\_\_\_\_ DEPTH \_\_\_\_\_ FEET, BOTTOM AREA \_\_\_\_\_ SQ. FT.

SEEPAGE PITS \_\_\_\_\_ ABSORBENT SIDE-WALL AREA \_\_\_\_\_ SQ. FT.

INLET PIPE \_\_\_\_\_ FT. BELOW ORIGINAL GRADE. MAXIMUM DEPTH \_\_\_\_\_ FT. BELOW ORIGINAL GRADE

EFFECTIVE DEPTH AT \_\_\_\_\_ FT. BELOW ORIGINAL GRADE.

LOCATE DISPOSAL AREA \_\_\_\_\_ FT. FROM \_\_\_\_\_ LOT LINE AND \_\_\_\_\_ FT. FROM \_\_\_\_\_ LOT LINE AS SEEN WHEN FACING LOT FROM

Okay to put "T" shaped trench around 50 ft. long 4 to 12 ft. to left of existing dry well.

PLANS APPROVED BY David J. O'Neill DATE 12/13/77

COVER NO WORK UNTIL INSPECTED AND APPROVED.

NEITHER THE HOWARD COUNTY COUNCIL NOR THE HEALTH DEPARTMENT IS RESPONSIBLE FOR THE SUCCESSFUL OPERATION OF ANY SYSTEM.

NOTE: IF TRENCH IS USED CALL FOR INSPECTION BEFORE PLACING GRAVEL IN TRENCH.

NOTE: NO DRY WELL SHALL EXCEED 15 FOOT IN DIAMETER.

NOTE: ALL PIPE FROM HOUSE TO DISPOSAL AREA MUST BE CAST IRON.

PERMIT VOID AFTER THREE YEARS.

NOTE: INSTALL STAND PIPE ON SEPTIC TANK AND DRY WELL. STAND PIPES MUST BE 6 INCHES IN DIAMETER. CAST IRON, CONCRETE OR TERRA COTTA ACCEPTED.

**\*INSTALLER IS RESPONSIBLE FOR OBTAINING FINAL APPROVAL ON THIS PERMIT.**

P 27328

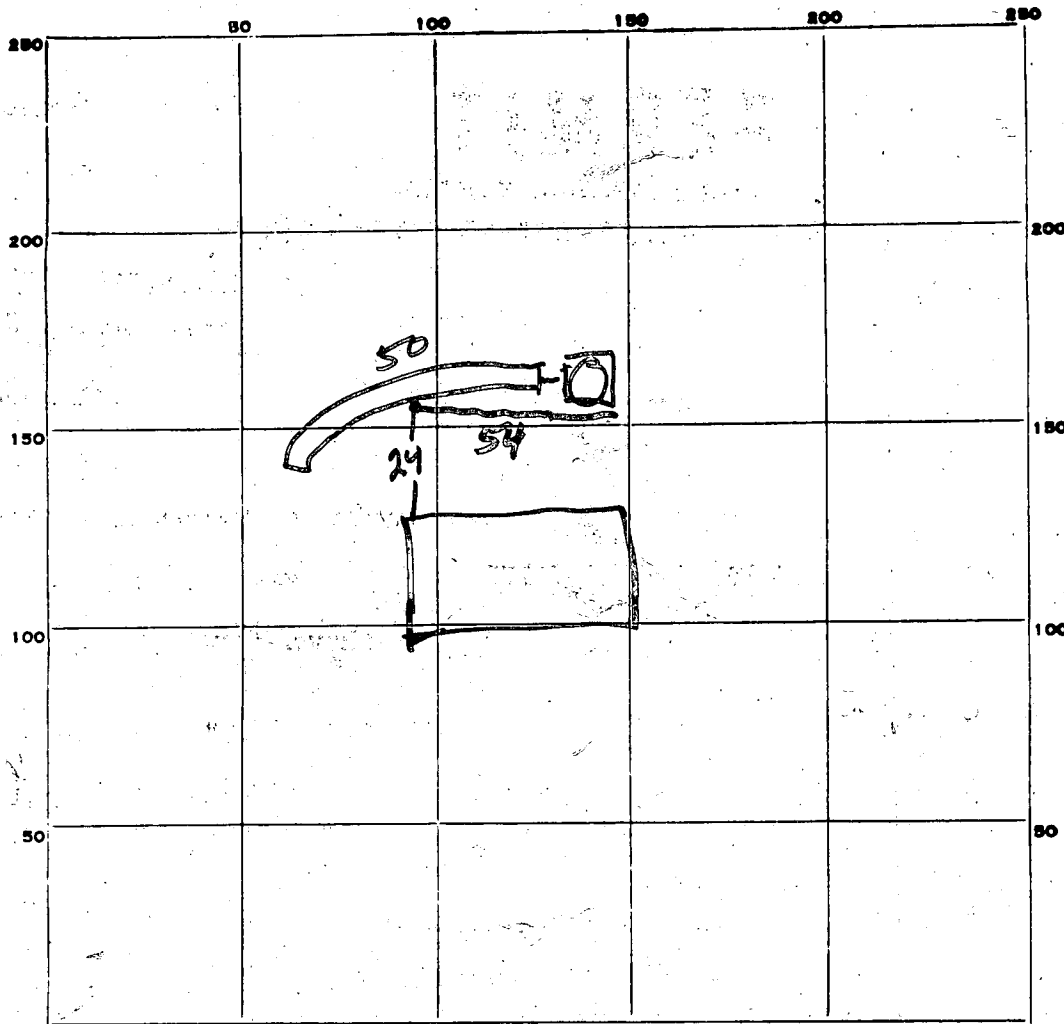

INDICATE NORTH. - NAME ADJOINING ROADWAY AS BASE LINE.

PERMIT CARD NA

SEPTIC TANK, LEVEL NA CLEANOUTS NA

DISTRIBUTION BOX, LEVEL NA

TILE FIELD, DEPTH 13 FT. TRENCH WIDTH 2 FT.

GRAVEL DEPTH 8-9 IN. TOTAL LENGTH 50 FT.

NUMBER OF TRENCHES 1 TOTAL SIDE BOTTOM AREA 400-450 ONE SIDE

SEEPAGE PITS, INSIDE DIAMETER NA FT. DEPTH BELOW INLET NA FT.

ABSORBENT AREA NA SQ. FT.

REMARKS AM add stone to trench call for inspect PAB  
12/20/77 PM - Stone added to Pitel R1

DATE SYSTEM APPROVED 12/20/77 INSPECTOR Raymond Hodges

off 6-4-68  
Sec 7

# PERMIT

SEWAGE DISPOSAL SYSTEM

MARYLAND STATE DEPARTMENT OF HEALTH

HOWARD COUNTY

ELLICOTT CITY

## INDEXED

DISTRICT 3

DATE 4-15-68

P 13520

A 13009

Calvin C. Miles IS PERMITTED TO INSTALL  ALTER

ADDRESS Rt. 216, Fulton, Md. 20759 PHONE 725-5311

A SEWAGE DISPOSAL SYSTEM LOCATED AT \_\_\_\_\_

SUBDIVISION Woodmark, Inc. ROAD Court "D" LOT 33, Blk. B, Sec 2

PROPERTY OWNER Woodmark, Inc., Mark A. Wakefield, Jr.

ADDRESS 231 Chatham Rd., Ellicott City, Md.

SPECIFICATIONS 4 - Bedrooms

DRAIN FIELD \_\_\_\_\_ DEPTH \_\_\_\_\_ FEET, BOTTOM AREA \_\_\_\_\_ SQ. FT.

SEEPAGE PITS \_\_\_\_\_ ABSORBENT SIDE-WALL AREA \_\_\_\_\_ SQ. FT.

SEPTIC TANK CAPACITY 1000 GALLONS

FOR GARBAGE GRINDER, INCREASE DISPOSAL AREA 22% & TANK CAPACITY 50%.

OTHER Dry well - 125 sq.ft. absorbent sidewall area per bedroom below inlet pipe. Max Depth of Dry Well 13 ft. below original grade.

Place Dry Well 185 ft. from front line and 95 ft. from right sideline as seen when facing from Townhouse Ct.

PERMIT VOID AFTER THREE YEARS.

PLANS APPROVED BY D. W. Monaghan DATE 3-12-68

FILL SEPTIC TANK AND DISTRIBUTION BOX WITH WATER BEFORE CALLING FOR AN INSPECTION. COVER NO WORK UNTIL INSPECTED AND APPROVED.

NEITHER THE HOWARD COUNTY COMMISSIONERS NOR THE HEALTH DEPARTMENT IS RESPONSIBLE FOR THE SUCCESSFUL OPERATION OF ANY SYSTEM.

### NOTIFY THE HEALTH DEPARTMENT 48 HOURS BEFORE EXCAVATIONS ARE TO BE BACK FILLED.

13009

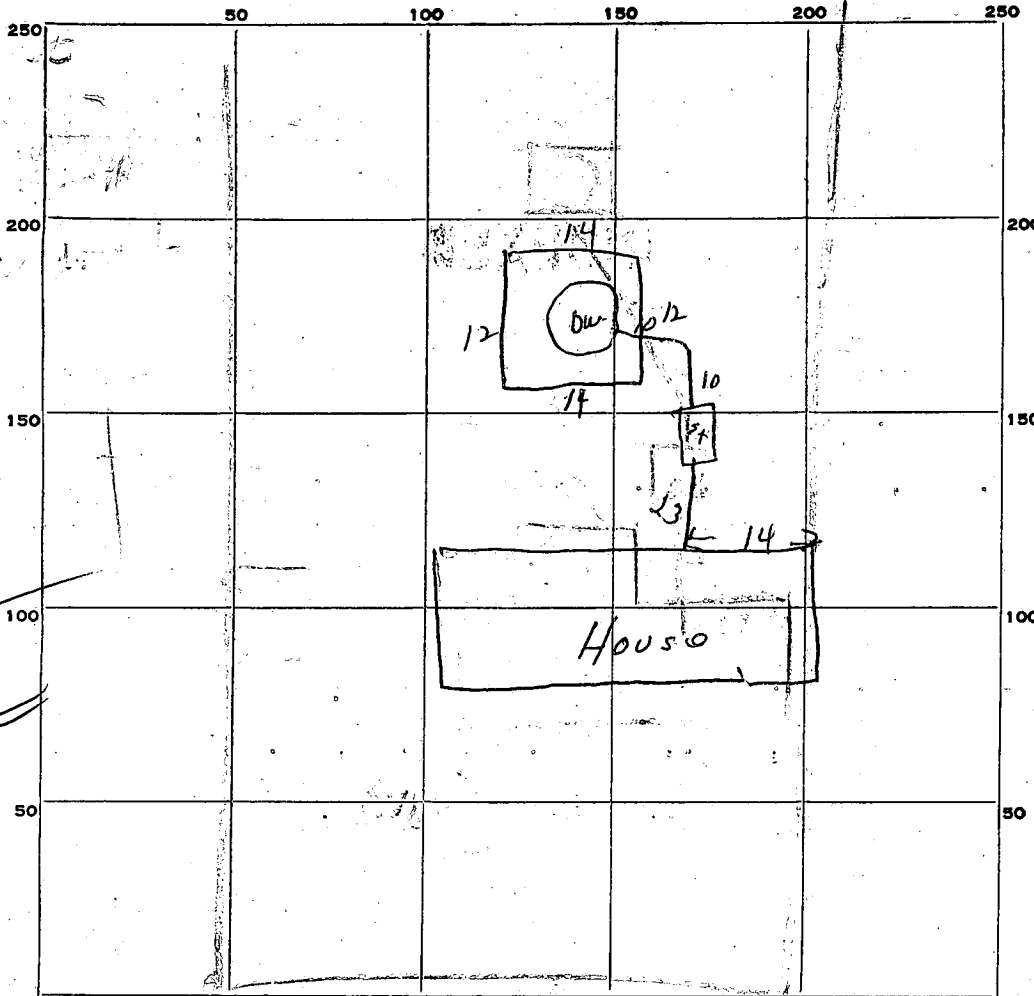

INDICATE NORTH. - NAME ADJOINING ROADWAY AS BASE LINE.

*Fawnhason Court*

*Perimeter*

*14  
14  
12  
12  
-----  
52  
9 1/2*

*26  
468  
-----  
494*

PERMIT CARD \_\_\_\_\_

SEPTIC TANK, LEVEL OK

CLEANOUTS OK

DISTRIBUTION BOX, LEVEL \_\_\_\_\_

TILE FIELD, DEPTH \_\_\_\_\_ FT. TRENCH WIDTH \_\_\_\_\_ FT.

GRAVEL DEPTH \_\_\_\_\_ IN. TOTAL LENGTH \_\_\_\_\_ FT.

NUMBER OF TRENCHES \_\_\_\_\_ TOTAL BOTTOM AREA \_\_\_\_\_

SEEPAGE PITS, INSIDE DIAMETER Perimeter 52 FT. DEPTH BELOW INLET 9 1/2 FT.

ABSORBENT AREA 494 SQ. FT.

REMARKS \_\_\_\_\_

DATE SYSTEM APPROVED 6/4/68

INSPECTOR DW Manag

*preliminary*

# APPLICATION

SEWAGE DISPOSAL TESTING

MARYLAND STATE DEPARTMENT OF HEALTH

HOWARD COUNTY

ELLICOTT CITY

DISTRICT 3

DATE 8/10/67

A 13009

P \_\_\_\_\_

TO: THE COUNTY HEALTH OFFICER  
ELLICOTT CITY, MARYLAND

I, HEREBY, APPLY FOR THE NECESSARY TESTS IN ORDER TO CONSTRUCT (OR RECONSTRUCT) A SEWAGE DISPOSAL SYSTEM.

PROPERTY OWNER Woodmark, Inc., Mark A. Wakefield, Jr.

ADDRESS 231 Chatham Rd., Ellicott City, Md. PHONE HO 5-1345

PROPERTY LOCATION:

SUBDIVISION Woodmark, Inc. LOT NO. 33 Blk. B, Sec. 2

ROAD AND DESCRIPTION Court "D"

OCCUPANT \_\_\_\_\_ PHONE \_\_\_\_\_

PERSON TO CONSTRUCT SYSTEM \_\_\_\_\_

ADDRESS \_\_\_\_\_ PHONE \_\_\_\_\_

SIZE OF LOT 122' x 290' x 150' x 286' TYPE BLDG. 3 or 4  
NUMBER OF BEDROOMS

IF NOT SINGLE RESIDENCE DESCRIBE \_\_\_\_\_

SIGNATURE OF APPLICANT /s/ Mark Wakefield

APPROVED BY [Signature] FOR [Signature] DATE 3-12-68

REJECTED BY \_\_\_\_\_ FOR \_\_\_\_\_ DATE \_\_\_\_\_

HOLD PENDING FURTHER TESTS \_\_\_\_\_ DATE \_\_\_\_\_

REASONS FOR REJECTION OR HOLDING \_\_\_\_\_

# THIS IS NOT A PERMIT

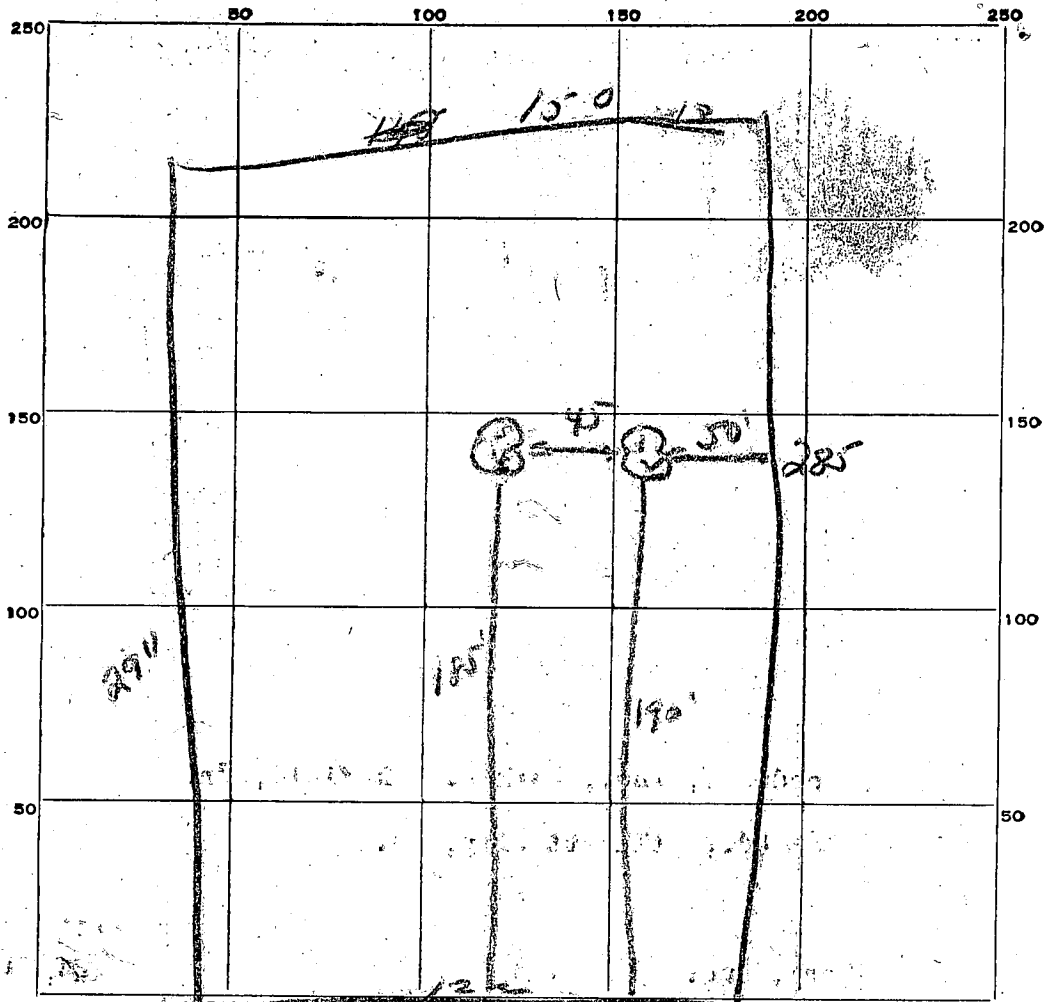

INDICATE NORTH. - NAME ADJOINING ROADWAY AS BASE LINE.

Chart D

DATE	TEST NO.	DEPTH	PRE-WET		TEST - 1" DROP		TIME
			START	STOP	START	STOP	
8/15/77	1	7'	2:42	2:52	2:52	3:12	20 min
	2	12 1/2'	2:42	2:43	2:43	2:46	3 min
	3	6'	2:45	2:55	2:55	3:13	18 min
	4	11'	2:45	2:47	2:47	2:49	2 min

290  
150  
150  
150

SOIL AUGER FINDING

TESTED BY JHR + DM

REMARKS

33  
B



Lot 33  
 Lot 30 or 34

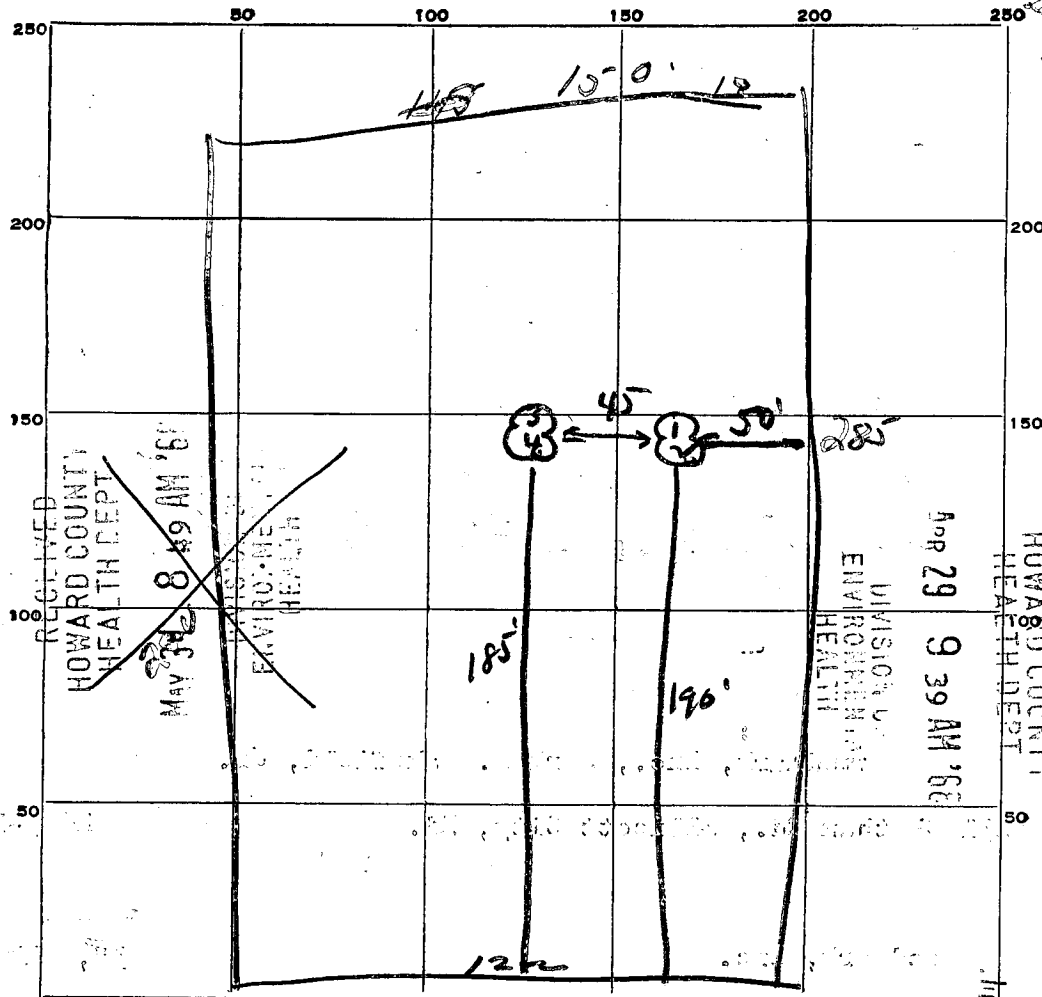

INDICATE NORTH - NAME ADJOINING ROADWAY AS BASE LINE.  
 Court D

DATE	TEST NO.	DEPTH	PRE-WET		TEST - 1" DROP		TIME
			START	STOP	START	STOP	
8/15/67	1	2'	2:42	2:52	2:52	3:12	20 min
	2	12 1/2'	2:42	2:43	2:43	2:46	3 min
	3	6'	2:45	2:55	2:55	3:13	18 min
	4	11'	2:45	2:47	2:47	2:49	2 min

SOIL AUGER FINDING \_\_\_\_\_

TESTED BY JHK + DM

REMARKS \_\_\_\_\_

33  
 25 B

THIS REPORT  
MUST BE SUBMITTED  
WITHIN 30 DAYS  
AFTER COMPLETION  
OF THE WELL

WELL COMPLETION REPORT

WELL DESCRIPTION

**A** WELL LOG

State the kind of formations penetrated, their color, their depth, their thickness, and if water-bearing

**B** CASING AND SCREEN RECORD

State the kind and size and position of casing, liner, shoe, screen, and other accessories (if no casing used, give diameter of well).

	FEET		DIAM. (inches)	FEET	
	from	to		from	to
Dirt	0	9	Steel 6 1/4	0	59
rotton rock	9	38			
soft sandstone	38	55			
Hard <del>rock</del> sandstone	55	70			

Permit Number 10684200  
 Owner Robert M. Flourman  
 Address Boney Branch Rd.  
 Subdivision Woodmont Del.  
 Section 2 Lot 15  
 County Permit Number \_\_\_\_\_  
 PUMPING TEST  
 Hours Pumped 2  
 Type of Pump Used Baller  
 Pumping Rate \_\_\_\_\_  
 Gallons per Minute 8

WATER LEVEL  
 (Distance from land surface to water)  
 Before Pumping 21 Ft.  
 When Pumping 40 Ft.

APPEARANCE OF WATER  
 Clear  Cloudy \_\_\_\_\_  
 Taste Good  
 Odor None

Height of Casing Above Land  
 Surface 2 Ft.

PUMP INSTALLED  
 Type None  
 Capacity  
 Gallons per Minute \_\_\_\_\_  
 Gallons per Hour \_\_\_\_\_  
 Pump Column Length \_\_\_\_\_ Ft.

LOCATION OF WELL ON LOT  
 Show permanent structures such as building(s), septic tank, and/or other landmarks and indicate not less than 2 distances (measurements) to well.

NORTH  
 ↑  
*No Buildings on lot*

DATE WELL WAS COMPLETED  
5/2/68

I hereby affirm that this report contains no willful misrepresentations or falsifications and that information given in this report is true, accurate and complete to the best of my knowledge and belief.

Russell Dexter, Well Driller  
 Well Driller License No.: 119

APPLICATION MUST BE SUBMITTED AND PERMIT RECEIVED BEFORE DRILLING IS STARTED.

APPLICATION FOR PERMIT TO DRILL WELL

7-0-2077

A13009

Owner Robert M. Florian  
Street or R. F. D. Boney Branch Rd.  
Post Office Ellicott City, Md.

Driller Russell Heister License Number 119  
Street or R. F. D. 2524 Old Frederick Rd.  
Post Office Catonsville 28, Md.  
Date 4/9/68

Quantity of Water to be Produced 5 Gallons Per Minute  
Total Quantity Needed For Use 300 Gallons Per Day  
Use for Water New House  
Approximate Depth of Well (feet) 100  
Method of Drilling to be used Cable

Location of Well County \_\_\_\_\_  
Subdivision Woodmark Development  
Section \_\_\_\_\_ Lot 33 Lawnhaven Ct.  
Nearest Town Ellicott City  
Distance from Town 5 miles  
Direction from Town West

Is this a Replacement Well? Yes - No  
If YES, indicate date abandoned well is to be sealed: \_\_\_\_\_  
and by whom: \_\_\_\_\_

Description of Location of Well  
(This information MUST BE ACCURATE, and should be definite enough to permit locating well on a county map.)  
Near what road Frederick Rd.  
On which side of road East  
(North, East, South, West)  
Distance from road 300 ft.

PERMIT TO DRILL WELL  
(Not To Be Filled In By Driller)

Well Permit No. HO-68-W-200

Samples of Cuttings Required by Department:  Yes  No  
Owner Requires Permit to Appropriate Water:  Yes  No  
Owner Has Permit to Appropriate Water:  Yes  No

Appropriation Permit No. \_\_\_\_\_  
The applicant is herewith granted a permit to drill this well subject to the conditions stipulated.  
Paul W. McKee 4/15/68  
Director Date

**THIS PERMIT IS NOT TRANSFERABLE**  
WITHOUT WRITTEN PERMISSION FROM THE DEPARTMENT  
Special conditions that must be observed:

Health Department Approval of Application  
Howard County Department of Health  
or  State Department of Health  
Approved by Palmer F. Wise  
Title Director, Environmental Health  
Date 4/10/68

Draw a sketch below showing location of well in relation to nearby towns, roads and streams with north in the direction of the arrow, and give distance from well to nearest road junction or stream crossing shown on the sketch. Distances may be approximate, but must be indicated.

