

12/14/77

as early as possible in a.m.

PERMIT

File

179 F.C.O.

P 27090 C.Bd.

A 26022

SEWAGE DISPOSAL SYSTEM

MARYLAND STATE DEPARTMENT OF HEALTH

HOWARD COUNTY

05-37904

ELLICOTT CITY

DISTRICT 5th

DATE 10/18/77

INDEXED

Mr. Seiss IS PERMITTED TO INSTALL ALTER

ADDRESS PHONE

A SEWAGE DISPOSAL SYSTEM LOCATED AT

SUBDIVISION Williams Contrivance Estates ROAD 9450 Ellsworth Court LOT 12, Sec. 2

PROPERTY OWNER Roy D. Collins

ADDRESS P. O. Box 142, Simpsonville, Md. 21150 Phone: 953-7569

SPECIFICATIONS 4 bedrooms

DRAIN FIELD DEPTH FEET, BOTTOM AREA SQ. FT.

SEEPAGE PITS ABSORBENT SIDE-WALL AREA SQ. FT.

SEPTIC TANK CAPACITY 1250 GALLONS

FOR GARBAGE GRINDER, INCREASE DISPOSAL AREA 22% & TANK CAPACITY 50%.

OTHER DRY WELL - 480 sq. ft. sidewall area below inlet. Inlet to be 5 ft. deep below original grade. Dry well bottom to be 13 ft. deep below original grade. Place the dry well 143 ft. from front lot line (which is 172 ft. long) and 55 ft. from the left side line as seen when facing the lot from Ellsworth Court. If top of tank over 3 ft. deep manhole to ground surface needed.

NOTE: NO DRY WELL IS TO EXCEED 15 FOOT IN DIAMETER.

NOTE: ALL PIPE FROM HOUSE TO DISPOSAL AREA MUST BE CAST IRON.

PERMIT VOID AFTER THREE YEARS.

NOTE: INSTALL STAND PIPE ON SEPTIC TANK AND DRY WELL. STAND PIPES MUST BE 6 INCHES IN DIAMETER. CAST IRON, CONCRETE OR TERRA COTTA ACCEPTED.

PLANS APPROVED BY Raymond Hodges DATE 6/20/77

FILL SEPTIC TANK AND DISTRIBUTION BOX WITH WATER BEFORE CALLING FOR AN INSPECTION. COVER NO WORK UNTIL INSPECTED AND APPROVED.

NEITHER THE HOWARD COUNTY COMMISSIONERS NOR THE HEALTH DEPARTMENT IS RESPONSIBLE FOR THE SUCCESSFUL OPERATION OF ANY SYSTEM.

BLDG. PERMIT SIGNED AND RETURNED 7/22/77 Serial # 43821

A 26022

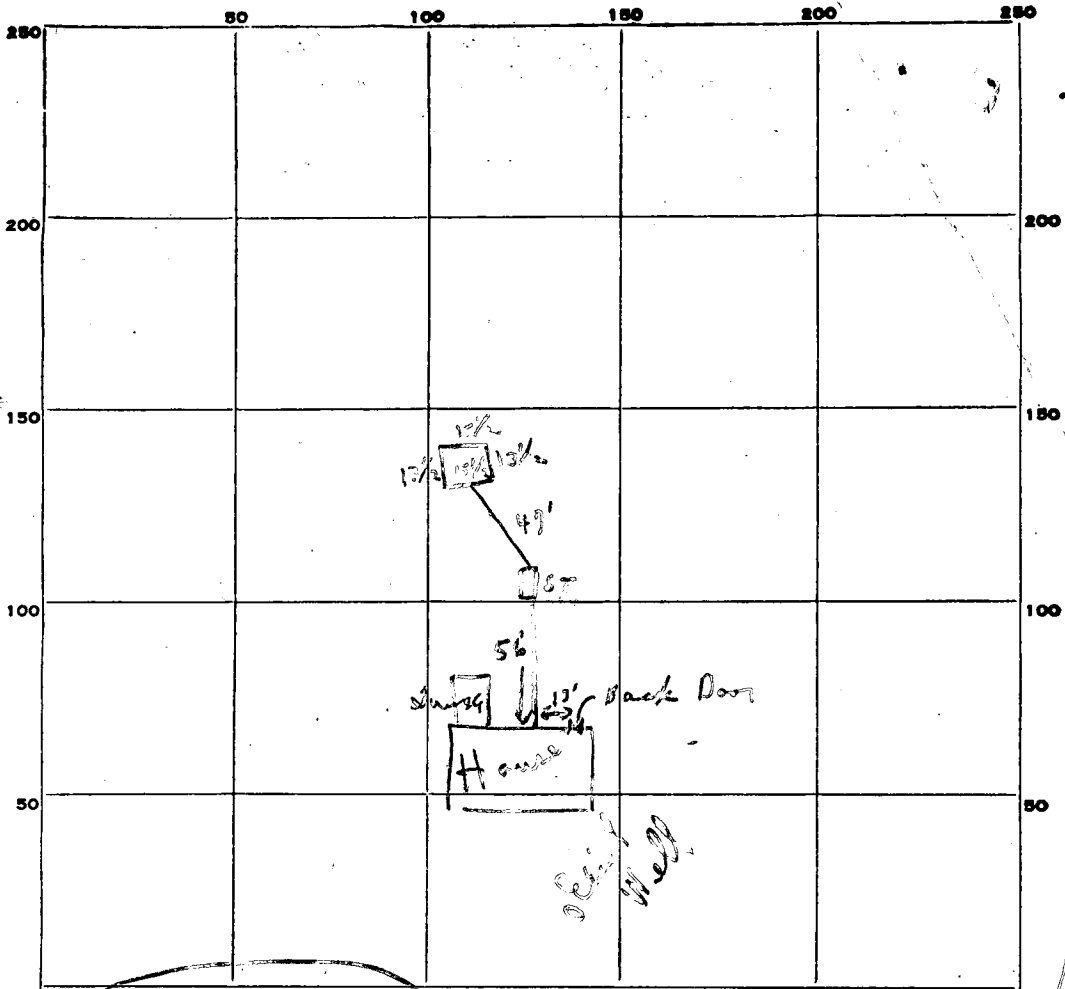

INDICATE NORTH. - NAME ADJOINING ROADWAY AS BASE LINE.

PERMIT CARD _____ *Yes in new window downstairs*

S.T.	D.W.
------	------

SEPTIC TANK, LEVEL _____ *OK* CLEANOUTS _____

<i>OK</i>	<i>OK</i>
-----------	-----------

DISTRIBUTION BOX, LEVEL _____ *N/A*

Trench
TILE FIELD, DEPTH _____ FT. TRENCH WIDTH _____ FT.

GRAVEL DEPTH _____ *1* IN. TOTAL LENGTH _____ FT.

NUMBER OF TRENCHES _____ TOTAL BOTTOM AREA _____

outside perimeter
SEEPAGE PITS, INSIDE DIAMETER _____ *58* FT. DEPTH BELOW INLET _____ *8 +* FT.

ABSORBENT AREA _____ *46.4 +* SQ. FT.

REMARKS *12/14/77 OK to cover system*

DATE SYSTEM APPROVED _____ *12/14/77* INSPECTOR *C B Strickland*