

HOWARD COUNTY  
PERMIT APPLICATION

PERMIT NUMBER

808001670

Building Address 3270 ELEANORS GARDEN WAY, WOODBINE MD. 21791  
Suite/Apt. #: \_\_\_\_\_ SDP/WP/Petition #: \_\_\_\_\_  
Census Tract \_\_\_\_\_ Subdivision \_\_\_\_\_  
Section \_\_\_\_\_ Area \_\_\_\_\_ Lot 40  
Tax Map \_\_\_\_\_ Parcel \_\_\_\_\_ Grid \_\_\_\_\_  
Zoning \_\_\_\_\_ Map Coordinates \_\_\_\_\_ Lot size 49572 FT<sup>2</sup>

Property Owner's Name MARY KURIKESHU  
Address 3270 ELEANORS GARDEN WAY  
City WOODBINE State MD Zip Code 21791  
Phone 410 489-2340 Phone \_\_\_\_\_  
Applicant's Name & Mailing Address, (if other than stated hereon): \_\_\_\_\_  
Phone \_\_\_\_\_ Fax \_\_\_\_\_

Existing Use S.F.D.  
Proposed Use DECK  
Estimated Construction Cost \$ 12,000  
Description of Work NEW WOOD FRAME DECK IRREGULAR SHAPE NO STAIRS ~ 512 FT<sup>2</sup> 15x24

Contractor Company Bruce Builders LLC  
Contact Person MICHAEL BRUCE  
Address 720 OAK GROVE CIR  
City SEW PARK State MD Zip Code 21146  
License No. 67133  
Phone 410-324-7915 Fax \_\_\_\_\_

Occupant or Tenant MARY KURIKESHU.  
Contact Name SAME  
Address 3270 ELANDORS GARDEN WAY  
City WOODBINE State MD Zip Code 21791  
Phone 410 489-2340 Fax \_\_\_\_\_

Engineer or Architect Company \_\_\_\_\_  
Contact Person \_\_\_\_\_  
Address \_\_\_\_\_  
City \_\_\_\_\_ State \_\_\_\_\_ Zip Code \_\_\_\_\_  
Phone \_\_\_\_\_ Fax \_\_\_\_\_

BUILDING DESCRIPTION - COMMERCIAL

BUILDING DESCRIPTION - RESIDENTIAL

Building Characteristics	Utilities
Height: _____	Water Supply: _____ Public <input type="checkbox"/> Private <input type="checkbox"/>
No. of stories: _____	Sewage Disposal: _____ Public <input type="checkbox"/> Private <input type="checkbox"/>
Gross area, sq. ft. per floor: _____	Electric Yes <input type="checkbox"/> No <input type="checkbox"/> Gas Yes <input type="checkbox"/> No <input type="checkbox"/>
Use group: _____	Heating System: _____ Electric <input type="checkbox"/> Oil <input type="checkbox"/> Natural Gas <input type="checkbox"/> Propane Gas <input type="checkbox"/>
Construction type: _____ Reinforced Concrete <input type="checkbox"/> Structural Steel <input type="checkbox"/> Masonry <input type="checkbox"/> Wood Frame <input type="checkbox"/> State Certified Modular <input type="checkbox"/>	Sprinkler system: <u>N/A</u> <input type="checkbox"/> Full <input type="checkbox"/> Partial <input type="checkbox"/> Other Suppression <input type="checkbox"/> # of Heads _____

Building Characteristics	Utilities
SF Dwelling <input checked="" type="checkbox"/> SF Townhouse <input type="checkbox"/> Depth _____ Width _____	Water Supply: _____ Public <input type="checkbox"/> Private <input checked="" type="checkbox"/>
1st floor: _____	Sewage Disposal: _____ Public <input type="checkbox"/> Private <input checked="" type="checkbox"/>
2nd floor: _____	Electric Yes <input checked="" type="checkbox"/> No <input type="checkbox"/> Gas Yes <input type="checkbox"/> No <input type="checkbox"/>
Basement: _____ Finished Basement <input type="checkbox"/> Unfinished Basement <input type="checkbox"/>	Heating System: _____ Electric <input type="checkbox"/> Oil <input type="checkbox"/> Natural Gas <input type="checkbox"/> Propane Gas <input type="checkbox"/>
Crawl space <input type="checkbox"/> Slab on Grade <input type="checkbox"/>	Sprinkler system: <u>N/A</u> <input checked="" type="checkbox"/> NFPA #13D _____ NFPA #13R _____ Other: _____
No. of Bedrooms _____	
Height: _____	
Multi-family dwellings: _____	
No. of efficiency units: _____	
No. of 1 BR units: _____	
No. of 2 BR units: _____	
No. of 3 BR units: _____	
Other Structure: _____	
Dimensions: _____	
Footings: _____	
Roof Height: _____	
State Certified Modular <input type="checkbox"/>	
Manufactured Home <input type="checkbox"/>	

THE UNDERSIGNED HEREBY CERTIFIES AND AGREES AS FOLLOWS: (1) THAT HE/SHE IS AUTHORIZED TO MAKE THIS APPLICATION; (2) THAT THE INFORMATION IS CORRECT; (3) THAT HE/SHE WILL COMPLY WITH ALL REGULATIONS OF HOWARD COUNTY WHICH ARE APPLICABLE THERETO; (4) THAT HE/SHE WILL PERFORM NO WORK ON THE ABOVE REFERENCED PROPERTY NOT SPECIFICALLY DESCRIBED IN THIS APPLICATION; (5) THAT HE/SHE GRANTS COUNTY OFFICIALS THE RIGHT TO ENTER ONTO THIS PROPERTY FOR THE PURPOSE OF INSPECTING THE WORK PERMITTED AND POSTING NOTICES.

M. Bruce  
Applicant's Signature  
Owner Bruce Builders  
Title/Company

M. Bruce  
Print Name  
June 5, 2008  
Date

Checks payable to: **DIRECTOR OF FINANCE OF HOWARD COUNTY**  
\*\* PLEASE WRITE NEATLY AND LEGIBLY. \*\*  
FOR OFFICE USE ONLY.

AGENCY	DATE	SIGNATURE APPROVAL	DPZ SETBACK INFORMATION	PROPERTY ID#
Land Development, DPZ			Front: _____	Filing fee \$ _____
State Highways			Rear: _____	Permit fee \$ _____
Building Official			Side: _____	Excise tax \$ _____
Dev. Engineering, DPZ	<u>6/5/08</u>	<u>[Signature]</u>	Side St.: _____	Add'l per. fee \$ _____
Health			All minimum setbacks met?	TOTAL FEES \$ _____
Fire Protection			YES <input type="checkbox"/> NO <input type="checkbox"/>	Sub-total paid \$ _____
Is Sediment Control approval required prior to issuance?			Is Entrance Permit required?	Balance due \$ _____
YES <input type="checkbox"/> NO <input type="checkbox"/>			YES <input type="checkbox"/> NO <input type="checkbox"/>	Check # _____
CONTINGENCY CONSTRUCTION START: <input type="checkbox"/>			Historic District?	Validation # _____
ONE STOP SHOP: <input type="checkbox"/>			YES <input type="checkbox"/> NO <input type="checkbox"/>	
Distribution of Copies:			Lot Coverage for New Town Zone _____	Accepted by _____
White: Building Official			SDP/Red-line approval date _____	
Green: LDD, DPZ				
Yellow: DED, DPZ				
Pink: Health				
Gold: SH				

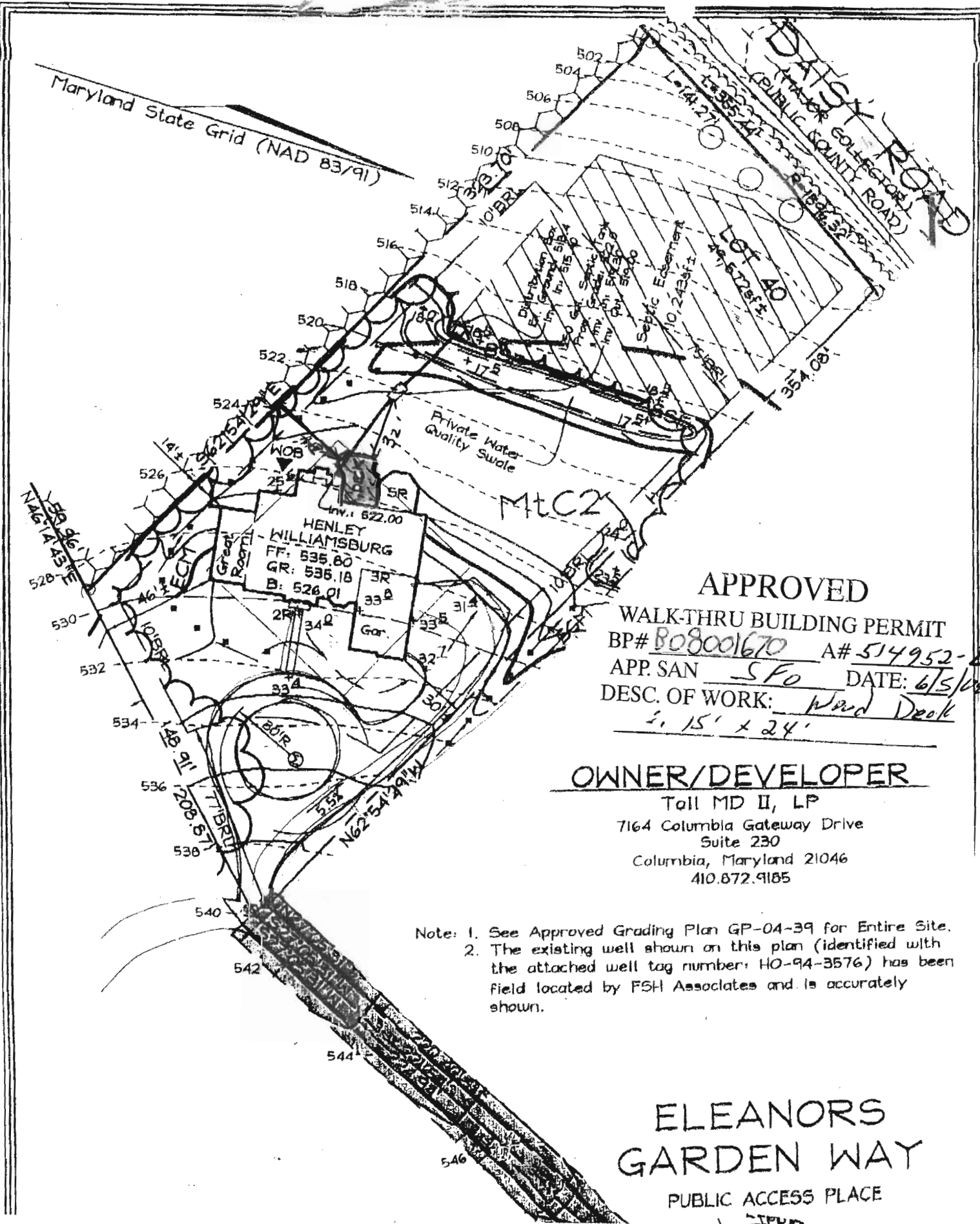

**APPROVED**  
 WALK-THRU BUILDING PERMIT  
 BP# 808001670 A# 514952-2  
 APP. SAN SFO DATE: 6/5/08  
 DESC. OF WORK: Wood Deck  
3.15' x 24'

**OWNER/DEVELOPER**  
 Toll MD II, LP  
 7164 Columbia Gateway Drive  
 Suite 230  
 Columbia, Maryland 21046  
 410.872.9185

Note: 1. See Approved Grading Plan GP-04-39 for Entire Site.  
 2. The existing well shown on this plan (identified with the attached well tag number: HO-94-3576) has been field located by FSH Associates and is accurately shown.

**ELEANORS GARDEN WAY**  
 PUBLIC ACCESS PLACE