

9/9/77-final

See 1/24/78 comments

PERMIT file

P 26833
A 26783

SEWAGE DISPOSAL SYSTEM

MARYLAND STATE DEPARTMENT OF HEALTH

HOWARD COUNTY

03298493

ELLICOTT CITY

DISTRICT 3rd

INDEXED

DATE 9/2/77

Jack Fyock

IS PERMITTED TO INSTALL ALTER

ADDRESS 13775 Triadelphia Road, Glenelg, Md. 21737

PHONE 988-9270

A SEWAGE DISPOSAL SYSTEM LOCATED AT

SUBDIVISION ROAD 13550 Old Frederick Road LOT

PROPERTY OWNER James H. Welling

ADDRESS 13550 Old Frederick Road, Sykesville, Md. 21784

Phone: 489-4102

SPECIFICATIONS Farm Trailer - 3 bedrooms

DRAIN FIELD DEPTH FEET, BOTTOM AREA SQ. FT.

SEEPAGE PITS ABSORBENT SIDE-WALL AREA SQ. FT.

SEPTIC TANK CAPACITY 1000 GALLONS

FOR GARBAGE GRINDER, INCREASE DISPOSAL AREA 22% & TANK CAPACITY 50%.

OTHER DRY WELL - 13 1/4 square foot dry well. Inlet at 4 ft. below original grade and maximum depth 12 ft. below original grade. Locate dry well in the hole that is approximately 35 ft. in front of walnut trees.

FYOCK CALLED & R.M. CHANGED TO DITCH 600

NOTE: ALL PIPE FROM HOUSE TO DISPOSAL AREA MUST BE CAST IRON. *SDF7 SIDEWALL 12" DEEP*
PERMIT VOID AFTER THREE YEARS.

NOTE: INSTALL STAND PIPE ON SEPTIC TANK AND DRY WELL. STAND PIPES MUST BE 6 INCHES IN DIAMETER. CAST IRON, CONCRETE OR TERRA COTTA ACCEPTED. *7F7 OF STONE*

PLANS APPROVED BY D. J. O'Neill & Fred Frommelt DATE 8/31/77

FILL SEPTIC TANK AND DISTRIBUTION BOX WITH WATER BEFORE CALLING FOR AN INSPECTION. COVER NO WORK UNTIL INSPECTED AND APPROVED.

NEITHER THE HOWARD COUNTY COMMISSIONERS NOR THE HEALTH DEPARTMENT IS RESPONSIBLE FOR THE SUCCESSFUL OPERATION OF ANY SYSTEM.

75

25
18
600

8 440

26783

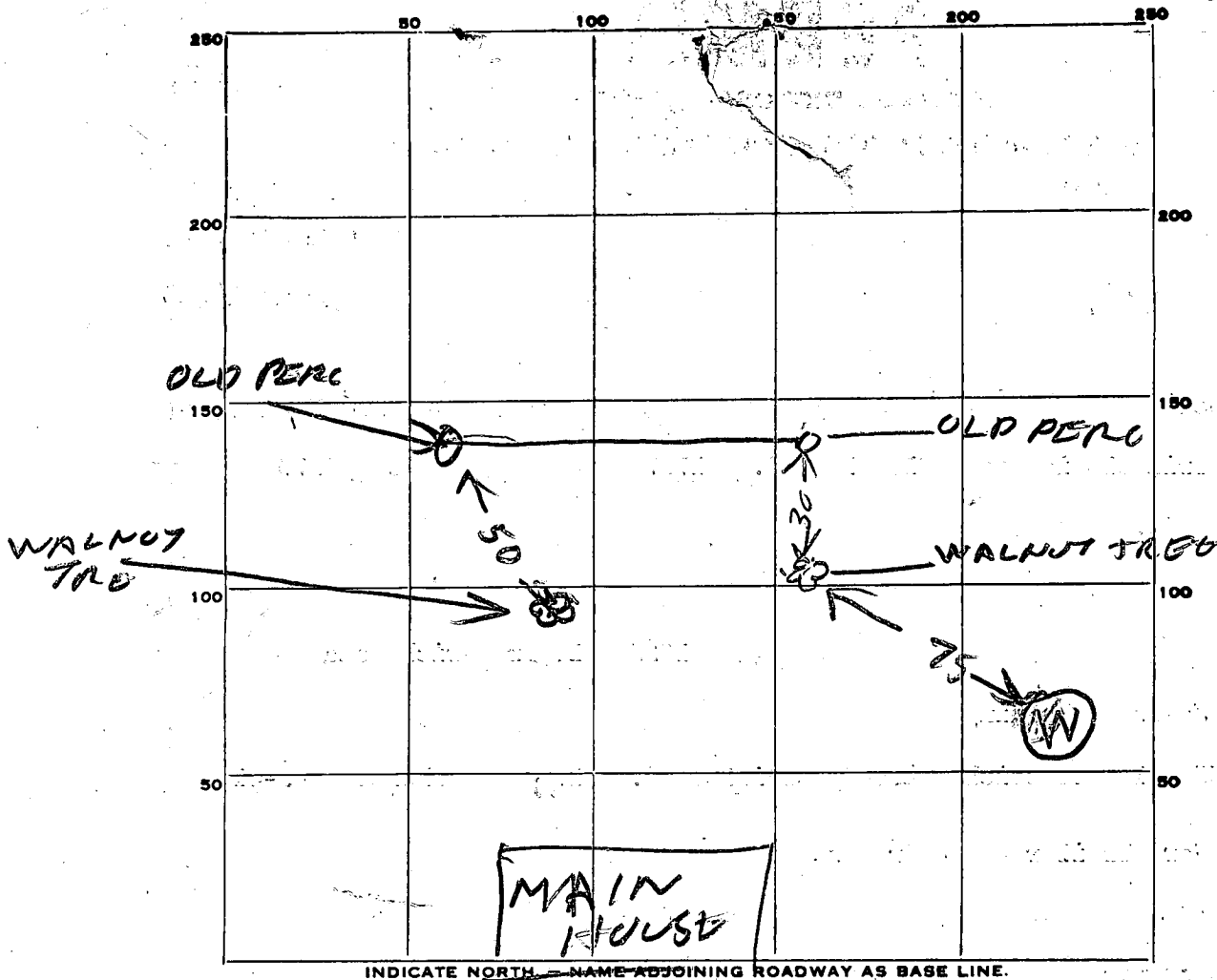

INDICATE NORTH - NAME ADJOINING ROADWAY AS BASE LINE.

PERMIT CARD (Not seen) S.T. / D.W
 SEPTIC TANK, LEVEL ok CLEANOUTS NA
 DISTRIBUTION BOX, LEVEL N/A
 TILE FIELD, DEPTH 12 FT. TRENCH WIDTH 2 FT.
 GRAVEL DEPTH 9 IN. TOTAL LENGTH 75 FT. 67.5 ±
 NUMBER OF TRENCHES 1 TOTAL BOTTOM AREA -
 SEEPAGE PITS, INSIDE DIAMETER - FT. DEPTH BELOW INLET - FT.

ABSORBENT AREA 675 ± SQ. FT.

REMARKS 9/9/77 DITCH OK FINISH JOB & 600
CALL FOR INSPECTION RHT
9/9/77 See attached sheet approved per above.
1/24/78 Checked - Trailer on site & hooked e.B.S.
up - system appears to be functioning C.B.S.
(No outflow) NOT approved connection

DATE SYSTEM APPROVED _____ INSPECTOR _____

PERMIT

SEWAGE DISPOSAL SYSTEM

P 26833

A 26783

MARYLAND STATE DEPARTMENT OF HEALTH

HOWARD COUNTY

ELLICOTT CITY

DISTRICT 3rd

DATE 9/2/77

Jack Fyock

IS PERMITTED TO INSTALL ALTER

ADDRESS 13775 Triadelphia Road, Glenelg, Md. 21737

PHONE 988-9270

A SEWAGE DISPOSAL SYSTEM LOCATED AT _____

SUBDIVISION _____ ROAD 13550 Old Frederick Road LOT _____

PROPERTY OWNER James H. Welling

ADDRESS 13550 Old Frederick Road, Sykesville, Md. 21784

Phone: 489-4102

SPECIFICATIONS Farm Trailer - 3 bedrooms

DRAIN FIELD _____ DEPTH _____ FEET, BOTTOM AREA _____ SQ. FT.

SEEPAGE PITS _____ ABSORBENT SIDE-WALL AREA _____ SQ. FT.

SEPTIC TANK CAPACITY 1000 GALLONS

FOR GARBAGE GRINDER, INCREASE DISPOSAL AREA 22% & TANK CAPACITY 50%.

OTHER DRY WELL - 13 1/4 square foot dry well. Inlet at 4 ft. below original grade and maximum depth 12 ft. below original grade. Locate dry well in the hole that is approximately 35 ft. in front of walnut trees.

NOTE: ALL PIPE FROM HOUSE TO DISPOSAL AREA MUST BE CAST IRON.

PERMIT VOID AFTER THREE YEARS.

NOTE: INSTALL STAND PIPE ON SEPTIC TANK AND DRY WELL. STAND PIPES MUST BE 6 INCHES IN DIAMETER. CAST IRON, CONCRETE OR TERRA COTTA ACCEPTED.

PLANS APPROVED BY D. J. O'Neill & Fred Frommelt DATE 8/31/77

FILL SEPTIC TANK AND DISTRIBUTION BOX WITH WATER BEFORE CALLING FOR AN INSPECTION. COVER NO WORK UNTIL INSPECTED AND APPROVED.

NEITHER THE HOWARD COUNTY COMMISSIONERS NOR THE HEALTH DEPARTMENT IS RESPONSIBLE FOR THE SUCCESSFUL OPERATION OF ANY SYSTEM.

OK to change D.W. to 75' trench 8' of stone for 600φ

R.M. 8 Sept 77

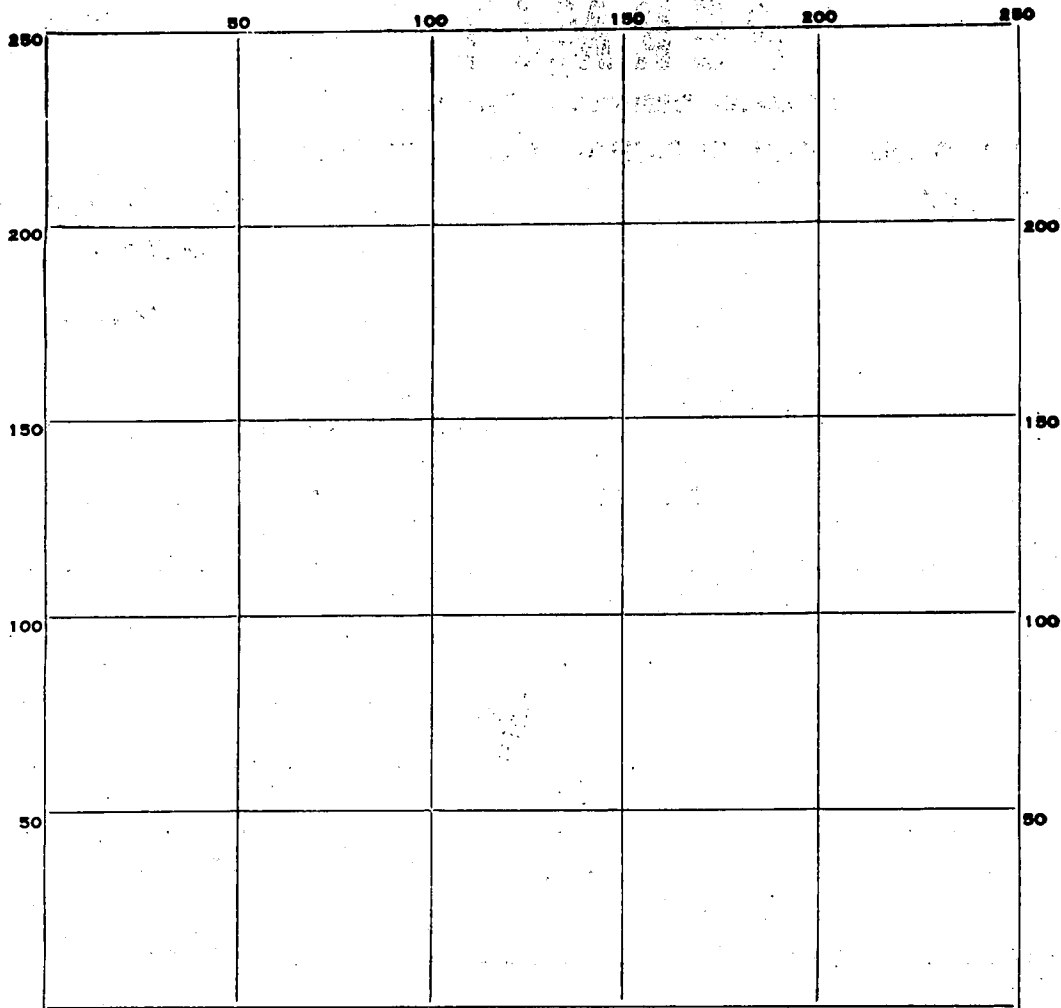

INDICATE NORTH. - NAME ADJOINING ROADWAY AS BASE LINE.

PERMIT CARD _____

SEPTIC TANK, LEVEL _____

CLEANOUTS _____

DISTRIBUTION BOX, LEVEL _____

TILE FIELD, DEPTH _____ FT. TRENCH WIDTH _____ FT.

GRAVEL DEPTH _____ IN. TOTAL LENGTH _____ FT.

NUMBER OF TRENCHES _____ TOTAL BOTTOM AREA _____

SEEPAGE PITS, INSIDE DIAMETER _____ FT. DEPTH BELOW INLET _____ FT.

ABSORBENT AREA _____ SQ. FT.

REMARKS _____

DATE SYSTEM APPROVED _____ INSPECTOR _____

Recorded
HOWARD COUNTY HEALTH DEPT. = SANITATION

APPLICATION

A 26783

SEWAGE DISPOSAL TESTING

P _____

STATE OF MARYLAND - DEPARTMENT OF HEALTH AND MENTAL HYGIENE

8/30/77
1:30 P.M.

HOWARD COUNTY HEALTH DEPARTMENT
ENVIRONMENTAL HEALTH SERVICES
P O. BOX 476, ELLICOTT CITY, MARYLAND 21043
TELEPHONE: 465-5000, EXT. 356

DISTRICT 3rd

DATE 8/8/77

1000 sq ft

*1 1/2 sq. ft. dw. inlet 4' max. depth 12' from original grade
140 # per. bedroom total 420 #
OK to put dry well 10-20' from trees
locate dry well in hole that is approx 35 ft. in front of
Walnut trees.*

TO: THE COUNTY HEALTH OFFICER
ELLICOTT CITY, MARYLAND

I, HEREBY, APPLY FOR THE NECESSARY TEST IN ORDER TO CONSTRUCT (OR RECONSTRUCT) A SEWAGE DISPOSAL SYSTEM.

PROPERTY OWNER James H. Welling

ADDRESS 13550 Old Frederick Road, Sykesville, Md. PHONE 489-4102

PROPERTY LOCATION:

SUBDIVISION _____ LOT NO. _____

ROAD AND DESCRIPTION 13550 Old Frederick Road 3rd Election Dist.

SIZE OF LOT 120 acres TYPE BLDG. Farm Trailer - 3 bedrooms
NUMBER OF BEDROOMS _____

IF NOT SINGLE RESIDENCE DESCRIBE _____

THE SYSTEM INSTALLED UNDER THIS APPLICATION IS ACCEPTABLE ONLY UNTIL PUBLIC FACILITIES BECOME AVAILABLE.

SIGNATURE OF APPLICANT James H. Welling

APPROVED BY _____ FOR _____ DATE _____
(KIND OF SYSTEM)

REJECTED BY _____ FOR _____ DATE _____
(KIND OF SYSTEM)

HOLD PENDING FURTHER TESTS _____ DATE _____

REASONS FOR REJECTION OR HOLDING _____

THIS IS NOT A PERMIT

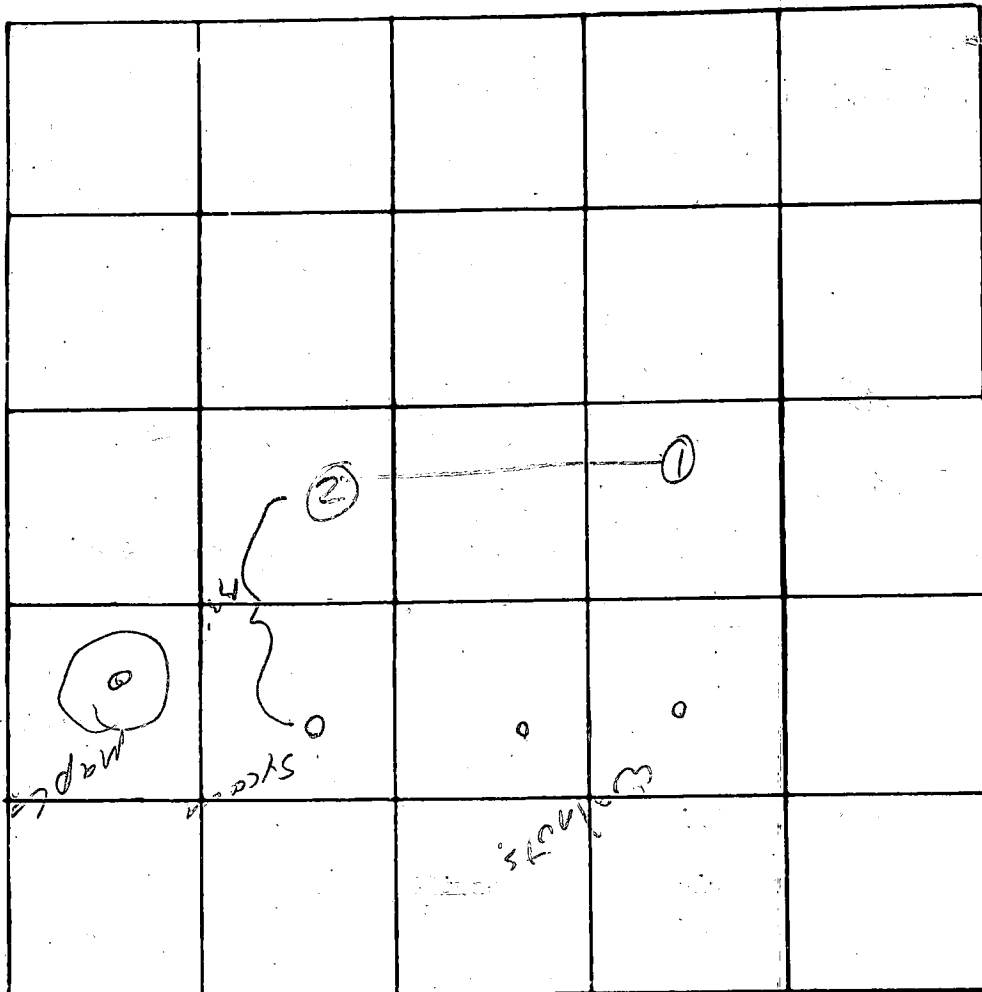

INDICATE NORTH. - NAME ADJOINING ROADWAY AS BASE LINE

4-12
 8
 125
 3
 305

DATE	TEST NO.	DEPTH	PRE-WET		TEST - 1" DROP		TIME
			START	STOP	START	STOP	
	15	4'	150	155	155	205	10
	9	13'	150	155	155	205	10
	25	5	151	155	155	203	8
	9	14 1/2'	152	158	155	201	6

39
 125
 49
 375
 38

REMARKS _____
 TYPE OF SOIL _____
 TESTED BY _____ ALSO PRESENT: _____