

Approved
10/7/77
TSD

P 26325
A 25622 26325

10/7/77

PERMIT

SEWAGE DISPOSAL SYSTEM

MARYLAND STATE DEPARTMENT OF HEALTH

HOWARD COUNTY

05-371325

ELLICOTT CITY

DISTRICT 5th

INDEXED

DATE 6/30/77

Jack Fyock

IS PERMITTED TO INSTALL ALTER

ADDRESS 13775 Triadelphia Road, Glenelg, Md.

PHONE 988-9720

A SEWAGE DISPOSAL SYSTEM LOCATED AT

SUBDIVISION

ROAD

5442 HARKES FARM LANE
Ten Oaks Road

LOT 17

PROPERTY OWNER

Brian Willson Robert L. Geiger

ADDRESS

SPECIFICATIONS 4 bedrooms

DRAIN FIELD _____ DEPTH _____ FEET, BOTTOM AREA _____ SQ. FT.

SEEPAGE PITS _____ ABSORBENT SIDE-WALL AREA _____ SQ. FT.

SEPTIC TANK CAPACITY 1250 GALLONS

BLDG. PERMIT SIGNED
AND RETURNED 9/22/77

Serial No. 32794

FOR GARBAGE GRINDER, INCREASE DISPOSAL AREA 22% & TANK CAPACITY 50%.

OTHER DRY WELL OR DRY WELL AND TRENCH - Dry well to have 130 sq. ft. effective absorbent sidewall area per bedroom below inlet. Inlet to be 4 1/2 ft. below original grade and maximum depth 12 ft. below original grade. Locate dry well per plat - 245 ft. up from left rear line corner and 150 ft. from left line when facing lot from right-of-way road. If trench is needed leave 5 ft. earth buffer between dry well and trench ~~xxxxxxx~~ and run necessary distance to make up needed sidewall area called for in system.

NOTE: CALL FOR INSPECTION OF TRENCH BEFORE PLACING GRAVEL IN TRENCH. NOTE: NO DRY WELL IS TO EXCEED 15 FOOT IN DIAMETER. NOTE: ALL PIPE FROM HOUSE TO DISPOSAL AREA MUST BE CAST IRON. PERMIT VOID AFTER THREE YEARS. NOTE: INSTALL STAND PIPES ON SEPTIC TANK AND DRY WELL. STAND PIPES MUST BE 6 INCHES IN DIAMETER. CAST IRON, CONCRETE OR

PLANS APPROVED BY Charles B. Streaker

DATE 2/7/77

TERRA COTTA ACCEPTED.

FILL SEPTIC TANK AND DISTRIBUTION BOX WITH WATER BEFORE CALLING FOR AN INSPECTION. COVER NO WORK UNTIL INSPECTED AND APPROVED.

NEITHER THE HOWARD COUNTY COMMISSIONERS NOR THE HEALTH DEPARTMENT IS RESPONSIBLE FOR THE SUCCESSFUL OPERATION OF ANY SYSTEM.

Trench 100' long - 11 1/2' deep - 7 ft stone follow contour of ground. & call for inspec of trench before gravel is installed

26325
25622

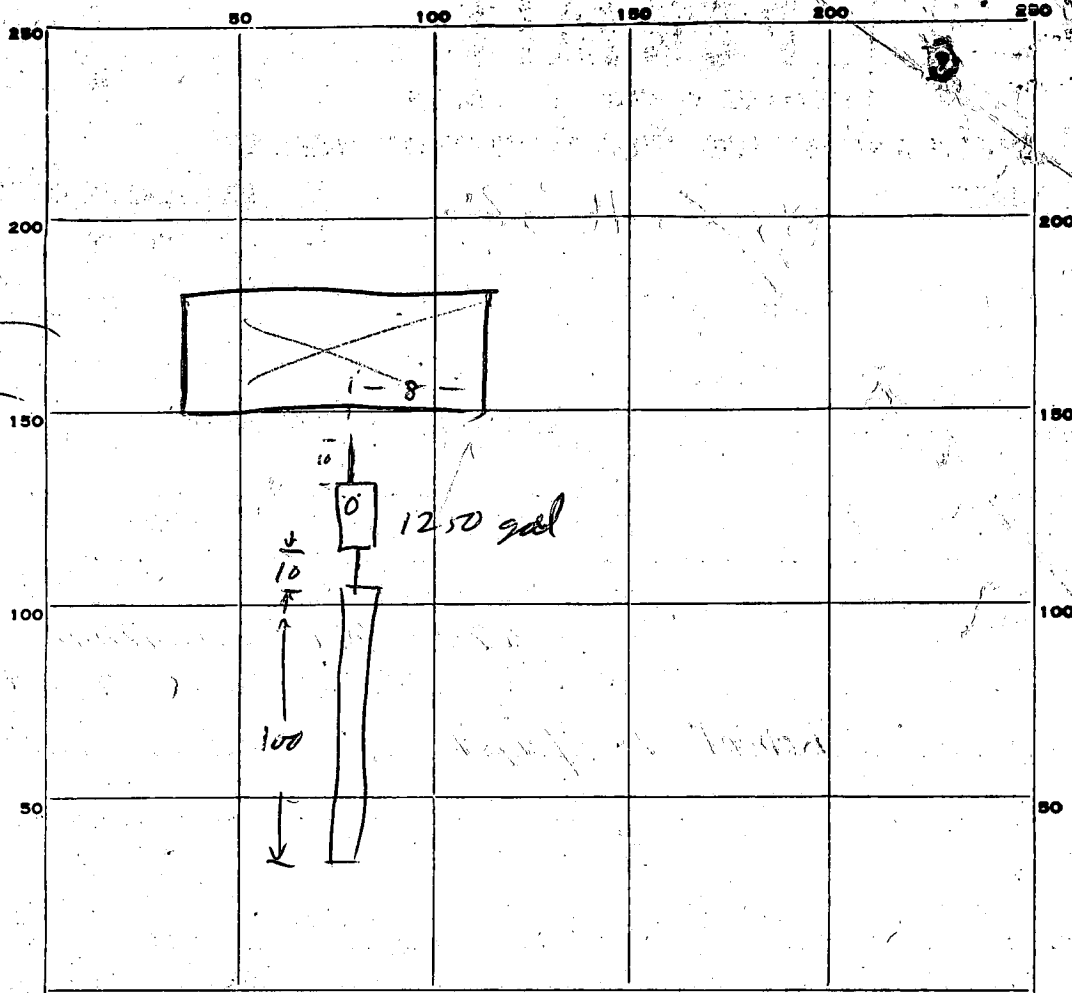

INDICATE NORTH. - NAME ADJOINING ROADWAY AS BASE LINE.

PERMIT CARD

Ten Oaks

SEPTIC TANK, LEVEL

CLEANOUTS

DISTRIBUTION BOX, LEVEL

TILE FIELD, DEPTH $11\frac{1}{2}$ FT. TRENCH WIDTH 2 FT.

GRAVEL DEPTH 7 ft. TOTAL LENGTH 100 FT.

NUMBER OF TRENCHES 1 TOTAL BOTTOM AREA 700

SEEPAGE PITS, INSIDE DIAMETER ~~4~~ FT. DEPTH BELOW INLET

ABSORBENT AREA 700 SQ. FT.

REMARKS 19 lps - no plumbing in house

OK To cover, must see house connection
10/7/77 T.S.O. : House connection ~~not~~ made.

DATE SYSTEM APPROVED

10/7/77

INSPECTOR

T.S. O'Connell

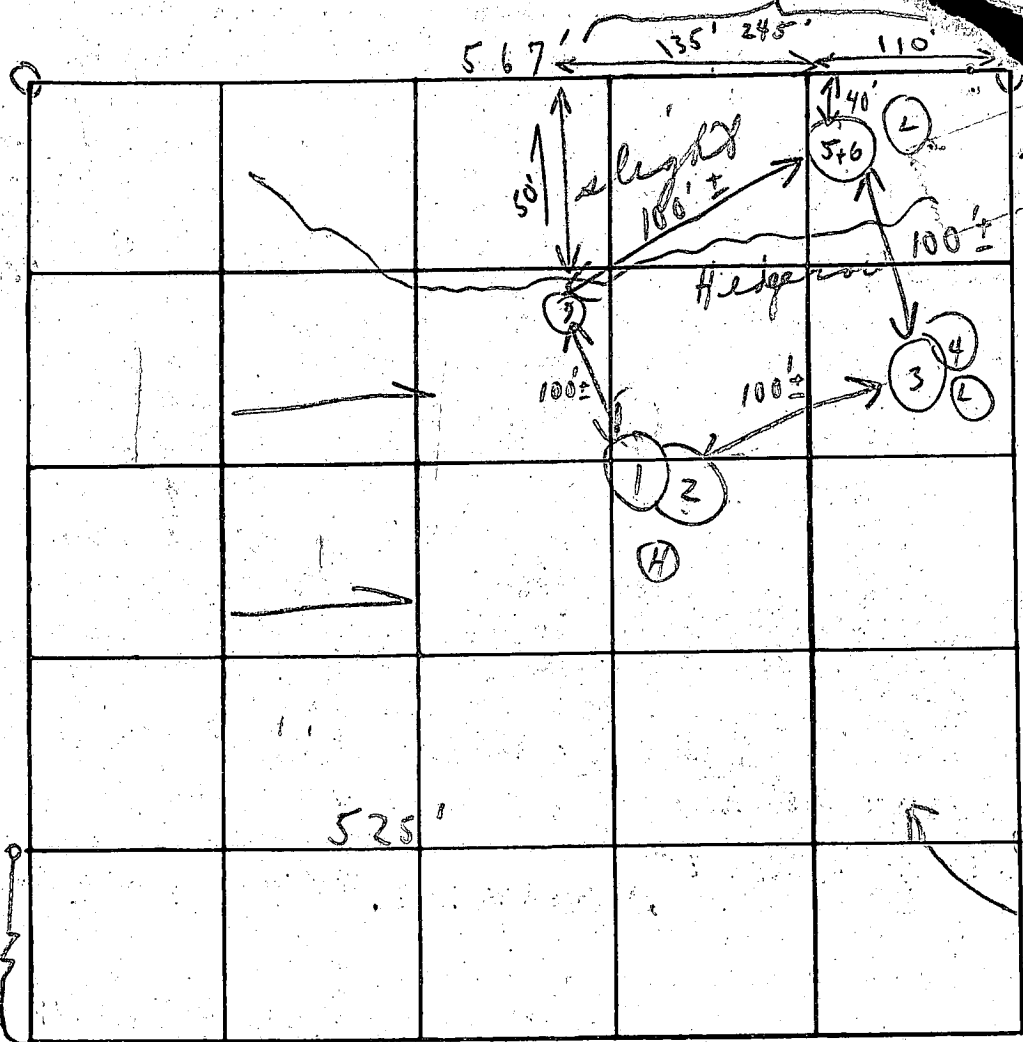

INDICATE NORTH - NAME ADJOINING ROADWAY AS BASE LINE

Ten Oaks Rd

Soil Profile	DATE	TEST NO.	DEPTH	PRE-WET		TEST - 1" DROP		TIME	
				START	STOP	START	STOP		
1'-4 1/2' clay	7/30/76	Val 1	4 1/2'	10:02	10:03	10:03	10:09	6 min	
9 1/2' loam		(H) 2	14'	10:02	10:03	10:03	10:07	4 min	
1'-5' clay		3	5'	10:11	10:13	10:13	10:16	3 min	
9' loam		(L) 4	14'	10:11	10:13	10:13	10:17	4 min	
1'-4 1/2' clay		5	4 1/2'	10:18	10:19	10:19	10:21	2 min	
9' loam		(D) 6	7 3/2'	10:18	10:19	10:17	10:21	2 min	
		(A) 7	13'	Visual similar to others				6:21	4 min

REMARKS: Property lines staked. Open field except hedge row.

TYPE OF SOIL: Sandy loam below clay

TESTED BY: C. B. S. [unclear] ALSO PRESENT: J. F. [unclear] + men



HERBERT M. SACHS
DIRECTOR

STATE OF MARYLAND
DEPARTMENT OF NATURAL RESOURCES
WATER RESOURCES ADMINISTRATION
TAWES STATE OFFICE BUILDING
ANNAPOLIS, MARYLAND 21401

September 14, 1977

Mr. L. Franklin Easterday, Sr.
9265 Brown Church Road
Mount Airy, Maryland 21771

RE: Well Construction
Permit #HO-73-2225

Dear Mr. Easterday:

I have received the well completion report requested in my letter to you of August 31, 1977. I have also received a report from the Howard County Health Department well inspector (Sanitarian).

The well in question meets standards. However, I see no reason why the well could not have been grouted in the presence of the Sanitarian. You grouted the well to 63 feet and Water Resources Regulations require that the grout (drop) pipe extend to this depth. It would have been a simple matter to grout the well instead of arguing over whether or not 40 feet of pipe was required. Frankly, this is not the type of case that should come to my attention.

Sincerely,

A handwritten signature in cursive script, appearing to read "Arnold Schiffman".

Arnold Schiffman
Chief, Permits Division

AS:mw

cc: Mr. Palmer Wine, Howard Co. Health Dept.

Sept 13, 1977

Palmer Wine
Environmental Health
County Office Bldg
Ellicott City, Md

Dear Mr Wine

Please be advised that I accept the construction ofv
the well on Lot I7 Ten Oaks Farm as being satisfactory and
herewith request that you release the Building Permit on This
Lot. The well was drilled under Permit no. HC -73-2225.

Thank You

Edwin G. Willson

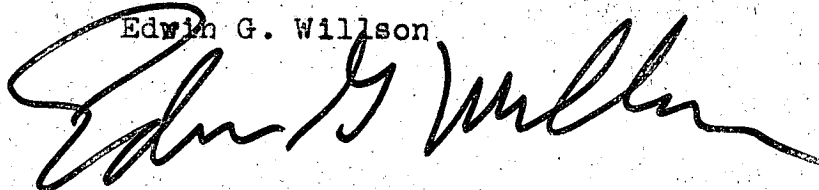
A handwritten signature in cursive script, appearing to read "Edwin G. Willson", written in dark ink over the typed name.



HERBERT M. SACHS
DIRECTOR

STATE OF MARYLAND
DEPARTMENT OF NATURAL RESOURCES
WATER RESOURCES ADMINISTRATION
TAWES STATE OFFICE BUILDING
ANNAPOLIS, MARYLAND 21401

August 31, 1977

Mr. L. Franklin Easterday, Sr.
9265 Brown Church Road
Mount Airy, MD 21771

Re: Well Construction Permit #H0-73-2225

Dear Mr. Easterday:

I am in receipt of your letter of August 26, 1977 requesting a deviation from well construction standards pursuant to Water Resources Regulation .08.05.02.03C(1)h.

Your explanation as to why you feel that the well bore was not bridged by caved material from 63 to 88 feet appears to be technically sound. The fact that you report a sandy formation as the caving material reinforces this judgement.

Your letter states that you have grouted and completed the well. Under the regulation cited above, the Administration must make a determination as to whether or not the well meets standards; if not, it shall be abandoned and sealed. Based on your letter, I see no reason not to grant the requested deviation from standards; however, I will need the well completion report to finalize my determination. Kindly submit this well completion report as soon as possible.

As you know, requests for a deviation from standards for caving conditions is becoming a significant problem. On the one hand I recognize the field realities of drilling wells and respect your judgement as a Licensed Master Well Driller. On the other hand, I see responsible officials of the Howard County Health Department trying their best to enforce grouting requirements. In granting these deviations from standards, I am, at least in part, substituting my judgement for the judgement of the county official in the field. Although I can and will exercise this judgement in an isolated case, I obviously cannot and will not do it on a routine basis.

We are drafting regulations to try to narrow the "gray areas" involved with caving conditions. However, I do not feel that these gray areas can be completely eliminated. Therefore, I suggest that you increase your cooperative efforts with Howard County. From a practical standpoint, there are only two ways that you can demonstrate the nature of caving conditions: either physically demonstrate it in the field by jetting or some other technique or show, by means of your knowledge as a well driller and specific information obtained during drilling, that there is complete caving and filling of the annular space without voids.

Sincerely,

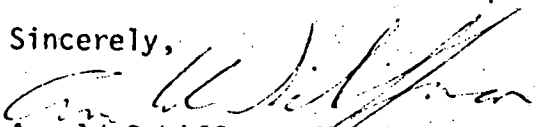
Arnold Schiffman, Chief
Permits Division

AS:dlk

cc: Palmer Mine Howard County



L. FRANKLIN EASTERDAY, INC.

WELL DRILLING . PUMP INSTALLATION & SERVICE

Rt. 3 - Phone 829-1640

MT. AIRY, MARYLAND 21771

August 26, 1977

Mr. Arnold Shiffman
Department of Natural Resources
Tawes Office Building
Annapolis, Maryland

Dear Mr. Shiffman:

Per our conversation, this is to notify you of the following deviations from the standards provided in the Rules and Regulations of the Maryland State Department of Natural Resources governing water well construction standards and being Regulation No. 8.05.02.03 C (2) i (3).

In this reference well, we have a "cave in" which I believe would justify a deviation pursuant to Regulation 8.05.02.03 C (1) h, and an application of coastal plain or other standards. In that specific regard, we believe a required grouting to forty (40) feet would be both equitable to all parties and safe for potential users of this well. (however we would actually have 63 feet of grout). The well is designated as Permit No. HO-73-2225, Ten Oaks Farms Lot 17, with 88 feet casing, 63 feet open hole, and we plan to grout the well today at 2:30 pm, in order to avoid any other chances of further cave ins.

In the process of drilling the overburden, we hit a sandy formation at 30-70 feet. We hit some water at 60 feet causing a cave in at that point. We had to push the casing through the sand that had caved from approximately 63 feet to the 88 feet in the sand rock.

It is my professional opinion that there is not any bridging from the 63 feet to the bottom of the casing, because we had to actually push the casing through the sand in order to get a seal in to the rock.

Please let us hear from you at the earliest possible moment as to this matter as building permits are being withheld.

Thank you for your cooperation and attention to this matter.

Very truly yours,

L. Franklin Easterday, Sr.
L. Franklin Easterday, Sr.
President

LFE/ob

C 1 1086 SEQUENCE NO. (WRA USE ONLY)

1 2 3 4 5 6 (THIS NUMBER IS TO BE PUNCHED IN COLS. 3-6 ON ALL CARDS)

STATE OF MARYLAND
WATER RESOURCES ADMINISTRATION
TAWES STATE OFFICE BLDG., ANNAPOLIS, MD. 21401
WELL COMPLETION REPORT

THIS REPORT MUST BE SUBMITTED WITHIN 30 DAYS AFTER WELL COMPLETION

FILL IN THIS FORM COMPLETELY

COUNTY NUMBER A 23622

DATE RECEIVED (WRA USE ONLY) 8/26/75 DATE WELL COMPLETED

DEPTH OF WELL 260 (TO NEAREST FOOT)

PERMIT NO. FROM "PERMIT TO DRILL WELL" 73-2225

DRILLERS IDENTIFICATION NO. 92

OWNER: Wilson Brian LAST NAME FIRST NAME

STREET OR RFD 14507 ... POST OFFICE

WELL LOG

STATE THE KIND OF FORMATIONS PENETRATED, THEIR COLOR, DEPTH, THICKNESS AND IF WATER BEARING

DESCRIPTION (USE ADDITIONAL SHEETS IF NECESSARY)	FEET		CHECK IF WATER BEARING
	FROM	TO	
Top soil	0	2	
slaty	2	30	
slaty	30	70	
SAND Stone	70	95	✓
rock	95	150	
rock	150	160	
rock	160	260	✓

GROUTING RECORD

WELL HAS BEEN GROUTED (CIRCLE APPROPRIATE BOX) YES [Y] NO [N]

TYPE OF GROUTING MATERIAL (CIRCLE BOX) CEMENT [CM] BENTONITE CLAY [BC]

NO. OF BAGS 24 NO. OF POUNDS 2400

GALLONS OF WATER 125

DEPTH OF GROUT SEAL (TO NEAREST FOOT) FROM 0 FT. TO 63 FT.

CASING RECORD

INSERT APPROPRIATE CODE BELOW: [S] [T] [C] [O] [P] [L] [O] [T]

STEEL CONCRETE PLASTIC OTHER

MAIN CASING TYPE [S] [T] NOMINAL DIAMETER TOP (MAIN) CASING (NEAREST, INCH) 6 TOTAL DEPTH OF MAIN CASING (NEAREST FOOT) 88

OTHER CASING (IF USED)

DIAMETER (INCH) DEPTH (FEET) FROM TO

SCREEN RECORD

INSERT APPROPRIATE CODE BELOW: [S] [T] [B] [R] [H] [O] [P] [L] [O] [T]

STEEL BRASS OR BRONZE OPEN HOLE PLASTIC OTHER

DEPTH (NEAREST WHOLE FOOT)

FROM 8 TO 260

SLOT SIZE 1, 2, 3

DIAMETER OF SCREEN 56 (NEAREST INCH) FROM TO

GRAVEL PACK

IF WELL DRILLED WAS A FLOWING WELL CIRCLE BOX 68 [F]

WRA USE ONLY (NOT TO BE FILLED IN BY DRILLER) TELESCOPE CASING LOG INDICATOR

PUMPING TEST

HOURS PUMPED (TO NEAREST HOUR) 3

PUMPING RATE (GALLONS PER MINUTE TO NEAREST GALLON) 5

METHOD USED TO MEASURE PUMPING RATE Bucket

WATER LEVEL: (DISTANCE FROM LAND SURFACE) BEFORE PUMPING 17 (NEAREST FOOT) 20

WHEN PUMPING 22 (NEAREST FOOT) 25

TYPE OF PUMP USED (CIRCLE APPROPRIATE BOX) [A] AIR [P] PISTON [T] TURBINE [C] CENTRIFUGAL [R] ROTARY [O] OTHER [J] JET [S] SUBMERSIBLE

PUMP INSTALLED

TYPE OF PUMP (WRITE APPROPRIATE LETTER IN BOX - SEE ABOVE: A, C, J, P, R, S, T, O)

DRILLER WILL INSTALL PUMP (CIRCLE APPROPRIATE BOX) YES [Y] NO [N]

CAPACITY: GALLONS PER MINUTE (TO NEAREST GALLON) 31 35

PUMP HORSE POWER 37 41

PUMP COLUMN LENGTH (NEAREST FOOT) 43 47

CASING HEIGHT (CIRCLE APPROPRIATE BOX AND ENTER CASING HEIGHT) [] ABOVE [] BELOW LAND SURFACE (NEAREST FOOT) 50 51

LOCATION OF WELL ON LOT

SHOW PERMANENT STRUCTURE SUCH AS BUILDINGS, SEPTIC TANKS, AND/OR OTHER LAND MARKS AND INDICATE NOT LESS THAN TWO DISTANCES (MEASUREMENTS TO WELL).

CIRCLE APPROPRIATE BOXES

[A] A WELL WAS ABANDONED AND SEALED WHEN THIS WELL WAS COMPLETED

[E] ELECTRIC LOG OBTAINED

[P] TEST WELL CONVERTED TO PRODUCTION WELL

I HEREBY CERTIFY THAT I HAVE COMPLIED WITH ALL CONDITIONS STATED ON THE ABOVE-CAPTIONED "PERMIT TO DRILL WELL", AND THAT INFORMATION CONTAINED IN THIS REPORT IS TRUE, ACCURATE, AND COMPLETE TO THE BEST OF MY KNOWLEDGE, INFORMATION AND BELIEF.

DRILLERS NAME: J. P. ...

SIGNATURE: J. P. ...

APPLICATION

8
27
81
13
6

A 26336

SEWAGE DISPOSAL TESTING

STATE OF MARYLAND - DEPARTMENT OF HEALTH AND MENTAL HYGIENE

HOWARD COUNTY HEALTH DEPARTMENT
ENVIRONMENTAL HEALTH SERVICES

P.O. BOX 476 ELLICOTT, MARYLAND 21043
TELEPHONE: 992-2330

Septic Tank { 1-3 Bedrooms 1000 gallons
4 Bedrooms 1250 gallons

Dry well to have 120 sqft. effective absorbent
sidewall area per bedroom below inlet. Inlet to be
2 1/2' below original grade and maximum depth
per engineer's plat. 50' off right property line and
225' from rear property line when facing lot from
Kalmia Drive. (Per table (1+2))

TO: THE COUNTY HEALTH OFFICER
ELLICOTT CITY, MARYLAND

4/13/83 REVISED SPECS

10 FT DEEP
DRYWELL

I HEREBY APPLY FOR THE NECESSARY TEST IN ORDER TO CONSTRUCT (OR RECONSTRUCT) A SEWAGE DISPOSAL SYSTEM.

PROPERTY OWNER

Michael + Joan Pometto

ADDRESS

~~ADD A DEEP DITCH OFF DW IF~~

NECESSARY AFTER 5 FT EARTH BUTTER

5016 Mineola Road
College Park, Maryland 20740

PROPERTY LOCATION

DITCH TO BE 10 FT DEEP WITH INLET

SUBDIVISION

KALMIA FARMS SEC. I. LOT NO. 1 sec. 1

ROAD AND DESCRIPTION

3 FT B.O.G. RUN THE DITCH TOWARD THE
NORTH SIDE OF THE LOT

5201 Kalmia Drive

SIZE OF LOT

TYPE BLDG.

4 Bedrooms per Mr. Pometto

THE SYSTEM INSTALLED UNDER THIS APPLICATION IS ACCEPTABLE ONLY UNTIL PUBLIC FACILITIES BECOME AVAILABLE

I FULLY UNDERSTAND THE FEE CONNECTED WITH THE FILING OF THIS PERC TEST APPLICATION IS NON-REFUNDABLE UNDER

ANY CIRCUMSTANCES.

SIGNATURE OF APPLICANT

APPROVED BY

C. B. Straker

FOR

Dry Well

DATE

2/13/79

REJECTED BY

FOR

DATE

HOLD PENDING FURTHER TESTS

DATE

REASONS FOR REJECTION OR HOLDING

10/23/78 Reaccomplished at office.

BLDG. PERMIT SIGNED

AND RETURNED

4/24/83
Serial # 53137

THIS IS NOT A PERMIT

DRYTON

240'

SOIL PROFILE

Below
clay
Sandy
loam

TRIAD DELPHIA MILL ROAD

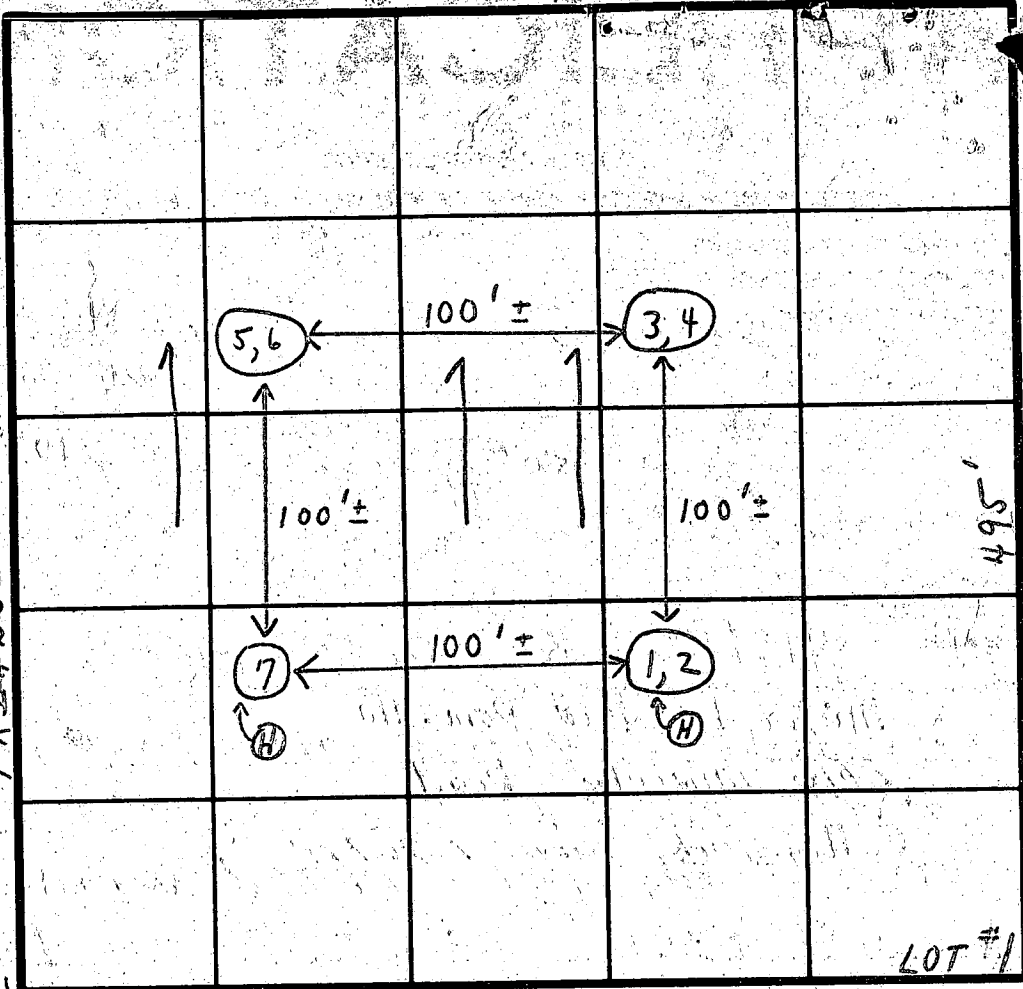

INDICATE NORTH - NAME ADJOINING ROADWAY AS BASE LINE.

(← slope indicates)

Existing dirt road

DATE	TEST NO.	DEPTH	PRE-WET		TEST - 1" DROP		TIME	
			START	STOP	START	STOP		
8/9/77	1	2 1/2'	10:03	10:05	10:05	10:10	5 min	
	(H) 2	12 1/2'	10:04	10:06	10:06	10:12	6 min	
	3	4 1/2'	10:06	10:12	10:12	10:16	4 min	
	(L) 4	13 1/2'	10:06	10:09	10:09	10:26	17 min	
	5	3'	10:08	10:13	10:13	10:17	4 min	
	(L) 6	12 1/2'	10:08	10:13	10:13	10:25	12 min	
	7	12'	Visual similar to these					
						6	148	

Inlet
2 1/2'
8 min.
avg.

REMARKS { Reacomplished field sheet 10/23/78 }
 C.B.V.
 TYPE OF SOIL
 TESTED BY C.B.V. ALSO PRESENT (J. F. York Jr. + crew)

B 0439

SEQUENCE NO. (OEP USE ONLY)

STATE OF MARYLAND PERMIT TO DRILL WELL

OEP PERMIT NUMBER

HO-81-0037

THIS NUMBER IS TO BE PUNCHED IN PLACES 3-6 ON ALL CARDS)

fill in this form completely

Date Received

022183

OWNER INFORMATION

POMETTO, MICHAEL A

5016 MINEOLA RD.

COLLEGE PARK MD 20740

B 3

LOCATION OF WELL

HOWARD

KALMIA FARMS

SECTION 1 LOT 1

DAYTON

MILES FROM TOWN (enter 0 if in town) 4 MI

B 4

DIRECTION OF WELL FROM TOWN (CIRCLE BOX)

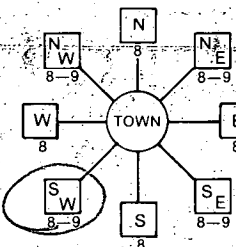

Kalmia Dr.

NEAR WHAT ROAD

ON WHICH SIDE OF ROAD (CIRCLE APPROPRIATE BOX)



DISTANCE FROM ROAD 100

ENTER FT or MI

DRILLER INFORMATION

Ronald L. Kyker

Westminster Rotary Well Drilling, Inc.

P.O. Box #861, Westminster, Md. 21157

Signature: Ronald L. Kyker Date: 2/21/83

B 2 WELL INFORMATION

APPROX. PUMPING RATE (GAL. PER MIN.) 5

AVERAGE DAILY QUANTITY NEEDED (GAL. PER DAY) 550

USE FOR WATER (CIRCLE APPROPRIATE BOX)

- D HOME (SINGLE OR DOUBLE HOUSEHOLD UNIT ONLY)
F FARMING (LIVESTOCK WATERING & AGRICULTURAL IRRIGATION)
I INDUSTRIAL, COMMERCIAL, STATE AND FEDERAL GOV. OTHER (REQUIRES APPROPRIATION PERMIT)
P PUBLIC OR PRIVATE WATER COMPANY (REQUIRES APPROPRIATION PERMIT AND STATE HEALTH DEPARTMENT APPROVAL)
T TEST, OBSERVATION, MONITORING (MAY REQUIRE APPROPRIATION PERMIT)

NOT TO BE FILLED IN BY DRILLER HEALTH DEPARTMENT APPROVAL

HOWARD

A26336

COUNTY NAME COUNTY NO. OEP SIGNATURE STATE HEALTH INSERT S

DATE ISSUED 032983 Frank Shi 9/29/83

NORTH GRID 508000 EAST GRID 0795000

APPROXIMATE DEPTH OF WELL 175 FEET

APPROXIMATE DIAMETER OF WELL 6 INCH

METHOD OF DRILLING (circle one)

- BORED (or Augered) JETTED Jetted & DRIVEN
AIR-ROtary AIR-PERcussion ROTARY (Hydraulic Rotary)
CABLE REVERSE-ROtary DRIVE-POINT

REPLACEMENT OR DEEPEMED WELLS (CIRCLE APPROPRIATE BOX)

- N THIS WELL WILL NOT REPLACE AN EXISTING WELL
Y THIS WELL WILL REPLACE A WELL THAT WILL BE ABANDONED AND SEALED
S THIS WELL WILL REPLACE A WELL THAT WILL BE USED AS A STANDBY
D THIS WELL WILL DEEPEM AN EXISTING WELL

PERMIT NUMBER OF WELL TO BE REPLACED OR DEEPEMED (IF AVAILABLE)

Not to be filled in by driller (OEP USE ONLY)

APPROP. PERMIT NUMBER GAP

FORCE INITIALS PERMIT NO. HO-81-0037

SPECIAL CONDITIONS

SHOW MAJOR FEATURES OF BOX & LOCATE WELL WITH AN X

SOURCES OF DRILLING WATER

- 1 City
2
3

WRITE THE BOX NUMBER FROM THE MAP HERE

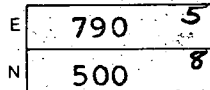

DRAW A SKETCH BELOW SHOWING LOCATION OF WELL IN RELATION TO NEARBY TOWNS AND ROADS AND GIVE DISTANCE FROM WELL TO NEAREST ROAD JUNCTION

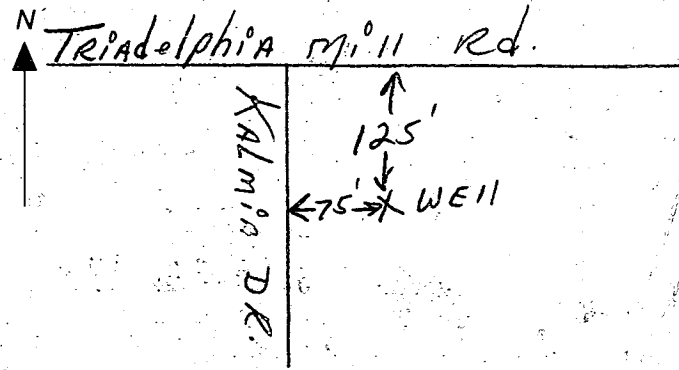

W = WELL
DH = DRY HOLE

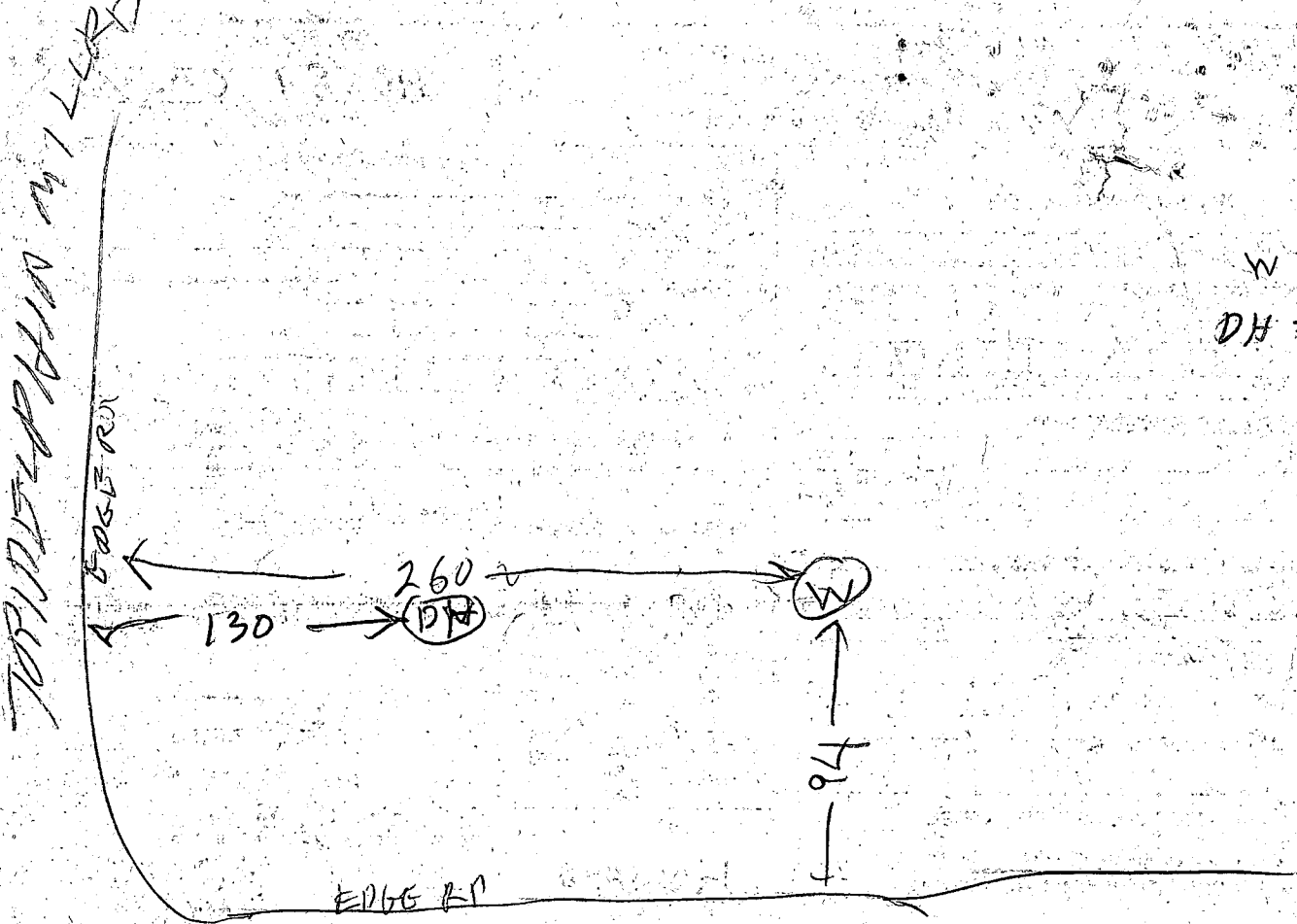

KALMIA RR

- ① LOCATION OK
- ② 82 FT CASING
- ③ Over 38 FT open Hole MEASURED WITH A STRING
(STRING NOT LONG ENOUGH)
- ④ 34 BAGS
- ⑤ DRY HOLE FILLED WITH CEMENT

B. Rudy
4/8/83

C1 7691

SEQUENCE NO. (OEP USE ONLY)

STATE OF MARYLAND WELL COMPLETION REPORT

THIS REPORT MUST BE SUBMITTED WITHIN 45 DAYS AFTER WELL IS COMPLETED.

(THIS NUMBER IS TO BE PUNCHED IN COLS. 3-6 ON ALL CARDS)

COUNTY NUMBER A26336

Date Received (OEP use only)

DATE WELL COMPLETED

Depth of Well

PERMIT NO.

FROM PERMIT TO DRILL WELL

0401833

203

40-81-0037

(TO NEAREST FOOT)

OWNER Pometto Michael A

STREET OR RD Kalmia Drive TOWN Dayton

SUBDIVISION Kalmia Farms SECTION 1 LOT 13

WELL LOG Not required for driven wells STATE THE KIND OF FORMATIONS PENETRATED, THEIR COLOR, DEPTH, THICKNESS AND IF WATER BEARING

Table with columns: DESCRIPTION, FEET (FROM, TO), Check if water bearing. Rows include: Dirt (0-1), Soft Brown Sand & Mica (1-14), Flint Rock (14-16), Soft Brown Sand & Clay (16-30), Soft Brown Sandstone (30-63), Soft Brown Sand (63-68), Soft Brown Sandstone (68-79), Hard Black Sandstone (79-90), Hard Brown Sandstone (90-91), Blue Sandstone (91-94), Brown Sandstone (94-96), Brown & Blue Sandstone (96-130), Black & Blue Sandstone & Schist (130-203).

WELL HAS BEEN GROUTED (Y) TYPE OF GROUTING MATERIAL CEMENT (CM) BENTONITE CLAY (BC) NO. OF BAGS 34 NO. OF POUNDS 3196 GALLONS OF WATER 204 DEPTH OF GROUT SEAL (to nearest foot) from 0 ft. to 82 ft.

CASING RECORD STEEL (S) CONCRETE (CO) PLASTIC (PL) OTHER (OT) MAIN CASING TYPE (S) Nominal diameter 6 1/2 inch Total depth of main casing 84' 10"

OTHER CASING (if used) diameter inch depth (feet) from to

SCREEN RECORD STEEL (ST) BRASS (BR) OPEN HOLE (HO) PLASTIC (PL) OTHER (OT) SLOT SIZE

DEPTH (nearest ft.) 84' 10" 203

CIRCLE APPROPRIATE BOX A WELL WAS ABANDONED AND SEALED WHEN THIS WELL WAS COMPLETED E ELECTRIC LOG OBTAINED P TEST WELL CONVERTED TO PRODUCTION WELL

I HEREBY CERTIFY THAT THIS WELL HAS BEEN CONSTRUCTED IN ACCORDANCE WITH COMAR 10.17.13 "WELL CONSTRUCTION" AND IN CONFORMANCE WITH ALL CONDITIONS STATED IN THE ABOVE CAPTIONED PERMIT...

DRILLERS IDENT. NO. 296 Ronald L. Kyker

DRILLERS SIGNATURE (MUST MATCH SIGNATURE ON APPLICATION) SITE SUPERVISOR (sign. of driller or journeyman responsible for sitework if different from permittee)

DIAMETER OF SCREEN (NEAREST INCH) GRAVEL PACK IF WELL DRILLED WAS FLOWING WELL CIRCLE BOX (F)

OEP USE ONLY (NOT TO BE FILLED IN BY DRILLER) T (E.R.O.S.) W.Q. TELESCOPE CASING LOG INDICATOR OTHER DATA

PUMPING TEST HOURS PUMPED PUMPING RATE (gal. per min. to nearest gal.) METHOD USED TO MEASURE PUMPING RATE (Submersible) WATER LEVEL (distance from land surface) BEFORE PUMPING 31 WHEN PUMPING 152 TYPE OF PUMP USED (for test) S submersible

PUMP INSTALLED DRILLER WILL INSTALL PUMP (Y) IF DRILLER INSTALLS PUMP, THIS SECTION MUST BE COMPLETED FOR ALL WELLS EXCEPT HOME USE TYPE OF PUMP (WRITE APPROPRIATE LETTER IN BOX) CAPACITY: GALLONS PER MINUTE PUMP HORSE POWER PUMP COLUMN LENGTH (nearest ft.) CASING HEIGHT (circle appropriate box and enter casing height) + above LAND SURFACE - below 2 (nearest foot)

LOCATION OF WELL ON LOT SHOW PERMANENT STRUCTURE SUCH AS BUILDING, SEPTIC TANKS, AND/OR LANDMARKS AND INDICATE NOT LESS THAN TWO DISTANCES (MEASUREMENTS TO WELL) Kalmia DR 130' Good X WELL DRY X WELL

KALMIA FARMS
Lot 1, Sect 1

4/13/93

Plans Rejected

- ① Plans should show actual well (Well has been drilled in revised site)
- ② Drywell should be placed in spot described in septic system specifications
- ③ Show elevation at dry well site before test & as it is now
- ④ Use only one Dry Well & if necessary add a ditch off DW after 5 FT earth Buffer
- ⑤ Put cleanout on sewer lines every 75 FT

4/14/93 Called Jim Marka (Not involved in this project)
Called Ryan Homer 833 8900
They will contact their surveyor Mr. Rogers about this

STATE OF MARYLAND
DEPARTMENT OF HEALTH AND MENTAL HYGIENE
LABORATORIES ADMINISTRATION
REPORT OF WATER ANALYSIS

Bottle Number: H 9239 Name: KALMIA LANE'S LITTLE County: HOWARD

Source of Sample: KALMIA DR Street: DAVON Town or City: Collector: FLORES

Sample Type (Circle): Community Source Non-Community Distribution Private MCL Emergency Recheck Routine

Remarks: NITRATE ONLY MICHAEL GONETTO
WELL # W810037

County: 13 Plant No. Sampling Station Date Collected: 040893 Time: 11 AM Acid Iced

Field Data: pH* Chlorine Residual: Free Total Specific Conductance

ANALYSIS	CODE	RESULTS	ANALYSIS	CODE	RESULTS
pH*	011		Arsenic	253	
Alkalinity (Total)	040		Barium	262	
Alkalinity (HCO ₃)	050		Cadmium	273	
Alkalinity (CO ₃)	060		Chromium	283	
pH*, Ca CO ₃ SAT.	071		Lead	302	
Alkalinity, Ca CO ₃ SAT.	080		Mercury	314	
Hardness	110		Selenium	323	
Ammonia-N	143		Silver	333	
<input checked="" type="checkbox"/> Nitrate-Nitrite N	162	<u>1.8</u>	Aluminum	192	
Nitrite N	173		Calcium	231	
MBAS	182		Copper	241	
Chloride	091		Iron	122	
Fluoride	101		Magnesium	241	
Color*	020		Manganese	133	
Turbidity*	031		Nickel	391	
Conductance*, SPEC.	201		Potassium	361	
Silica	210		Sodium	371	
Sulfate	220		Zinc	342	
Total Residue	381				

* Results reported in units, all others in milligrams per liter (ppm)

Date Received: JAN 1 1993 Date Reported: JAN 12 1993 Chemist: M Lab No.: 712485