

25897 File

# PERMIT

SEWAGE DISPOSAL SYSTEM

MARYLAND STATE DEPARTMENT OF HEALTH

HOWARD COUNTY

ELLICOTT CITY

DISTRICT 4th

5/23/77

## INDEXED

DATE 5/19/77

Arnold Septic Tank Service

IS PERMITTED TO INSTALL \_\_\_\_\_ ALTER X

ADDRESS Woodbine, Maryland 21797

PHONE 795-1285

A SEWAGE DISPOSAL-SYSTEM LOCATED AT \_\_\_\_\_

SUBDIVISION \_\_\_\_\_

ROAD 18001 Shaffers Mill Road - see application for directions LOT \_\_\_\_\_

PROPERTY OWNER Mrs. Griffin

ADDRESS Shaffers Mill Road, Mt. Airy, Maryland 21771

SPECIFICATIONS 3 bedrooms  
4 bedrooms

DRAIN FIELD \_\_\_\_\_ DEPTH \_\_\_\_\_ FEET, BOTTOM AREA \_\_\_\_\_ SQ. FT.

SEEPAGE PITS \_\_\_\_\_ ABSORBENT SIDE-WALL AREA \_\_\_\_\_ SQ. FT.

SEPTIC TANK CAPACITY 1000  
1250 GALLONS

FOR GARBAGE GRINDER, INCREASE DISPOSAL AREA 22% & TANK CAPACITY 50%.

OTHER DRY WELL - To have 175 sq. ft. effective absorbent sidewall area per bedroom below inlet. Inlet to be 4½ ft. below original grade and maximum depth 11½ ft. below original grade. Locate the dry well 45 ft. from left rear corner of existing house when facing house from driveway. If trench is needed to make up rest of effective sidewall area leave 5 ft. earth buffer between dry well and trench. NOTE: CALL FOR INSPECTION OF TRENCH BEFORE PLACING GRAVEL IN TRENCH. NOTE: IN NO CASE IS ANY DRY WELL TO EXCEED 15 FOOT IN DIAMETER. NOTE: ALL PIPE FROM HOUSE TO DISPOSAL AREA MUST BE CAST IRON. PERMIT VOID AFTER THREE YEARS. NOTE: INSTALL STAND PIPE ON SEPTIC TANK AND DRY WELL. STAND PIPES MUST BE 6 INCHES IN DIAMETER. CAST IRON, CONCRETE OR TERRA COTTA ACCEPTED.

PLANS APPROVED BY Charles B. Streaker

DATE 5/16/77

FILL SEPTIC TANK AND DISTRIBUTION BOX WITH WATER BEFORE CALLING FOR AN INSPECTION. COVER NO WORK UNTIL INSPECTED AND APPROVED.

NEITHER THE HOWARD COUNTY COMMISSIONERS NOR THE HEALTH DEPARTMENT IS RESPONSIBLE FOR THE SUCCESSFUL OPERATION OF ANY SYSTEM.

25897

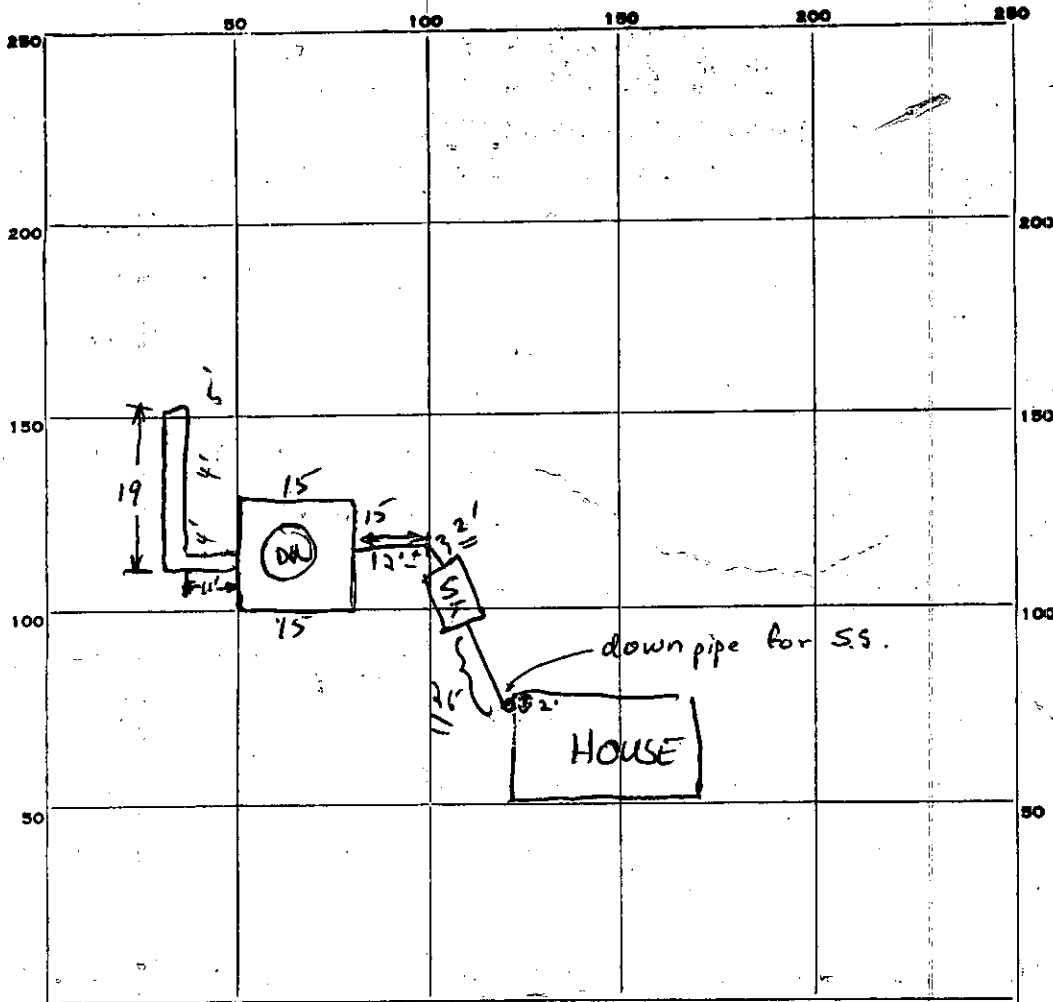

INDICATE NORTH. - NAME ADJOINING ROADWAY AS BASE LINE.

PERMIT CARD none seen / yes in tree

SEPTIC TANK, LEVEL 1250 gal CLEANOUTS ST | DW  
ok | ok

DISTRIBUTION BOX, LEVEL N/A

TRENCH FIELD, DEPTH 1 1/2 FT. TRENCH WIDTH 2 FT.

GRAVEL DEPTH 7 1/2 ± FT TOTAL LENGTH 19 FT.

NUMBER OF TRENCHES 1 TOTAL SIDEWALL AREA —

SEEPAGE PITS, INSIDE DIAMETER 60 FT. DEPTH BELOW INLET 6 1/2 FT.

ABSORBENT AREA 533 ± SQ. FT.

REMARKS 5/20/77 Inlet to DW will be ~ 4 3/4' below orig. grade. DW is 12' deep, eff ~~area~~ depth to 11 1/2'. WW2

5/23/77 Checked gravel to 5' of top of ground in DW well + trench to 4' of top of ground. C.B.D

DATE SYSTEM APPROVED 5/23/77 INSPECTOR C. B. D. Hunt

3 BR's  
175  
3  
58.33

19 1/2	60
6 1/2	60
114	360
10	390
124	124
19	514
	19
	533

# APPLICATION

A \_\_\_\_\_  
P \_\_\_\_\_

## SEWAGE DISPOSAL TESTING

STATE OF MARYLAND - DEPARTMENT OF HEALTH AND MENTAL HYGIENE

HOWARD COUNTY HEALTH DEPARTMENT  
ENVIRONMENTAL HEALTH SERVICES  
P. O. BOX 476, ELLICOTT CITY, MARYLAND 21043  
TELEPHONE: 465-5000, EXT. 356

DISTRICT 4th  
DATE 5/3/77

Septic Tank { 1-3 Bedrooms 1000 gallons  
4 Bedrooms 1250 gallons

*Repair perc*  
*5/9/77 p.m.*  
*1:30*

*⊕ Dry well to have 175 sqft. effective absorbent sidewall area per bedroom below inlet. Inlet to be 4 1/2' below original grade depth 11 1/2'. Location 45' from left rear corner of house when facing house from driveway (Perc hole 142) See back if needed*

TO: THE COUNTY HEALTH OFFICER  
ELLICOTT CITY, MARYLAND

I, HEREBY, APPLY FOR THE NECESSARY TEST IN ORDER TO CONSTRUCT (OR RECONSTRUCT) A SEWAGE DISPOSAL SYSTEM.

PROPERTY OWNER Mrs. Griffin

*⊕ Dry well + trench if used need*

ADDRESS Shaffers Mill Road, Mt. Airy, Md.

Any questions call Bud Arnold  
795-1285

PHONE

PROPERTY LOCATION:

*① 5' earth buffer between dry well + trench*  
*② Trench - before and after gravel*

SUBDIVISION \_\_\_\_\_

LOT NO. \_\_\_\_\_

ROAD AND DESCRIPTION Shaffers Mill Road - off Shaffersville Road - ~~xxxxxxx~~

~~3rd house~~ Rte. 144, left on St. Michael's Rd., right on Florence Rd., right on Shaffersville Road, left on Shaffers Mill Road - 2nd house on left - sits back off road.

SIZE OF LOT ?

TYPE BLDG. Existing House

IF NOT SINGLE RESIDENCE DESCRIBE \_\_\_\_\_

*Recommended 1250 gallon tank for 4 Bedrooms*  
*+/or 1000 gallon tank 3 Bedrooms*

THE SYSTEM INSTALLED UNDER THIS APPLICATION IS ACCEPTABLE ONLY UNTIL PUBLIC FACILITIES BECOME AVAILABLE.

SIGNATURE OF APPLICANT /s/ Bud Arnold

*175 sqft per bedroom below first 4 1/2' of original soil.*

APPROVED BY C.B. Stresker FOR Dry Well DATE 5/16/77  
(KIND OF SYSTEM)

REJECTED BY \_\_\_\_\_ FOR \_\_\_\_\_ DATE \_\_\_\_\_  
(KIND OF SYSTEM)

HOLD PENDING FURTHER TESTS \_\_\_\_\_ DATE \_\_\_\_\_

*5/9/77*  
REASONS FOR REJECTION OR HOLDING no back  
*C.B.S.*

# THIS IS NOT A PERMIT

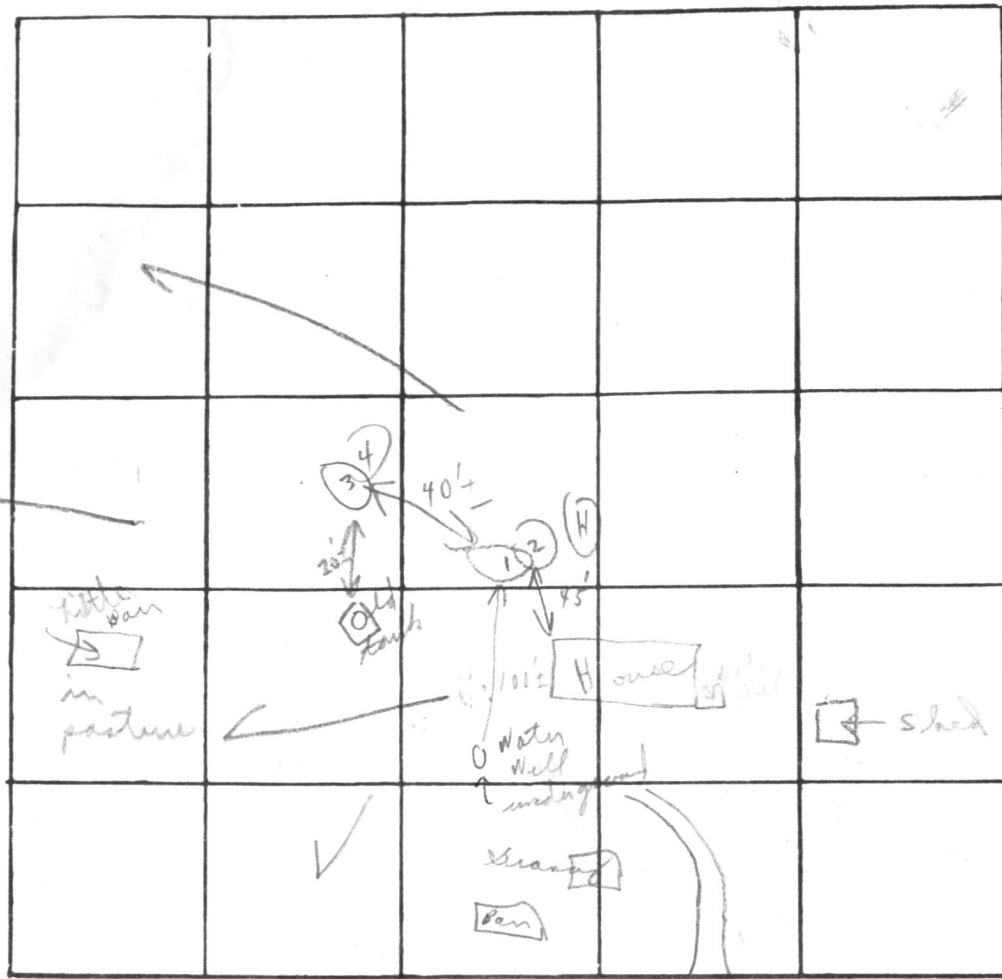

INDICATE NORTH. - NAME ADJOINING ROADWAY AS BASE LINE

DATE	TEST NO.	DEPTH	PRE-WET		TEST - 1" DROP		TIME	
			START	STOP	START	STOP		
5/2/77	1	4 1/2'	2:30	2:32	2:32	2:42	10m	
	2	12'	2:30	2:36	2:36	2:55	19m	
	3						29	
	4		(Visual similar to 1 & 2)					

REMARKS

Existing house & his plumbing

TYPE OF SOIL

TESTED BY

C. B. A.

ALSO PRESENT:

B. Arnold

5' soil profile  
from + to weathered  
bed shale  
below clay

1st well  
2" = 1 m  
15 min  
17.5 sq ft  
per bedroom  
below  
inlet  
Dial 4 1/2'

Recommended  
come off  
house 10' pad  
tank &  
run to 142

