

6/30/77 ~~around noon or 7:00 P.M.~~ Will Not be getting Approve ~~5/10/77~~ Sewer
5/11/77 will be ready at 10:00 A.M. 43555
5/23/77 1:30 P.M. house use pump pit 2" PVC pipe. 05-366259
7/1/77 final incomplete R.H. 7/1/77 incomplete

PERMIT

P 25849

SEWAGE DISPOSAL SYSTEM

MARYLAND STATE DEPARTMENT OF HEALTH

HOWARD COUNTY

100' Tracts 3-10' ~ 400' from

ELLICOTT CITY

DISTRICT 5th

DATE 5/10/77

Jenkins Brothers

Olen Kettuman

IS PERMITTED TO INSTALL

ALTER

ADDRESS Frederick Road, Ellicott City, Md. 21043

PHONE 465-6646

A SEWAGE DISPOSAL SYSTEM LOCATED AT

SUBDIVISION

ROAD 10841 Braeburn Road

LOT 7

PROPERTY OWNER

Mr. Sears Richard & Cathleen ~~Chiff~~ reached

ADDRESS 10841 Braeburn Road, Clarksville, Md.

Phone: 531-6639

SPECIFICATIONS

Cedar lane off 32

DRAIN FIELD _____ DEPTH _____ FEET, BOTTOM AREA _____ SQ. FT.

SEEPAGE PITS _____ ABSORBENT SIDE-WALL AREA _____ SQ. FT.

SEPTIC TANK CAPACITY _____ GALLONS

FOR GARBAGE GRINDER, INCREASE DISPOSAL AREA 22% & TANK CAPACITY 50%.

OTHER DITCH @ 480 sq. ft. sidewall area in area between distribution box and perc hole and beyond perc hole. Maximum depth permitted for ditch is 10 ft. below original grade. Depth of ditch to be 10 ft., with 4 ft. of stone for a total ~~sidewall length of 120 ft.~~

DRY WELL & DITCH WITH TOTAL OF

NOTE: ALL PIPE FROM HOUSE TO DISPOSAL AREA MUST BE CAST IRON.

PERMIT VOID AFTER THREE YEARS. 480 SQ FT sidewall area

below inlet part system between

PLANS APPROVED BY Raymond Hodges

DATE 5/6/77

FILL SEPTIC TANK AND DISTRIBUTION BOX WITH WATER BEFORE CALLING FOR AN INSPECTION. COVER NO WORK UNTIL INSPECTED AND APPROVED.

PW discussed Repair job with Jenkins

NEITHER THE HOWARD COUNTY COMMISSIONERS NOR THE HEALTH DEPARTMENT IS RESPONSIBLE FOR THE SUCCESSFUL OPERATION OF ANY SYSTEM.

BLDG. PERMIT SIGNED AND RETURNED 5/10/77

Serial # 41579 -
Pump & deck

25849

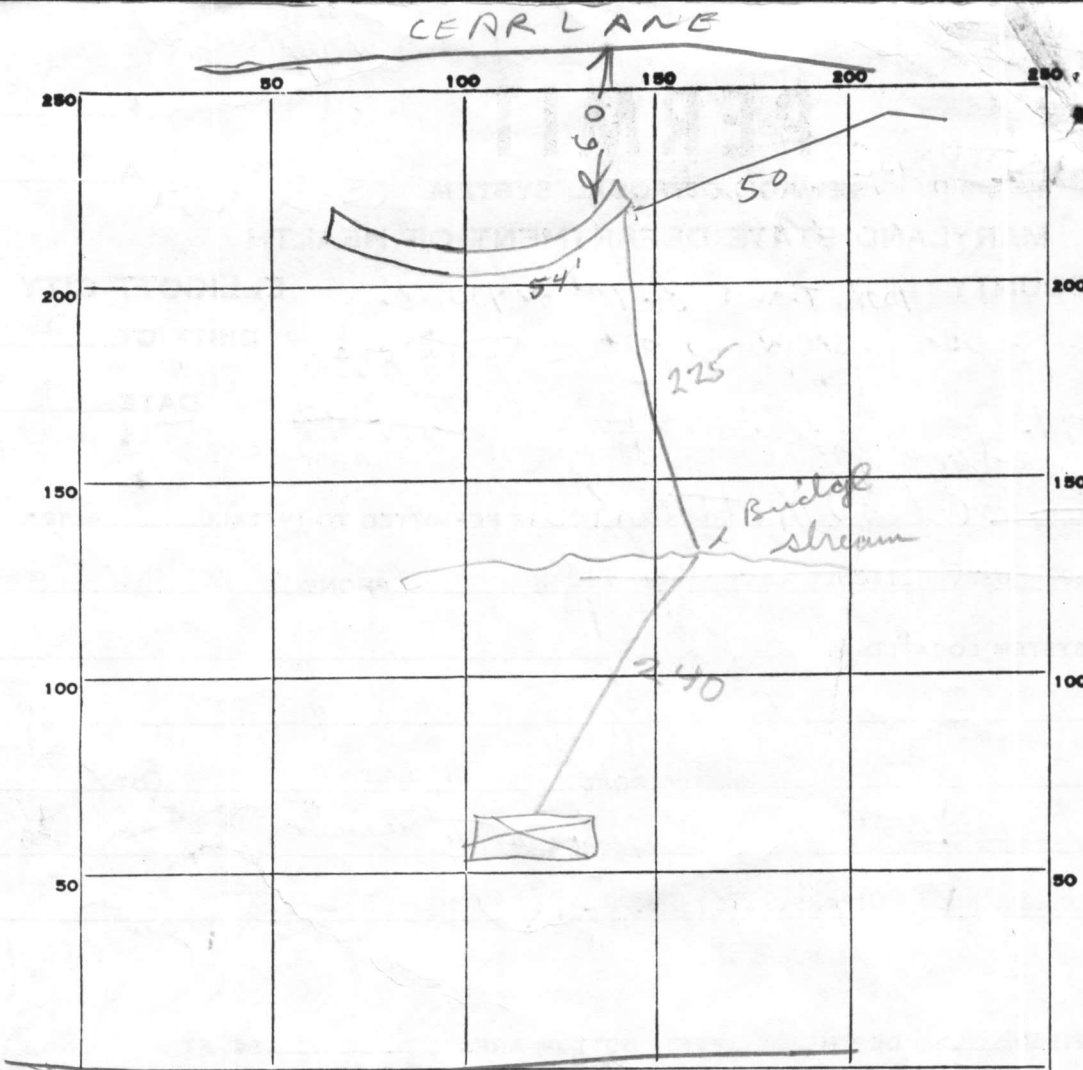

INDICATE NORTH. - NAME ADJOINING ROADWAY AS BASE LINE.

BRABURN RD

PERMIT CARD _____

SEPTIC TANK, LEVEL _____

CLEANOUTS _____

DISTRIBUTION BOX, LEVEL _____

TILE FIELD, DEPTH 10' FT. TRENCH WIDTH 2 FT.

GRAVEL DEPTH 6 1/2 IN. TOTAL LENGTH 100 FT.

NUMBER OF TRENCHES 1

TOTAL BOTTOM AREA 6.50

SEEPAGE PITS, INSIDE DIAMETER _____ FT.

DEPTH BELOW INLET _____ FT.

ABSORBENT AREA _____ SQ. FT.

REMARKS

OK to gravel first 50 ft of trench PAB

" " " remainder of trench PAB 30 June 77

6/30/77 - DITCH OK TO COVER Connect sewer line

& pump & call for inspection RIT 7/6. Spoke to

SA Kitterman OK to backfill pump line as it is laid. 7/11/77, 1030 hrs. - line not started - re-inspect no sooner than 1530 this afternoon

DATE SYSTEM APPROVED 1/13/77

INSPECTOR R. Bigg

75
3
225

50

3

106 100
6.5

265

Repair permit

APPLICATION

A _____
P _____

SEWAGE DISPOSAL TESTING

*4/25/77
2:00 PM*

STATE OF MARYLAND - DEPARTMENT OF HEALTH AND MENTAL HYGIENE

HOWARD COUNTY HEALTH DEPARTMENT
ENVIRONMENTAL HEALTH SERVICES
P O. BOX 476, ELLICOTT CITY, MARYLAND 21043
TELEPHONE: 465-5000, EXT. 356

EXISTING TANK

DISTRICT 5th
DATE 4/22/77

*5/6/77
11:30 PM*

*DITCH - 480 SQ FT SIDEWALK AREA
IN AREA BETWEEN DISTRIBUTION
BOX & PERC HOLE & BEYOND PERC HOLE
MAXIMUM DEPTH OF DITCH
IS 10 FT DEPTH OF STONE IN DITCH*

TO: THE COUNTY HEALTH OFFICER
ELLICOTT CITY, MARYLAND

I, HEREBY, APPLY FOR THE NECESSARY TEST IN ORDER TO CONSTRUCT (OR RECONSTRUCT) A SEWAGE DISPOSAL SYSTEM.

according to attached chart

PROPERTY OWNER Mr. Sears
changed a permit
ADDRESS 1084 BRAEBURN RD
Cedar Lane, Clarksville, Md. PHONE 531 6639

PROPERTY LOCATION Jenkins
SUBDIVISION _____ LOT NO. _____

ROAD AND DESCRIPTION Cedar Lane - 1st house on left on Cedar Lane off Route 108

1084 BRAEBURN RD NAME ON BOX
WHITE HOUSE 2 STORY
SIZE OF LOT _____ TYPE BLDG. Existing House
NUMBER OF BEDROOMS _____

IF NOT SINGLE RESIDENCE DESCRIBE _____

THE SYSTEM INSTALLED UNDER THIS APPLICATION IS ACCEPTABLE ONLY UNTIL PUBLIC FACILITIES BECOME AVAILABLE.

SIGNATURE OF APPLICANT /s/ Jenkins Brothers *Old time H&EC 465 6646*

APPROVED BY _____ FOR _____ DATE _____
(KIND OF SYSTEM)

REJECTED BY _____ FOR _____ DATE _____
(KIND OF SYSTEM)

HOLD PENDING FURTHER TESTS _____ DATE _____

REASONS FOR REJECTION OR HOLDING _____

THIS IS NOT A PERMIT

200
7480

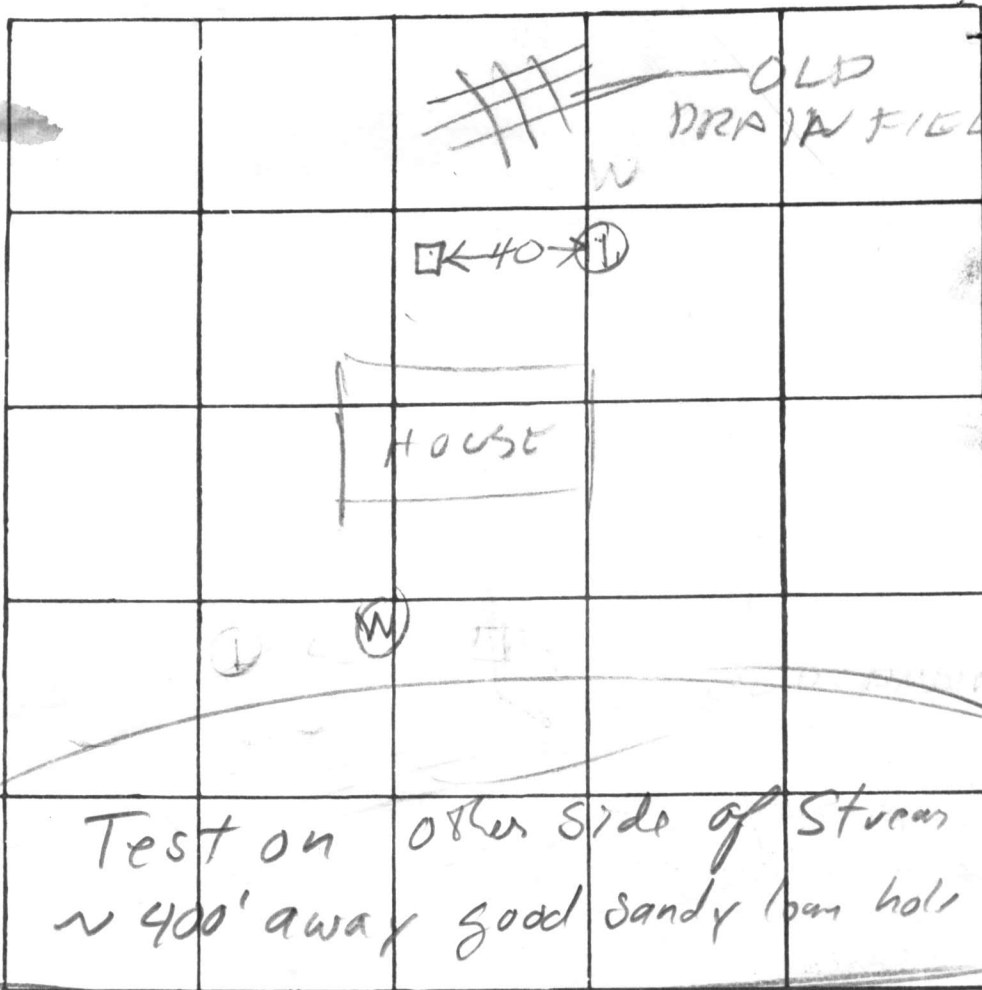

INDICATE NORTH - NAME ADJOINING ROADWAY AS BASE LINE

BRAEBURN RD

| DATE | TEST NO. | DEPTH | PRE-WET | | TEST - 1" DROP | | TIME |
|--------|----------|-------|----------|------|----------------|------|------|
| | | | START | STOP | START | STOP | |
| 5/6/77 | 1 | 12 | ALL SAND | | 12:17 | | |
| | | | | | | | |
| | | | | | | | |
| | | | | | | | |
| | | | | | | | |
| | | | | | | | |
| | | | | | | | |
| | | | | | | | |
| | | | | | | | |
| | | | | | | | |

REMARKS _____

TYPE OF SOIL _____

TESTED BY Raymond Hodga ALSO PRESENT: Jes Purz