

4/29/77
after 10:00 please
- apply F.S.

PERMIT

P 25675

SEWAGE DISPOSAL SYSTEM

A _____

MARYLAND STATE DEPARTMENT OF HEALTH

HOWARD COUNTY

ELLICOTT CITY

DISTRICT 1st

INDEXED

DATE 4/22/77

Waterloo Sanitation Service IS PERMITTED TO INSTALL _____ ALTER X

ADDRESS 7311 Washington Blvd., Baltimore, Md. PHONE 799-1942

A SEWAGE DISPOSAL-SYSTEM LOCATED AT _____

SUBDIVISION _____ ROAD 6584 Montgomery Road LOT _____

PROPERTY OWNER Alfred J. Obester

ADDRESS 6584 Montgomery Road, Elkridge, Maryland

SPECIFICATIONS 1 bedroom

DRAIN FIELD _____ DEPTH _____ FEET, BOTTOM AREA _____ SQ. FT.

SEEPAGE PITS _____ ABSORBENT SIDE-WALL AREA _____ SQ. FT.

SEPTIC TANK CAPACITY 750 GALLONS

FOR GARBAGE GRINDER, INCREASE DISPOSAL AREA 22% & TANK CAPACITY 50%.

OTHER REPLACING SEPTIC TANK

PLANS APPROVED BY Palmer F. Wine DATE 4/22/77

FILL SEPTIC TANK AND DISTRIBUTION BOX WITH WATER BEFORE CALLING FOR AN INSPECTION. COVER NO WORK UNTIL INSPECTED AND APPROVED.

NEITHER THE HOWARD COUNTY COMMISSIONERS NOR THE HEALTH DEPARTMENT IS RESPONSIBLE FOR THE SUCCESSFUL OPERATION OF ANY SYSTEM.

P25675

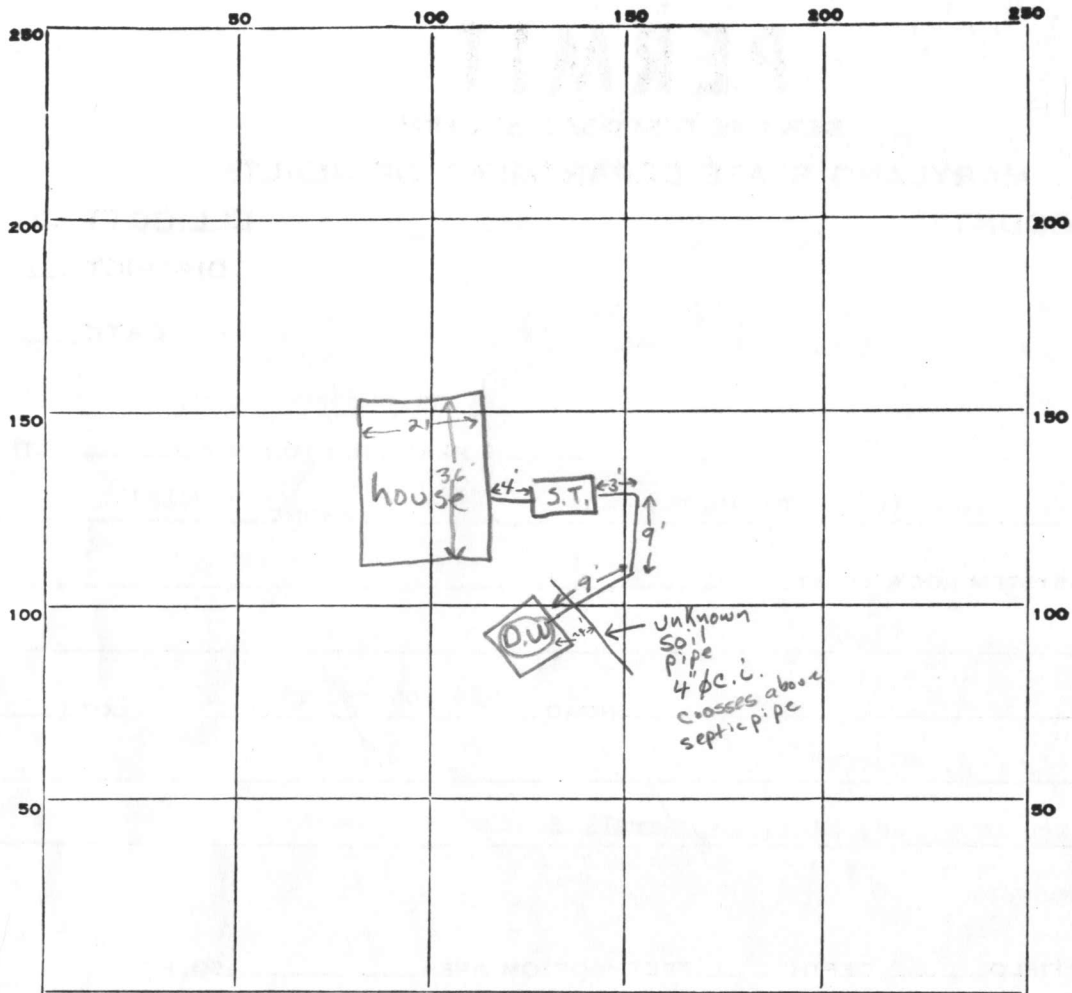

avg. H₂O bill shows between 10 & 15 thousand gal. per 3 mos. period

INDICATE NORTH. - NAME ADJOINING ROADWAY AS BASE LINE.

PERMIT CARD ✓ final O.K.

SEPTIC TANK, LEVEL ✓

CLEANOUTS

S.T.
O.K.

DISTRIBUTION BOX, LEVEL n.a.

TILE FIELD, DEPTH _____ FT. TRENCH WIDTH _____ FT.

GRAVEL DEPTH _____ IN. TOTAL LENGTH _____ FT.

NUMBER OF TRENCHES _____ TOTAL BOTTOM AREA _____

SEEPAGE PITS, INSIDE DIAMETER _____ FT. DEPTH BELOW INLET _____ FT.

ABSORBENT AREA _____ SQ. FT.

REMARKS 4/29/77 logwell insert at ~ 3' below grade, S.T. holds water from bathroom only, according to Mrs. Obester F.S.

DATE SYSTEM APPROVED 4/29/77

INSPECTOR Frank Skinner