

12-29-76  
130-0ppd 4.5,

REPAIR

# PERMIT

P 25079

SEWAGE DISPOSAL SYSTEM

A \_\_\_\_\_

MARYLAND STATE DEPARTMENT OF HEALTH

HOWARD COUNTY

ELLICOTT CITY

INDEXED

DISTRICT 6th

06-391621

DATE 12/29/76

Jack Fyock

IS PERMITTED TO INSTALL \_\_\_\_\_ ALTER

ADDRESS \_\_\_\_\_ PHONE \_\_\_\_\_

A SEWAGE DISPOSAL SYSTEM LOCATED AT \_\_\_\_\_

SUBDIVISION \_\_\_\_\_ ROAD 8524 Pineway Drive LOT \_\_\_\_\_

PROPERTY OWNER C. O. Ball (South on 29 to 216 East on 216 to Pineway Drive. Right on Pineway and job is on ri

ADDRESS \_\_\_\_\_

### SPECIFICATIONS

DRAIN FIELD \_\_\_\_\_ DEPTH \_\_\_\_\_ FEET, BOTTOM AREA \_\_\_\_\_ SQ. FT.

SEEPAGE PITS \_\_\_\_\_ ABSORBENT SIDE-WALL AREA \_\_\_\_\_ SQ. FT.

SEPTIC TANK CAPACITY \_\_\_\_\_ GALLONS

FOR GARBAGE GRINDER, INCREASE DISPOSAL AREA 22% & TANK CAPACITY 50%.

OTHER REPAIR-Call for inspection when ground is opened up and Sanitarian will recommend repair.

*Richard J. Ball - the trench was 8' deep*

PLANS APPROVED BY \_\_\_\_\_ DATE \_\_\_\_\_

FILL SEPTIC TANK AND DISTRIBUTION BOX WITH WATER BEFORE CALLING FOR AN INSPECTION. COVER NO WORK UNTIL INSPECTED AND APPROVED.

NEITHER THE HOWARD COUNTY COMMISSIONERS NOR THE HEALTH DEPARTMENT IS RESPONSIBLE FOR THE SUCCESSFUL OPERATION OF ANY SYSTEM.

\* P 25079

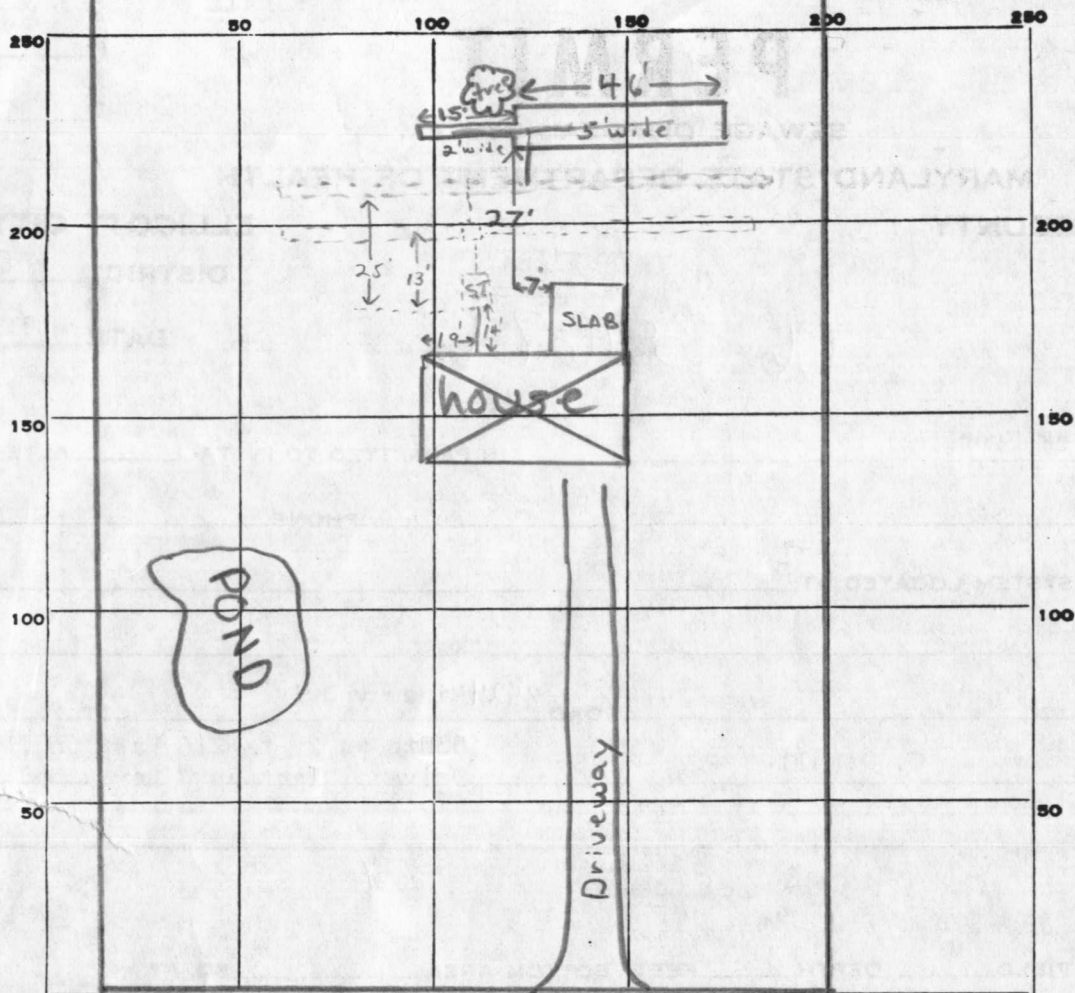

INDICATE NORTH. - NAME ADJOINING ROADWAY AS BASE LINE.

Pineway Drive

PERMIT CARD  signed final O.K. F.S.

SEPTIC TANK, LEVEL existing CLEANOUTS S.T. | trench  
O.K. | n.a.

DISTRIBUTION BOX, LEVEL \_\_\_\_\_

TILE FIELD, DEPTH 8 FT. TRENCH WIDTH 2 # 5 FT.

GRAVEL DEPTH 4 1/2 - 5 FT. TOTAL LENGTH 61 FT.

NUMBER OF TRENCHES 1 TOTAL BOTTOM AREA 1/2 SIDEWALL  
244 # or 60 # + 230 # (bottom area)

SEEPAGE PITS, INSIDE DIAMETER \_\_\_\_\_ FT. DEPTH BELOW INLET 4 FT.

ABSORBENT AREA ± 244 SQ. FT.

REMARKS 12/29/76 Public H<sub>2</sub>O used, new trench tied into old tile fields  
distribution pipe. O.K. to cover all work F.S.

DATE SYSTEM APPROVED 12/29/76 INSPECTOR Frank Skinner