

11-26-90
11:00am
11-29-90
11:22am
11/30/90
AFTER LUNCH

PERMIT

SEWAGE DISPOSAL SYSTEM

DEPARTMENT OF HEALTH AND MENTAL HYGIENE

04-336380

P 46635

A 25892

DISTRICT 4th

DATE 11/23/90

HOWARD COUNTY HEALTH DEPARTMENT

BUREAU OF ENVIRONMENTAL HEALTH

461-9933

DATE SYSTEM APPROVED 12-4-90

INSPECTOR JEN

INDEXED

Clement G. Scheper IS PERMITTED TO INSTALL ALTER X

ADDRESS 3142 Hernwood Road, Woodstock, Maryland 21163 PHONE 461-5880 | 876-4307
same place

SUBDIVISION Brantly LOT 3B ROAD 3317 Brantly Road

PROPERTY OWNER Mrs. Paula West Roger L. West 442-1037

ADDRESS _____

SEPTIC TANK CAPACITY existing 1950 GALLONS

NUMBER OF BEDROOMS 4

125 SQUARE FEET PER BEDROOM Total = 500 sqft

LINEAR FEET OF TRENCH REQUIRED *100 ft with drywell in use, 145# without drywell

REPAIR - PURPOSE - DRYWELL IS FLOODED.

11-26-90 Call for inspection when ground is opened so sanitarian can recommend repair.

With drywell, use 125 sqft/bdrm. Without drywell use 180 sqft/bdrm.
Inlet at 2.5 ft, bottom at 7.5 ft, Effective depth of stone 5.0 ft.
Trench to be 3.0 ft wide. Maintain 75 ft from all wells. JEN

PLANS APPROVED BY C. Williams JEN 11-26-90 DATE 11/23/90

COVER NO WORK UNTIL INSPECTED AND APPROVED

NEITHER THE HOWARD COUNTY COUNCIL NOR THE HEALTH DEPARTMENT IS RESPONSIBLE FOR THE SUCCESSFUL OPERATION OF ANY SYSTEM

NOTE: CLEANOUT REQUIRED EVERY 70 FEET OF SEWER LINE AND/OR AT 90° SWEEPS IN LINES FROM HOUSE TO DRAIN FIELDS, 90° ELBOWS NOT ACCEPTABLE.

NOTE: ALL PARTS OF SEPTIC SYSTEMS (I.E. TANK, DISTRIBUTION BOX TRENCHES) TO BE 100 FEET FROM WELL (UNLESS OTHERWISE SPECIFICALLY AUTHORIZED)

NOTE: IF DEEP TRENCH(ES) ARE USED CALL FOR INSPECTION BEFORE AND AFTER PLACING GRAVEL IN TRENCH(ES)

NOTE: NO DRY WELL SHALL EXCEED 15 FOOT IN DIAMETER NO ABSORPTION TRENCH TO EXCEED 100 FEET IN LENGTH

NOTE: ALL PIPE FROM HOUSE TO SEPTIC TANK MUST BE CAST IRON OR SCHEDULE 35/40 PVC OR ABS

PERMIT VOID AFTER TWO YEARS

NOTE: INSTALL STAND PIPE ON SEPTIC TANK AND DRY WELL STAND PIPES MUST BE 6 INCHES IN DIAMETER CAST IRON. CONCRETE OR TERRA COTTA OR PVA OR ABS ACCEPTED. IF TOP OF SEPTIC TANK IS DEEPER THAN 3 FEET. MANHOLE TO GRADE REQUIRED.

NOTE: DISTRIBUTION BOXES MUST HAVE BAFFLES

***INSTALLER IS RESPONSIBLE FOR OBTAINING FINAL APPROVAL ON THIS PERMIT**

BUILDING PERMIT SIGNED AND RETURNED

5-2-03 BOD14363-ENCLOSURE
11004-BOD15199-GARAGE

25892

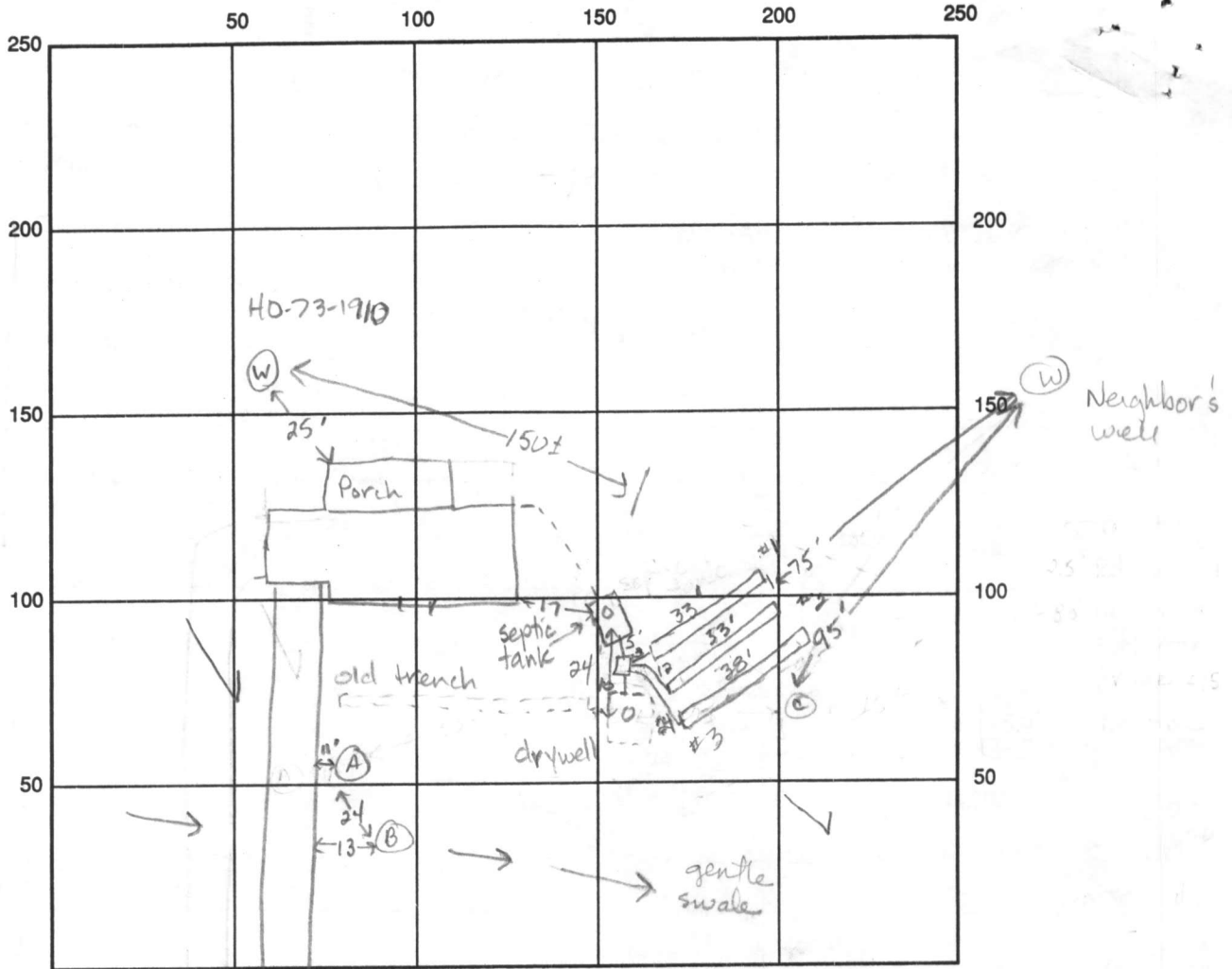

INDICATE NORTH - NAME ADJOINING ROADWAY AS BASE LINE

Existing SEPTIC TANK LEVEL 2000 gal ± CLEANOUTS 1 on septic tank
Brantly Road

DISTRIBUTION BOX LEVEL ok w/ baffle

DRAIN FIELD/TITLE DEPTH 7.5' 7.5' 8' FT. TRENCH WIDTH 3.0 FT. INLET DEPTH 2.5 2.5 3' FT.

EFFECTIVE GRAVEL DEPTH 5 5 5 FT. TOTAL LENGTH 33 33 38 FT.

NUMBER OF TRENCHES 2 ONE SIDEWALL/BOTTOM AREA 65 165 190 SQ. FT.

DRYWALL INSIDE DIAMETER 48 FT. EFFECTIVE DEPTH BELOW INLET 6 FT. 288 sq ft

ABSORBENT AREA 288 + 520 SQ. FT. = 808 total

REMARKS: 11-29-90 ok to use area near septic tank keeping 75 ft from wells. JEN
11-29-90 trench #1 cover leaving ends open. JEN 11-30-90 ok to stone
and cover trenches. JEN 12-4-90 ok to cover all work. JEN

DATE SYSTEM APPROVED Dec. 4, 1990 INSPECTOR Jane E. Nadeau