

BP will be Applied for on ~~7-22-98~~ 7-22-98.

WALK-THRU

INDEXED

APPLICATION

HOWARD COUNTY

SERIAL NUMBER

PERMIT APPLICATION

DEPARTMENT OF INSPECTIONS, LICENSES & PERMIT
3430 COURT HOUSE DRIVE, ELLICOTT CITY, MARYLAND 21043

000113137

BUILDING ADDRESS (HOUSE NO., STREET, TOWN OR AREA)
11444 Old Frederick Road
Marriottsville, MD 21104

GRADING/SEDIMENT CONTROL YES NO SDP #

LOT NO.	PARCEL NO.	SEC.	AREA	BLOCK NO.	LIBER	FOLIO
6	6					

DESCRIPTION OF WORK AUTHORIZED
20x40 Rectangle
Steel Wall Inground
Pool 31'-8"
(TRUCK FILL)

SUB DIVISION	MANUF	ZONE	ZONE MAP	ELEC. DIST.	CENSUS TR.
Marriottsville					

SIZE OF BLDG.	FRONT	DEPTH	HEIGHT

OWNER NAME AND ADDRESS
GOTTFREDEAU Gary + Denise
11444 Old Frederick Rd
Marriottsville MD 21104

PHONE NO.
(500) 442-2354

TYPE OF BLDG.	AREA	VOLUME	ROOF

OCCUPANT'S NAME AND ADDRESS
same as above

PHONE NO.

ARCHITECT OR ENGINEER'S NAME AND ADDRESS

PHONE NO.

FOOTINGS	FOUNDATION	S. WALLS

CONTRACTOR'S NAME AND ADDRESS
TRI-COUNTY POOLS, INC.
13410 Moser Road
Thurmont MD 21788

PHONE NO.
301-898-3030

UTILITIES					
WATERWELL	SEWER/SEPTIC	GAS	ELECTRICITY	TYPE OF HEAT	AC

EXISTING USE

PROPOSED USE
INGROUND POOL

I have carefully examined and read this application and know the same is true and correct, and that is doing this work, all provisions of Howard County Ordinances and the State Laws of Maryland will be complied with, whether specified or not; and I will notify the Department of Inspections, and Permits twenty-four hours in advance when I am ready for the inspections called for elsewhere in the application; and that no work will be covered up until such inspections have been completed with.

EST. CONSTRUCTION COST	LICENSE NUMBER	PERMIT FEE
\$26,700.00	34414-01	

Raymond Stenahl
President
SIGNATURE
7/10/98
DATE

W/S CODE

FOR OFFICE USE ONLY

DISTANCE IN FEET FROM R/W LINE TO FRONT BUILDING LINE _____

SIDE YARD _____
(DISTANCE IN FEET FROM SIDE BLDG. LINE TO SIDE PROPERTY LINE)

TO SIDE BUILDING LINE _____
DISTANCE IN FEET, REAR YD. REQUIRING SET

BACK _____ (CORNER LOT ONLY)

SDP # _____

FUNCTION	DATE	SIGNATURE APPROVAL
ZONING/PLANNING		
SHA		
SEDIMENT/GRADING		
BUILDING OFFICIAL		
WATER & SEWER		
HEALTH DEPT.	7-15-98	<i>[Signature]</i>
FIRE PROTECTION		
STORM WATER MGM.		

Check payable to: DIRECTOR OF FINANCE OF HOWARD COUNTY

CAUTION

To begin construction before a permit placard has been issued and displayed on the job is a violation of the law.
Use and occupancy permit must be applied for two weeks before it will be issued.

IMPORTANT: PLEASE SHOW ZIP CODES AND AREA CODES WHEREVER REQUIRED.

APPROVED DATE

Distribution of Copies:
White - Building Official
Green - Planning & Zoning

Yellow - Engineering
Pink - Health Dept.
Gold - S.H.A.

A 25588

A23411

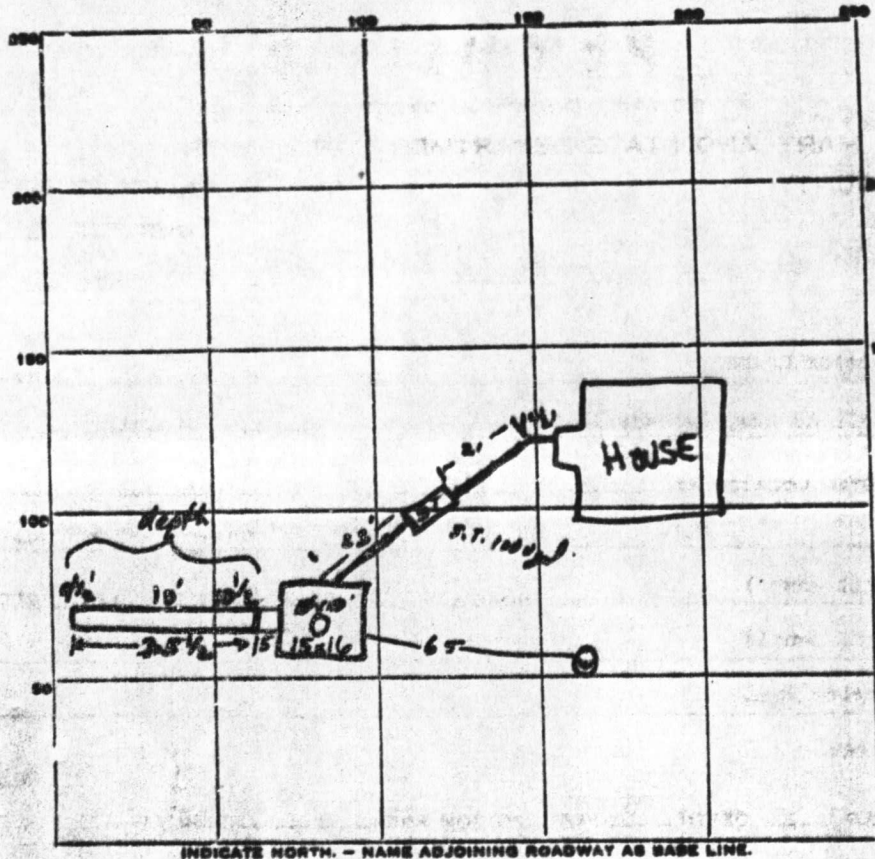

144
 3
 42

62
 6 1/2
 372
 31
 403

15x16

PERMIT CARD

SEPTIC TANK, LEVEL 1000 gal

	ST	DW
CLEANOUTS	<input checked="" type="checkbox"/>	<input checked="" type="checkbox"/>

DESIGNER'S SIGNATURE LEVEL _____

TILE FIELD, DEPTH 10 FT. TRENCH WIDTH 2 FT. 6 1/2 35

GRAVEL DEPTH 6 FT. TOTAL LENGTH 35 1/2 FT. 210

NUMBER OF TRENCHES 1 SIDEWALL TOTAL BOTTOM AREA 210 sq ft

SEEPAGE PITS, INSIDE DIAMETER 62 FT. DEPTH BELOW INLET 6 1/2 FT. Inlet @ 4'

ABSORBENT AREA 403 sq. ft. in DW; TOTAL sq ft = 613 sq ft *

REMARKS 18 Apr 77 D.W. depth: 10 1/2' R.M.

4/19/77 AM Initial trench inst OK W2

4/19/77 PM Final C.O. — OK.

* Eff. sidewall area (as per specs is) 49 sq ft less than shown.

DATE SYSTEM APPROVED 4/19/77 INSPECTOR Thurmond J. Jupp

A23411

o Denotes Approximate Location of Test Pits.

DONALD EVANS

PARCEL 4

PARCEL 5

N 16° 44' 30" E
137.14'

587° 07' 13" E
545.54'

385 WIDE STRIP TO
OLD FREDERICK RD.
MD. ROUTE 99

N 28° 37' 12" W 430.00'

PARCEL 6

INV. ELEV 435
INV. ELEV 434
EXIST. ELEV 436
INV. ELEV 433
EXIST. ELEV 432
ELEV AT TIME OF TEST 435

50 FT. RIGHT-
OF-WAY TO
OLD FREDERICK
RD. MD. ROUTE 99

561° 22' 48" W 419.38'

PARCEL 7

Being known and designated as Parcel C as shown on a Plat entitled "Plat Showing a Division of The Lands of Vincent J. Vecora, et al 3rd Election District, Howard County, Maryland, which Plat is recorded among the Land Records of Howard County in Plat Book 25, folio 64.

The lot shown hereon complies with the minimum ownership and lot area as required by the Md. State Health Department.

Approved: Private Water & Private Sewer

By *[Signature]* Date: 7/16/75
Howard County Health Officer

REG. NO. 7730

W. T. SADLER, INC.
Surveyors
458 main street
elisterstown, maryland 21136



LOCATION SURVEY		
SHOWING LOCATION OF PERCOLATION TEST PITS		
SCALE 1" = 100'	DATE 7-28-75	APP. NO. JOB NO. A-53

NOTE: This plot is not intended for use in establishing property lines.