

App. 25 May 77 RMOB

PERMIT

P 25340

SEWAGE DISPOSAL SYSTEM

A 25235

MARYLAND STATE DEPARTMENT OF HEALTH

HOWARD COUNTY

ELLICOTT CITY

INDEXED

DISTRICT 5th

DATE 3/3/77

H. Edwards Construction Co. IS PERMITTED TO INSTALL ALTER

ADDRESS 6645 Mink Hollow Road, Highland, MD. 20777 PHONE 596-6309

A SEWAGE DISPOSAL SYSTEM LOCATED AT _____

SUBDIVISION _____ ROAD 13777 B.O.R.L. Brighton Dam & Havilland Mill Roads LOT _____

PROPERTY OWNER H. Edwards James & Meredith Phelan

ADDRESS 6645 Mink Hollow Road, Highland, MD. 20777

SPECIFICATIONS 4 bedrooms

DRAIN FIELD _____ DEPTH _____ FEET, BOTTOM AREA _____ SQ. FT.

SEEPAGE PITS _____ ABSORBENT SIDE-WALL AREA _____ SQ. FT.

SEPTIC TANK CAPACITY 1250 GALLONS

BLDG. PERMIT SIGNED AND RETURNED 3/3/77 Serial No. 31050

FOR GARBAGE GRINDER, INCREASE DISPOSAL AREA 22% & TANK CAPACITY 50%.

OTHER DRY WELL-Locate the dry well 54 feet from the 272.5 foot property line and 88 feet from the 159 foot property line. The invert will enter the dry well at 3 feet below original grade and the maximum depth of the dry well will be 9 feet below original grade. The trench will begin at a point 5 feet from the edge of the dry well and will follow the contour of the land. The trench will be constructed 2 feet wide, 9 feet deep, and contain 6 feet of stone. There will be a minimum of 166 sq. feet of sidewall per bedroom. 2 inspections.

CALL FOR INSPECTION BEFORE PLACING STONE IN TRENCH.

NOTE: ALL PIPE FROM HOUSE TO DISPOSAL AREA MUST BE CAST IRON. PERMIT VOID AFTER 3 YEARS.

PLANS APPROVED BY Robert T. Moorefield DATE 3/2/77

FILL SEPTIC TANK AND DISTRIBUTION BOX WITH WATER BEFORE CALLING FOR AN INSPECTION. COVER NO WORK UNTIL INSPECTED AND APPROVED.

NOTE: INSTALL STAND PIPE ON DRY WELL AND SEPTIC TANK. STAND PIPES MUST BE 6 INCHES IN NEITHER THE HOWARD COUNTY COMMISSIONERS NOR THE HEALTH DEPARTMENT IS RESPONSIBLE FOR THE SUCCESSFUL OPERATION OF ANY SYSTEM.

DIAMETER. CAST IRON, CONCRETE OR TERRA COTTA ACCEPTED.

BLDG. PERMIT SIGNED AND RETURNED 9/18/76 Serial # 72734 2-cav addition

25235

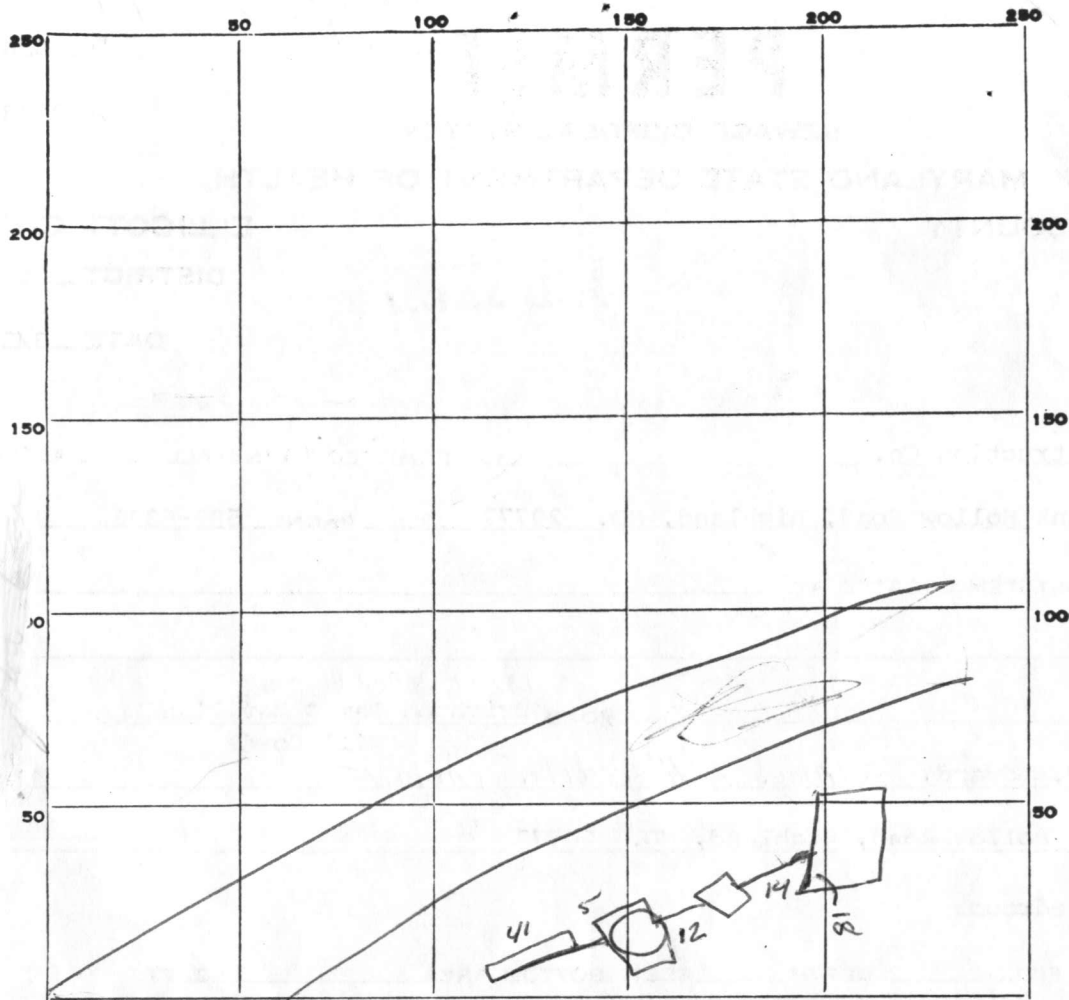

INDICATE NORTH - NAME ADJOINING ROADWAY AS BASE LINE.

Brighton Dam

PERMIT CARD SEPTIC TANK, LEVEL CLEANOUTS OK DW ST
 DISTRIBUTION BOX, LEVEL NA/

TILE FIELD, DEPTH 9?? FT. TRENCH WIDTH 2 FT.

GRAVEL DEPTH 6?? IN. TOTAL LENGTH 41 FT. 166
4

NUMBER OF TRENCHES 1 TOTAL ^{sidewall} BOTTOM AREA 246 Needed: 664 ϕ

SEEPAGE PITS, ^{outside perimeter} INSIDE DIAMETER 74 FT. DEPTH BELOW INLET 7.5 FT.

ABSORBENT AREA 555 SQ. FT. 74
7.5
518

REMARKS Trench 246 ϕ + a.w.: 555 ϕ = 801 ϕ

trench depth not recorded & must assume it was acceptable (R.M.) Note* - my visit was on 4/11/77 for well grouting only !! R.M.

DATE SYSTEM APPROVED 25 May 77 INSPECTOR (R. Mansfield ??)
R. Mansfield

5
27
8
12 | 216
12
196

2
74
7.5
320
518
555.0

PRELIMINARY

APPLICATION

A 25235

SEWAGE DISPOSAL TESTING

P _____

STATE OF MARYLAND - DEPARTMENT OF HEALTH AND MENTAL HYGIENE

2/14/77
2:00 P.M.

HOWARD COUNTY HEALTH DEPARTMENT
ENVIRONMENTAL HEALTH SERVICES
P. O. BOX 476, ELLICOTT CITY, MARYLAND 21043
TELEPHONE: 465-5000, EXT. 356

ST
3 | 1000
4 | 1250
5 | 1500

DISTRICT 5th

DATE 2/14/77

Locate the D.W. 54' from the 272.5' prop line and 88' from the 159' prop line. The inv. will enter the D.W. @ 3' below O.G. and the max depth of the D.W. will be 9' below O.G. The trench will begin @ a point 5' from the edge of the D.W. and will follow the contour of the land. The trench will be constructed 2' wide, 9' deep and contain 6' of stone. There will be a minimum of 166' of sidewalk per bedroom.

TO: THE COUNTY HEALTH OFFICER
ELLICOTT CITY, MARYLAND

2 inspections

I, HEREBY, APPLY FOR THE NECESSARY TEST IN ORDER TO CONSTRUCT (OR RECONSTRUCT) A SEWAGE DISPOSAL SYSTEM.

PROPERTY OWNER Grandville J. O'Keefe property

Any questions call Howard Edwards - 5966309

ADDRESS _____ PHONE _____

PROPERTY LOCATION:

SUBDIVISION _____ LOT NO. _____

ROAD AND DESCRIPTION Brighton Dam and Havilland Mill Roads

SIZE OF LOT 1.011 acres m/l TYPE BLDG. 3 or 4 bedrooms

NUMBER OF BEDROOMS

IF NOT SINGLE RESIDENCE DESCRIBE _____

THE SYSTEM INSTALLED UNDER THIS APPLICATION IS ACCEPTABLE ONLY UNTIL PUBLIC FACILITIES BECOME AVAILABLE.

SIGNATURE OF APPLICANT /s/ Howard Edwards

APPROVED BY R. Moneyfield FOR D.W. trench DATE 2 Mar 77
(KIND OF SYSTEM)

REJECTED BY _____ FOR _____ DATE _____
(KIND OF SYSTEM)

HOLD PENDING FURTHER TESTS _____ DATE _____

REASONS FOR REJECTION OR HOLDING _____

THIS IS NOT A PERMIT

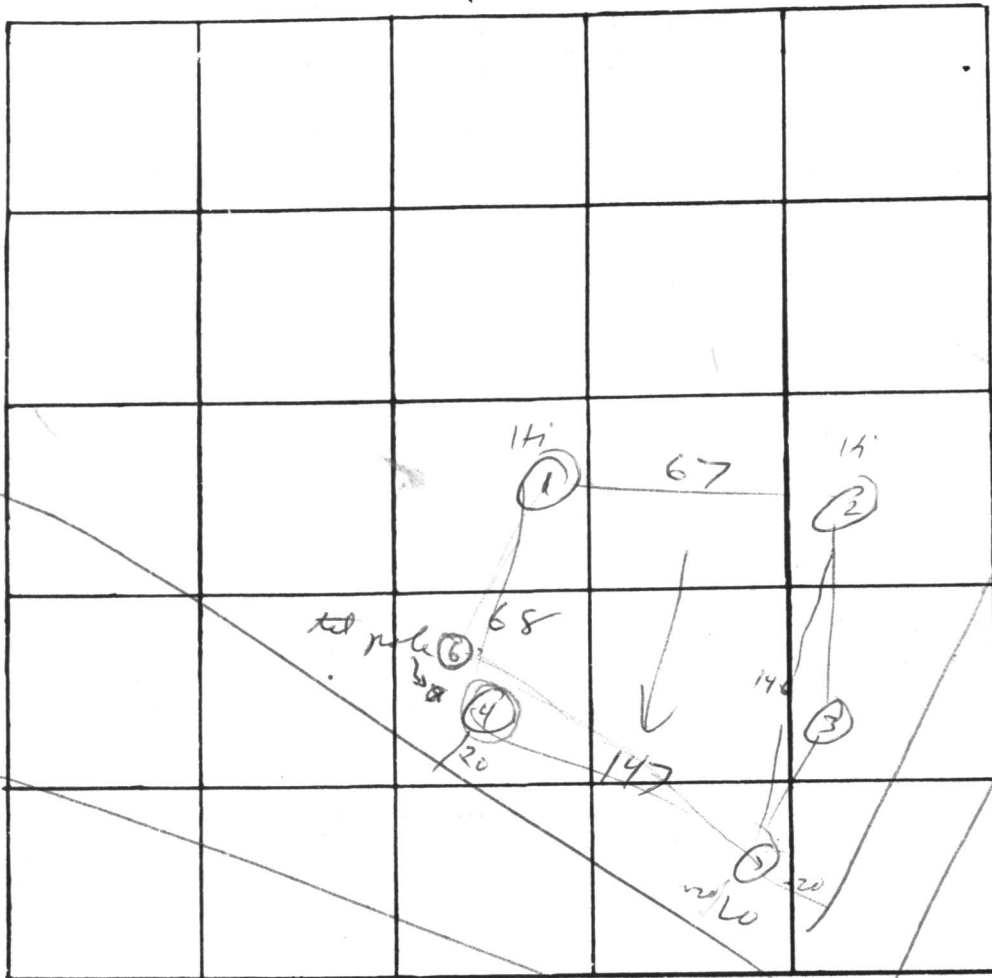

INDICATE NORTH. - NAME ADJOINING ROADWAY AS BASE LINE.

DATE	TEST NO.	DEPTH	PRE-WET		TEST - 1" DROP		TIME
			START	STOP	START	STOP	
2/14/77	1	13	2 ⁰⁷	2 ⁰⁸	2 ⁰⁸	2 ¹⁰	2
	1A	3	2 ⁰²	2 ¹¹	2 ¹¹	2 ²⁵	14
	2	13	vis	-	dry	-	-
	3	12	vis	-	-	-	-
	4	3	2 ¹³	} almost 1" in then no Δ timed for 40 min	25 min,		
	4A	12 1/2	2 ¹³				
	5	3	2 ¹⁹	2 ⁴⁴	2 ⁴⁴	peg patted	
	5A	13	2 ¹⁹	2 ²¹	2 ²¹	2 ²³	2
	6	3	2 ⁵²	3 ⁰²	3 ⁰²	3 ²⁸	21
	6A	13	2 ⁵²	2 ⁵⁵	2 ⁵⁵	3 ⁰²	12
	5B	4 1/2	3 ⁰²	3 ¹²	3 ¹²	3 ²²	17

} sim to #1

REMARKS _____

TYPE OF SOIL _____

TESTED BY M ALSO PRESENT: H. Edwards

1-3,6
0
| clay f.
| micaceous
| loam
3 1/2
| micaceous
| loam
13

(more clay)
in 4 1/2

5
0
| clay
4
| loam
5
13

4
0
| clay
| some loam
| mixed
12 1/2

C i 3298 SEQUENCE NO. (WRA USE ONLY)
2 3 (SEQ. NO.) 6
(THIS NUMBER IS TO BE PUNCHED IN COLS. 3-6 ON ALL CARDS)

STATE OF MARYLAND
WATER RESOURCES ADMINISTRATION
TAWES STATE OFFICE BLDG., ANNAPOLIS, MD. 21401
WELL COMPLETION REPORT

THIS REPORT MUST BE SUBMITTED WITHIN 30 DAYS AFTER WELL COMPLETION

FILL IN THIS FORM COMPLETELY

COUNTY NUMBER

DATE RECEIVED (WRA USE ONLY)
8-13

DATE WELL COMPLETED
Apr 11, 1977

DEPTH OF WELL
105
22 (TO NEAREST FOOT) 26

PERMIT NO. FROM "PERMIT TO DRILL WELL"
40-73-1903
28 29 30 31 32 33 34 35 36 37

DRILLERS IDENTIFICATION NO. 238

OWNER: Edwards LAST NAME 13777 BRIGHTON DAM RD FIRST NAME
STREET OR RFD: 7514 Mint Halbuld POST OFFICE: Heald Md.

WELL LOG

STATE THE KIND OF FORMATIONS PENETRATED, THEIR COLOR, DEPTH, THICKNESS AND IF WATER BEARING

DESCRIPTION (USE ADDITIONAL SHEETS IF NECESSARY)	FEET		CHECK IF WATER BEARING
	FROM	TO	
Sand	0	25	
Gray Mica	25	105	

GROUTING RECORD

WELL HAS BEEN GROUTED (CIRCLE APPROPRIATE BOX) YES NO

TYPE OF GROUTING MATERIAL (CIRCLE BOX):
CEMENT BENTONITE CLAY

NO. OF BAGS 8 NO. OF POUNDS 153

GALLONS OF WATER 48

DEPTH OF GROUT SEAL (TO NEAREST FOOT)
FROM 0 FT. TO 30 FT.

CASING RECORD

CASING TYPES: INSERT APPROPRIATE CODE BELOW

STEEL CONCRETE
PLASTIC OTHER

MAIN CASING TYPE: ST

NOMINAL DIAMETER TOP (MAIN) CASING (NEAREST INCH) 6

TOTAL DEPTH OF MAIN CASING (NEAREST FOOT) 30

OTHER CASING (IF USED)

DIAMETER (INCH) _____ DEPTH (FEET) FROM _____ TO _____

SCREEN RECORD

INSERT APPROPRIATE CODE BELOW

STEEL BRASS OR BRONZE OPEN HOLE
PLASTIC OTHER

SCREEN

DEPTH (NEAREST WHOLE FOOT) FROM 28 TO 105

SLOT SIZE 1, 2, 3

DIAMETER OF SCREEN 56 (NEAREST INCH) FROM _____ TO _____

GRAVEL PACK _____

IF WELL DRILLED WAS A FLOWING WELL CIRCLE BOX

WRA USE ONLY (NOT TO BE FILLED IN BY DRILLER) (E.R.O.S.)

TELESCOPE CASING LOG INDICATOR OTHER DATA AVAILABLE

PUMPING TEST

HOURS PUMPED (TO NEAREST HOUR) 2

PUMPING RATE (GALLONS PER MINUTE TO NEAREST GALLON) 10

METHOD USED TO MEASURE PUMPING RATE AIR

WATER LEVEL: (DISTANCE FROM LAND SURFACE)
BEFORE PUMPING 5 (NEAREST FOOT)
WHEN PUMPING 35 (NEAREST FOOT)

TYPE OF PUMPED USED (CIRCLE APPROPRIATE BOX) (FOR PUMPING TEST)
A AIR P PISTON T TURBINE
C CENTRIFUGAL R ROTARY O OTHER (DESCRIBE BELOW)
J JET S SUBMERSIBLE

PUMP INSTALLED

TYPE OF PUMP (WRITE APPROPRIATE LETTER IN BOX - SEE ABOVE: A, C, J, P, R, S, T, O) _____

DRILLER WILL INSTALL PUMP (CIRCLE APPROPRIATE BOX) YES NO

CAPACITY:
GALLONS PER MINUTE (TO NEAREST GALLON) 31 35
PUMP HORSE POWER 37 41
PUMP COLUMN LENGTH (NEAREST FOOT) 43 47

CASING HEIGHT (CIRCLE APPROPRIATE BOX AND ENTER CASING HEIGHT)
+ ABOVE } LAND SURFACE
- BELOW } 2 (NEAREST FOOT)

LOCATION OF WELL ON LOT
SHOW PERMANENT STRUCTURE SUCH AS BUILDINGS, SEPTIC TANKS, AND/OR OTHER LAND MARKS AND INDICATE NOT LESS THAN TWO DISTANCES (MEASUREMENTS TO WELL).

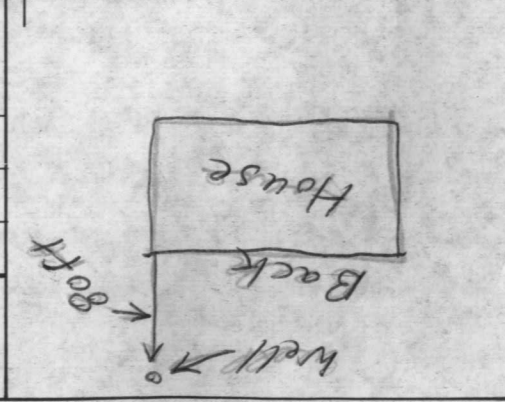

CIRCLE APPROPRIATE BOXES

A A WELL WAS ABANDONED AND SEALED WHEN THIS WELL WAS COMPLETED

E ELECTRIC LOG OBTAINED

P TEST WELL CONVERTED TO PRODUCTION WELL

I HEREBY CERTIFY THAT I HAVE COMPLIED WITH ALL CONDITIONS STATED ON THE ABOVE-CAPTIONED "PERMIT TO DRILL WELL", AND THAT INFORMATION CONTAINED IN THIS REPORT IS TRUE, ACCURATE, AND COMPLETE TO THE BEST OF MY KNOWLEDGE, INFORMATION AND BELIEF.

DRILLERS NAME: Joseph L. Mayne
SIGNATURE: Joseph L. Mayne

