

approved 4/29/81

Stayer

P 30808

A REPAIR

4/28/81

as soon as possible

PERMIT

SEWAGE DISPOSAL SYSTEM

MARYLAND STATE DEPARTMENT OF HEALTH

HOWARD COUNTY

04-313291

ELLICOTT CITY

DISTRICT 5th.

INDEXED

DATE 7/23/80

Jack Fyock

IS PERMITTED TO INSTALL ALTER X

ADDRESS _____ PHONE _____

SUBDIVISION 0402 ROAD 14402 Dorsey Mill Road LOT 2

PROPERTY OWNER Joshua L. Dill PHONE: 854-6773

ADDRESS 14402 Dorsey Mill Road

SPECIFICATIONS

SEPTIC TANK CAPACITY _____ GALLONS

DRAIN FIELD _____ DEPTH _____ FEET, BOTTOM AREA _____ SQ. FT.

DEEP TRENCH _____ DEPTH _____ FEET, BOTTOM AREA _____ SQ. FT.

SEEPAGE PITS _____ ABSORBENT SIDE-WALL AREA _____ SQ. FT.

INLET PIPE _____ FT. BELOW ORIGINAL GRADE. MAXIMUM DEPTH _____ FT. BELOW ORIGINAL GRADE

EFFECTIVE DEPTH AT _____ FT. BELOW ORIGINAL GRADE.

LOCATE DISPOSAL AREA _____ FT. FROM _____ LOT LINE AND _____ FT. FROM _____ LOT LINE AS SEEN WHEN FACING LOT FROM

REPAIR-CALL FOR INSPECTION WHEN GROUND IS OPENED UP SO SANITARIAN CAN RECOMMEND

REPAIR. one Trench 75' long 11' deep, inlet at 2 1/2' effective depth at 3', at least 8' of stone under pipe. SK 4/28/81

PLANS APPROVED BY Palmer F. Wine DATE 7/23/80

COVER NO WORK UNTIL INSPECTED AND APPROVED.

NEITHER THE HOWARD COUNTY COUNCIL NOR THE HEALTH DEPARTMENT IS RESPONSIBLE FOR THE SUCCESSFUL OPERATION OF ANY SYSTEM.

NOTE: IF TRENCH IS USED CALL FOR INSPECTION BEFORE PLACING GRAVEL IN TRENCH.

NOTE: NO DRY WELL SHALL EXCEED 15 FOOT IN DIAMETER.

NOTE: ALL PIPE FROM HOUSE TO DISPOSAL AREA MUST BE CAST IRON.

PERMIT VOID AFTER THREE YEARS.

NOTE: INSTALL STAND PIPE ON SEPTIC TANK AND DRY WELL. STAND PIPES MUST BE 6 INCHES IN DIAMETER. CAST IRON, CONCRETE OR TERRA COTTA ACCEPTED.

*INSTALLER IS RESPONSIBLE FOR OBTAINING FINAL APPROVAL ON THIS PERMIT.

P 30808

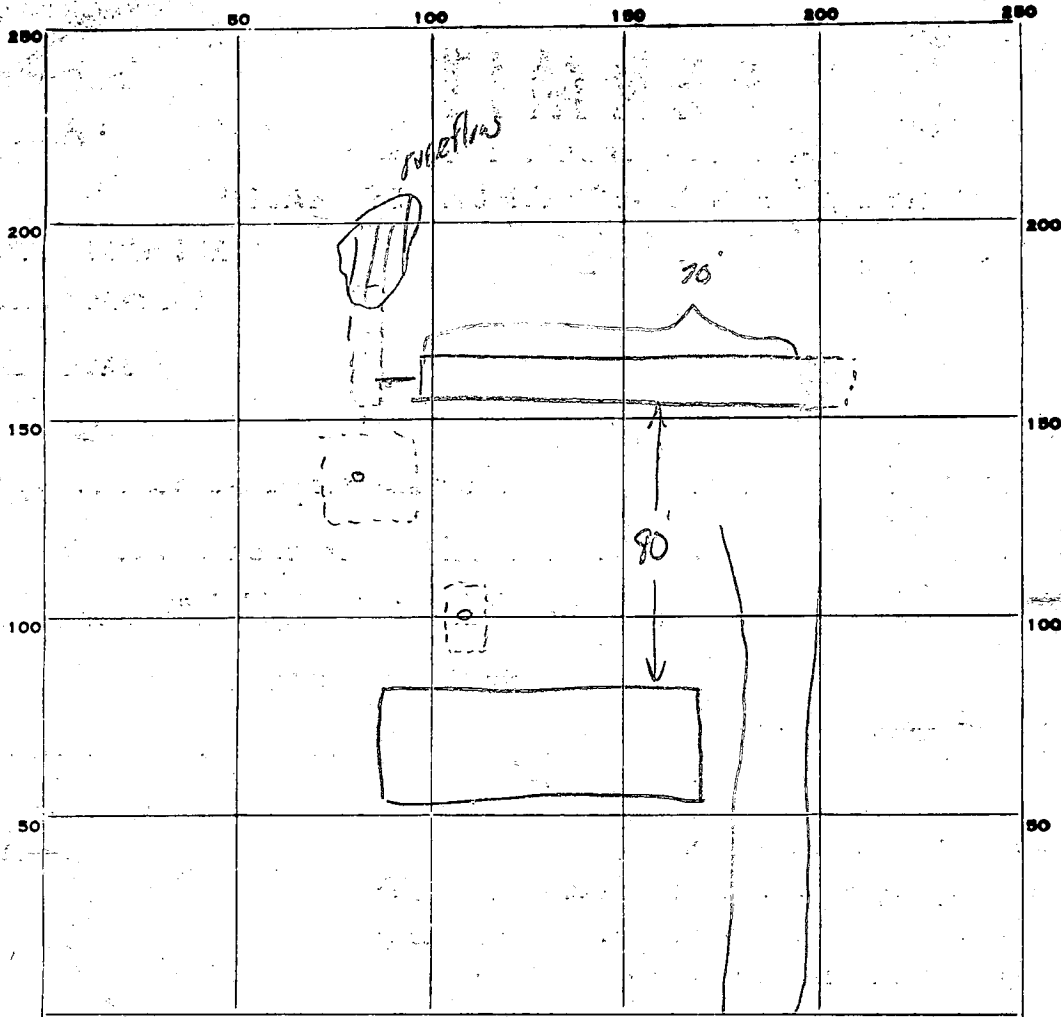

INDICATE NORTH. — NAME ADJOINING ROADWAY AS BASE LINE.

PERMIT CARD ND

DORSEY Mill RD

SEPTIC TANK, LEVEL _____

CLEANOUTS _____

DISTRIBUTION BOX, LEVEL _____

TILE FIELD, DEPTH 11 FT. TRENCH WIDTH 2 FT.

GRAVEL DEPTH 8 IN. TOTAL LENGTH 80 FT.

NUMBER OF TRENCHES 1 TOTAL BOTTOM AREA 640

SEEPAGE PITS, INSIDE DIAMETER _____ FT. DEPTH BELOW INLET _____ FT.

ABSORBENT AREA 640 SQ. FT.

REMARKS 5 people live in house per skip, 4/28/81 OK to add
stone to trench, 70' of trench dug, will dig additional 5'
SK-

4/29/81 OK to cover all work. JS

DATE SYSTEM APPROVED 4/29/81

INSPECTOR Stayer

Ready for installation 10/5/59 3000
PERMIT

SEWAGE DISPOSAL SYSTEM

MARYLAND STATE DEPARTMENT OF HEALTH

HOWARD COUNTY

A 01305
A 01305

ELLICOTT CITY

DISTRICT

DATE 10-5-59

INDEXED

C. V. Ricketts

IS PERMITTED TO INSTALL ALTER

ADDRESS Blair

PHONE WIRA 4-5777

A SEWAGE DISPOSAL SYSTEM LOCATED AT Dorsey Hill Rd.

SUBDIVISION

ROAD

LOT

PROPERTY OWNER Bill. Joshua

ADDRESS Hayterville

SPECIFICATIONS

DRAIN FIELD DEPTH 4 FEET BOTTOM AREA 38 SQ. FT.

SEEPAGE PITS ABSORBENT SIDE-WALL AREA SQ. FT.

SEPTIC TANK CAPACITY 750 GALLONS

FOR GARBAGE GRINDER INCREASE DISPOSAL AREA 25% & TANK CAPACITY 20%

OTHER one 9 ft. x 12 ft. dry well 30 ft. from left side of lot and 10 ft. from front lot. Left side of lot determined when facing lot from Dorsey Hill Rd.

PLANS APPROVED BY James E. Hennigan

DATE 10-29-59

FILL SEPTIC TANK AND DISTRIBUTION BOX WITH WATER BEFORE CALLING FOR AN INSPECTION. COVER WORK UNTIL INSPECTED AND APPROVED.

NEITHER THE HOWARD COUNTY COMMISSIONERS NOR THE HEALTH DEPARTMENT IS RESPONSIBLE FOR THE SUCCESSFUL OPERATION OF ANY SYSTEM.

A 01305

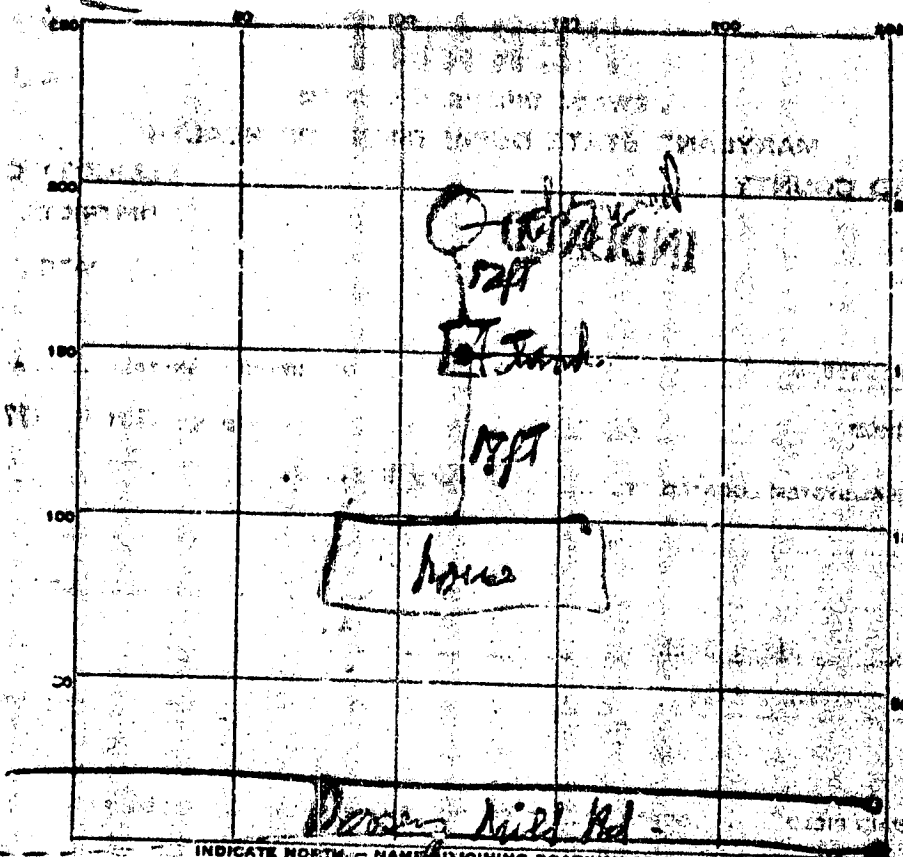

INDICATE NORTH - NAME ADJOINING ROADWAY AS BASE LINE.

PERMIT CARD

SEPTIC TANK, LEVEL

CLEANOUTS

DISTRIBUTION BOX, LEVEL

TILE FIELD, DEPTH _____ FT. TRENCH WIDTH _____ FT.

GRAVEL DEPTH _____ IN. TOTAL LENGTH _____ FT.

NUMBER OF TRENCHES _____ TOTAL BOTTOM AREA _____

SEEPAGE PITS, INSIDE DIAMETER _____ FT. DEPTH BELOW INLET _____ FT.

ABSORBENT AREA 800 SQ. FT.

REMARKS

DATE SYSTEM APPROVED

10/6/59

INSPECTOR

RW

A^s 01487

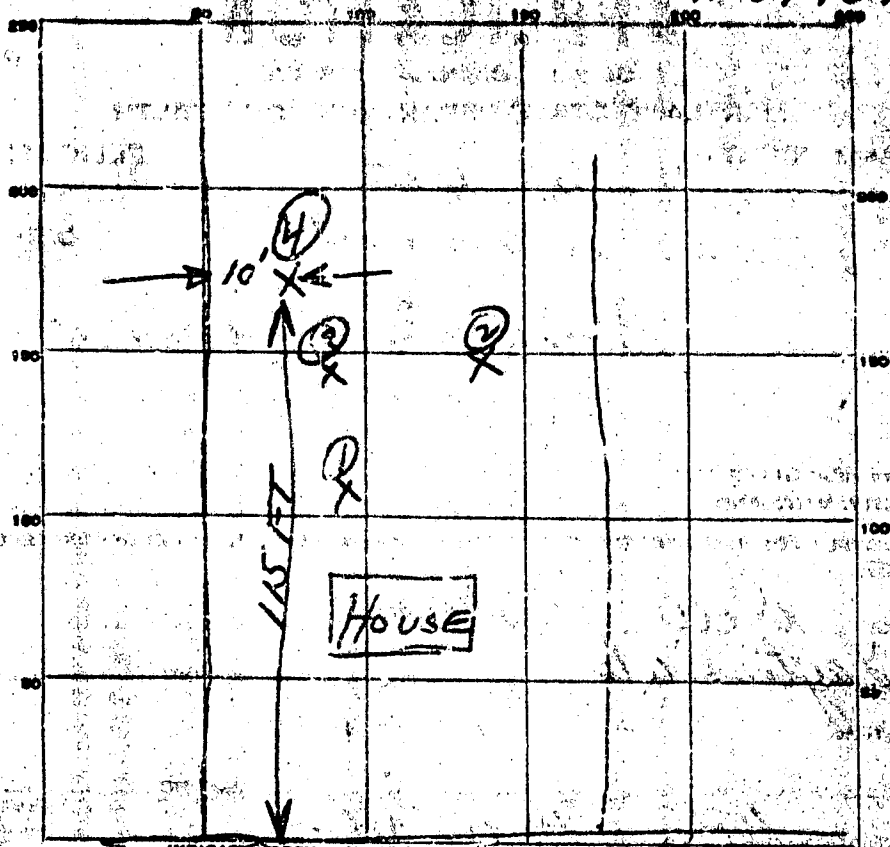

DATE	TEST NO.	DEPTH	PRE-WET		TEST - 1" DROP		TIME	
			START	STOP	START	STOP		
7-28-54	1	4 FT.	10:38	11:04	11:04			
	2	1	10:50	11:19	11:19	11:50	29 Minutes	
	3	Approx. 6	minutes to each					
	4	10 FT	11:38	11:41	11:41	11:48	7 Minutes	

SOIL AUGER FINDING _____
 TESTED BY: *JH*
 REMARKS: *Calvin Howard*