

6/9/80  
Be ready around  
1000 AM  
as soon as possible  
6/10/80

APPROVED  
6/10/80 RH

# PERMIT

P 30717

A Repair

SEWAGE DISPOSAL SYSTEM

MARYLAND STATE DEPARTMENT OF HEALTH

11 PE

HOWARD COUNTY

05-364167

ELLICOTT CITY

DISTRICT 5th

INDEXED

DATE 6/9/80

Jack Fyock

IS PERMITTED TO INSTALL ALTER X

ADDRESS 13775 Triadelphia Road, Glenelg, Md. 21737 PHONE 988-9270

SUBDIVISION \_\_\_\_\_ ROAD 7022 Deer Valley Road LOT \_\_\_\_\_

PROPERTY OWNER Jerome M. Raffel

ADDRESS 7022 Deer Valley Road, Highland, Md. 20777 Phone: 286-3736

SPECIFICATIONS

SEPTIC TANK CAPACITY \_\_\_\_\_ GALLONS

DRAIN FIELD \_\_\_\_\_ DEPTH \_\_\_\_\_ FEET. BOTTOM AREA \_\_\_\_\_ SQ. FT.

DEEP TRENCH 11 DEPTH \_\_\_\_\_ FEET. <sup>SIDE</sup> BOTTOM AREA \_\_\_\_\_ SQ. FT.

SEEPAGE PITS \_\_\_\_\_ ABSORBENT SIDE-WALL AREA \_\_\_\_\_ SQ. FT.

INLET PIPE \_\_\_\_\_ FT. BELOW ORIGINAL GRADE. MAXIMUM DEPTH \_\_\_\_\_ FT. BELOW ORIGINAL GRADE

EFFECTIVE DEPTH AT 3 FT. BELOW ORIGINAL GRADE.

LOCATE DISPOSAL AREA 40 FT. FROM \_\_\_\_\_ LOT LINE AND \_\_\_\_\_ FT. FROM \_\_\_\_\_ LOT LINE AS SEEN WHEN \_\_\_\_\_

~~FACING LOT FROM~~

BEHIND THE HOUSE OFF

REPAIR - Call for an appointment when ground is opened up and Sanitarian will OLD DRY WELL

recommend the repair system.

DITCH 11 FT DEEP 2 FT WIDE 7 FT STONE  
70 FT LONG (4 BR) OR 55 FT LONG (3 BR)

PLANS APPROVED BY Palmer F. Wine DATE 6/9/80

COVER NO WORK UNTIL INSPECTED AND APPROVED.

NEITHER THE HOWARD COUNTY COUNCIL NOR THE HEALTH DEPARTMENT IS RESPONSIBLE FOR THE SUCCESSFUL OPERATION OF ANY SYSTEM.

NOTE: IF TRENCH IS USED CALL FOR INSPECTION BEFORE PLACING GRAVEL IN TRENCH.

NOTE: NO DRY WELL SHALL EXCEED 15 FOOT IN DIAMETER.

NOTE: ALL PIPE FROM HOUSE TO DISPOSAL AREA MUST BE CAST IRON.

PERMIT VOID AFTER THREE YEARS.

NOTE: INSTALL STAND PIPE ON SEPTIC TANK AND DRY WELL. STAND PIPES MUST BE 6 INCHES IN DIAMETER. CAST IRON, CONCRETE OR TERRA COTTA ACCEPTED.

\*INSTALLER IS RESPONSIBLE FOR OBTAINING FINAL APPROVAL ON THIS PERMIT.

P 30717

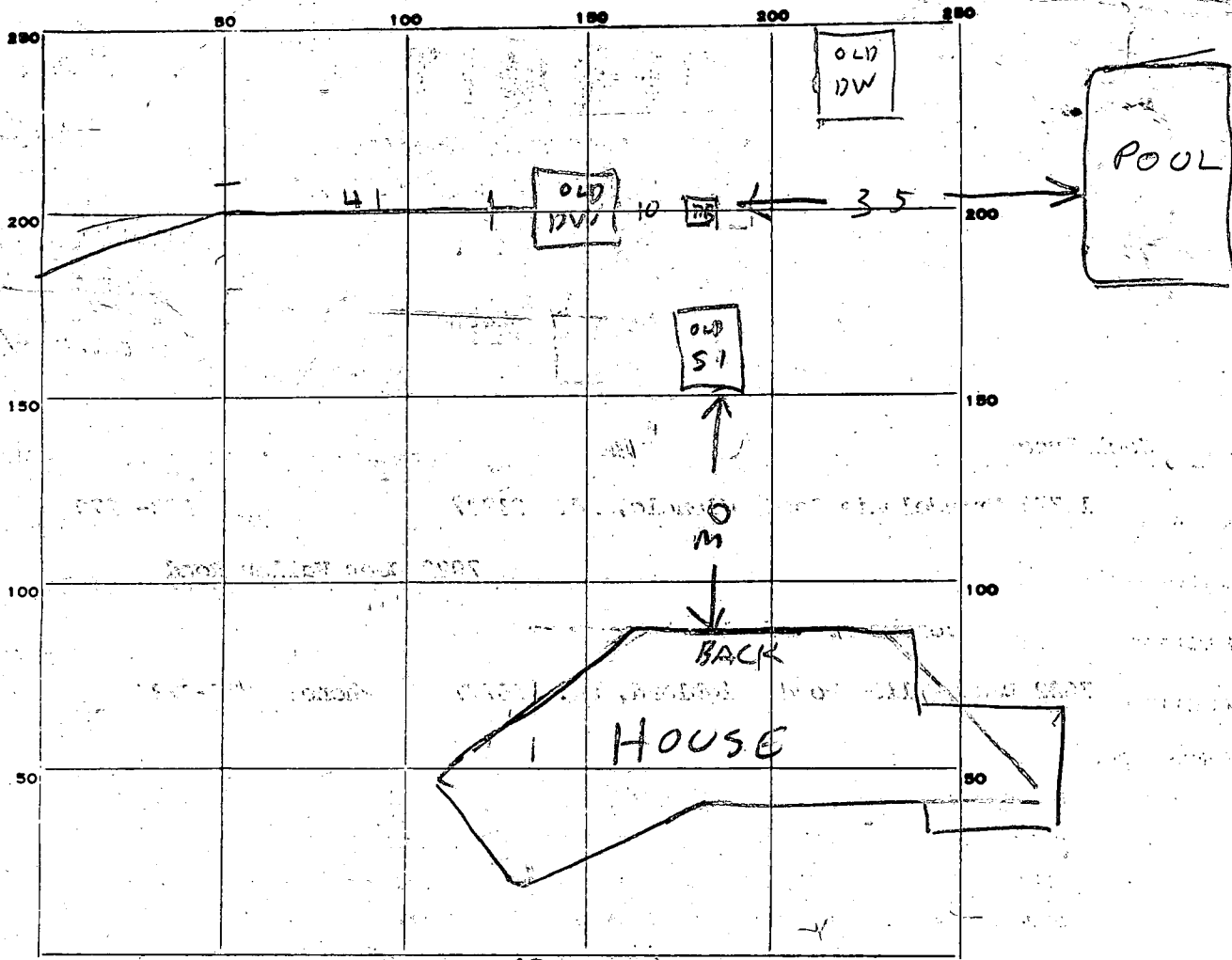

INDICATE NORTH. - NAME ADJOINING ROADWAY AS BASE LINE.

PERMIT CARD

SEPTIC TANK, LEVEL \_\_\_\_\_

CLEANOUTS \_\_\_\_\_

DISTRIBUTION BOX, LEVEL \_\_\_\_\_

DITCH

TRENCH FIELD, DEPTH 11 FT. TRENCH WIDTH 2 FT.

GRAVEL DEPTH 7 FT. IN. TOTAL LENGTH 41 FT. 76

NUMBER OF TRENCHES \_\_\_\_\_ TOTAL BOTTOM AREA 512

SEEPAGE PITS, INSIDE DIAMETER \_\_\_\_\_ FT. DEPTH BELOW INLET \_\_\_\_\_ FT.

ABSORBENT AREA \_\_\_\_\_ SQ. FT.

REMARKS 6/9/80 SOIL SANDY - DITCH 11 FT DEEP WITH  
120 SQ FT PER BR NEEDED. FINISH DITCH ADD STONE &

LEAVE DOWN STREAM END OF DITCH OPEN FOR SOIL INSPECTION RIF

6/9/80 - DITCH EXTENDED TO 76 FT

6/10/80 - SIXTONETE NEEDED 9 FT & STD

DATE SYSTEM APPROVED

6/10/80

INSPECTOR

Raymond Hedges

480

76  
7  
2

30  
2  
60  
15