

# PERMIT

P 32285

A 30638

SEWAGE DISPOSAL SYSTEM

MARYLAND STATE DEPARTMENT OF HEALTH\*

HOWARD COUNTY

INDEXED

ELLICOTT CITY

DISTRICT 5th

05-355176

DATE Nov. 1, 1982

*complete 11/9/82 (CW)*

Herman Sirk IS PERMITTED TO INSTALL  ALTER

ADDRESS 255 Jennings Chapel Road, Woodbine, Md. 21797 PHONE 489-4724

SUBDIVISION \_\_\_\_\_ ROAD 12397 Hall Shop & Brown Bridge

PROPERTY OWNER Lawrence Jenson

ADDRESS 3461 Dorsey Rd., Woodbine, Md.

SPECIFICATIONS 3 Bedrooms

SEPTIC TANK CAPACITY 1000 GALLONS

DRAIN FIELD \_\_\_\_\_ DEPTH \_\_\_\_\_ FEET, BOTTOM AREA \_\_\_\_\_ SQ. FT.

DEEP TRENCH \_\_\_\_\_ DEPTH \_\_\_\_\_ FEET, BOTTOM AREA \_\_\_\_\_ SQ. FT.

SEEPAGE PITS \_\_\_\_\_ ABSORBENT SIDE-WALL AREA \_\_\_\_\_ SQ. FT.

INLET PIPE \_\_\_\_\_ FT. BELOW ORIGINAL GRADE, MAXIMUM DEPTH \_\_\_\_\_ FT. BELOW ORIGINAL GRADE

EFFECTIVE DEPTH AT \_\_\_\_\_ FT. BELOW ORIGINAL GRADE.

LOCATE DISPOSAL AREA \_\_\_\_\_ FT. FROM \_\_\_\_\_ LOT LINE AND \_\_\_\_\_ FT. FROM \_\_\_\_\_ LOT LINE AS SEEN WHEN FACING LOT FROM

400 feet linear trench required (2-70 feet long trench ok.) Trench inlet at 2 1/2' below original grade, bottom of trench at 6' below original grade with 3 1/2' of gravel below distribution pipe. Use a distribution box to connect trenches to septic tank. Locate the trenches behind the house approximately 50 to 60 feet. Dig trenches on level ground. Call for inspection of trench before gravel is installed. Keep 75' separation between well and trench system.

*2 each 60' long trenches OK inlet 2 1/2' max depth 6 1/2'*

PLANS APPROVED BY Frank Skinner DATE 9/23/82

COVER NO WORK UNTIL INSPECTED AND APPROVED.

NEITHER THE HOWARD COUNTY COUNCIL NOR THE HEALTH DEPARTMENT IS RESPONSIBLE FOR THE SUCCESSFUL OPERATION OF ANY SYSTEM.

NOTE: IF TRENCH IS USED CALL FOR INSPECTION BEFORE PLACING GRAVEL IN TRENCH.

NOTE: NO DRY WELL SHALL EXCEED 15 FOOT IN DIAMETER.

NOTE: ALL PIPE FROM HOUSE TO DISPOSAL AREA MUST BE CAST IRON.

PERMIT VOID AFTER THREE YEARS.

NOTE: INSTALL STAND PIPE ON SEPTIC TANK AND DRY WELL. STAND PIPES MUST BE 6 INCHES IN DIAMETER. CAST IRON, CONCRETE OR TERRAZO ACCEPTED.

\*INSTALLER IS RESPONSIBLE FOR OBTAINING FINAL APPROVAL ON THIS PERMIT.

A 30638

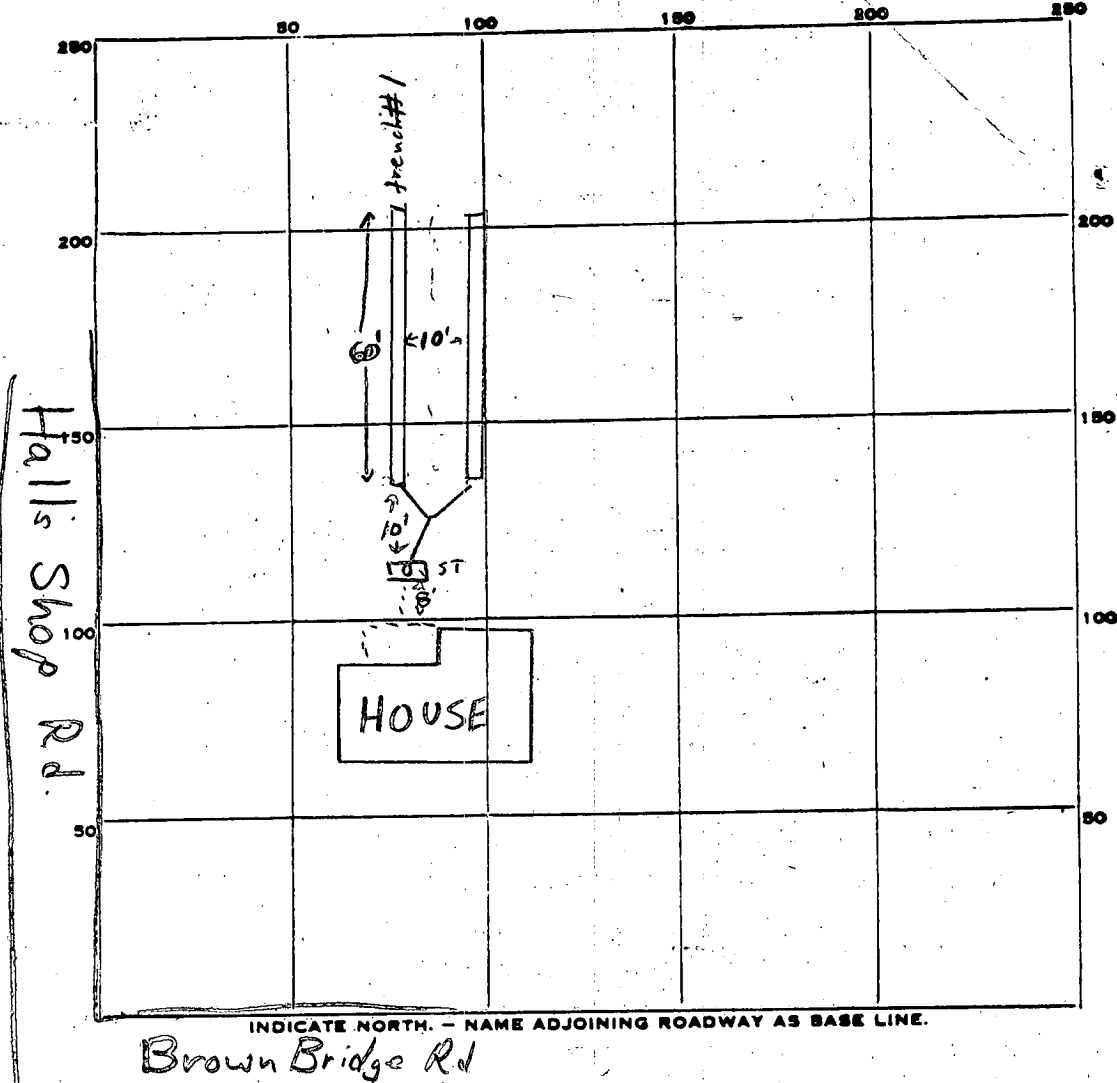

PERMIT CARD \_\_\_\_\_

SEPTIC TANK, LEVEL \_\_\_\_\_ CLEANOUTS \_\_\_\_\_

DISTRIBUTION BOX, LEVEL \_\_\_\_\_

TILE FIELD, DEPTH 6 1/2 FT. TRENCH WIDTH 2 FT. trench #1 60' long

GRAVEL DEPTH 4 FT IN. TOTAL LENGTH 60 FT.

NUMBER OF TRENCHES 2 TOTAL BOTTOM AREA 480

SEEPAGE PITS, INSIDE DIAMETER \_\_\_\_\_ FT. DEPTH BELOW INLET \_\_\_\_\_ FT.

ABSORBENT AREA 480 SQ. FT.

REMARKS 11/8/82 O.K. to put gravel in trench #1

11/9/82 2<sup>ND</sup> TRENCH OK. COVER BOTH. ST. OK. MUST SEE HOUSE CONNECTION CW

NO FURTHER CONTACT AS OF 7/28/95 INDEX AS COMPLETE CW

DATE SYSTEM APPROVED COMPLETE 11/9/82 INSPECTOR Cwellhi

Brown Bridge Rd

Hall Shop Rd

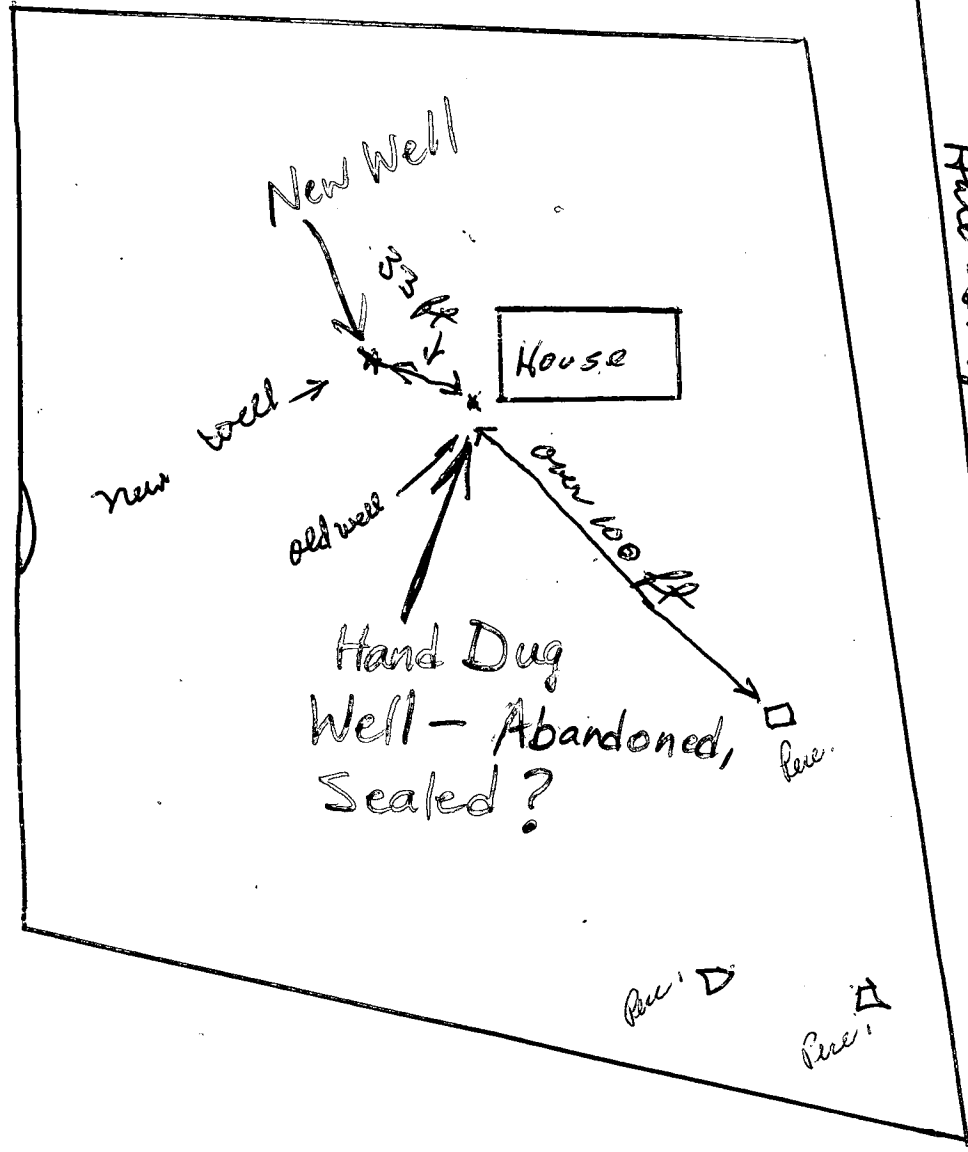

Stake done with well on it.

Lawrence Jensen  
489-4963

# APPLICATION

SEWAGE DISPOSAL TESTING

STATE OF MARYLAND - DEPARTMENT OF HEALTH AND MENTAL HYGIENE

A 30638  
P \_\_\_\_\_

HOWARD COUNTY HEALTH DEPARTMENT  
ENVIRONMENTAL HEALTH SERVICES

3 B.R. 1000 gallon septic tank

P.O. BOX 476 ELLICOTT, MARYLAND 21043  
TELEPHONE: 992-2330

140 linear feet of trench required  
(2-70 ft long tanks O.K.)

DISTRICT 5th  
DATE 4/3/80

1 trench inlet at 2 1/2 ft. below original grade  
bottom of trench at 6 ft below original grade with 3 1/2 ft. of gravel  
below distribution pipe, use a distribution box to connect trenches to septic tank  
Locate the trenches behind the house approximately 50 to 60 feet. Dig trenches  
on level ground. Call for inspection of trenches before grout is installed. Keep  
75 feet separation between well and trench system.

TO: THE COUNTY HEALTH OFFICER  
ELLICOTT CITY, MARYLAND

I HEREBY APPLY FOR THE NECESSARY TEST IN ORDER TO CONSTRUCT (OR RECONSTRUCT) A SEWAGE DISPOSAL SYSTEM. call after

PROPERTY OWNER Lawrence Jenson (3:00)

ADDRESS Hall Shop and Brown Bridge Roads, Highland, Md. PHONE 489-4963

PROPERTY LOCATION: 3461 Daisy Rd., Woodhome

SUBDIVISION \_\_\_\_\_ LOT NO. \_\_\_\_\_

ROAD AND DESCRIPTION corner of Hall Shop and Brown Bridge Roads

SIZE OF LOT 1 acres plus TYPE BLDG. existing house  
3 bedrooms

THE SYSTEM INSTALLED UNDER THIS APPLICATION IS ACCEPTABLE ONLY UNTIL PUBLIC FACILITIES BECOME AVAILABLE.

I FULLY UNDERSTAND THE FEE CONNECTED WITH THE FILING OF THIS PERC TEST APPLICATION IS NON-REFUNDABLE UNDER

ANY CIRCUMSTANCES.

SIGNATURE OF APPLICANT Lawrence Jenson

APPROVED BY Frank Skyring FOR shallow trench DATE 9/23/82

REJECTED BY \_\_\_\_\_ FOR \_\_\_\_\_ DATE \_\_\_\_\_

HOLD PENDING FURTHER TESTS hold for water sample DATE 5/12/80

REASONS FOR REJECTION OR HOLDING 12/12/80. New well drilled

# THIS IS NOT A PERMIT

① ②  
SOIL PROFILE

0-2 1/2'  
Clay sand

2-11'  
Sandy loam

③  
0-11'  
Sandy loam

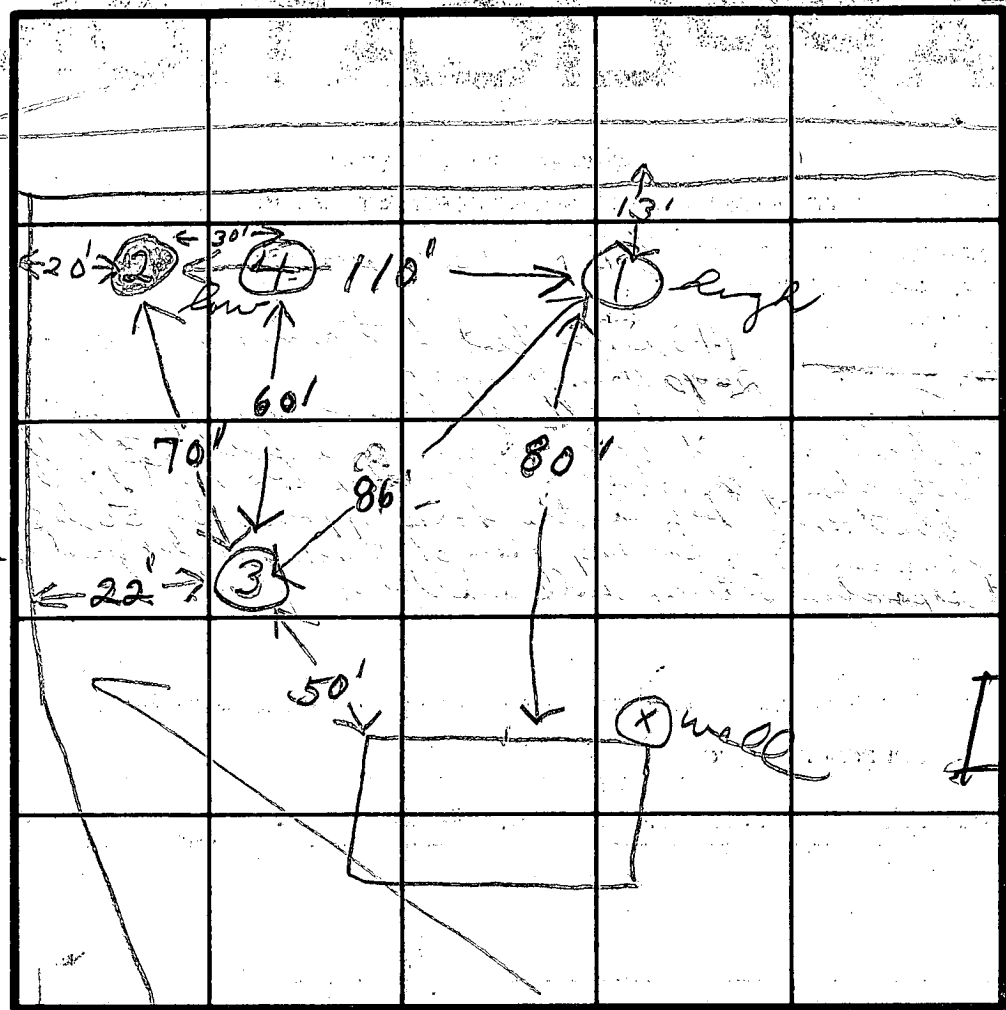

2 1/2' - 6'

3 1/2' stone

3' wide trench

140' trench  
(3 bedrooms)

INDICATE NORTH - NAME ADJOINING ROADWAY AS BASE LINE  
Brown's Bridge Rd

DATE	TEST NO.	DEPTH	PRE-WET		TEST - 1" DROP		TIME
			START	STOP	START	STOP	
5/8/80	1S	4 1/2	1:25	1:27	1:27	1:30	3
	1D	11 1/2	1:24	1:39	1:39	2:09	30
	2	11 1/2	— water at		11 ft.		
	3S	4 1/8	2:05	2:05	2:05	2:15	10
	3D	8	2:20	2:24	2:24	2:31	5
	2S	4 1/8	2:05	2:09	2:09	2:15	6
	(2M)	8	2:25	2:40	2:40	— failed	2 1/2' inch
	4S	8 1/2	same as all other tests				
	4M	8	3:24	3:30	3:30	3:41	11
	3	12	— water				

REMARKS Elevation from hole #2 to #1 - 3 ft.  
same from #2 to #3

TYPE OF SOIL \_\_\_\_\_

TESTED BY SK + J

ALSO PRESENT H. Sisk

C 1 9311 SEQUENCE NO. (WRA USE ONLY)

1 2 3 (SEQ. NO.) 6  
 (THIS NUMBER IS TO BE PUNCHED IN COLS. 3-6 ON ALL CARDS)

**STATE OF MARYLAND**  
**WATER RESOURCES ADMINISTRATION**  
 TAWES STATE OFFICE BLDG., ANNAPOLIS, MD. 21401  
**WELL COMPLETION REPORT**

THIS REPORT MUST BE SUBMITTED WITHIN 30 DAYS AFTER WELL COMPLETION

FILL IN THIS FORM COMPLETELY

COUNTY NUMBER A31050

DATE RECEIVED (WRA USE ONLY) Dec 12, 1980 DEPTH OF WELL 205 PERMIT NO. FROM "PERMIT TO DRILL WELL" 40-73-3755

DATE WELL COMPLETED Dec 12, 1980 22 (TO NEAREST FOOT) 26 28 29 30 31 32 33 34 35 36 37

8-13 18 20 DRILLERS IDENTIFICATION NO. 2

OWNER Jenson LAST NAME FIRST NAME Michael

STREET OR RFD 2401 Main St. K.D. POST OFFICE Woodmen Park

**WELL LOG**

STATE THE KIND OF FORMATIONS PENETRATED, THEIR COLOR, DEPTH, THICKNESS AND IF WATER BEARING

DESCRIPTION (USE ADDITIONAL SHEETS IF NECESSARY)	FEET		CHECK IF WATER BEARING
	FROM	TO	
<u>Sand</u>	<u>0</u>	<u>76</u>	
<u>Gray Micaceous</u>	<u>76</u>	<u>205</u>	<input checked="" type="checkbox"/>

**GROUTING RECORD**

WELL HAS BEEN GROUTED (CIRCLE APPROPRIATE BOX)  YES  NO

TYPE OF GROUTING MATERIAL (CIRCLE BOX)

CEMENT  BENTONITE, CLAY

NO. OF BAGS 27 NO. OF POUNDS 2068

GALLONS OF WATER 132

DEPTH OF GROUT SEAL (TO NEAREST FOOT)

FROM 0 FT. TO 60 FT.

**CASING RECORD**

CASING TYPES (INSERT APPROPRIATE CODE BELOW)

STEEL  CONCRETE

PLASTIC  OTHER

MAIN CASING TYPE ST NOMINAL DIAMETER TOP (MAIN) CASING (NEAREST INCH) 6 TOTAL DEPTH OF MAIN CASING (NEAREST FOOT) 80

**OTHER CASING (IF USED)**

DIAMETER (INCH) DEPTH (FEET) FROM TO

**SCREEN RECORD**

SCREEN TYPE OR OPEN HOLE (INSERT APPROPRIATE CODE BELOW)

STEEL  BRASS OR BRONZE  OPEN HOLE

PLASTIC  OTHER

C 2 (SEQ. NO.) 6

DEPTH (NEAREST WHOLE FOOT)

FROM 40 TO 205

1 2 3 4 5 6 7 8 9 10 11 12 13 14 15 16 17 18 19 20 21 22 23 24 25 26 27 28 29 30 31 32 33 34 35 36 37 38 39 40 41 42 43 44 45 46 47 48 49 50 51 52 53 54 55 56 57 58 59 60 61 62 63 64 65 66 67 68 69 70 71 72 73 74 75 76 77 78 79 80 81 82 83 84 85 86 87 88 89 90 91 92 93 94 95 96 97 98 99 100

SLOTSIZE 1, 3/8 2, 3/8

DIAMETER OF SCREEN 56 (NEAREST INCH) FROM 15 TO 68

GRAVEL PACK 30 68

IF WELL DRILLED WAS A FLOWING WELL CIRCLE BOX  68  F

DRILLERS NAME Joseph L. Mayde

(PLEASE PRINT) SIGNATURE Joseph L. Mayde

WRA USE ONLY (NOT TO BE FILLED IN BY DRILLER) (E.R.O.S.)

T  LOG CASSING  70  72  74 75 76 OTHER DATA AVAILABLE

C 3 (SEQ. NO.) 6

**PUMPING TEST**

HOURS PUMPED (TO NEAREST HOUR) 2

PUMPING RATE (GALLONS PER MINUTE TO NEAREST GALLON) 10

METHOD USED TO MEASURE PUMPING RATE dir

WATER LEVEL: (DISTANCE FROM LAND SURFACE)

BEFORE PUMPING 45 (NEAREST FOOT) 17 20

WHEN PUMPING 5 (NEAREST FOOT) 22 25

TYPE OF PUMP USED (CIRCLE APPROPRIATE BOX) (FOR PUMPING TEST)

AIR  PISTON  TURBINE

CENTRIFUGAL  ROTARY  OTHER (DESCRIBE BELOW)

JET  SUBMERSIBLE

**PUMP INSTALLED**

TYPE OF PUMP (WRITE APPROPRIATE LETTER IN BOX - SEE ABOVE: A, C, J, P, R, S, T, O)

DRILLER WILL INSTALL PUMP (CIRCLE APPROPRIATE BOX)  YES  NO

CAPACITY: GALLONS PER MINUTE (TO NEAREST GALLON) 31 35

PUMP HORSE POWER 37 41

PUMP COLUMN LENGTH (NEAREST FOOT) 43 47

**CASING HEIGHT (CIRCLE APPROPRIATE BOX AND ENTER CASING HEIGHT)**

ABOVE  BELOW

LAND SURFACE (NEAREST FOOT) 2 49 50 51

**LOCATION OF WELL ON LOT**

SHOW PERMANENT STRUCTURE SUCH AS BUILDINGS, SEPTIC TANKS, AND/OR OTHER LAND MARKS AND INDICATE NOT LESS THAN TWO DISTANCES (MEASUREMENTS TO WELL).

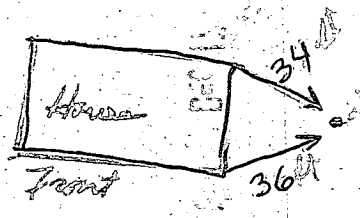

**B 1** 5801 SEQUENCE NO. (WRA USE ONLY)

1 2 3 (SEQ. NO.) 6  
 (THIS NUMBER IS TO BE PUNCHED IN COLS. 3-6 ON ALL CARDS)

**STATE OF MARYLAND**  
**WATER RESOURCES ADMINISTRATION**  
 TAWES STATE OFFICE BLDG., ANNAPOLIS, MARYLAND 21401  
**APPLICATION FOR PERMIT TO DRILL WELL**

WRA PERMIT NUMBER 40-73-3755

FILL IN THIS FORM COMPLETELY

DATE RECEIVED (WRA USE ONLY)  
 1:30 P.M.  
 12/12/80  
 2nd

OWNER Kenneth Lawrence  
 COL 15 LAST NAME COL 34 FIRST NAME

STREET OR RFD 3441 Davis Rd.  
 COL 36 COL 55

POST OFFICE Woodbine Md. 21794  
 COL 57 COL 76

**B 1 CONTINUED DRILLER INFORMATION**

1 2 3 (SEQ. NO.) 6

DATE Dec 1, 1980 LICENSE NUMBER 238  
 77 80

FIRST NAME Joseph L. Magee DRILLER LAST NAME

SIGNATURE Joseph L. Magee

**B 3 LOCATION OF WELL**

1 2 3 (SEQ. NO.) 6 Howard  
 COUNTY (DO NOT ABBREVIATE COUNTY NAME) 21

SUBDIVISION 23 42

SECTION 44 LOT 48 50

NEAREST TOWN Highland 52 71

MILES FROM TOWN (ENTER 0 IF IN TOWN) 7.5 76 77 78

**B 2 WELL INFORMATION**

1 2 3 (SEQ. NO.) 6

MAXIMUM PUMPING RATE (GALLONS PER MINUTE) 5  
 8 12

AVERAGE DAILY QUANTITY NEEDED (GALLONS PER DAY) 750  
 14 20

**B 4 DIRECTION FROM TOWN**  
 (CIRCLE APPROPRIATE BOX)

N NORTH  E EAST  NE NORTHEAST  SE SOUTHEAST  
 S SOUTH  W WEST  NW NORTHWEST  SW SOUTHWEST

NEAR WHAT ROAD Brown Bridge Rd  
 8 9 8 9 8 9 8 9

ON WHICH SIDE OF ROAD (CIRCLE APPROPRIATE BOX)  N  S  E  W  
 32 32 32 32

DISTANCE FROM ROAD (ENTER DISTANCE AND CIRCLE APPROPRIATE BOX) 70  
 34 37 38 39

**USE FOR WATER (CIRCLE APPROPRIATE BOX)**

HOME (SINGLE OR DOUBLE HOUSEHOLD UNIT ONLY)

FARMING, AGRICULTURE, IRRIGATION

INDUSTRIAL, COMMERCIAL, STATE AND FEDERAL GOVERNMENT.

MUNICIPAL WATER SUPPLY } MUST HAVE STATE HEALTH DEPT. APPROVAL

PRIVATE WATER COMPANY }

TEST

APPROXIMATE DEPTH OF WELL 180 FEET  
 24 28

APPROXIMATE DIAMETER OF WELL 6 (NEAREST INCH)

**METHOD OF DRILLING USED (CIRCLE APPROPRIATE METHOD)**

BORED (OR AUGERED)  JETTED  DRIVEN

80-87  AIR-ROTARY  AIR-PERCUSSION  ROTARY (HYDRAULIC ROTARY)

CABLE  REVERSE-ROTARY  DRIVE-POINT

OTHER (DESCRIBE)

**REPLACEMENT OR DEEPEMED WELLS (CIRCLE APPROPRIATE BOX)**

THIS WELL WILL NOT REPLACE AN EXISTING WELL

THIS WELL WILL REPLACE A WELL THAT WILL BE ABANDONED AND SEALED

THIS WELL WILL REPLACE A WELL THAT WILL BE USED AS A STANDBY

THIS WELL WILL DEEPEM AN EXISTING WELL PERMIT NUMBER OF WELL TO BE REPLACED OR DEEPEMED (IF AVAILABLE)

**NOT TO BE FILLED IN BY DRILLER (WRA USE ONLY)**

APPROPRIATION PERMIT NUMBER [ ] ENGINEER REVIEW DISTRICT NO. [ ]

FORCE [ ] WRITE INITIALS IN BOX [ ] CONDITIONS [ ]

**B 4 HEALTH DEPARTMENT APPROVAL**

1 2 3 (SEQ. NO.) 6

41  STATE HEALTH COUNTY NAME Howard COUNTY NO. 431050

MO. DAY YR. 12 01 80

DATE 12 01 80 APPROVED BY Fred Frommelt, Sanitarian

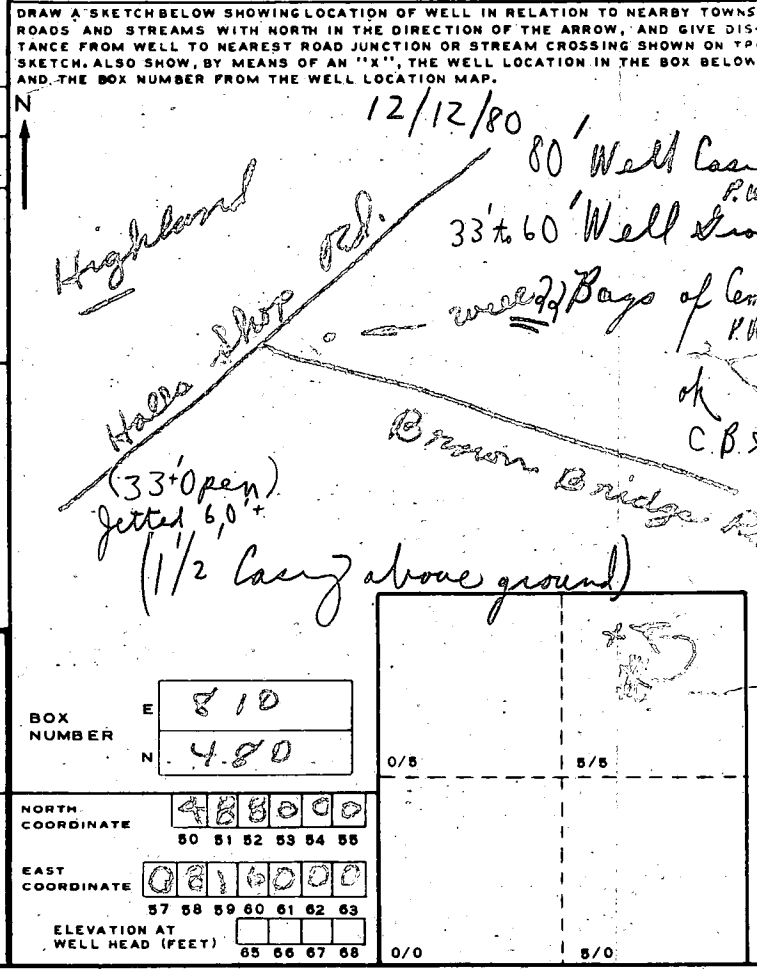

**B 5 SPECIAL CONDITIONS 8-63 (WRA USE ONLY)**

1 2 3 (SEQ. NO.) 6