

HOWARD COUNTY  
PERMIT APPLICATION

PERMIT NUMBER  
808002297

Building Address <u>12975 E. LINDEN CHURCH RD.</u> <u>CLARKSVILLE MD, 21029</u> Suite/Apt. #: _____ SDP/WP/Petition #: _____ Census Tract _____ Subdivision _____ Section _____ Area _____ Lot _____ Tax Map _____ Parcel _____ Grid _____ Zoning _____ Map Coordinates _____ Lot size _____	Property Owner's Name <u>Glen Nicastro</u> Address <u>12975 E. LINDEN CHURCH RD.</u> City <u>CLARKSVILLE</u> State <u>MD</u> Zip Code <u>21029</u> Phone <u>410 531 9006</u> Phone _____ Applicant's Name & Mailing Address, (if other than stated hereon): _____ Phone _____ Fax _____
Existing Use <u>SFD.</u> Proposed Use <u>NEW DECK</u> Estimated Construction Cost \$ <u>14,000</u> Description of Work <u>NEW WOOD FRAME</u> <u>16x20 DECK W/ STAIRS TO GRADE</u> <u>320 FT<sup>2</sup></u>	Contractor Company <u>Bruce Builders LLC</u> Contact Person <u>MICHAEL BRUCE</u> Address <u>720 OAK GROVE CIRCLE</u> City <u>SEV. PARK</u> State <u>MD</u> Zip Code <u>21146</u> License No. <u>67133</u> Phone <u>443 324-7465</u> Fax _____
Occupant or Tenant <u>GLEN NICASTRO</u> Contact Name <u>GLEN NICASTRO</u> Address <u>12975 E. LINDEN CHURCH RD.</u> City <u>CLARKSVILLE</u> State <u>MD</u> Zip Code <u>21029</u> Phone <u>410 531-9006</u> Fax _____	Engineer or Architect Company _____ Contact Person _____ Address _____ City _____ State _____ Zip Code _____ Phone _____ Fax _____

BUILDING DESCRIPTION - COMMERCIAL		BUILDING DESCRIPTION - RESIDENTIAL	
<b>Building Characteristics</b> Height: _____ No. of stories: _____ Gross area, sq. ft. per floor: _____ Use group: _____ Construction type: <input type="checkbox"/> Reinforced Concrete <input type="checkbox"/> Structural Steel <input type="checkbox"/> Masonry <input type="checkbox"/> Wood Frame <input type="checkbox"/> State Certified Modular	<b>Utilities</b> Water Supply: <input type="checkbox"/> Public <input type="checkbox"/> Private Sewage Disposal: <input type="checkbox"/> Public <input type="checkbox"/> Private Electric Yes <input type="checkbox"/> No <input type="checkbox"/> Gas Yes <input type="checkbox"/> No <input type="checkbox"/> Heating System: Electric <input type="checkbox"/> Oil <input type="checkbox"/> Natural Gas <input type="checkbox"/> Propane Gas <input type="checkbox"/> Sprinkler system: N/A <input type="checkbox"/> <input type="checkbox"/> Full <input type="checkbox"/> Partial <input type="checkbox"/> Other Suppression <input type="checkbox"/> # of Heads	<b>Building Characteristics</b> SF Dwelling <input checked="" type="checkbox"/> SF Townhouse <input type="checkbox"/> Depth _____ Width _____ 1st floor: _____ 2nd floor: _____ Basement: _____ Finished Basement <input type="checkbox"/> Unfinished Basement <input type="checkbox"/> <input type="checkbox"/> Crawlspace <input type="checkbox"/> Slab on Grade <input type="checkbox"/> No. of Bedrooms _____ Height: _____ Multi-family dwellings: No. of efficiency units: _____ No. of 1 BR units: _____ No. of 2 BR units: _____ No. of 3 BR units: _____ Other Structure: _____ Dimensions: _____ Footings: _____ Roof Height: _____ <input type="checkbox"/> State Certified Modular <input type="checkbox"/> Manufactured Home	<b>Utilities</b> Water Supply: <input checked="" type="checkbox"/> Public <input type="checkbox"/> Private Sewage Disposal: <input type="checkbox"/> Public <input checked="" type="checkbox"/> Private Electric Yes <input checked="" type="checkbox"/> No <input type="checkbox"/> Gas Yes <input type="checkbox"/> No <input type="checkbox"/> Heating System: Electric <input checked="" type="checkbox"/> Oil <input type="checkbox"/> Natural Gas <input type="checkbox"/> Propane Gas <input type="checkbox"/> Sprinkler system: N/A <input type="checkbox"/> <input type="checkbox"/> NFPA #13D <input type="checkbox"/> NFPA #13R <input type="checkbox"/> Other:

THE UNDERSIGNED HEREBY CERTIFIES AND AGREES AS FOLLOWS: (1) THAT HE/SHE IS AUTHORIZED TO MAKE THIS APPLICATION; (2) THAT THE INFORMATION IS CORRECT; (3) THAT HE/SHE WILL COMPLY WITH ALL REGULATIONS OF HOWARD COUNTY WHICH ARE APPLICABLE THERETO; (4) THAT HE/SHE WILL PERFORM NO WORK ON THE ABOVE REFERENCED PROPERTY NOT SPECIFICALLY DESCRIBED IN THIS APPLICATION; (5) THAT HE/SHE GRANTS COUNTY OFFICIALS THE RIGHT TO ENTER ON TO THIS PROPERTY FOR THE PURPOSE OF INSPECTING THE WORK PERMITTED AND POSTING NOTICES.

[Signature]  
 Applicant's Signature  
Owner Bruce Builders  
 Title/Company

M. Bruce  
 Print Name  
July 30, 2008  
 Date

Checks payable to: DIRECTOR OF FINANCE OF HOWARD COUNTY  
 \*\* PLEASE WRITE NEATLY AND LEGIBLY. \*\*  
 - FOR OFFICE USE ONLY -

AGENCY	DATE	SIGNATURE APPROVAL	DPZ SETBACK INFORMATION	PROPERTY ID#:
Land Development, DPZ			Front: _____	Filing fee \$ _____
State Highways			Rear: _____	Permit fee \$ _____
Building Official			Side: _____	Excise tax \$ _____
Dev. Engineering, DPZ	<u>7/30/08</u>	<u>[Signature]</u>	Side St.: _____	Add'l per. fee \$ _____
Health			All minimum setbacks met?	TOTAL FEES \$ _____
Fire Protection			YES <input type="checkbox"/> NO <input type="checkbox"/>	Sub-total paid \$ _____
Is Sediment Control approval required prior to issuance?			Is Entrance Permit required?	Balance due \$ _____
YES <input type="checkbox"/> NO <input type="checkbox"/>			YES <input type="checkbox"/> NO <input type="checkbox"/>	Check # _____
CONTINGENCY CONSTRUCTION START: <input type="checkbox"/>			Historic District?	Validation # _____
ONE STOP SHOP: <input type="checkbox"/>			YES <input type="checkbox"/> NO <input type="checkbox"/>	
Distribution of Copies- White: Building Official Green: LDD, DPZ Yellow: DED, DPZ Pink: Health Gold: SHA			Lot Coverage for NewTown Zone _____	Accepted by _____
T:\forms\PERMIT.FRM			SDP/Red-line approval date _____	

William E. Doyle

LAND SURVEYOR 8440

8312 EMERALD DRIVE SYKESVILLE, MARYLAND 21784 PHONE (301) 798-2210

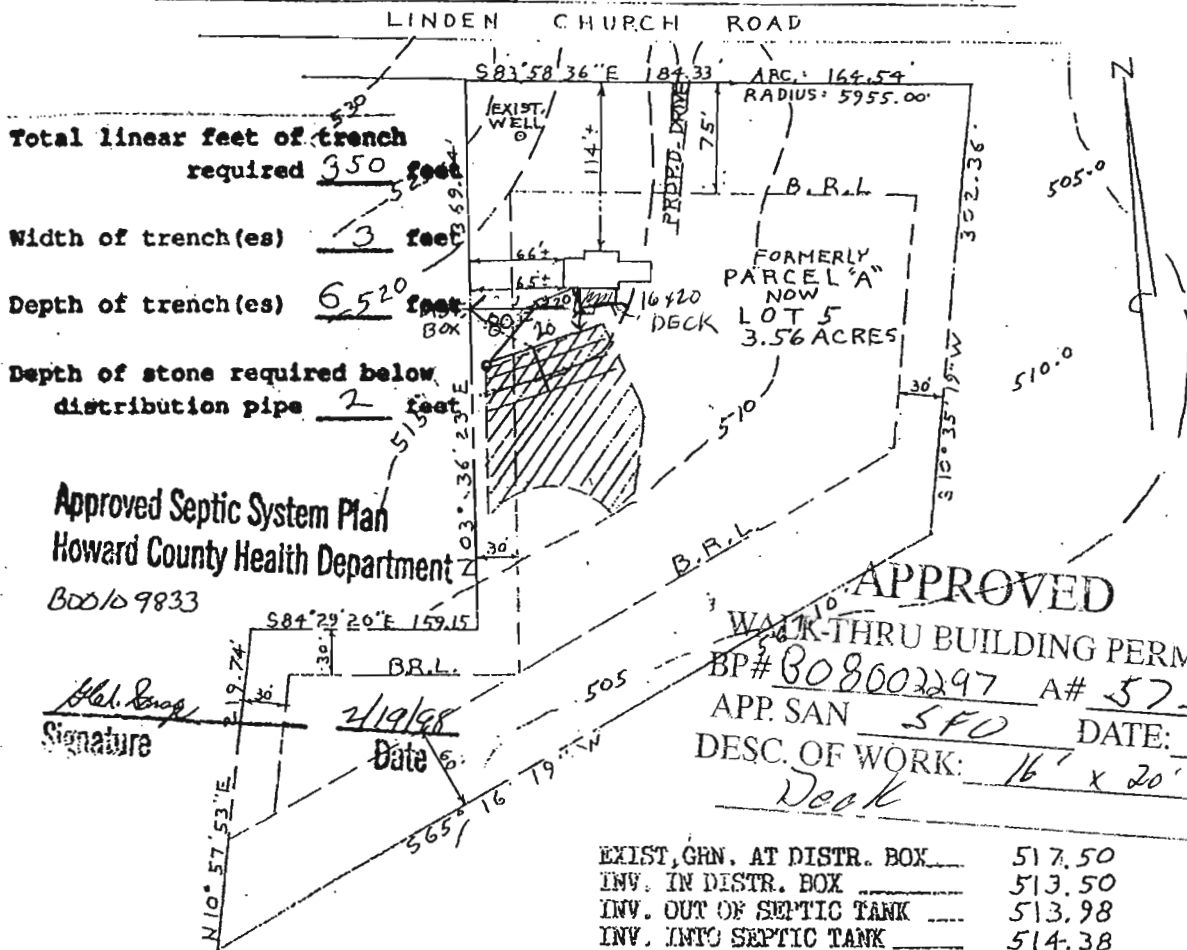

Total linear feet of trench required 350 feet  
 Width of trench(es) 3 feet  
 Depth of trench(es) 6.520 feet  
 Depth of stone required below distribution pipe 2 feet

Approved Septic System Plan  
 Howard County Health Department  
 B00109833

*Hal. Snop*  
 Signature

2/19/98  
 Date

**APPROVED**  
 WALK-THRU BUILDING PERMIT  
 BP# 808002297 A# 57335-B  
 APP. SAN SFO DATE: 7/31/08  
 DESC. OF WORK: 16' x 20' Deck

EXIST. GRN. AT DISTR. BOX	517.50
INV. IN DISTR. BOX	513.50
INV. OUT OF SEPTIC TANK	513.98
INV. INTO SEPTIC TANK	514.38
INV. OUT OF DWELLING	514.68
FIRST FLOOR ELEV.	523.00
CELLAR ELEV.	515.00
WELL ELEV.	522.00
NO. OF BEDROOMS	5
ACREAGE	3.56 ACRES



I CERTIFY THE ABOVE MEASUREMENTS AND ELEVATIONS ARE ACTUAL AND CORRECT FOR THIS PROPERTY.

signed *William E. Doyle*

**PLOT PLAN**  
 12975 LINDEN CHURCH ROAD  
 LOT 5  
 LINDEN CHURCH ROAD PROPERTY  
 TAX MAP 28, BLOCK 15, PARCEL 145  
 5TH ELECTION DISTRICT  
 HOWARD COUNTY, MARYLAND  
 SCALE: 1" = 100'  
 DRAWN: JANUARY 23, 1998