

PUB. SEWER STATUS VERIFIED BY NA — SRK

ISSUE DATE: 4/9/2003

P 518618

APPROVAL DATE: 5-19-03

A REPAIR

PERMIT INDEXED

**ON-SITE SEWAGE DISPOSAL SYSTEM
HOWARD COUNTY HEALTH DEPARTMENT
BUREAU OF ENVIRONMENTAL HEALTH**

04-314050

Jack Fyock Septic Service IS PERMITTED TO INSTALL ALTER

ADDRESS: PO Box 89, Glenelg, MD 21737 PHONE NUMBER: 410-988-9270

SUBDIVISION: _____ LOT NUMBER: 5-A

ADDRESS: 2800 Duvall Road PROPERTY OWNER: Scott Carneal

SEPTIC TANK CAPACITY (GALLONS): Existing 1000 gal ADD A 1250

PUMP CHAMBER CAPACITY (GALLONS): N/A FOR ADDITIONAL

NUMBER OF BEDROOMS: 4

SQUARE FEET PER BEDROOM: 210

LINEAR FEET OF TRENCH REQUIRED: 3-90' trenches

TRENCHES:	Trench to be 3 feet wide. Inlet ^{1 1/2'} feet below original grade. Bottom maximum depth ^{2 1/2'} feet below original grade. Effective area begins at 2' feet below original grade. 1 foot of stone below distribution pipe.
LOCATION:	Cave in existing dry well. ADD 1250 tank to system. Run 3-90' trenches on contour.
PURPOSE:	Septic system has failed. Call for inspection when ground is opened so sanitarian can recommend repair. Clogged line - and in support of building permit.

PLANS APPROVED: Kacie Noonan DATE: 5-7-03
5/5/2003

- NOTE: PERMIT VOID AFTER 2 YEARS
- NOTE: CONTRACTOR RESPONSIBLE FOR SCHEDULING A PRE-CONSTRUCTION INSPECTION FOR ALL INSTALLATIONS
- NOTE: WATERTIGHT SEPTIC TANKS REQUIRED
- NOTE: ALL PARTS OF SEPTIC SYSTEM SHALL BE 100 FEET FROM ANY WATER WELL
- NOTE: MANHOLE RISERS REQUIRED ON ALL SEPTIC TANKS AND PUMP CHAMBERS

**NEITHER THE HOWARD COUNTY COUNCIL NOR THE HEALTH DEPARTMENT IS
RESPONSIBLE FOR THE SUCCESSFUL OPERATION OF ANY SYSTEM
PERMITTEE RESPONSIBLE FOR OBTAINING FINAL APPROVAL ON THIS PERMIT
CALL 410-313-2640 FOR INSPECTION OF SEPTIC SYSTEM**

P518618

NOT TO SCALE

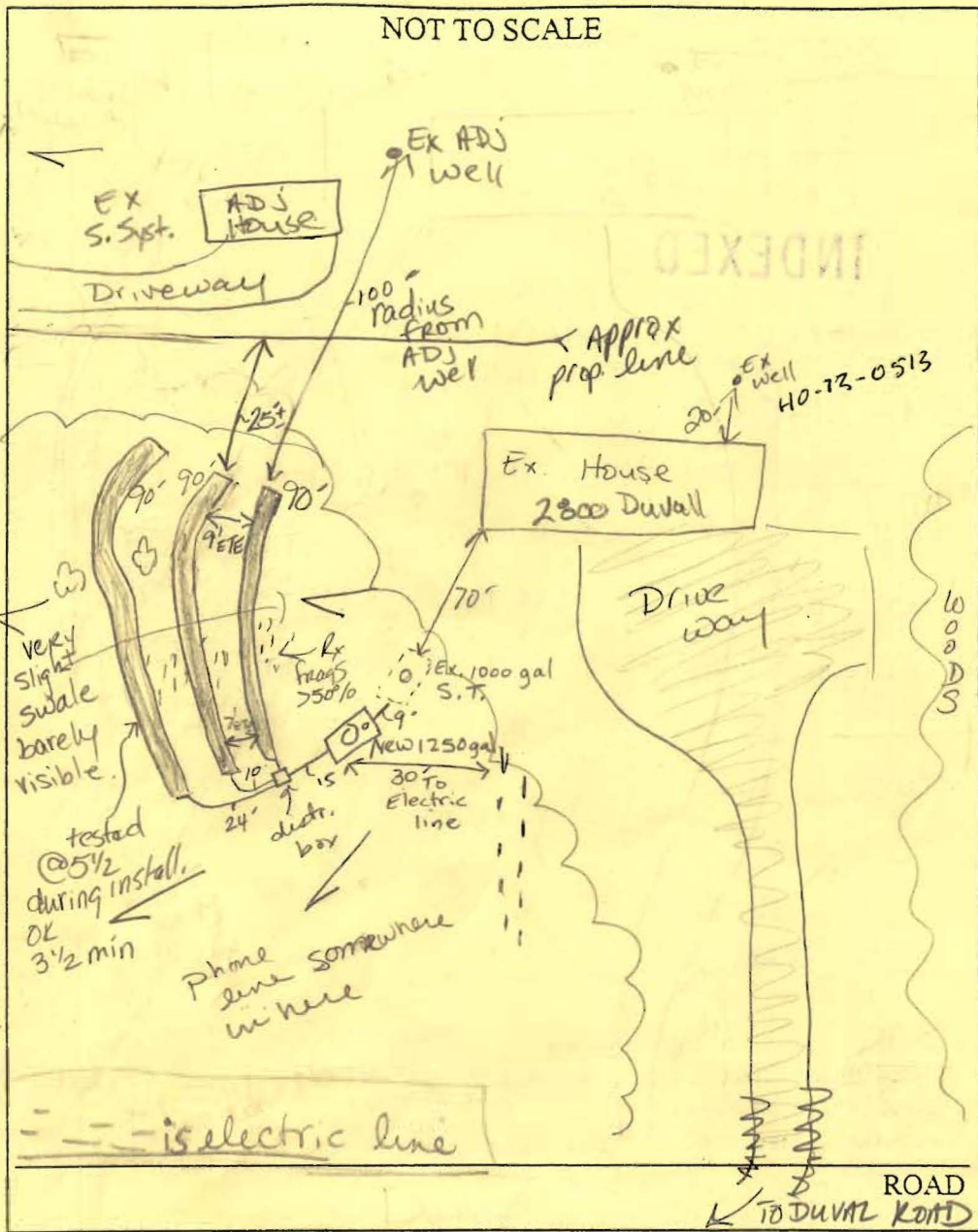

TRENCH/DRAINFIELD DATA		
WIDTH	INLET	BOTTOM
3	1 1/2	2 1/2-3'
NUMBER OF TRENCHES		3
TOTAL LENGTH		270'
ABSORPTION AREA		
DISTRIBUTION BOX LEVEL		yes
DISTRIBUTION BOX BAFFLE		
DISTRIBUTION BOX PORT		No

SEPTIC TANK DATA		EX 1000
SEPTIC TANK 1 LEVEL		NEW-4
CAPACITY	1250	GAL
SEAM LOC	TOP	
TANK LID DEPTH	1'	
BAFFLES	yes	
BAFFLE FILTER	N	
MANHOLE LOC	middle	
6" PORT LOC	front	
WATERTIGHT TEST	NO	
SEPTIC TANK 2 LEVEL		N/A
CAPACITY		GAL
SEAM LOC		
TANK LID DEPTH		
BAFFLES		
BAFFLE FILTER		
MANHOLE LOC		
6" PORT LOC		
WATERTIGHT TEST		

PRE-CONSTRUCTION 5-7-03 Dry well effluent measured 10' below surface. Bottom of Dry Well is @ 11' - must be too much R - should

INSTALLATION be saturated by now. Dug holes A + B, >80% Rock starting at 2 1/2'. Downslope of Hole A by 10' perched at 3 1/2' corner + hole C perc at 4 1/2' and 2'. SEE SOIL PERC SHEET. No

surrounding well concerns downslope. Install trenches approximately 30-35' downslope of S. Tank (KN) 5-12-03 Inspector

there all day. OK TO COVER ALL TRENCHES. NEED TO INSPECT d. box for water test, levelers, and appropriate baffle. Existing

dry well collapsed + filled in. (KN) 5-19-03 D. Box covered. Called

FINAL INSPECTOR Kacu Noonan DATE OF APPROVAL 5-19-03

Skip on cell. STD levelers USED + cinder block cut 1/2" (KN)