

~~3/11/80~~ Canceled
~~9:30 A.M.~~
~~3/22/80~~
~~9:30 A.M.~~
4/21/80
Afternoon
I please

4/23/80

PERMIT

P 30541

A REPAIR

SEWAGE DISPOSAL SYSTEM
MARYLAND STATE DEPARTMENT OF HEALTH*

HOWARD COUNTY

ELLICOTT CITY

DISTRICT _____

DATE 2/29/80

01-181394

Thomas Earp IS PERMITTED TO INSTALL ALTER X

ADDRESS 206 Old Padonia Road, Cockeysville, Md. PHONE 666-1444

SUBDIVISION _____ ROAD 6021 Old Lawyers Hill Road LOT _____

PROPERTY OWNER Audrey Suhr

ADDRESS 6021 Old Lawyers Hill Road, Elkridge, Md. 21227

SPECIFICATIONS 3 bedrooms

SEPTIC TANK CAPACITY 1000 GALLONS **NEW TANK TO REPLACE EXISTING TANK**

DRAIN FIELD _____ DEPTH _____ FEET, BOTTOM AREA _____ SQ. FT. **INSTALLED IN**

DEEP TRENCH _____ DEPTH _____ FEET, BOTTOM AREA _____ SQ. FT. **THE HOUSE**

SEEPAGE PITS _____ ABSORBENT SIDE-WALL AREA _____ SQ. FT.

INLET PIPE _____ FT. BELOW ORIGINAL GRADE. MAXIMUM DEPTH _____ FT. BELOW ORIGINAL GRADE

EFFECTIVE DEPTH AT _____ FT. BELOW ORIGINAL GRADE.

LOCATE DISPOSAL AREA _____ FT. FROM _____ LOT LINE AND _____ FT. FROM _____ LOT LINE AS SEEN WHEN

FACING LOT FROM

REPAIR-CALL FOR INSPECTION WHEN GROUND IS OPENED UP SO SANITARIAN CAN

RECOMMEND REPAIR. 3/29/80 INSTALL TANK 1000 GALL

& CONNECTED TO OLD DRAINAGE SYSTEM.

FIX BROKEN PIPE NEAR ROAD DOWNHILL FROM

PLANS APPROVED BY D.W. Monaghan/P.F. Wine DATE 2/29/80 TANK

COVER NO WORK UNTIL INSPECTED AND APPROVED. 4/21/80 DITCH - 60 FT LONG 12 FT

NEITHER THE HOWARD COUNTY COUNCIL NOR THE HEALTH DEPARTMENT IS RESPONSIBLE FOR THE SUCCESSFUL OPERATION OF ANY SYSTEM.

NOTE: IF TRENCH IS USED CALL FOR INSPECTION BEFORE PLACING GRAVEL IN TRENCH. 6 FT STONE

NOTE: NO DRY WELL SHALL EXCEED 15 FOOT IN DIAMETER. 1 1/2 FT TO 2 FT WIDE

NOTE: ALL PIPE FROM HOUSE TO DISPOSAL AREA MUST BE CAST IRON. RUN DITCH ALONG SIDE

PERMIT VOID AFTER THREE YEARS.

NOTE: INSTALL STAND PIPE ON SEPTIC TANK AND DRY WELL. STAND PIPES MUST BE 6 INCHES IN DIAMETER. CAST IRON, CONCRETE OR TERRA

COTTA ACCEPTED.

OF HILL STARTING ABOUT 20 FT DOWNHILL FROM TANK

*INSTALLER IS RESPONSIBLE FOR OBTAINING FINAL APPROVAL ON THIS PERMIT.

OK FOR HOME OWNER TO MEASURE DEPTH OF DITCH.

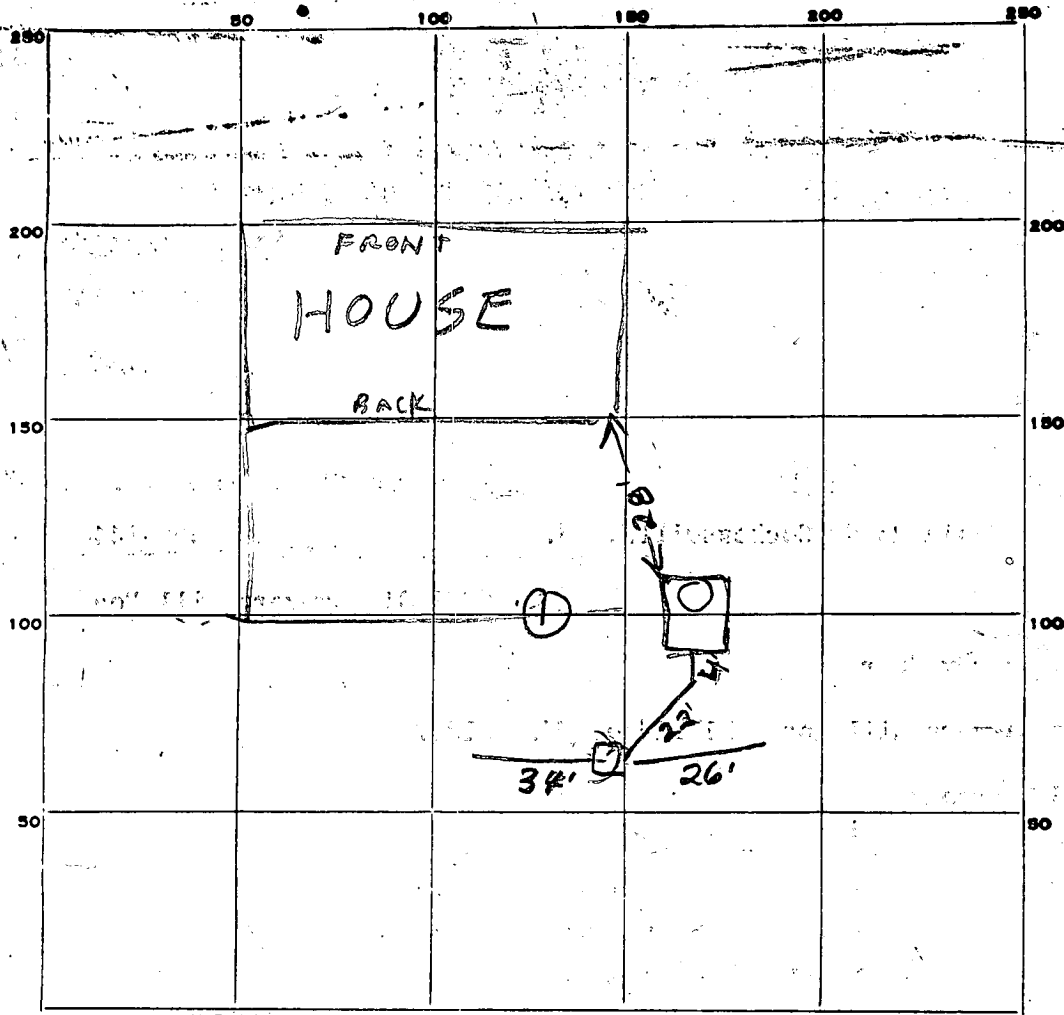

INDICATE NORTH. - NAME ADJOINING ROADWAY AS BASE LINE.

PERMIT CARD _____

SEPTIC TANK, LEVEL OK 1000 CLEANOUTS MANHOLE

TOP 6FT UNDER GROUND

DISTRIBUTION BOX, LEVEL _____ OK

DITCH _____

TILE FIELD, DEPTH _____ FT. TRENCH WIDTH _____ FT.

GRAVEL DEPTH _____ IN. TOTAL LENGTH 60 FT.

NUMBER OF TRENCHES _____ TOTAL BOTTOM AREA 360 BELOW TOP 6FT

SEEPAGE PITS, INSIDE DIAMETER _____ FT. DEPTH BELOW INLET _____ FT.

ABSORBENT AREA _____ SQ. FT.

REMARKS 3/29/80 HOLE ① - 15FT DEEP TOP 6FT CLAY BOT 9FT SANDY LOAM.

4/21/80 J.S & RH NOTICED SEWAGE OVERFLOW DOWN HILL FROM HOUSE TANK OK TO COVER RH. OBTAINED DYE FROM OFFICE, RETURNED & RUN DYE TEST. DYE TEST POSITIVE

HOLE ② 14FT DEEP TOP 6FT CLAY BOT 8 FT SANDY LOAM, CITY WATER

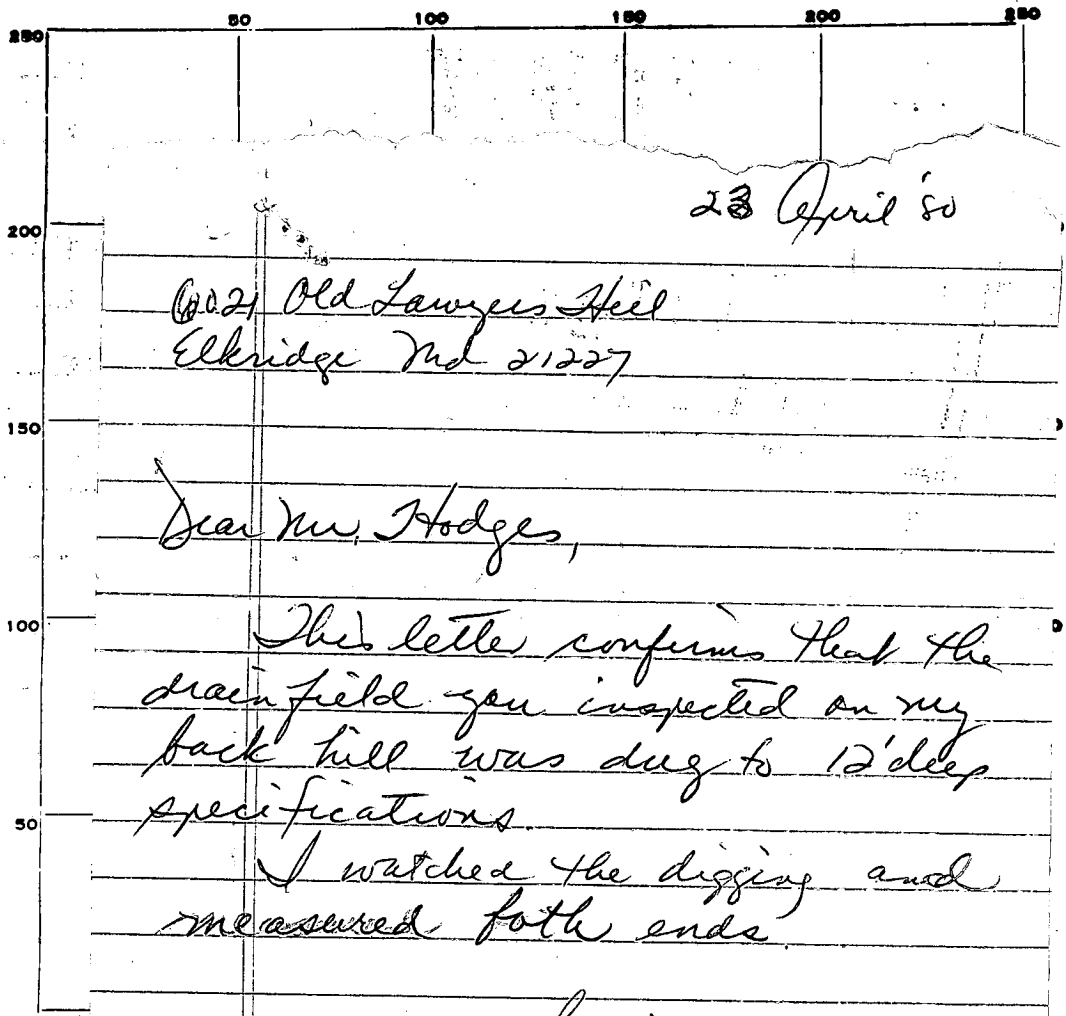

2021 Old Lawyers Hill
Elkridge Md 21227

Dear Mr. Hodges,

This letter confirms that the
drain field you inspected on my
back hill was dug to 12' deep
specifications.

I watched the digging and
measured both ends.

Sincerely,
Andrew Solle, Sr.

PERMIT CARD _____
SEPTIC TANK, LEVEL _____
DISTRIBUTION BOX, LE _____
TILE FIELD, DEPTH _____
GRAVEL D _____
NUMBER C _____

SEEPAGE PITS, INSIDE _____

ABSORBENT AREA _____ SQ. FT.

REMARKS 4/23/80 - DEEP DITCH DUG & STONE & PIPE
& PAPER ADDED. AVERAGE COVER ON DITCH
IS 5 FT. NO LETTER FROM HOMEOWNER. DITCH
CAN BE COVERED BUT NOT APPROVED UNTIL WE
RECEIVE A LETTER FROM THE HOMEOWNER R/H

4/29/80 LETTER RECEIVED R/H

DATE SYSTEM APPROVED 4/28/80 INSPECTOR Raymond Hodges