

2/20/80  
2-730 P.M.

approved 2/20/80  
J. Stayer

# PERMIT

P 30529

SEWAGE DISPOSAL SYSTEM

A REPAIR

MARYLAND STATE DEPARTMENT OF HEALTH\*

HOWARD COUNTY

65-371724

ELLICOTT CITY

DISTRICT \_\_\_\_\_

DATE 2/19/80

INDEXED

Jenkins Brothers

IS PERMITTED TO INSTALL \_\_\_\_\_ ALTER X

ADDRESS \_\_\_\_\_ PHONE \_\_\_\_\_

SUBDIVISION \_\_\_\_\_ ROAD off 8525 Murphy Rd. LOT \_\_\_\_\_

PROPERTY OWNER Mr. Wetzie Whetzel

ADDRESS off Route 29 - 8525 Murphy Rd.

SPECIFICATIONS 2 bedroom

SEPTIC TANK CAPACITY \_\_\_\_\_ GALLONS

DRAIN FIELD \_\_\_\_\_ DEPTH \_\_\_\_\_ FEET, BOTTOM AREA \_\_\_\_\_ SQ. FT.

DEEP TRENCH 12 DEPTH 50 FEET, BOTTOM AREA 360 SQ. FT.

SEEPAGE PITS \_\_\_\_\_ ABSORBENT SIDE-WALL AREA \_\_\_\_\_ SQ. FT.

INLET PIPE 4 FT. BELOW ORIGINAL GRADE, MAXIMUM DEPTH 12 FT. BELOW ORIGINAL GRADE

EFFECTIVE DEPTH AT \_\_\_\_\_ FT. BELOW ORIGINAL GRADE.

LOCATE DISPOSAL AREA \_\_\_\_\_ FT. FROM \_\_\_\_\_ LOT LINE AND \_\_\_\_\_ FT. FROM \_\_\_\_\_ LOT LINE AS SEEN WHEN FACING LOT FROM

REPAIR- CALL FOR INSPECTION WHEN GROUND IS OPENED UP SO SANITARIAN CAN

RECOMMEND REPAIR.

*Depending on depth of inlet pipe, (may have to be deeper to get slope) 50 ft of trench, 8 ft of stone.*

PLANS APPROVED BY Palmer F. Wine *Must have 360 sq ft* DATE 2/19/80

COVER NO WORK UNTIL INSPECTED AND APPROVED. *Two inspections*

NEITHER THE HOWARD COUNTY COUNCIL NOR THE HEALTH DEPARTMENT IS RESPONSIBLE FOR THE SUCCESSFUL OPERATION OF ANY SYSTEM.

- NOTE: IF TRENCH IS USED CALL FOR INSPECTION BEFORE PLACING GRAVEL IN TRENCH.
- NOTE: NO DRY WELL SHALL EXCEED 15 FOOT IN DIAMETER.
- NOTE: ALL PIPE FROM HOUSE TO DISPOSAL AREA MUST BE CAST IRON.

PERMIT VOID AFTER THREE YEARS.

NOTE: INSTALL STAND PIPE ON SEPTIC TANK AND DRY WELL. STAND PIPES MUST BE 6 INCHES IN DIAMETER. CAST IRON, CONCRETE OR TERRA COTTA ACCEPTED.

\*INSTALLER IS RESPONSIBLE FOR OBTAINING FINAL APPROVAL ON THIS PERMIT.

P30529

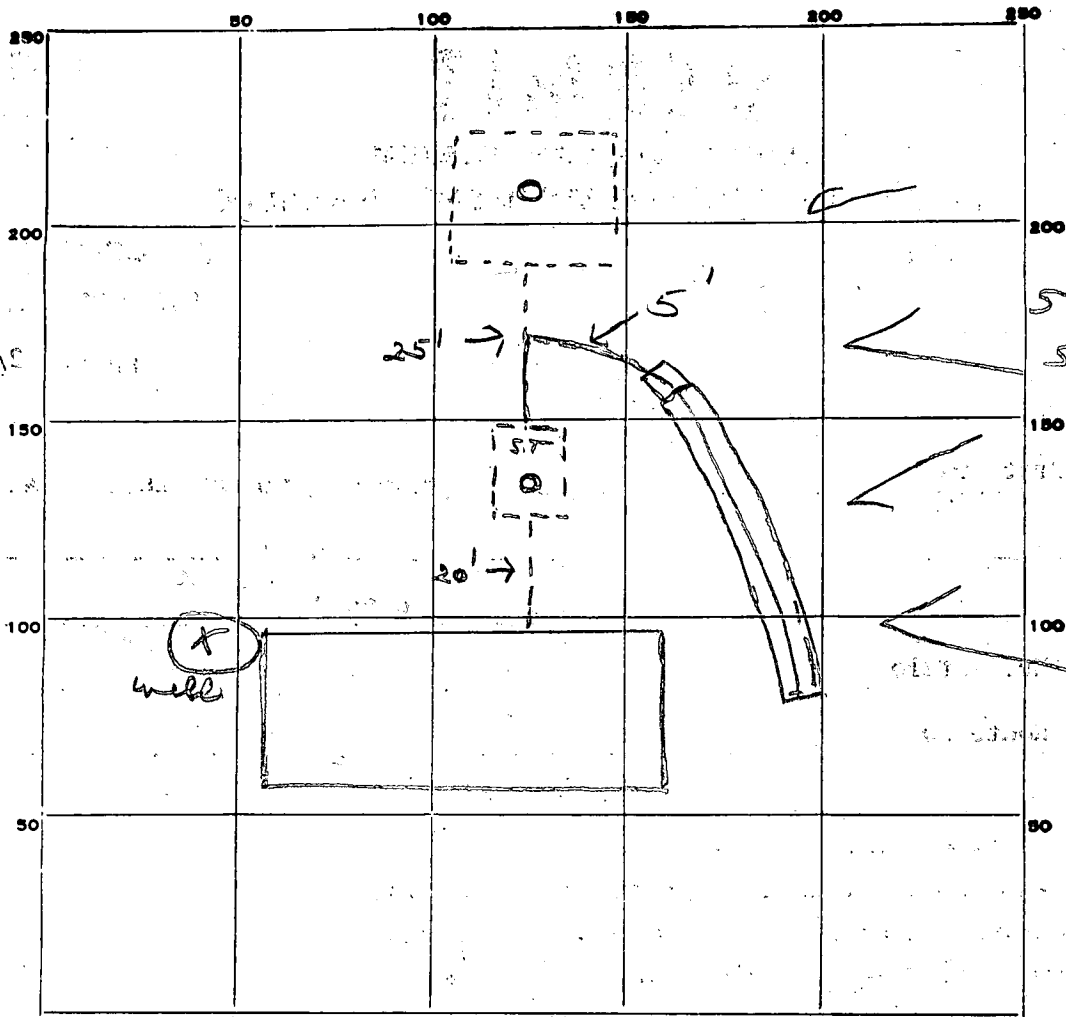

INDICATE NORTH. - NAME ADJOINING ROADWAY AS BASE LINE.

PERMIT CARD

SEPTIC TANK, LEVEL \_\_\_\_\_ CLEANOUTS ST / DW

DISTRIBUTION BOX, LEVEL \_\_\_\_\_ terra cotta

TILE FIELD, DEPTH 12 FT. TRENCH WIDTH 2 FT.

GRAVEL DEPTH 6 FT. IN. TOTAL LENGTH 60 FT.

NUMBER OF TRENCHES 1 TOTAL BOTTOM AREA 360

SEEPAGE PITS, INSIDE DIAMETER \_\_\_\_\_ FT. DEPTH BELOW INLET \_\_\_\_\_ FT.

ABSORBENT AREA 360 SQ. FT.

REMARKS 2/19/80 call when trench is ready - JS  
2/20/80 OK to cover all work - JS  
 (NOTE: waited till gravel + pipe in trench)

DATE SYSTEM APPROVED 2/20/8 INSPECTOR J. Stager

*Repair perc.*  
*2/19/80*  
*1:30 p.m.*

# APPLICATION

SEWAGE DISPOSAL TESTING

STATE OF MARYLAND - DEPARTMENT OF HEALTH AND MENTAL HYGIENE

A \_\_\_\_\_

P Repair

HOWARD COUNTY HEALTH DEPARTMENT  
ENVIRONMENTAL HEALTH SERVICES  
P.O. BOX 476 ELLICOTT, MARYLAND 21043  
TELEPHONE: 992-2330

DISTRICT 5th

DATE 2/13/80

TO: THE COUNTY HEALTH OFFICER  
ELLICOTT CITY, MARYLAND

I HEREBY APPLY FOR THE NECESSARY TEST IN ORDER TO CONSTRUCT (OR RECONSTRUCT) A SEWAGE DISPOSAL SYSTEM.

PROPERTY OWNER Robert Whetzel

ADDRESS 8525 Murphy Road, Laurel, Md. PHONE Jenkins - 465-XXX 6646

PROPERTY LOCATION:

SUBDIVISION \_\_\_\_\_ LOT NO. \_\_\_\_\_

ROAD AND DESCRIPTION 8525 Murphy Road

SIZE OF LOT ? TYPE BLDG. ?

THE SYSTEM INSTALLED UNDER THIS APPLICATION IS ACCEPTABLE ONLY UNTIL PUBLIC FACILITIES BECOME AVAILABLE.

I FULLY UNDERSTAND THE FEE CONNECTED WITH THE FILING OF THIS PERC TEST APPLICATION IS NON-REFUNDABLE UNDER

ANY CIRCUMSTANCES.

SIGNATURE OF APPLICANT /s/ Jenkins Brothers

APPROVED BY [Signature] FOR Whetzel DATE 2/19/80

REJECTED BY \_\_\_\_\_ FOR \_\_\_\_\_ DATE \_\_\_\_\_

HOLD PENDING FURTHER TESTS \_\_\_\_\_ DATE \_\_\_\_\_

REASONS FOR REJECTION OR HOLDING \_\_\_\_\_

# THIS IS NOT A PERMIT

SOIL PROFILE

0

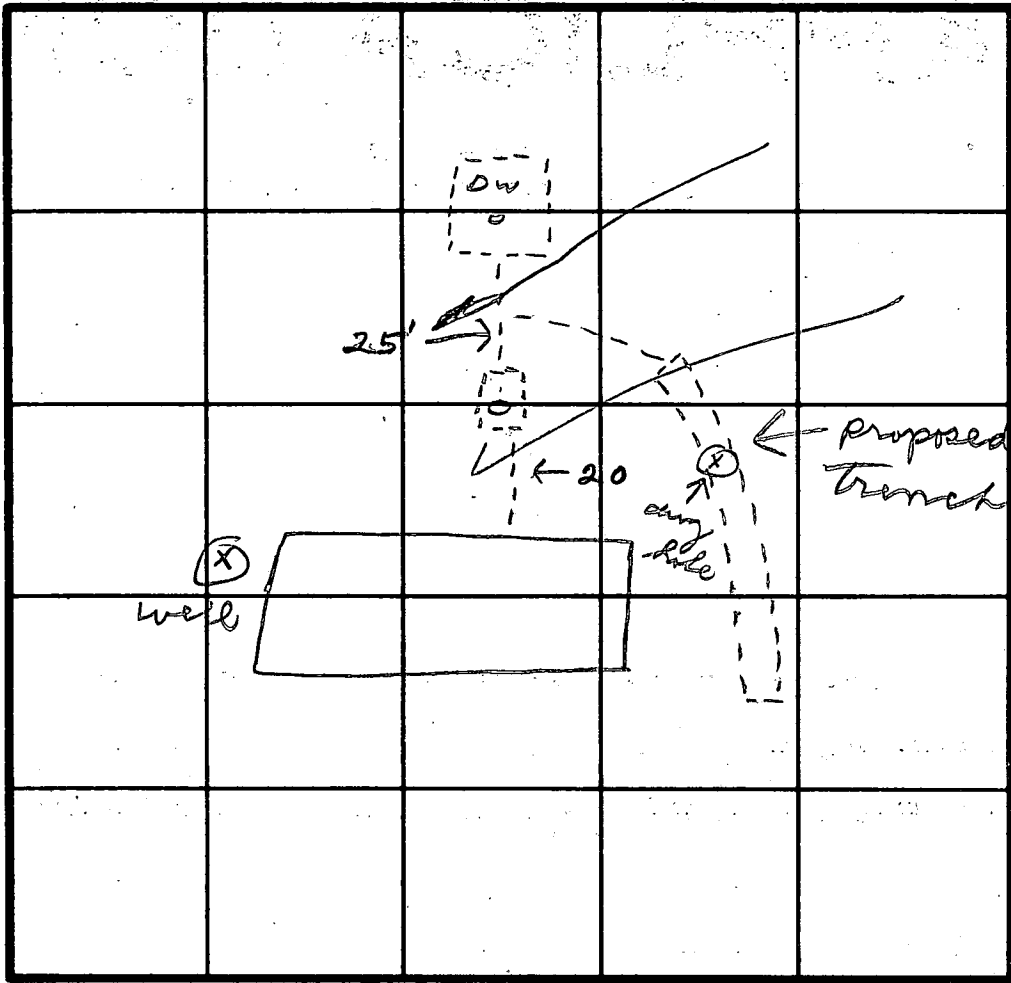

INDICATE NORTH - NAME ADJOINING ROADWAY AS BASE LINE.

Murphy RD

| DATE    | TEST NO. | DEPTH | PRE-WET   |             | TEST - 1" DROP |      | TIME |
|---------|----------|-------|-----------|-------------|----------------|------|------|
|         |          |       | START     | STOP        | START          | STOP |      |
| 2/17/80 | 1        | 13    | Visuals - | good soil - |                |      |      |
|         |          |       | no clay - | sandy loam  |                |      |      |
|         |          |       | to 13 ft  |             |                |      |      |
|         |          |       |           |             |                |      |      |
|         |          |       |           |             |                |      |      |
|         |          |       |           |             |                |      |      |
|         |          |       |           |             |                |      |      |
|         |          |       |           |             |                |      |      |
|         |          |       |           |             |                |      |      |
|         |          |       |           |             |                |      |      |

REMARKS \_\_\_\_\_

TYPE OF SOIL \_\_\_\_\_

TESTED BY *[Signature]*

ALSO PRESENT *[Signature]*  
*[Signature]*