

~~2/22/80~~  
~~9:30 A.M.~~

4/9/80

approved 4/10/80  
J. Stayer

# PERMIT

P 30524

A REPAIR

SEWAGE DISPOSAL SYSTEM

MARYLAND STATE DEPARTMENT OF HEALTH\*

HOWARD COUNTY

ELLICOTT CITY

INDEXED

DISTRICT 2nd

02-221071

DATE 2/13/80

Boender Associates

IS PERMITTED TO INSTALL ALTER X

ADDRESS Town & Country Blvd., Ellicott City, Md.

PHONE

SUBDIVISION ROAD 10236 Balto. Nat'l Pike LOT

PROPERTY OWNER Mrs. Joan Udoff (Enterprise Motors West)

ADDRESS same as above

SPECIFICATIONS

SEPTIC TANK CAPACITY 1000 GALLONS

DRAIN FIELD DEPTH FEET, BOTTOM AREA SQ. FT.

DEEP TRENCH  DEPTH 11-12 FEET, BOTTOM AREA 360 SQ. FT. ONE SIDE AREA

SEEPAGE PITS ABSORBENT SIDE-WALL AREA SQ. FT.

INLET PIPE FT. BELOW ORIGINAL GRADE. MAXIMUM DEPTH FT. BELOW ORIGINAL GRADE

EFFECTIVE DEPTH AT FT. BELOW ORIGINAL GRADE.

LOCATE DISPOSAL AREA FT. FROM LOT LINE AND FT. FROM LOT LINE AS SEEN WHEN

FACING LOT FROM

REPAIR-CALL FOR INSPECTION WHEN GROUND IS OPENED UP SO SANITARIAN CAN RECOMMEND

REPAIR. - DEEP DITCH - 2 FT WIDE 52 FT LONG, 11-12

Broumberg has all papers pertaining to case

FT DEEP WITH 7 FT OF STONE

PLACE DITCH BETWEEN 10870 FROM SITE DATE 2/13/80

PLANS APPROVED BY Palmer Wine

COVER NO WORK UNTIL INSPECTED AND APPROVED. OF OLD TANK & RUN TOWARD THE BACK OF LOT

NEITHER THE HOWARD COUNTY COUNCIL NOR THE HEALTH DEPARTMENT IS RESPONSIBLE FOR THE SUCCESSFUL OPERATION OF ANY SYSTEM.

NOTE: IF TRENCH IS USED CALL FOR INSPECTION BEFORE PLACING GRAVEL IN TRENCH. NEW 1000 GAL TANK NEEDED

NOTE: NO DRY-WELL SHALL EXCEED 15 FOOT IN DIAMETER.

NOTE: ALL PIPE FROM HOUSE TO DISPOSAL AREA MUST BE CAST IRON.

PERMIT VOID AFTER THREE YEARS.

NOTE: INSTALL STAND PIPE ON SEPTIC TANK AND DRY WELL. STAND PIPES MUST BE 6 INCHES IN DIAMETER. CAST IRON, CONCRETE OR TERRA COTTA ACCEPTED.

\*INSTALLER IS RESPONSIBLE FOR OBTAINING FINAL APPROVAL ON THIS PERMIT.

P 30524

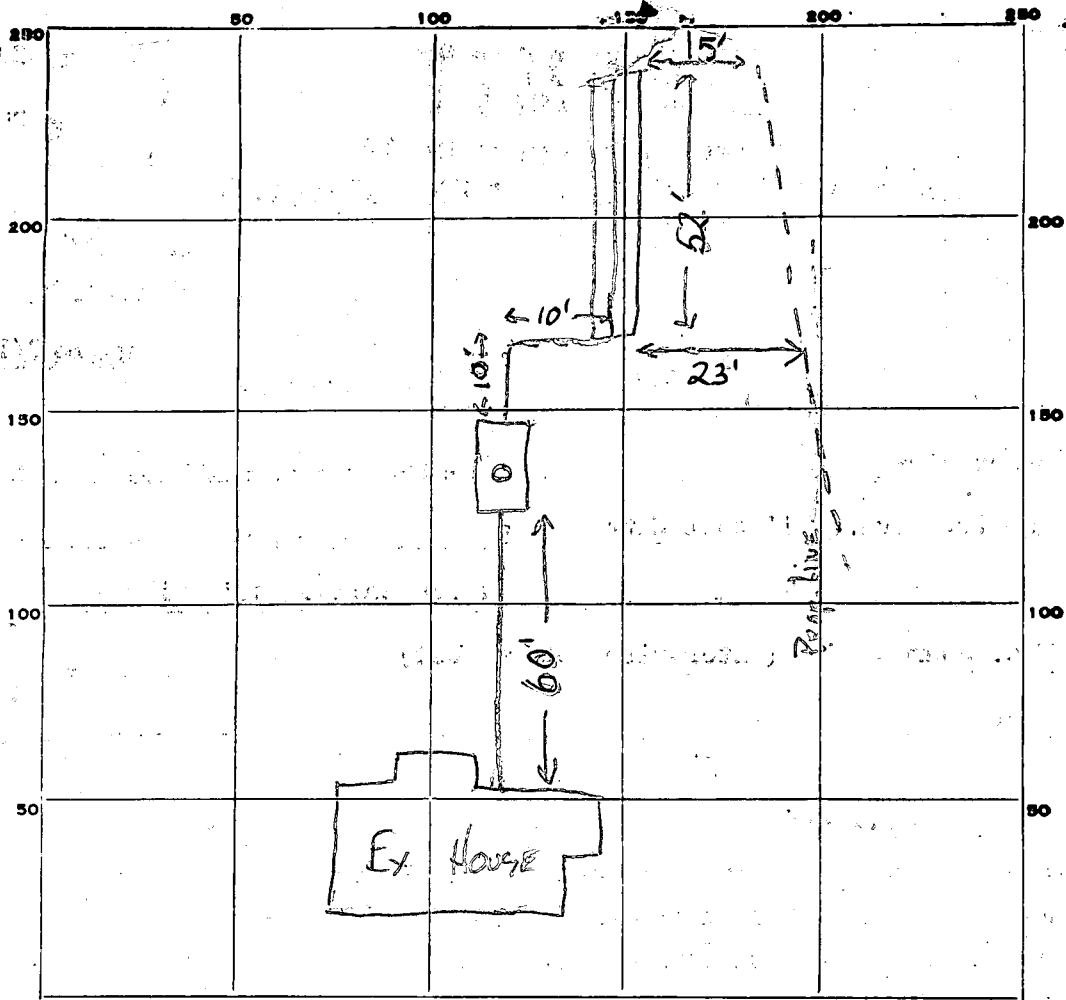

INDICATE NORTH. - NAME ADJOINING ROADWAY AS BASE LINE.

BALTO; NATL. PIKE (Rt 40 WEST)

PERMIT CARD

SEPTIC TANK, LEVEL

CLEANOUTS 5T  
 terra cotta

DISTRIBUTION BOX, LEVEL

TILE FIELD, DEPTH 12' FT. TRENCH WIDTH 2' FT.

GRAVEL DEPTH 9 IN. TOTAL LENGTH 52' FT.

NUMBER OF TRENCHES 1 TOTAL BOTTOM AREA 468

SEEPAGE PITS, INSIDE DIAMETER      FT. DEPTH BELOW INLET      FT.

ABSORBENT AREA 468 SQ. FT.

REMARKS 2/22/80 - SEE ATTACHED SHEET 7 4/9/80 NOT ready. J & SK  
4-9-80 - 1 TRENCH 12' DEEP. 52' LENGTH, OK TO add GRAVEL SK&JS  
4/10/80 OK to cover all work. J & SK

DATE SYSTEM APPROVED 4/10/80 INSPECTOR J. Stayer

5/24/85

# APPLICATION

A 35449

SEWAGE DISPOSAL TESTING

STATE OF MARYLAND - DEPARTMENT OF HEALTH AND MENTAL HYGIENE

P \_\_\_\_\_

HOWARD COUNTY HEALTH DEPARTMENT  
ENVIRONMENTAL HEALTH SERVICES

DISTRICT \_\_\_\_\_

P. O. BOX 476 ELLICOTT CITY, MARYLAND 21043  
TELEPHONE: 992-2330

DATE May 1, 1985

TO: THE COUNTY HEALTH OFFICER  
ELLICOTT CITY, MARYLAND

I, HEREBY, APPLY FOR THE NECESSARY TEST IN ORDER TO CONSTRUCT (OR RECONSTRUCT) A SEWAGE DISPOSAL SYSTEM.

PROPERTY OWNER Jonor Enterprises

ADDRESS 10236 Baltimore National Pike PHONE \_\_\_\_\_

PROPERTY LOCATION:

SUBDIVISION \_\_\_\_\_ LOT NO. 1 *Tax Map ~~24~~ Parcel 490*

ROAD AND DESCRIPTION North side Route 40 west of Pine Orchard Lane

SIZE OF LOT .854 acres TYPE BLDG. \_\_\_\_\_ (NUMBER OF BEDROOMS)

THE SYSTEM INSTALLED UNDER THIS APPLICATION IS ACCEPTABLE ONLY UNTIL PUBLIC FACILITIES BECOME AVAILABLE. I FULLY UNDERSTAND THE FEE CONNECTED WITH THE FILING OF THIS PERC TEST APPLICATION IS NON-REFUNDABLE UNDER ANY CIRCUMSTANCES. I ALSO AGREE TO COMPLY

WITH ALL M.O.S.H.A. REQUIREMENTS IN TESTING THIS LOT. /s/ Boender John Udoff  
(SIGNATURE OF APPLICANT)

APPROVED BY \_\_\_\_\_ FOR \_\_\_\_\_ DATE \_\_\_\_\_

REJECTED BY \_\_\_\_\_ FOR \_\_\_\_\_ DATE \_\_\_\_\_

HOLD PENDING FURTHER TESTS HOLD FOR EVALUATION PENDING SPECIFIC PROPOSAL DATE 9/30/85 CW

REASONS FOR REJECTION OR HOLDING 5-24-85; PERC. SATISFACTORY, HOLD FOR REVIEW PERC AREA UPGRADE FROM PROPOSED DWELLING SITE. SAME

SPECIFIC PLANS REQUIRED BEFORE CONSIDERATION CAN BE GIVEN FOR FURTHER DEVELOPMENT OF THIS PROPERTY, SEWERAL, SEPTIC SYSTEMS AND SHARED WATER SUPPLY COMPLICATE THIS PROPERTY 9/30/85 CW

# THIS IS NOT A PERMIT



52  
7  
364

JOAN V DUFF  
ENTERPRISE MOTORS  
10236 ROUTE 40

P 30524  
A REPAIR

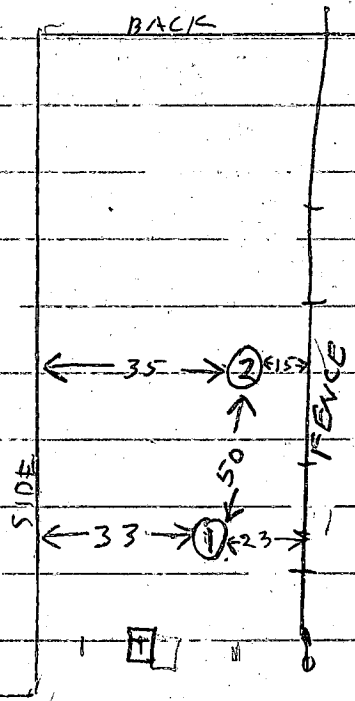

CAR LOT

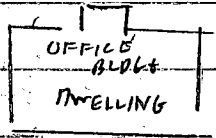

2 1/2 x 80	1 S	4	1003	1010	1010	1020	10
	IV	12 1/2	TOP 4 FT CLAYISH			DRY	
	2V	11 1/2	BOT 8 1/2 FT SANDY			DRY	
			TOP 3 FT CLAYISH				
			BOT 8 1/2 FT SANDY			DRY	

REMARKS BUSTY LEAKY METAL TANK [T] FOUND  
CITY WATER

CITY  
ALSO PRESENT DENNY MINIS  
DAVID SAPIE  
TEST BY R HODGES

October 1, 1985

Jonor Enterprises  
10236 Baltimore National Pike  
Ellicott City, Maryland 21043

RE: Percolation Testing  
Tax Map 24, Parcel 490  
Route 40

Dear Sirs:

Percolation testing conducted May 24, 1985 revealed satisfactory results. A plat from a registered engineer showing certified test hole locations should be submitted within sixty (60) days to allow field verification if necessary.

The property is already improved by several buildings that utilize well and septic systems. Space on this property is limited and approval for any additional projects will be granted only with due consideration to the requirements of the facilities already located on this property.

If you have any further questions relative to this matter, please call me at 461-9933.

Very truly yours,

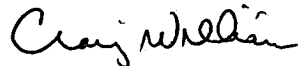

Craig Williams, Director  
Water and Sewerage Program

CW:JR