

8/15/79
1:30 PM

APPROVED
9/29/79
RH
P 30083
A Repair

PERMIT

SEWAGE DISPOSAL SYSTEM

MARYLAND STATE DEPARTMENT OF HEALTH

HOWARD COUNTY

05-355745

ELLICOTT CITY

DISTRICT _____

INDEXED

DATE 8/8/79

W. W. Jones

IS PERMITTED TO INSTALL

ALTER X

ADDRESS _____

PHONE _____

SUBDIVISION Holiday Hills

ROAD 10606 Hunting Lane

LOT

8

PROPERTY OWNER

W. W. Jones JOHN SZASZ

PHONE: 531-6571

ADDRESS

10606 Hunting Lane, Columbia, Md. 21044

SPECIFICATIONS

3 Bedrooms

SEPTIC TANK CAPACITY _____ GALLONS

DRAIN FIELD _____ DEPTH _____ FEET, BOTTOM AREA _____ SQ. FT.

DEEP TRENCH _____ DEPTH _____ FEET, BOTTOM AREA _____ SQ. FT.

SEEPAGE PITS _____ ABSORBENT SIDE-WALL AREA _____ SQ. FT.

INLET PIPE _____ FT. BELOW ORIGINAL GRADE, MAXIMUM DEPTH _____ FT. BELOW ORIGINAL GRADE

EFFECTIVE DEPTH AT _____ FT. BELOW ORIGINAL GRADE.

LOCATE DISPOSAL AREA _____ FT. FROM _____ LOT LINE AND _____ FT. FROM _____ LOT LINE AS SEEN WHEN

FACING LOT FROM

REPAIR-CALL FOR INSPECTION WHEN GROUND IS OPEN UP SO **S**ANITARIAN CAN RECOMMEND

REPAIR.

1 Dry Well 12' x 12'; located 2 1/2' below original

grade and maximum depth 10 1/2'; locate 39' off of property

septic tank. C.B. (Perc hole 142)

PLANS APPROVED BY

Palmer F. Wine

DATE 8/8/79

COVER NO WORK UNTIL INSPECTED AND APPROVED.

NEITHER THE HOWARD COUNTY COUNCIL NOR THE HEALTH DEPARTMENT IS RESPONSIBLE FOR THE SUCCESSFUL OPERATION OF ANY SYSTEM.

NOTE: IF TRENCH IS USED CALL FOR INSPECTION BEFORE PLACING GRAVEL IN TRENCH.

NOTE: NO DRY WELL SHALL EXCEED 15 FOOT IN DIAMETER.

NOTE: ALL PIPE FROM HOUSE TO DISPOSAL AREA MUST BE CAST IRON.

PERMIT VOID AFTER THREE YEARS.

NOTE: INSTALL STAND PIPE ON SEPTIC TANK AND DRY WELL. STAND PIPES MUST BE 6 INCHES IN DIAMETER. CAST IRON, CONCRETE OR TERRA COTTA ACCEPTED.

**BUILDING PERMIT SIGNED
AND RETURNED**

8/1/2002 800137789 INTERIOR ALTERATION

***INSTALLER IS RESPONSIBLE FOR OBTAINING FINAL APPROVAL ON THIS PERMIT.**

P 30083

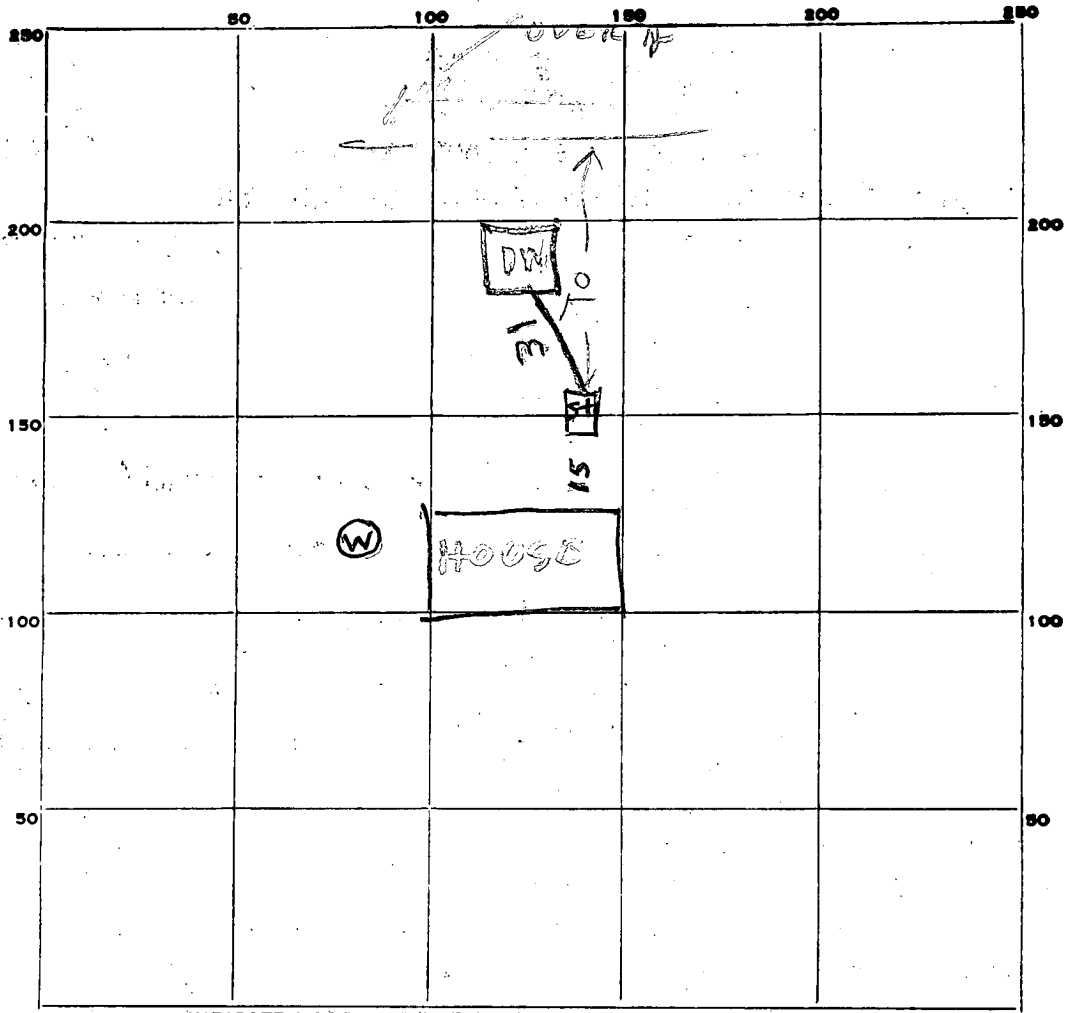

INDICATE NORTH. - NAME ADJOINING ROADWAY AS BASE LINE.

PERMIT CARD _____

SEPTIC TANK, LEVEL _____

CLEANOUTS _____

DISTRIBUTION BOX, LEVEL _____

TILE FIELD, DEPTH _____ FT. TRENCH WIDTH _____ FT.

GRAVEL DEPTH _____ IN. TOTAL LENGTH _____ FT.

NUMBER OF TRENCHES _____ TOTAL BOTTOM AREA _____

SEEPAGE PITS, INSIDE DIAMETER PERIMETER 51 FT. DEPTH BELOW INLET 8 FT.

ABSORBENT AREA 408 SQ. FT.

REMARKS ~~NO SHOW, TOLD MR JUNG'S TO RESCHEDULE~~
~~INSPECTION & TO HAVE 2 HOLES EACH 12" DIA DEEP 50 TO 75 FT~~
 PART DUG AT LEAST 75 FT FROM WELL RA
 9/28/79 - DW INLET 2 1/2 FT BELOW GRADE

DATE SYSTEM APPROVED 9/28/79 INSPECTOR Raymond Hodge

10606 Hunting Lane

Field sheet

SOIL PROFILE

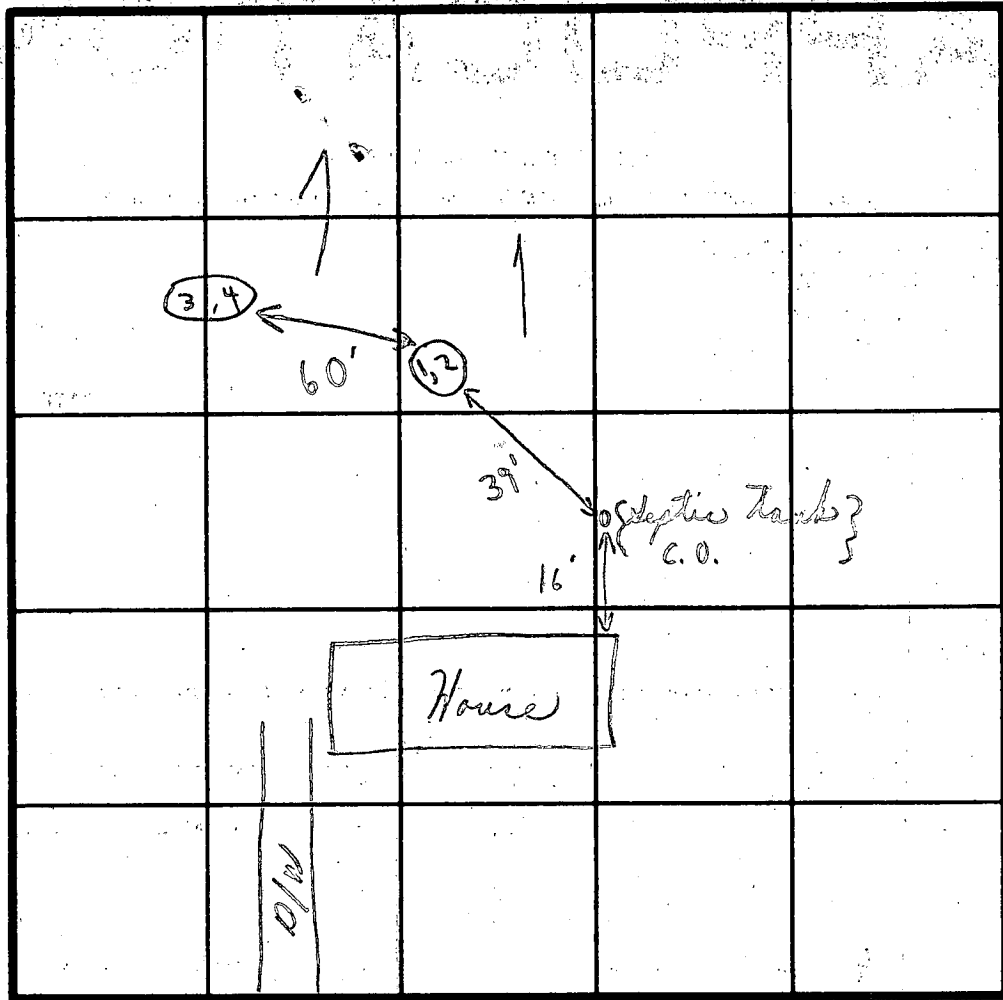
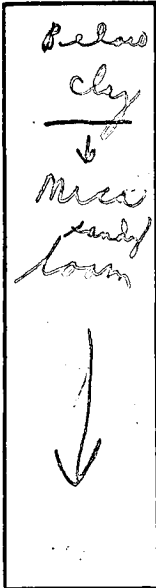

INDICATE NORTH - NAME ADJOINING ROADWAY AS BASE LINE.

Hunting Lane

DATE	TEST NO.	DEPTH	PRE-WET		TEST - 1" DROP		TIME	
			START	STOP	START	STOP		
8/22/99	1	2 1/2'	2:18	2:20	2:20	2:22	2m	
	2	13'	Same; silts @ 2 1/2'					
	3	3 1/2'	Sandy loam; ?					
	4	13'	Mica sandy loam similar to (1+2);					
							1 Day well	
							45' 2 1/2' - 10 1/2' Mat (12x12) depth	
			Recommend dry well 8' 3/4"					
			Write specs on yellow permit sheet.					
			(Have copy to Mr. Jones)					
								43
								36

1 - 2 1/2' clay
Sandy loam
2 1/2' - 13'

Hunting Lane

(3 Bedrooms per Mr. Jones)

REMARKS Existing houses } No holes dug - waited on }
 TYPE OF SOIL } Backhoe; 1.50 }
 TESTED BY C. B. A. }
 ALSO PRESENT } Mr. Jones }
 } Mr. Brighthouse }
 } present + 3 men }

B00137789

8/1/02 O.K. to enlarge existing bathroom
losing 1 bedroom (total of 2 currently)

