

10/28/80
10/29/80

Stephen Paul

PERMIT

P 31001
30956
A REPAIR

SEWAGE DISPOSAL SYSTEM

MARYLAND STATE DEPARTMENT OF HEALTH

HOWARD COUNTY

ELLICOTT CITY

DISTRICT 3rd.

DATE 10/23/80

INDEXED

03-285634

Robert L. Orndorff IS PERMITTED TO INSTALL X ALTER

ADDRESS 13938 Highland Road PHONE 596-9394

SUBDIVISION Driar Hill ROAD 3421 Blackberry Lane LOT 1

PROPERTY OWNER Jim Lawson

ADDRESS 3421 Blackberry Lane, Ellicott City, Md.

SPECIFICATIONS

SEPTIC TANK CAPACITY _____ GALLONS
DRAIN FIELD _____ DEPTH _____ FEET, BOTTOM AREA _____ SQ. FT.
DEEP TRENCH _____ DEPTH _____ FEET, BOTTOM AREA _____ SQ. FT.
SEEPAGE PITS _____ ABSORBENT SIDE-WALL AREA _____ SQ. FT.
INLET PIPE _____ FT. BELOW ORIGINAL GRADE. MAXIMUM DEPTH _____ FT. BELOW ORIGINAL GRADE
EFFECTIVE DEPTH AT _____ FT. BELOW ORIGINAL GRADE.

LOCATE DISPOSAL AREA _____ FT. FROM _____ LOT LINE AND _____ FT. FROM _____ LOT LINE AS SEEN WHEN

~~XXXXXXXXXXXXXXXXXXXX~~ TRENCHES - 3 trenches to be installed in the area under proposed rear half of tennis court. Each trench to be 2 ft. wide, 11 ft. deep with 8 ft. of gravel under distribution pipe. Trench inlets to be 3 ft. below original grade. Start the first trench roughly 155 ft. from the front lot line and 20 ft. from the right sideline. Continue to dig the trench on level ground. Start the second trench 16 ft. away from and parallel to the first trench at a point 172 ft. from the front lot line and 30 ft. from the right side line. Continue to dig the second trench on level ground. Start the third trench at a point 190 feet from the front lot line and 20 feet from the right side line. Continue to dig third trench on level ground. All directions are as seen when facing the property from Blackberry Lane. Install a distribution box and connect existing trench and all three new trenches to nearest end of trench. NOTE: All pipe between septic

PLANS APPROVED BY Frank Skinner DATE 10/9/80

COVER NO WORK UNTIL INSPECTED AND APPROVED.

NEITHER THE HOWARD COUNTY COUNCIL NOR THE HEALTH DEPARTMENT IS RESPONSIBLE FOR THE SUCCESSFUL OPERATION OF ANY SYSTEM.

NOTE: IF TRENCH IS USED CALL FOR INSPECTION BEFORE PLACING GRAVEL IN TRENCH.

NOTE: NO DRY WELL SHALL EXCEED 15 FOOT IN DIAMETER.

NOTE: ALL PIPE FROM HOUSE TO DISPOSAL AREA MUST BE CAST IRON.

PERMIT VOID AFTER THREE YEARS.

NOTE: INSTALL STAND PIPE ON SEPTIC TANK AND DRY WELL. STAND PIPES MUST BE 6 INCHES IN DIAMETER. CAST IRON, CONCRETE OR TERRAZO ACCEPTED.

*INSTALLER IS RESPONSIBLE FOR OBTAINING FINAL APPROVAL ON THIS PERMIT.

HD - 23 tank and beginning of trenches to be cast iron. NOTE: CALL FOR INSPECTION OF TRENCHES BEFORE AND AND AFTER GRAVEL IS INSTALLED IN TRENCHES.

BLDG. PERMIT SIGNED
AND RETURNED 10/30/80
Serial # 44911

A 30956 Repair

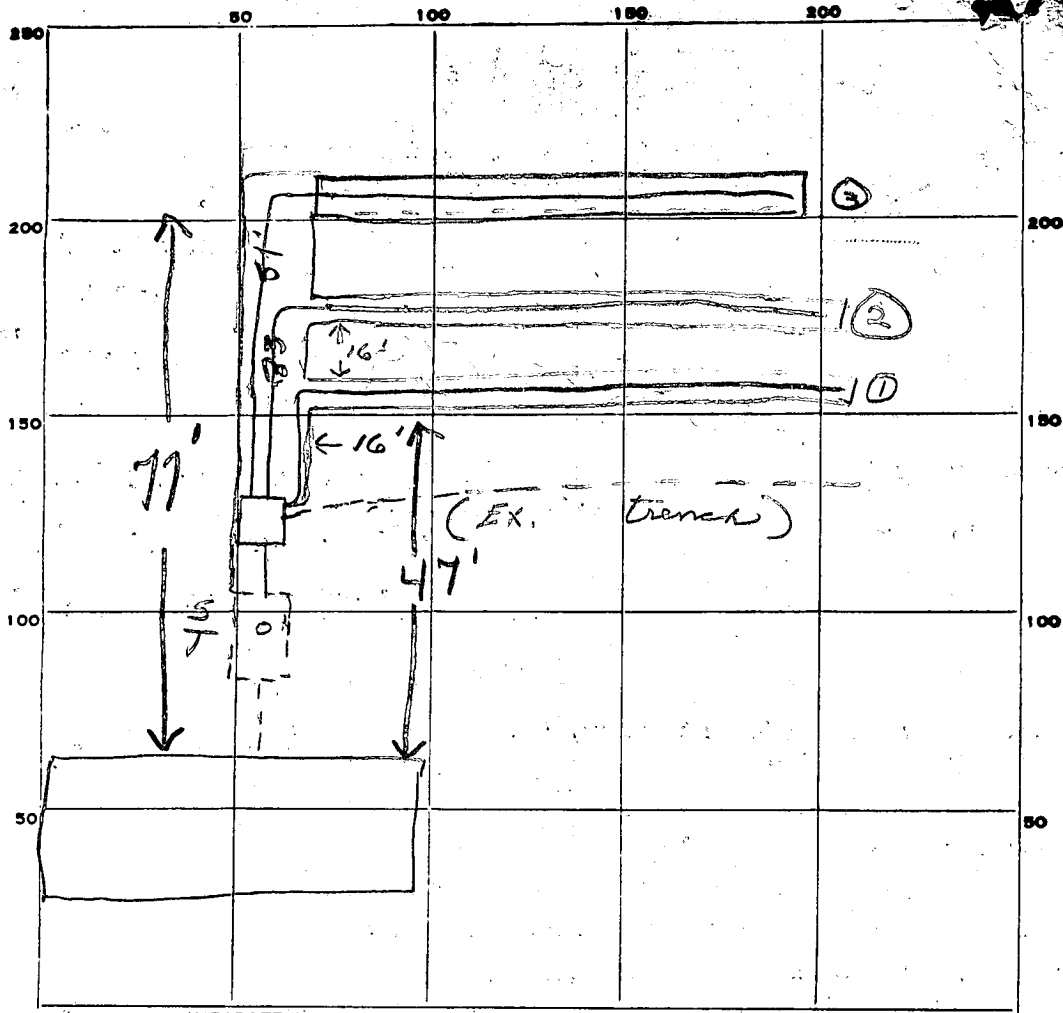

INDICATE NORTH. — NAME ADJOINING ROADWAY AS BASE LINE.

PERMIT CARD

SEPTIC TANK, LEVEL _____

CLEANOUTS _____

DISTRIBUTION BOX, LEVEL

TILE FIELD, DEPTH ①② 11 FT. TRENCH WIDTH 2 FT.

GRAVEL DEPTH ① 8' IN. TOTAL LENGTH ① 80' ② 70' ③ 73' = 223' Total

NUMBER OF TRENCHES ① ② ③ TOTAL SDGWA BOTTOM AREA 2,753 sq ft

SEEPAGE PITS, INSIDE DIAMETER _____ FT. DEPTH BELOW INLET _____ FT.

ABSORBENT AREA _____ SQ. FT.

REMARKS 10/28/80 OK to add gravel in #1 trench.

OK to cover work to #1 trench. 18

10/28/80 OK to cover #1 trench. OK to add gravel in #2 trench 18

10/29/80 OK to work Trench #2, OK to gravel Trench #3. 9C

10/29/80 OK to work all work.

DATE SYSTEM APPROVED 10/29/80

INSPECTOR Stephen G. Hall

Richard Knight

APPLICATION

SEWAGE DISPOSAL TESTING

A 30956

STATE OF MARYLAND - DEPARTMENT OF HEALTH AND MENTAL HYGIENE

P _____

HOWARD COUNTY HEALTH DEPARTMENT
ENVIRONMENTAL HEALTH SERVICES

P.O. BOX 476 ELLICOTT, MARYLAND 21043

TELEPHONE: 992-2330

3 trenches to be installed

in the area under proposed rear half of tennis court. Each trench to be 2 ft. wide 11 ft. deep with 8 ft. of gravel under distribution pipe. Trench sits to be 3 ft. below original grade. Start the first trench roughly 155 ft. from the front lot line and 20 ft. from the right sideline. Continue to dig the trench on level ground. Start the second trench 16 ft. away from and parallel to the first trench at a point 172 ft. from the front lot line and 20 ft. from the right side line. Continue to dig the second trench on level ground. Start the third trench at a point 190 ft. from the front lot line and 20 ft. from the right sideline. Continue to dig third trench on level ground. All directions are as seen when facing the property from Blackberry Lane. Install a distribution box and connect existing trench and all three new trenches to nearest end of trench. NOTE: All pipe between septic tank and beginning of trench to be cast iron.

DISTRICT 3rd
DATE 9/25/80

TO: THE COUNTY HEALTH OFFICER
ELLICOTT CITY, MARYLAND

I, HEREBY, APPLY FOR THE NECESSARY TEST IN ORDER TO CONSTRUCT (OR RECONSTRUCT) A SEWAGE DISPOSAL SYSTEM.

PROPERTY OWNER: Jim Lawson

ADDRESS: 3421 Blackberry Lane, Ellicott City, Md.

PHONE 997-9620

PROPERTY LOCATION:

NOTE: Call for inspection of trench(es) before gravel is installed in trench(es)

SUBDIVISION Briar Hill

LOT NO. 1

ROAD AND DESCRIPTION 3421 Blackberry Lane

Repercing to add additional area as part of reserve area is going to have tennis court placed over it.

SIZE OF LOT 1.41 acres

TYPE BLDG. 4 bedrooms (going to put in tennis court over reserve area).

THE SYSTEM INSTALLED UNDER THIS APPLICATION IS ACCEPTABLE ONLY UNTIL PUBLIC FACILITIES BECOME AVAILABLE.

I FULLY UNDERSTAND THE FEE CONNECTED WITH THE FILING OF THIS PERC TEST APPLICATION IS NON-REFUNDABLE UNDER ANY CIRCUMSTANCES.

SIGNATURE OF APPLICANT /s/ Richard Knight

APPROVED BY Frank Skinner FOR trenches

DATE 10/9/80

REJECTED BY _____ FOR _____ DATE _____

HOLD PENDING FURTHER TESTS _____ DATE _____

REASONS FOR REJECTION OR HOLDING _____

THIS IS NOT A PERMIT

①
SOIL PROFILE

0	Clay
2 1/2	Clay & Rock
3 1/2	Mottly Clay Some Mica Loam
7	Grey Mica Loam

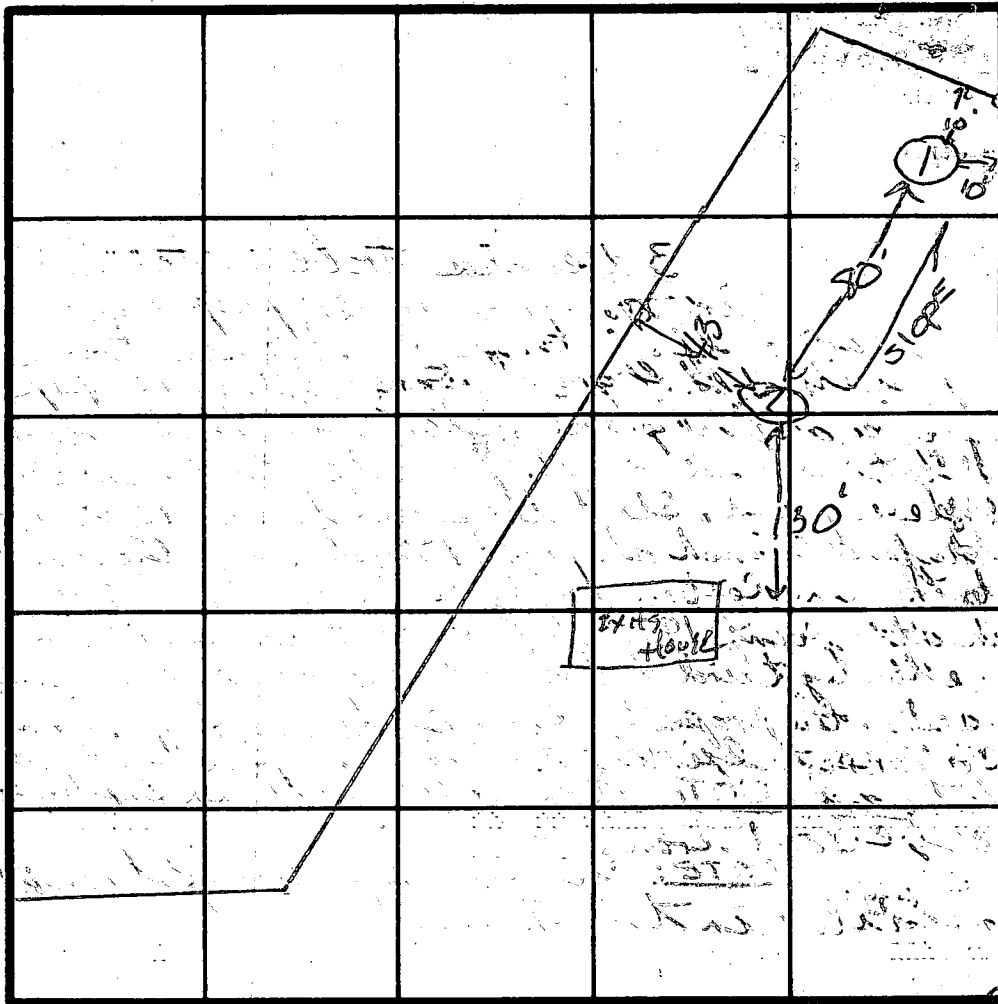

CORNER STAKED
Lot 1+2

INDICATE NORTH - NAME ADJOINING ROADWAY AS BASE LINE.

Blackberry Lane

CORNER STAKED
Lot 1+2

②

3	Clay
8	Redish Mica Loam
12 1/2	Grey Mica Loam

DATE	TEST NO.	DEPTH	PRE-WET		TEST - 1" DROP		TIME	
			START	STOP	START	STOP		
4-8-80	15	3'	2:11	2:26	2:26	XXXX	3/4"	Fail
	10	12'	2:17	2:19	2:19	2:29	10	
	25	3'	2:35	2:40	2:40	2:47	7	
	20	12 1/2'	2:37	2:38	2:38	2:40	2	
	1A5	4 1/2'	3:10	XX	XX	XY	3/4 in	Fail
	1A5	6'	3:40	XX	XX	XY	3/4 in	Fail

REMARKS _____

TYPE OF SOIL _____

TESTED BY SK 10/8/80

ALSO PRESENT BRIAN OF ORNDORFF
B. ORNDORFF

