

12/14/76 Partial

PERMIT

P 24826

SEWAGE DISPOSAL SYSTEM

A _____

MARYLAND STATE DEPARTMENT OF HEALTH

HOWARD COUNTY

ELLICOTT CITY

INDEXED

DISTRICT 4th

DATE 11/22/76

Arnold Septic Tank Service IS PERMITTED TO INSTALL ALTER _____

ADDRESS Woodbine, Maryland 21797 PHONE _____

A SEWAGE DISPOSAL-SYSTEM LOCATED AT _____

SUBDIVISION _____ ROAD Daisy Road LOT _____

PROPERTY OWNER Mrs. Byrd

ADDRESS Daisy Road, Woodbine, Md.

SPECIFICATIONS 3 bedrooms

DRAIN FIELD _____ DEPTH _____ FEET, BOTTOM AREA _____ SQ. FT.

SEEPAGE PITS _____ ABSORBENT SIDE-WALL AREA _____ SQ. FT.

SEPTIC TANK CAPACITY 1,000 GALLONS

FOR GARBAGE GRINDER, INCREASE DISPOSAL AREA 22% & TANK CAPACITY 50%.

OTHER TRENCH - To be ⁶⁶60 ft. long and ¹²13 ft. deep, with inlet at 2½ to 3 ft. Dig

Trench parallel to Daisy Road about 40 ft. from the edge of Daisy Road.

CALL FOR INSPECTION OF TRENCH BEFORE GRAVEL IS INSTALLED.

Connect trench in series with existing dry well.

INSTALL STANE PIPE ON EXISTING SEPTC TANK.

PLANS APPROVED BY Frank Skinner DATE 11/19/76

FILL SEPTIC TANK AND DISTRIBUTION BOX WITH WATER BEFORE CALLING FOR AN INSPECTION. COVER NO WORK UNTIL INSPECTED AND APPROVED.

NEITHER THE HOWARD COUNTY COMMISSIONERS NOR THE HEALTH DEPARTMENT IS RESPONSIBLE FOR THE SUCCESSFUL OPERATION OF ANY SYSTEM.

* P 24826

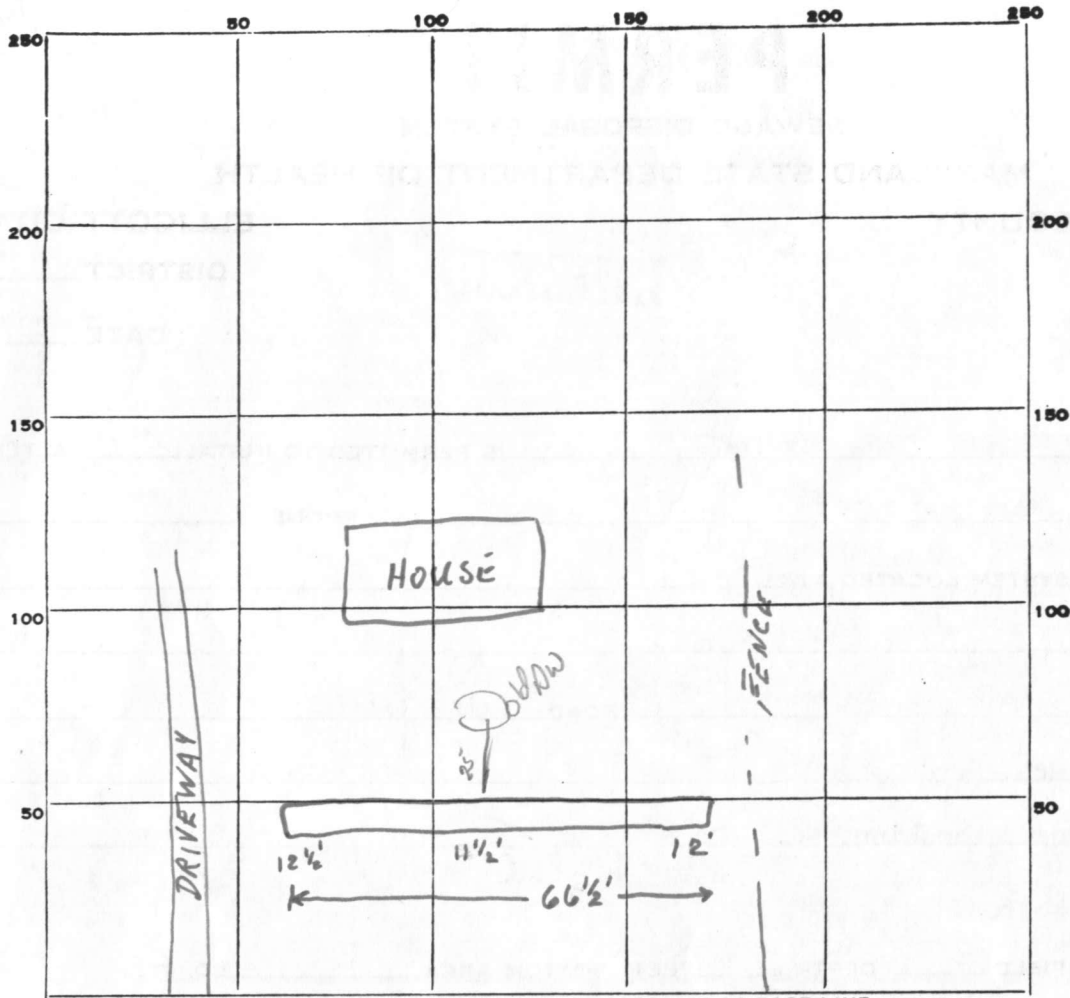

INDICATE NORTH. - NAME ADJOINING ROADWAY AS BASE LINE.

DAISY RD

PERMIT CARD 5444

SEPTIC TANK, LEVEL _____

CLEANOUTS _____

DISTRIBUTION BOX, LEVEL _____

TILE FIELD, DEPTH 12 FT. TRENCH WIDTH 2 FT.

GRAVEL DEPTH 10 ^{FT}/_{IN.} TOTAL LENGTH 66 1/2 FT.

NUMBER OF TRENCHES 1 TOTAL ^{SIDEWALL} BOTTOM AREA _____ (one side)

SEEPAGE PITS, INSIDE DIAMETER _____ FT. DEPTH BELOW INLET _____ FT.

ABSORBENT AREA _____ SQ. FT.

REMARKS 12/14/76 9:45 AM - Trench inpt - OK to install gravel. WWZ.
12/14/77 OK to go; 11, 1987 by phone told Arnod to uncover
septic cleanout ppd 4

DATE SYSTEM APPROVED 12/14/70

INSPECTOR ppd 4

APPLICATION

SEWAGE DISPOSAL TESTING

STATE OF MARYLAND - DEPARTMENT OF HEALTH AND MENTAL HYGIENE

HOWARD COUNTY HEALTH DEPARTMENT
ENVIRONMENTAL HEALTH SERVICES

P. O. BOX 476, ELLICOTT CITY, MARYLAND 21043
TELEPHONE: 465-5000, EXT. 356

DISTRICT 4th

DATE 11/15/76

Repair permit

*11/18/76
9:30 A.M.*

*Trench to be 60 ft long 13 ft. deep, with inlet at 2 1/2 to 3 ft.
Dig trench parallel to Daisy Road about 40 ft from the edge of Daisy Road.
Call for inspection of trench before gravel is installed. Connect trench
in series with existing drywell. Install stand pipe on existing
septic tank.*

TO: THE COUNTY HEALTH OFFICER
ELLICOTT CITY, MARYLAND

I, HEREBY, APPLY FOR THE NECESSARY TEST IN ORDER TO CONSTRUCT (OR RECONSTRUCT) A SEWAGE DISPOSAL SYSTEM.

PROPERTY OWNER Mrs. Byrd

ADDRESS Daisy Road, Woodbine, Md. PHONE Any questions call Bud Arnold: 795-1285

PROPERTY LOCATION:

SUBDIVISION _____ LOT NO. _____

ROAD AND DESCRIPTION Daisy Road - on left hand side just past Mullinix Motors

SIZE OF LOT ? TYPE BLDG. Existing House
NUMBER OF BEDROOMS _____

IF NOT SINGLE RESIDENCE DESCRIBE _____

THE SYSTEM INSTALLED UNDER THIS APPLICATION IS ACCEPTABLE ONLY UNTIL PUBLIC FACILITIES BECOME AVAILABLE.

SIGNATURE OF APPLICANT /s/ Bud Arnold

APPROVED BY Frank Skinner & D.W.M. FOR trench DATE 11/19/76
(KIND OF SYSTEM)

REJECTED BY _____ FOR _____ DATE _____
(KIND OF SYSTEM)

HOLD PENDING FURTHER TESTS _____ DATE _____

REASONS FOR REJECTION OR HOLDING _____

THIS IS NOT A PERMIT

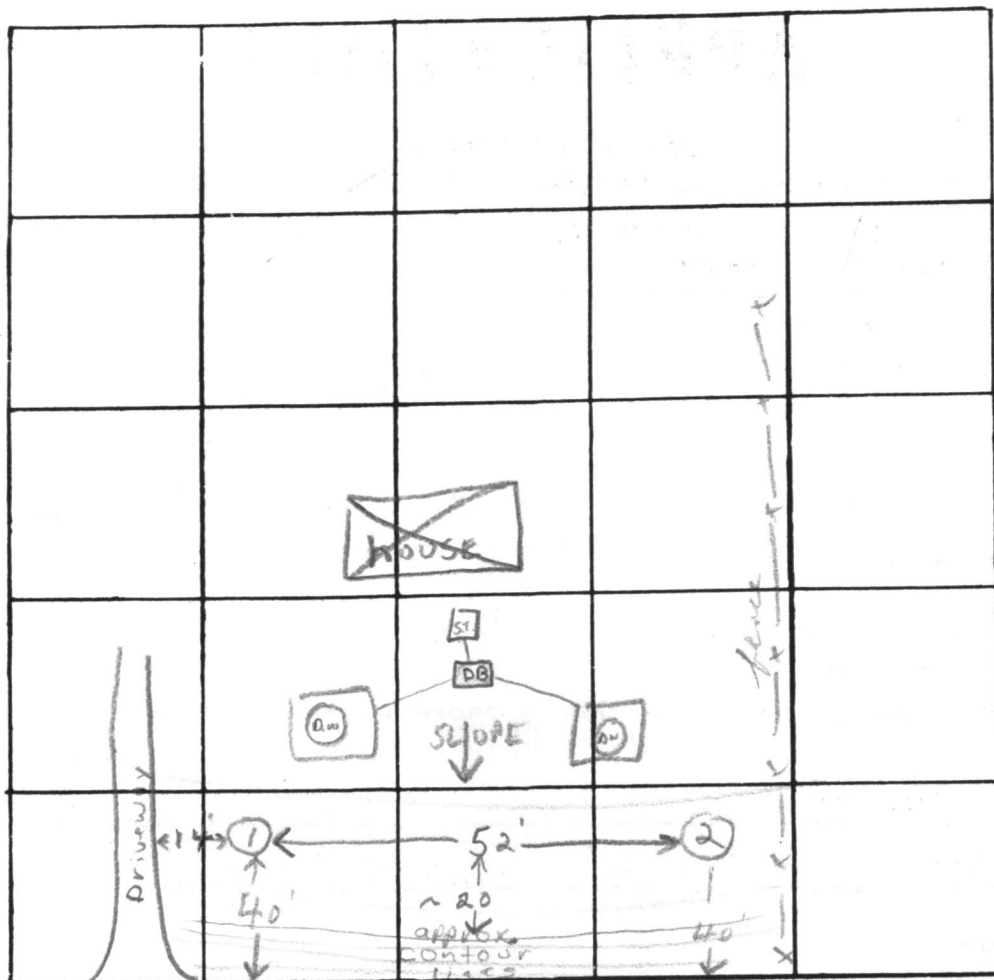
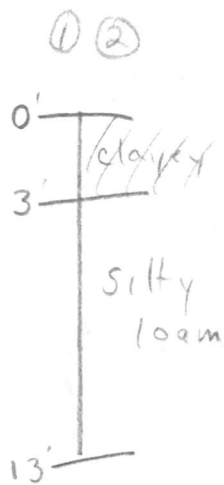

DATE	TEST NO.	DEPTH	PRE-WET		TEST - 1" DROP		TIME
			START	STOP	START	STOP	
11/18/76	1	4 1/2'	10:09	10:19	10:18	10:26	8 min
	1A	13'	10:09	10:25	10:25	10:46	21 min
	2	5'	10:09	10:11	10:11	10:16	5 min
	2A	13'	10:09	10:12	10:12	10:17	5 min
	1B	2'	10:11	10:51	10:51		pulled peg 1st ind. 40 min last
	2B	2 1/2'	10:10	10:27	10:27	10:50	23 min

REMARKS 60' trench & inlet at 2' max depth 13'

TYPE OF SOIL silty loam below top 3' clayey soil

TESTED BY F.S. ALSO PRESENT: Arnold