

10/18/76
1:30 P.M.
10/29/76
7:30

01-159526

PERMIT

File unapproved P 24001

SEWAGE DISPOSAL SYSTEM

A _____

MARYLAND STATE DEPARTMENT OF HEALTH

HOWARD COUNTY

ELLICOTT CITY

DISTRICT 1st

DATE 9/24/76

INDEXED

Jim Brittingham

IS PERMITTED TO INSTALL _____ ALTER

ADDRESS 3004 N. Rogers Avenue, Ellicott City, Md. PHONE 461-1870

A SEWAGE DISPOSAL SYSTEM LOCATED AT _____

SUBDIVISION _____ ROAD 6099 Duckett's Lane LOT _____

PROPERTY OWNER Mrs. M. L. Blackstone

ADDRESS 6099 Duckett's Lane, Elkridge, Md. Phone: 796-1092

SPECIFICATIONS

87
24
3
3

DRAIN FIELD _____ DEPTH _____ FEET, BOTTOM AREA _____ SQ. FT.

SEEPAGE PITS _____ ABSORBENT SIDE-WALL AREA _____ SQ. FT.

SEPTIC TANK CAPACITY _____ GALLONS

FOR GARBAGE GRINDER, INCREASE DISPOSAL AREA 22% & TANK CAPACITY 50%.

OTHER REPAIR - Call for inspection when ground is opened up so Sanitarian can recommend repair system.

PLANS APPROVED BY Palmer F. Wine DATE 8/24/76

FILL SEPTIC TANK AND DISTRIBUTION BOX WITH WATER BEFORE CALLING FOR AN INSPECTION. COVER NO WORK UNTIL INSPECTED AND APPROVED.

NEITHER THE HOWARD COUNTY COMMISSIONERS NOR THE HEALTH DEPARTMENT IS RESPONSIBLE FOR THE SUCCESSFUL OPERATION OF ANY SYSTEM.

2259M

P 24001

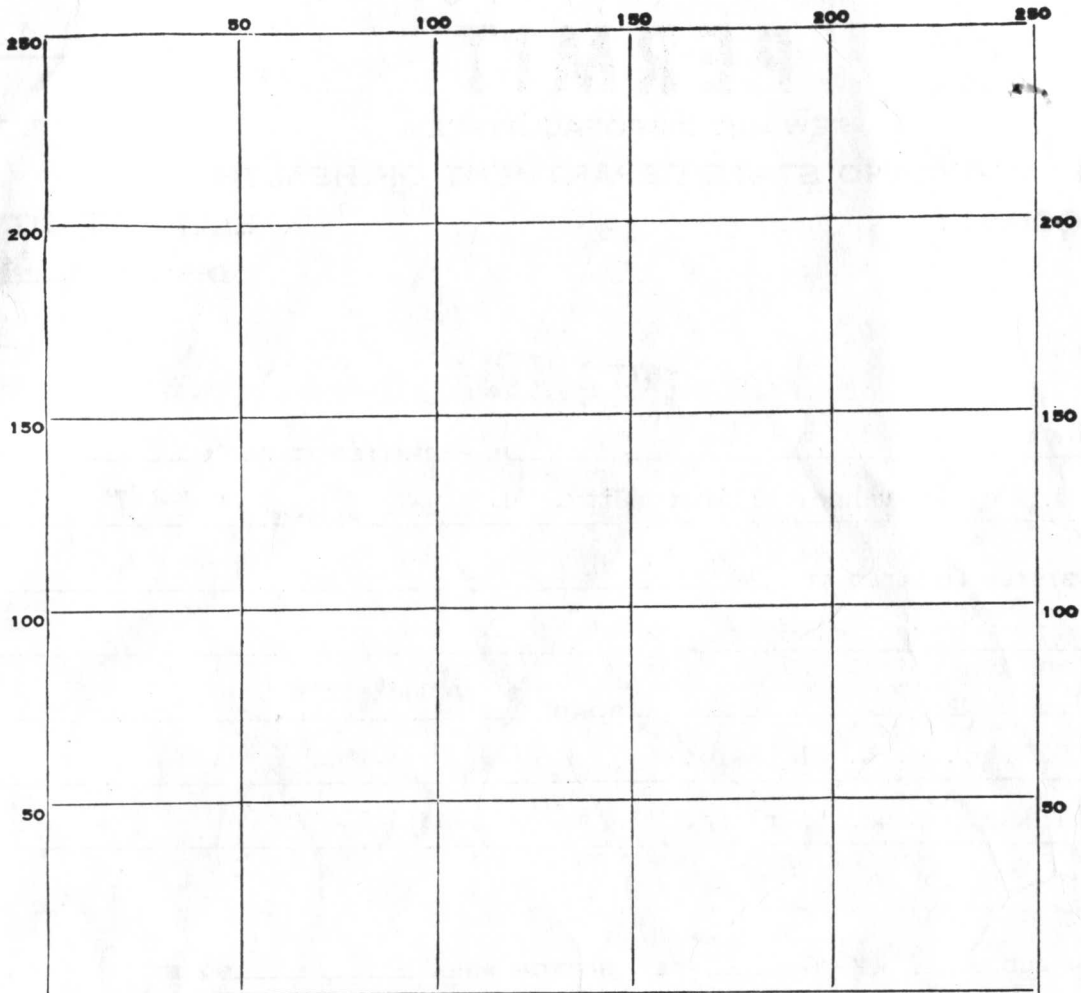

A234001

INDICATE NORTH. - NAME ADJOINING ROADWAY AS BASE LINE.

PERMIT CARD _____

SEPTIC TANK, LEVEL _____ CLEANOUTS _____

DISTRIBUTION BOX, LEVEL _____

TILE FIELD, DEPTH _____ FT. TRENCH WIDTH _____ FT.

GRAVEL DEPTH _____ IN. TOTAL LENGTH _____ FT.

NUMBER OF TRENCHES _____ TOTAL BOTTOM AREA _____

LEEPAGE PITS, INSIDE DIAMETER _____ FT. DEPTH BELOW INLET _____ FT.

ABSORBENT AREA _____ SQ. FT.

REMARKS 10/29/16 Hole ① - 8 ft deep UNDERGROUND WATER 6 FT ALL CLAY
 Hole ② - 3 ft deep UNDERGROUND WATER 3 FT ALL CLAY & TOPSOIL OLD PIPE
 BH decided soil unsatisfactory for septic systems & no need for extra
 holes since lot is small & almost level see attached drawing

DATE SYSTEM APPROVED _____ INSPECTOR _____

A234001

EL BLACKSTON
6099 DUCKETT LANE

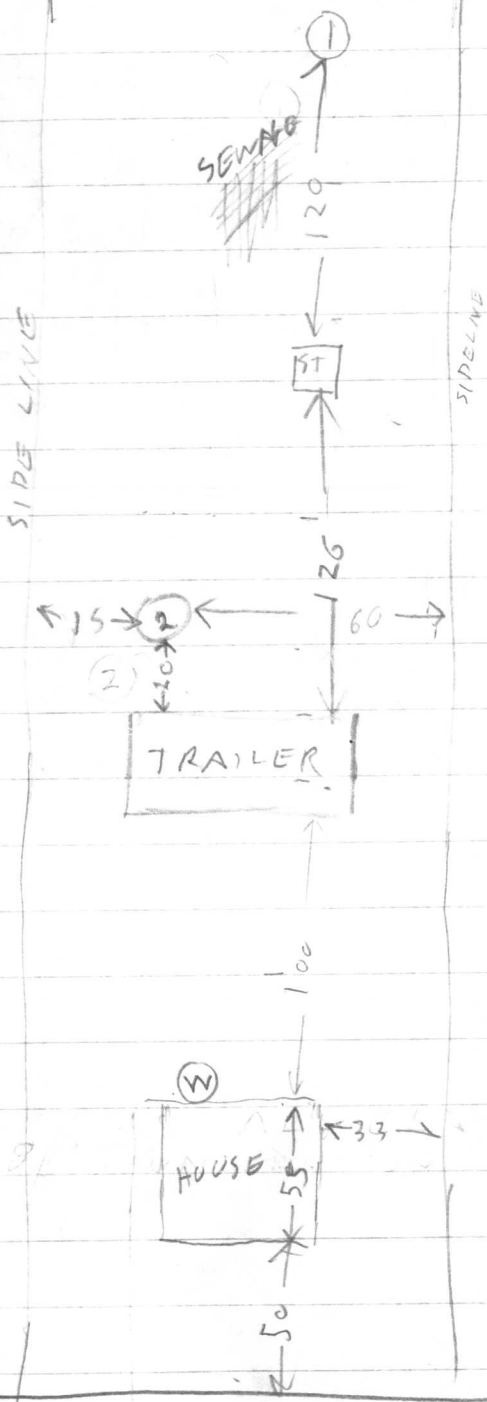

76

DUCKETT LANE

← TO BAUMAN DRIVE

House connected to city water Old well not used
 Lot is almost level slight slope to Rear Hole 1 Lower
 Skinner wrote order to Repair System Sept 10 1976 RH 10/29/76