

APP 12/28/78

12/28/78
12/28/78

PERMIT

P 29175

A 24862

SEWAGE DISPOSAL SYSTEM

MARYLAND STATE DEPARTMENT OF HEALTH*

HOWARD COUNTY

05-381916

ELLCOTT CITY

DISTRICT 5th

DATE 11/8/78

INDEXED

Paul Belschner IS PERMITTED TO INSTALL X ALTER

ADDRESS Catonsville, Md. PHONE 744-6182

SUBDIVISION Wesley Hills ROAD 7394 Minter Lane LOT 2

PROPERTY OWNER F.G. Marker

ADDRESS _____

SPECIFICATIONS 4 bedrooms

SEPTIC TANK CAPACITY 1250 GALLONS - manhole type cleanout to grade level.

DRAIN FIELD _____ DEPTH _____ FEET, BOTTOM AREA _____ SQ. FT.

DEEP TRENCH _____ DEPTH _____ FEET, BOTTOM AREA _____ SQ. FT.

SEEPAGE PITS _____ ABSORBENT SIDE-WALL AREA 120 SQ. FT. per bedroom

INLET PIPE 4 FT. BELOW ORIGINAL GRADE. MAXIMUM DEPTH 12 FT. BELOW ORIGINAL GRADE

EFFECTIVE DEPTH AT _____ FT. BELOW ORIGINAL GRADE.

LOCATE DISPOSAL AREA 80 FT. FROM front LOT LINE AND 32 FT. FROM right LOT LINE AS SEEN WHEN
FACING LOT FROM Rowley Road.

PLANS APPROVED BY Raymond Hodges DATE 10/13/77

COVER NO WORK UNTIL INSPECTED AND APPROVED.

NEITHER THE HOWARD COUNTY COUNCIL NOR THE HEALTH DEPARTMENT IS RESPONSIBLE FOR THE SUCCESSFUL OPERATION OF ANY SYSTEM.

NOTE: IF TRENCH IS USED CALL FOR INSPECTION BEFORE PLACING GRAVEL IN TRENCH.

NOTE: NO DRY WELL SHALL EXCEED 15 FOOT IN DIAMETER.

NOTE: ALL PIPE FROM HOUSE TO DISPOSAL AREA MUST BE CAST IRON.

PERMIT VOID AFTER THREE YEARS.

NOTE: INSTALL STAND PIPE ON SEPTIC TANK AND DRY WELL. STAND PIPES MUST BE 6 INCHES IN DIAMETER. CAST IRON, CONCRETE OR TERRA
COTTA ACCEPTED.

*INSTALLER IS RESPONSIBLE FOR OBTAINING FINAL APPROVAL ON THIS PERMIT.

A 24862

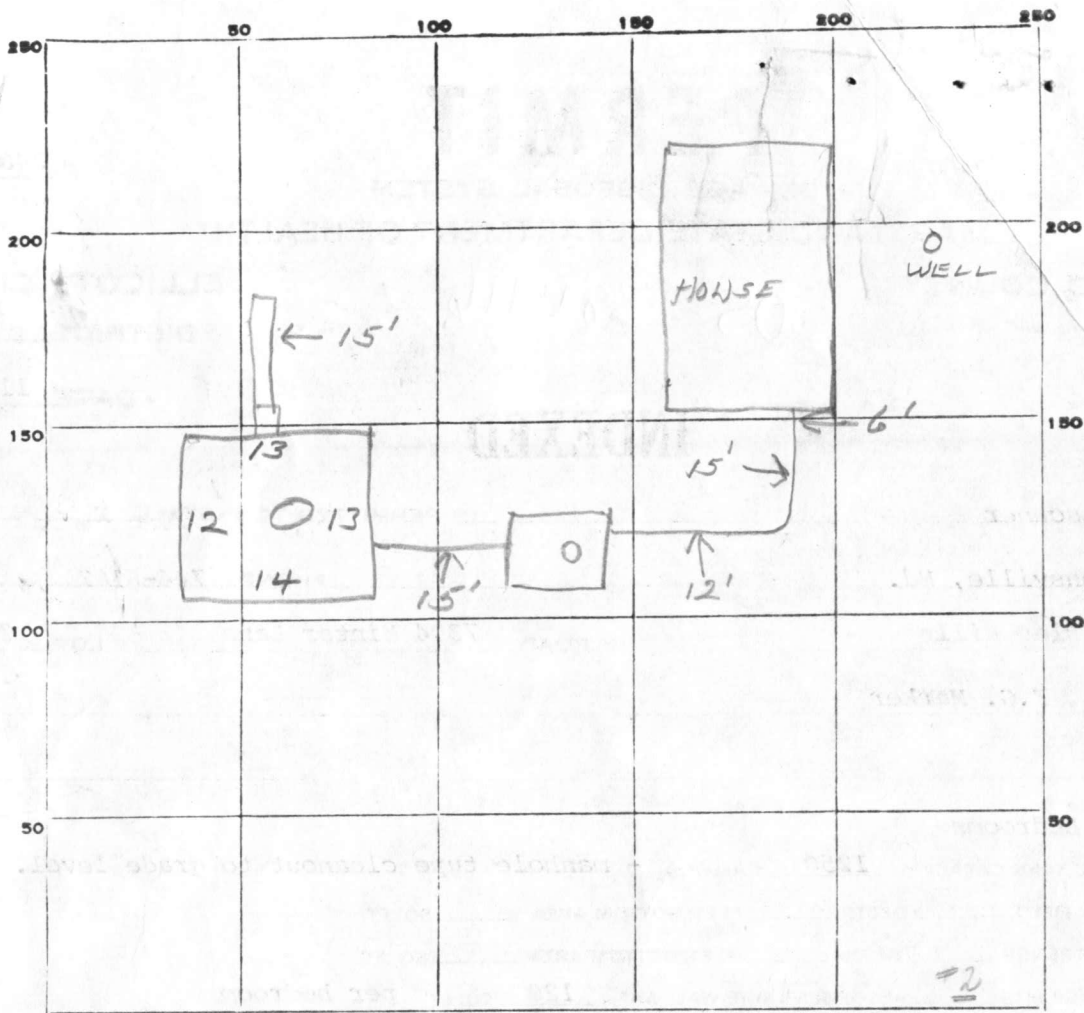

INDICATE NORTH. - NAME ADJOINING ROADWAY AS BASE LINE.

PERMIT CARD

SEPTIC TANK, LEVEL

CLEANOUTS

S.T. | D.W.
 |

DISTRIBUTION BOX, LEVEL

Trench
 TRENCH FIELD, DEPTH 12 FT. TRENCH WIDTH 2 FT.

GRAVEL DEPTH 7 IN. TOTAL LENGTH 15 FT.

NUMBER OF TRENCHES 1 TOTAL BOTTOM AREA _____

SEE PAGE PITS, INSIDE DIAMETER outside perimeter 32 FT. DEPTH BELOW INLET 8 FT.

ABSORBENT AREA 521 SQ. FT.

REMARKS ^{AM} 12/26/78 Not ready -
 12/28/78 - NEED CLEAN OUTS ON SEPTIC + DW - OK TO ADD GRAVEL
 TO TRENCH - JS. 12/28/78 - OK TO COVER WORK

480
 416
 105
 521

DATE SYSTEM APPROVED 12/28/78 INSPECTOR J. Stayer

APPLICATION

A 24862

SEWAGE DISPOSAL TESTING

P _____

STATE OF MARYLAND - DEPARTMENT OF HEALTH AND MENTAL HYGIENE

HOWARD COUNTY HEALTH DEPARTMENT
ENVIRONMENTAL HEALTH SERVICES
P. O. BOX 476, ELLICOTT CITY, MARYLAND 21043
TELEPHONE: 465-5000, EXT. 356

DISTRICT 5th

DATE 12/1/76

System plot

See attached sheet for Specs

TO: THE COUNTY HEALTH OFFICER
ELLICOTT CITY, MARYLAND

I, HEREBY, APPLY FOR THE NECESSARY TEST IN ORDER TO CONSTRUCT (OR RECONSTRUCT) A SEWAGE DISPOSAL SYSTEM.

PROPERTY OWNER Capital District Wesleyan Church

ADDRESS 10929 Pleasant Acres Drive, Hyattsville 20783 PHONE 559-2626

PROPERTY LOCATION:

SUBDIVISION Wesley Hills LOT NO. 2

ROAD AND DESCRIPTION Kraus Road

SIZE OF LOT 40,000 Sq. feet TYPE BLDG. 4
NUMBER OF BEDROOMS

IF NOT SINGLE RESIDENCE DESCRIBE _____

THE SYSTEM INSTALLED UNDER THIS APPLICATION IS ACCEPTABLE ONLY UNTIL PUBLIC FACILITIES BECOME AVAILABLE.

SIGNATURE OF APPLICANT /s/ James W. Kraus, President

APPROVED BY Raymond Hodge FOR Drywell DATE 10/13/77
(KIND OF SYSTEM)

REJECTED BY _____ FOR _____ DATE _____
(KIND OF SYSTEM)

HOLD PENDING FURTHER TESTS _____ DATE _____

REASONS FOR REJECTION OR HOLDING _____

THIS IS NOT A PERMIT

MINTER ↗
KRAUS RD

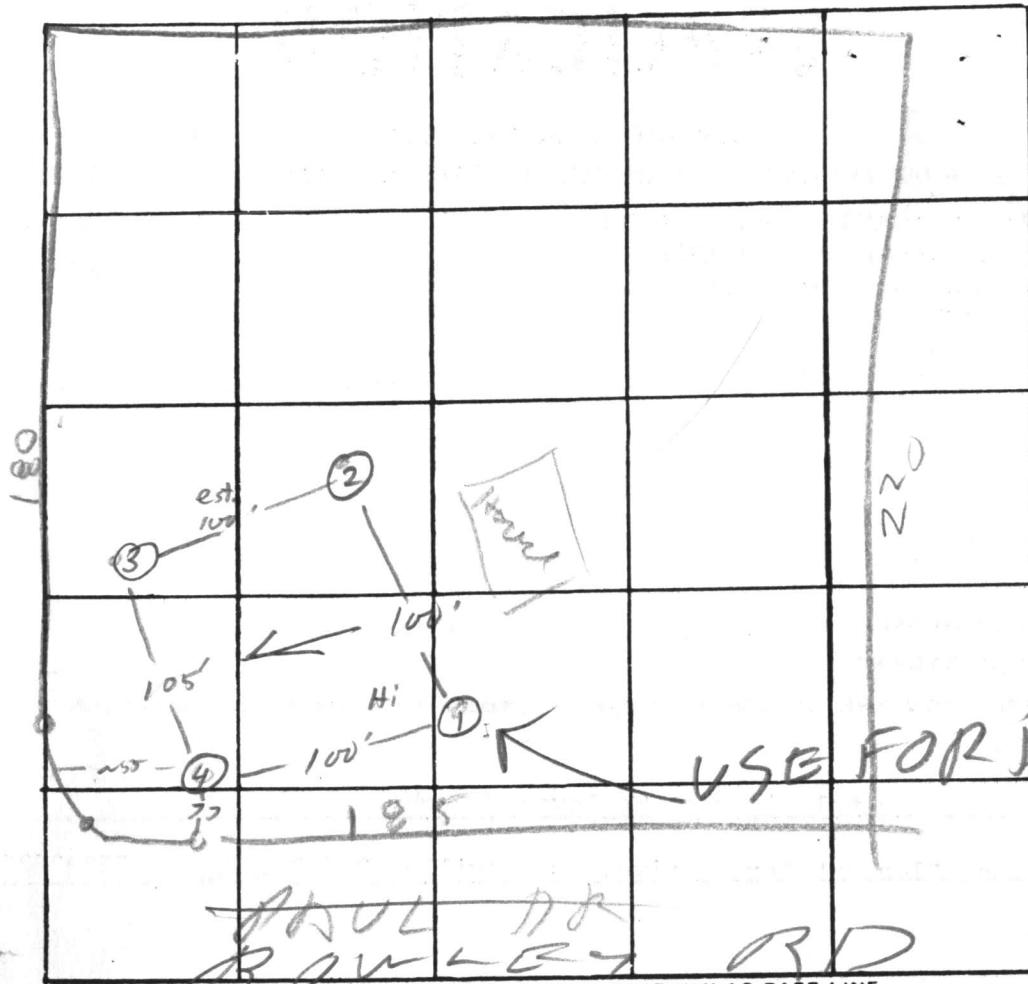

INDICATE NORTH. - NAME ADJOINING ROADWAY AS BASE LINE.

① 0
sandy loam
12½

④ 0
clay/loam
6
sandy loam
13½

③
0
clay/sand
5
sandy
12½

DATE	TEST NO.	DEPTH	PRE-WET		TEST - 1" DROP		TIME
			START	STOP	START	STOP	
12/15/76	1	4	12 ³⁸	12 ⁴¹	12 ⁴¹	12 ⁵⁰	9
	1A	12½	12 ³⁸	12 ⁴⁰	12 ⁴⁰	12 ⁴⁵	5
	2	12½	vis				
	3	5	1 ⁰¹	102	102	103	1
	3A	12½	1 ⁰¹	102	102	1 ⁰⁸	6
	4	6	12 ⁴¹	12 ⁴³	12 ⁴³	12 ⁴²	4
12/15/76	4A	13½	12 ⁴¹	12 ⁴⁶	12 ⁴⁶	12 ¹²	26
							57
							9

REMARKS _____

TYPE OF SOIL _____

TESTED BY BH RM ALSO PRESENT: Fryout

at time 9 Max Depth 5 1

Lot 2

C 1 **4859** SEQUENCE NO. (WRA USE ONLY)

1 2 3 (SEQ. NO.) 6
 (THIS NUMBER IS TO BE PUNCHED IN COLS. 3-6 ON ALL CARDS)

STATE OF MARYLAND
WATER RESOURCES ADMINISTRATION
 TAWES STATE OFFICE BLDG., ANNAPOLIS, MD. 21401
WELL COMPLETION REPORT

THIS REPORT MUST BE SUBMITTED WITHIN 30 DAYS AFTER WELL COMPLET

FILL IN THIS FORM COMPLETELY

COUNTY NUMBER

DATE RECEIVED (WRA USE ONLY) Oct 16, 1988 DEPTH OF WELL 165 PERMIT NO. FROM "PERMIT TO DRILL WELL" HO-73-3000

DATE WELL COMPLETED 15 20 22 (TO NEAREST FOOT) 26

8-13 DRILLERS IDENTIFICATION NO. 238

OWNER: Mark LAST NAME G. 1932 Co-Inv FIRST NAME

STREET OR RFD 5900 Princess Gardens Blvd POST OFFICE Tanham Md.

WELL DESCRIPTION

WELL LOG

STATE THE KIND OF FORMATIONS PENETRATED, THEIR COLOR, DEPTH, THICKNESS AND IF WATER BEARING

DESCRIPTION (USE ADDITIONAL SHEETS IF NECESSARY)	FEET		CHECK IF WATER BEARING
	FROM	TO	
<u>Sand</u>	<u>0</u>	<u>66</u>	
<u>Gray mica Rock</u>	<u>66</u>	<u>165</u>	

GROUTING RECORD YES NO

WELL HAS BEEN GROUTED (CIRCLE APPROPRIATE BOX) Y N

TYPE OF GROUTING MATERIAL (CIRCLE BOX):
 CEMENT C M BENTONITE CLAY B C

NO. OF BAGS 16 NO. OF POUNDS 1504

GALLONS OF WATER 96

DEPTH OF GROUT SEAL (TO NEAREST FOOT)

FROM 0 FT. TO 35 FT.
 (ENTER 0 IF FROM SURFACE)

CASING RECORD

CASING TYPES: INSERT APPROPRIATE CODE BELOW

STEEL S T CONCRETE C O
 PLASTIC P L OTHER O T

MAIN CASING TYPE S T NOMINAL DIAMETER TOP (MAIN) CASING (NEAREST INCH) 6 TOTAL DEPTH OF MAIN CASING (NEAREST FOOT) 70

OTHER CASING (IF USED)

DIAMETER (INCH) DEPTH (FEET) FROM TO

SCREEN RECORD

SCREEN TYPE OR OPEN HOLE: INSERT APPROPRIATE CODE BELOW

STEEL S T BRASS OR BRONZE B R OPEN HOLE H O
 PLASTIC P L OTHER O T

C 2 (SEQ. NO.)

DEPTH (NEAREST WHOLE FOOT) FROM TO

1 8 9 11 15 17 21

2 23 24 26 30 32 36

3 38 39 41 45 47 51

SLOT SIZE 1, 2, 3

DIAMETER OF SCREEN 56 60 (NEAREST INCH) FROM TO

GRAVEL PACK IF WELL DRILLED WAS A FLOWING WELL CIRCLE BOX 68 F

WRA USE ONLY (NOT TO BE FILLED IN BY DRILLER) (E.R.O.S.)

TELESCOPE CASING 70 LOG INDICATOR 72 OTHER DATA AVAILABLE 74 75 76

C 3 (SEQ. NO.)

PUMPING TEST

HOURS PUMPED (TO NEAREST HOUR) 2

PUMPING RATE (GALLONS PER MINUTE TO NEAREST GALLON) 12

METHOD USED TO MEASURE PUMPING RATE All

WATER LEVEL: (DISTANCE FROM LAND SURFACE)

BEFORE PUMPING 15 (NEAREST FOOT) 17 20

WHEN PUMPING 3 (NEAREST FOOT) 22 25

TYPE OF PUMPED USED (CIRCLE APPROPRIATE BOX) (FOR PUMPING TEST)

AIR A PISTON P TURBINE T
 CENTRIFUGAL C ROTARY R OTHER (DESCRIBE BELOW) O
 JET J SUBMERSIBLE S

PUMP INSTALLED

TYPE OF PUMP (WRITE APPROPRIATE LETTER IN BOX - SEE ABOVE: A, C, J, P, R, S, T, O) 29

DRILLER WILL INSTALL PUMP (CIRCLE APPROPRIATE BOX) YES NO

CAPACITY: GALLONS PER MINUTE (TO NEAREST GALLON) 31 35

PUMP HORSE POWER 37 41

PUMP COLUMN LENGTH (NEAREST FOOT) 43 47

CASING HEIGHT (CIRCLE APPROPRIATE BOX AND ENTER CASING HEIGHT)

ABOVE + BELOW - LAND SURFACE 2 (NEAREST FOOT) 49 50 51

LOCATION OF WELL ON LOT

SHOW PERMANENT STRUCTURE SUCH AS BUILDINGS, SEPTIC TANKS, AND/OR OTHER LAND MARKS AND INDICATE NOT LESS THAN TWO DISTANCES (MEASUREMENTS TO WELL).

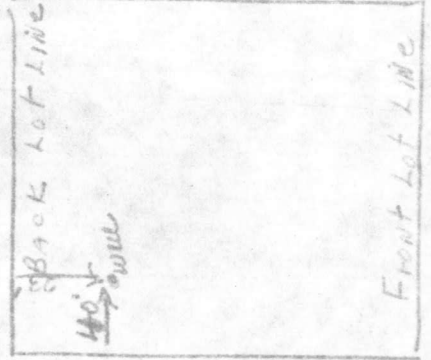

CIRCLE APPROPRIATE BOXES

A A WELL WAS ABANDONED AND SEALED WHEN THIS WELL WAS COMPLETED

E ELECTRIC LOG OBTAINED

P TEST WELL CONVERTED TO PRODUCTION WELL

I HEREBY CERTIFY THAT I HAVE COMPLIED WITH ALL CONDITIONS STATED ON THE ABOVE-CAPTIONED "PERMIT TO DRILL WELL", AND THAT INFORMATION CONTAINED IN THIS REPORT IS TRUE, ACCURATE, AND COMPLETE TO THE BEST OF MY KNOWLEDGE, INFORMATION AND BELIEF.

DRILLERS NAME Joseph L. Dwyer

(PLEASE PRINT) Joseph L. Dwyer

SIGNATURE Joseph L. Dwyer

RECEIVED

NOV 2 9 16 AM '78

HOWARD COUNTY
HEALTH DEPT.
ELLCOTT CITY, MD.

