

06-405843

# PERMIT

P 24760

SEWAGE DISPOSAL SYSTEM

A 24758

MARYLAND STATE DEPARTMENT OF HEALTH

HOWARD COUNTY

ELLICOTT CITY

DISTRICT 6th

## INDEX

DATE 11/16/76

Frank Robbins IS PERMITTED TO INSTALL  ALTER

ADDRESS \_\_\_\_\_ PHONE \_\_\_\_\_

A SEWAGE DISPOSAL SYSTEM LOCATED AT \_\_\_\_\_

SUBDIVISION \_\_\_\_\_ ROAD 10010 Gorman Road LOT \_\_\_\_\_

PROPERTY OWNER Harry Hearn Wincopia Farm

ADDRESS \_\_\_\_\_

SPECIFICATIONS 3 bedrooms

DRAIN FIELD \_\_\_\_\_ DEPTH \_\_\_\_\_ FEET, BOTTOM AREA \_\_\_\_\_ SQ. FT.

SEEPAGE PITS \_\_\_\_\_ ABSORBENT SIDE-WALL AREA \_\_\_\_\_ SQ. FT.

SEPTIC TANK CAPACITY 1000 GALLONS

FOR GARBAGE GRINDER, INCREASE DISPOSAL AREA 22% & TANK CAPACITY 50%.

OTHER LOCATE DRY WELL - 192 ft. from the last row of greenhouses (see sketches).

Dry well inlet at 2 ft. below grade with maximum depth of dry well at 11 ft.

below original grade. Dry well to have a total sidewall absorption area of 450 sq. ft.

NOTE: ALL PIPE FROM HOUSE TO DISPOSAL AREA MUST BE CAST IRON.  
PERMIT VOID AFTER THREE YEARS.

NOTE: INSTALL STAND PIPE ON SEPTIC TANK AND DRY WELL. STAND PIPES MUST BE 6 INCHES

PLANS APPROVED BY Mr. Frank Skinner DATE 11/16/76  
IN DIAMETER. CAST IRON, CONCRETE OR TERRA COTTA ACCEPTED.

FILL SEPTIC TANK AND DISTRIBUTION BOX WITH WATER BEFORE CALLING FOR AN INSPECTION. COVER NO WORK UNTIL INSPECTED AND APPROVED.

NEITHER THE HOWARD COUNTY COMMISSIONERS NOR THE HEALTH DEPARTMENT IS RESPONSIBLE FOR THE SUCCESSFUL OPERATION OF ANY SYSTEM.

A 24758

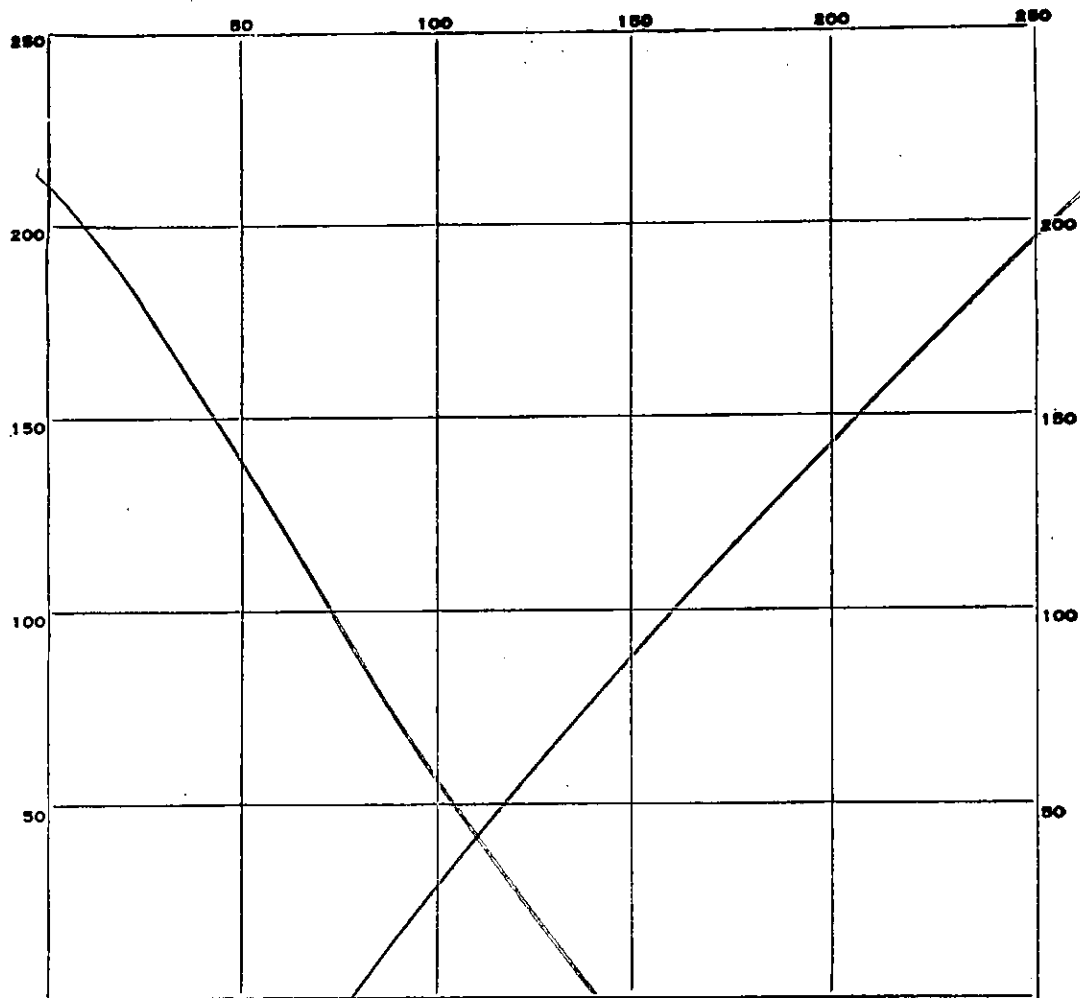

INDICATE NORTH. - NAME ADJOINING ROADWAY AS BASE LINE.

PERMIT CARD \_\_\_\_\_

SEPTIC TANK, LEVEL \_\_\_\_\_

CLEANOUTS \_\_\_\_\_

DISTRIBUTION BOX, LEVEL \_\_\_\_\_

TILE FIELD, DEPTH \_\_\_\_\_ FT. TRENCH WIDTH \_\_\_\_\_ FT.

GRAVEL DEPTH \_\_\_\_\_ IN. TOTAL LENGTH \_\_\_\_\_ FT.

NUMBER OF TRENCHES \_\_\_\_\_ TOTAL BOTTOM AREA \_\_\_\_\_

SEEPAGE PITS, INSIDE DIAMETER \_\_\_\_\_ FT. DEPTH BELOW INLET \_\_\_\_\_ FT.

ABSORBENT AREA \_\_\_\_\_ SQ. FT.

REMARKS \_\_\_\_\_

\_\_\_\_\_  
 \_\_\_\_\_  
 \_\_\_\_\_  
 \_\_\_\_\_  
 \_\_\_\_\_

DATE SYSTEM APPROVED \_\_\_\_\_

INSPECTOR \_\_\_\_\_

# APPLICATION

A 24758

## SEWAGE DISPOSAL TESTING

P \_\_\_\_\_

STATE OF MARYLAND - DEPARTMENT OF HEALTH AND MENTAL HYGIENE

HOWARD COUNTY HEALTH DEPARTMENT  
ENVIRONMENTAL HEALTH SERVICES

DISTRICT 6th

P. O. BOX 476, ELLICOTT CITY, MARYLAND 21043  
TELEPHONE: 465-5000, EXT. 356

DATE 11/16/76

1000 gal. septic tank

Locate drywell 192 ft from the last row of greenhouses (see sketch)  
Drywell inlet at 2 ft. below grade with maximum depth of  
drywell at 11 ft below grade. Drywell to have a total sidewall  
absorption area of 450 SQ. FT.

TO: THE COUNTY HEALTH OFFICER  
ELLICOTT CITY, MARYLAND

I, HEREBY, APPLY FOR THE NECESSARY TEST IN ORDER TO CONSTRUCT (OR RECONSTRUCT) A SEWAGE DISPOSAL SYSTEM.

PROPERTY OWNER Harry Heavn Wincopia Farm

ADDRESS Gorman Road PHONE \_\_\_\_\_

PROPERTY LOCATION:

SUBDIVISION \_\_\_\_\_ LOT NO. \_\_\_\_\_

ROAD AND DESCRIPTION Gorman Road

SIZE OF LOT \_\_\_\_\_ TYPE BLDG. possible office trailer  
NUMBER OF BEDROOMS \_\_\_\_\_

IF NOT SINGLE RESIDENCE DESCRIBE \_\_\_\_\_

THE SYSTEM INSTALLED UNDER THIS APPLICATION IS ACCEPTABLE ONLY UNTIL PUBLIC FACILITIES BECOME AVAILABLE.

SIGNATURE OF APPLICANT \_\_\_\_\_

APPROVED BY Frank Skinner FOR Drywell DATE 11/16/76  
(KIND OF SYSTEM)

REJECTED BY \_\_\_\_\_ FOR \_\_\_\_\_ DATE \_\_\_\_\_  
(KIND OF SYSTEM)

HOLD PENDING FURTHER TESTS \_\_\_\_\_ DATE \_\_\_\_\_

REASONS FOR REJECTION OR HOLDING \_\_\_\_\_

# THIS IS NOT A PERMIT

0  
clayey  
2  
Sandy mica loam  
12 1/2  
hard packed in dept 13 of pit

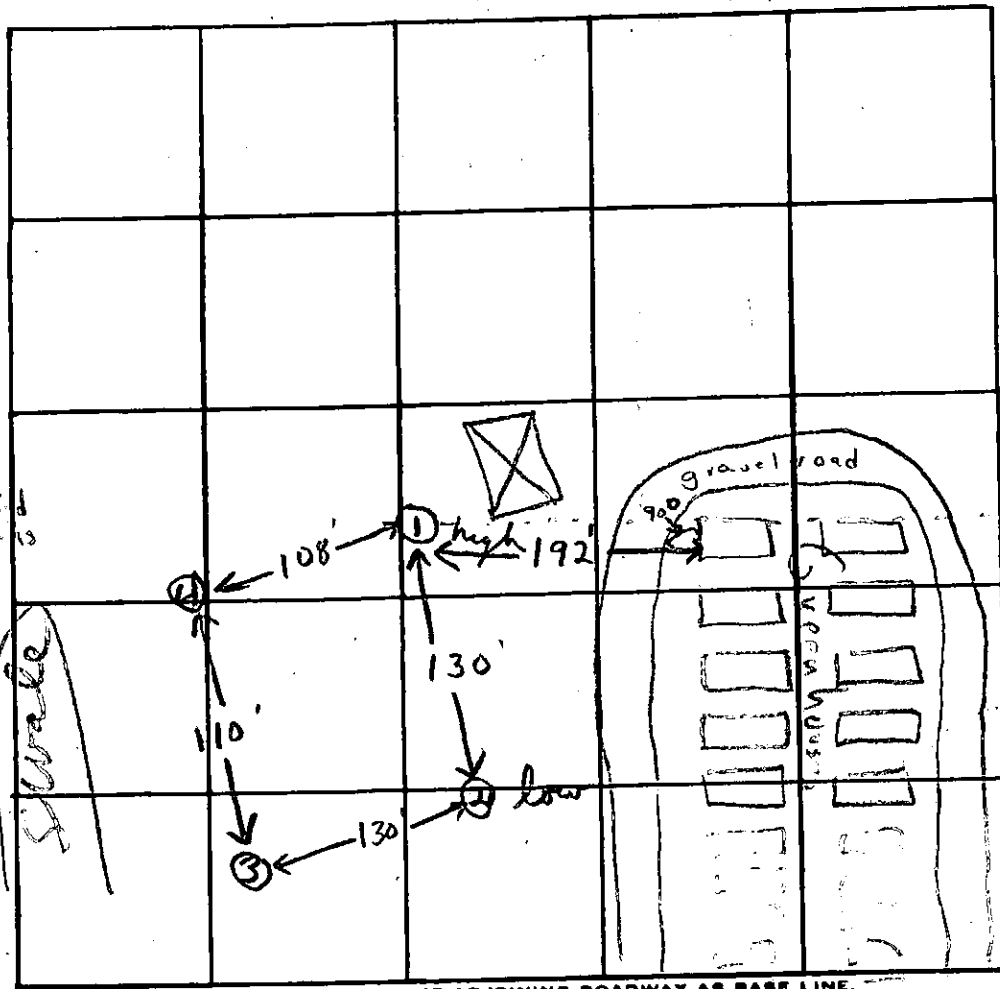

INDICATE NORTH. - NAME ADJOINING ROADWAY AS BASE LINE.

DATE	TEST NO.	DEPTH	PRE-WET		TEST - 1" DROP		TIME	
			START	STOP	START	STOP		
8/17/76	1 high	3 1/2'	3:35	3:37	3:37	3:40	3 min	
	1A	12 1/2'	3:33	3:38	3:38	3:45	7 min	
	2 low	4'	3:59	4:02	4:02	4:05	2 min	
	2A	11'	3:56	4:14	4:14	4:38	24 min	
	3	12'	clayey to 2' sandy mica loam below					
	4	11 1/2'	clayey to 2' sandy mica loam below					

REMARKS

TYPE OF SOIL

clayey 1-3', sand & sand, loam below

TESTED BY

F.S.

ALSO PRESENT:

H. Heath