

8/5/88 UAM

03-313085

# PERMIT

SEWAGE DISPOSAL SYSTEM

MARYLAND STATE DEPARTMENT OF HEALTH

**HOWARD COUNTY**  
BUREAU OF ENVIRONMENTAL HEALTH  
461-9933

## INDEXED

{ I.C.O.P.  
Time expired }

P 42164

A 37993

DISTRICT 3rd

DATE 7/21/89

DATE SYSTEM APPROVED 8-5-88

INSPECTOR JEN

Dave Hopkins & Son IS PERMITTED TO INSTALL X ALTER

ADDRESS 17550 Old Frederick Road, Mt. Airy, Maryland 21771 PHONE 831-7257

SUBDIVISION Mathis Property ROAD 12465 Barnard Way LOT 21

PROPERTY OWNER Ronald Broderick  
~~Barnard Bros. Construction Co., Inc.~~

ADDRESS \_\_\_\_\_

IF GARBAGE GRINDER IS USED INCREASE SEPTIC TANK CAPACITY BY 50% AND ABSORPTION AREA BY 22%.

GARBAGE GRINDER? YES \_\_\_\_\_ NO X

SEPTIC TANK CAPACITY 1000 GALLONS NUMBER OF BEDROOMS 3

<sup>180</sup>/<sub>3</sub>  
5(540)  
108 ft

TRENCHES - 180 sq. ft. per bedroom. Trench to be 2 feet wide. Inlet 4 feet below original grade. Bottom maximum depth 9 feet below original grade. Effective area begins at 4 feet below original grade. 5 feet of stone below distribution pipe.

LOCATION - Start the first trench 190 feet from the front lot line and 110 feet from the right lot line. Run trenches along contour toward right-rear part of property.

NOTE - No trench to exceed 100 feet in length. Provide 6" - 8" diameter cleanout and cap to grade or above on septic tank. Oklw

PLANS APPROVED BY C. Williams DATE 5/13/88

- COVER NO WORK UNTIL INSPECTED AND APPROVED.
- NEITHER THE HOWARD COUNTY COUNCIL NOR THE HEALTH DEPARTMENT IS RESPONSIBLE FOR THE SUCCESSFUL OPERATION OF ANY SYSTEM.
- NOTE: CLEANOUT REQUIRED EVERY 70 FEET OF SEWER LINE AND/OR AT 90° SWEEPS IN LINES FROM HOUSE TO DRAIN FIELDS.
- NOTE: ALL PARTS OF SEPTIC SYSTEMS (I.E., TANK, DISTRIBUTION BOX, TRENCHES) TO BE 100 FEET FROM WELL. (UNLESS OTHERWISE SPECIFICALLY AUTHORIZED)
- NOTE: IF DEEP TRENCH(ES) ARE USED CALL FOR INSPECTION BEFORE AND AFTER PLACING GRAVEL IN TRENCH(ES).
- NOTE: NO DRY WELL SHALL EXCEED 15 FOOT IN DIAMETER. NO ABSORPTION TRENCH TO EXCEED 100 FEET IN LENGTH.
- NOTE: ALL PIPE FROM HOUSE TO SEPTIC TANK MUST BE CAST IRON OR SCHEDULE 40 PVC OR ABS.
- PERMIT VOID AFTER TWO YEARS.
- NOTE: INSTALL STAND PIPE ON SEPTIC TANK AND DRY WELL. STAND PIPES MUST BE 6 INCHES IN DIAMETER. CAST IRON, CONCRETE OR TERRA COTTA OR PVC OR ABS ACCEPTED. IF TOP OF SEPTIC TANK IS DEEPER THAN 3 FEET, MANHOLE TO GRADE REQUIRED.
- NOTE: DISTRIBUTION BOXES MUST HAVE BAFFLES.

BLDG. PERMIT SIGNED  
AND RETURNED 11/26/91  
Serial # 40467 - detached  
BLDG. PERMIT SIGNED  
AND RETURNED 7/12/90  
Serial # 33997 - check

37993

**\*INSTALLER IS RESPONSIBLE FOR OBTAINING FINAL APPROVAL ON THIS PERMIT**

\*CALL 461-9933 FOR INSPECTION OF SEPTIC SYSTEMS.

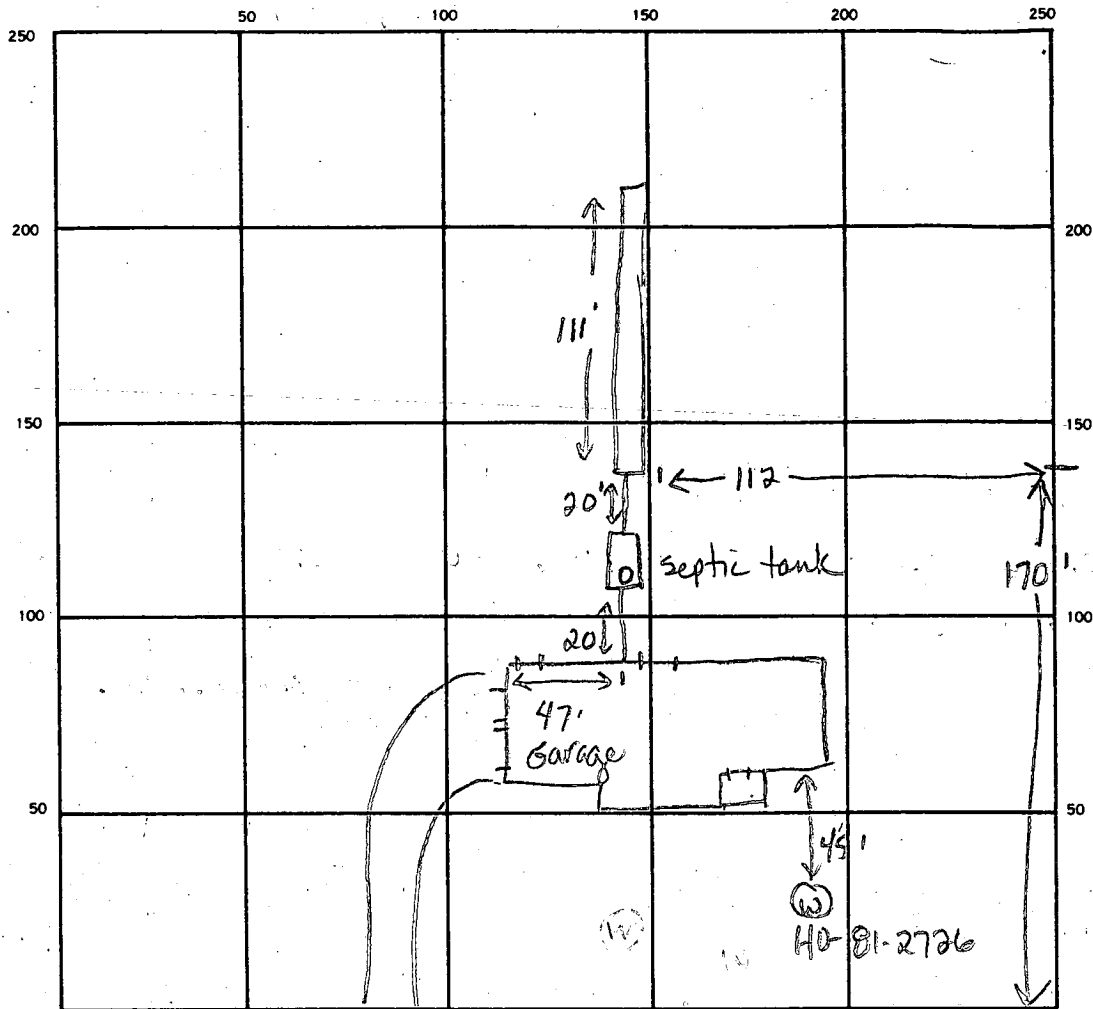

70  
2.4  
280

547.  
2.4  
188  
948  
112  
19  
2.6  
76  
38  
45

INDICATE NORTH. — NAME ADJOINING ROADWAY AS BASE LINE.

Barnard Way

SEPTIC TANK. LEVEL 1250 gpl CLEANOUTS 1 on septic tank

DISTRIBUTION BOX. LEVEL not applicable (only one trench)

DRAIN FIELD/TILE FIELD. DEPTH 9 FT. TRENCH WIDTH 2 FT. INLET DEPTH 4 FT.

EFFECTIVE GRAVEL DEPTH 5 FT. TOTAL LENGTH 111 FT.

NUMBER OF TRENCHES 1 ONE SIDEWALL/BOTTOM AREA 555 SQ. FT.

DRYWELL INSIDE DIAMETER \_\_\_\_\_ FT. EFFECTIVE DEPTH BELOW INLET \_\_\_\_\_ FT.

ABSORBENT AREA 555 SQ. FT.

REMARKS 8-5-88 OK to stone, trench and add pipe, & paper JEN  
8-5-88 OK to cover all work, JEN

DATE SYSTEM APPROVED 8-5-88 INSPECTOR Jane E. Wade

32

LAND TO BE DEDICATED TO PUBLIC USE FOR THE PURPOSE OF A PUBLIC ROAD  
49,000 ± OR 1.125 Ac. ±

R. W. TENNANT  
655 281

CgB2

M1D2

CgC2

LOT 4  
30 Ac. ±

LOT 13  
3.00 Ac. ±

ChC2

LOT 17  
30 Ac. ±

BARNARD WAY

LOT 18  
3.0 Ac. ±

ChB2

ChB2

LOT 21  
30.5 Ac. ±

PROPOSED

BARNARD WAY

RECREATION FIELDS  
WEST FRIENDSHIP SCHOOL  
ELEMENTARY

ZONE CONFORMING TO STANDARDS FOR SEDIMENT

2,133,095 ± OR 48,969 Ac. ±

IC

49,000 ± OR 1.125 Ac. ±

DIVISION: 2,182,095 ± OR 50,094 Ac. ±

N/E  
THE BOARD OF ED.  
HOWARD COUNTY  
L 706