

8/22/68

*JTS*

# PERMIT

P 13807

SEWAGE DISPOSAL SYSTEM

A \_\_\_\_\_

MARYLAND STATE DEPARTMENT OF HEALTH

HOWARD COUNTY

ELLICOTT CITY

**INDEXED**

DISTRICT 3

DATE 8-3-68

John E. Neal

IS PERMITTED TO INSTALL  ALTER

ADDRESS Marriottsville, Md.

PHONE 328-12 2412

A SEWAGE DISPOSAL SYSTEM LOCATED AT 1205 Driver Road - Marriottsville, Md.

*1/2 mile off Marriottsville Rd.  
along the farm  
(Newer house)*

SUBDIVISION \_\_\_\_\_ ROAD (Newer house) LOT \_\_\_\_\_

PROPERTY OWNER Herbert Steiner

ADDRESS Driver Rd. - Marriottsville, Md.

SPECIFICATIONS 2 - Bedrooms

DRAIN FIELD \_\_\_\_\_ DEPTH \_\_\_\_\_ FEET, BOTTOM AREA \_\_\_\_\_ SQ. FT.

SEEPAGE PITS \_\_\_\_\_ ABSORBENT SIDE-WALL AREA \_\_\_\_\_ SQ. FT.

SEPTIC TANK CAPACITY 750 GALLONS

FOR GARBAGE GRINDER, INCREASE DISPOSAL AREA 22% & TANK CAPACITY 50%.

OTHER Dry Well or Tile Field -- Minumum 300 sq. ft.

*Miss*

Permit void after three years.

PLANS APPROVED BY P. Wine DATE 8-2-68

FILL SEPTIC TANK AND DISTRIBUTION BOX WITH WATER BEFORE CALLING FOR AN INSPECTION. COVER NO WORK UNTIL INSPECTED AND APPROVED.

NEITHER THE HOWARD COUNTY COMMISSIONERS NOR THE HEALTH DEPARTMENT IS RESPONSIBLE FOR THE SUCCESSFUL OPERATION OF ANY SYSTEM.

## NOTIFY THE HEALTH DEPARTMENT 48 HOURS BEFORE EXCAVATIONS ARE TO BE BACK FILLED.

*13807*

$$\begin{array}{r} 17 \\ 3 \\ \hline 51 \\ 3 \\ \hline 153 \\ 3 \\ \hline 359 \end{array}$$

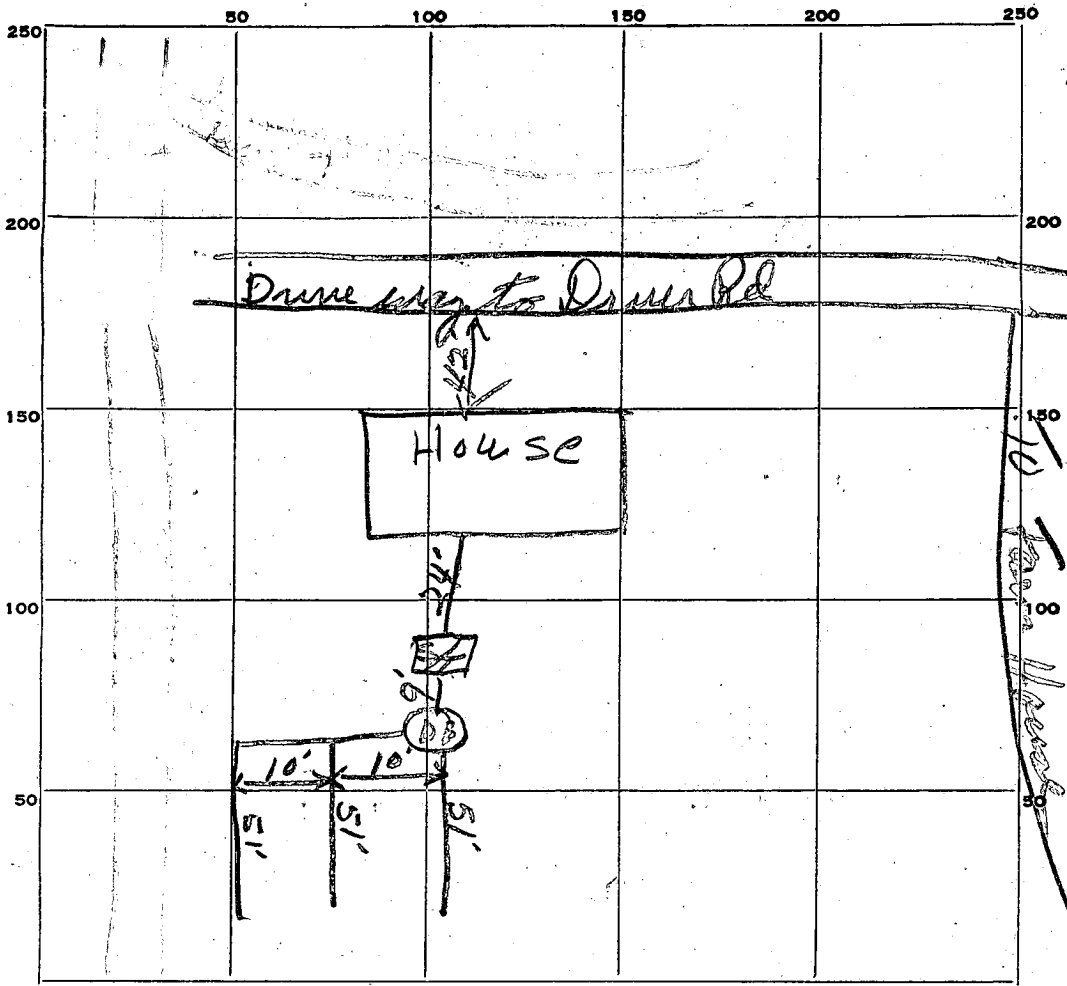

INDICATE NORTH. - NAME ADJOINING ROADWAY AS BASE LINE.

PERMIT CARD OK  
 SEPTIC TANK, LEVEL OK cannot 250 CLEANOUTS None  
 DISTRIBUTION BOX, LEVEL OK  
 TILE FIELD, DEPTH 3 FT. TRENCH WIDTH 3 FT.  
 GRAVEL DEPTH 1 IN. TOTAL LENGTH 153 FT.  
 NUMBER OF TRENCHES 3 TOTAL BOTTOM AREA 359 sq ft  
 SEEPAGE PITS, INSIDE DIAMETER \_\_\_\_\_ FT. DEPTH BELOW INLET \_\_\_\_\_ FT.  
 ABSORBENT AREA \_\_\_\_\_ SQ. FT.

REMARKS made cleanout on septic and hook to house

Job finished but not connected from house to  
septic tank (so I will not approve)  
Mr Framedlt said do this job

DATE SYSTEM APPROVED 8/22/68 INSPECTOR James T. Wright