

4/14/84
ASAP

4-14-84
approved
S. Amy

PERMIT

P 36684
A 24161

SEWAGE DISPOSAL SYSTEM

MARYLAND STATE DEPARTMENT OF HEALTH

HOWARD COUNTY
BUREAU OF ENVIRONMENTAL HEALTH
~~982-9270~~
461-9933

03-305007

INDEXED

ELLICOTT CITY
DISTRICT 3rd
DATE 3/20/84

Jack Fyock IS PERMITTED TO INSTALL X ALTER

ADDRESS _____ PHONE 988-9270

SUBDIVISION Annandale ROAD 13357 Grinstead Ct. LOT 6, Section II

PROPERTY OWNER Fred Kirksey John Frank

ADDRESS _____

IF GARBAGE GRINDER IS USED INCREASE SEPTIC TANK CAPACITY BY 50% AND ABSORPTION AREA BY 22%.

GARBAGE GRINDER? YES _____ NO X

BLDG. PERMIT SIGNED
AND RETURNED

SEPTIC TANK CAPACITY 1000 GALLONS NUMBER OF BEDROOMS 3

Serial # 67078

TRENCHES - 168 sq. ft. per bedroom. Trench to be 2 feet wide. Inlet 4 feet below original grade. Bottom maximum depth 10 feet below original grade. Effective area begins at 4 feet below original grade. 6 feet of stone below distribution pipe.

LOCATION:- Start the first trench 120 feet from the front lot line and 40 feet from the left lot line as seen when facing the property from Grinstead Court. Run trenches along level ground toward right side of lot with no part of any trench closer than 100 feet to the well.

NOTE - No trench to exceed 100 feet in length. If more than one trench used, a distribution box is required. Call for inspection of trench(s) before and after gravel is installed. Provide 6" - 8" diameter cleanout and cap to grade or above on septic tank. ok/cw

BLDG. PERMIT SIGNED
AND RETURNED

1-11-89
Serial # B10 115373
detached garage

PLANS APPROVED BY C. Williams DATE 10/24/84

COVER NO WORK UNTIL INSPECTED AND APPROVED.

NEITHER THE HOWARD COUNTY COUNCIL NOR THE HEALTH DEPARTMENT IS RESPONSIBLE FOR THE SUCCESSFUL OPERATION OF ANY SYSTEM.

NOTE: IF TRENCH IS USED CALL FOR INSPECTION BEFORE AND AFTER PLACING GRAVEL IN TRENCH.

NOTE: NO DRY WELL SHALL EXCEED 15 FOOT IN DIAMETER. NO ABSORPTION TRENCH TO EXCEED 100 FEET IN LENGTH.

NOTE: ALL PIPE FROM HOUSE TO SEPTIC TANK MUST BE CAST IRON OR SCHEDULE 40 PVC OR ABS.

PERMIT VOID AFTER THREE YEARS.

NOTE: INSTALL STAND PIPE ON SEPTIC TANK AND DRY WELL. STAND PIPES MUST BE 6 INCHES IN DIAMETER CAST IRON, CONCRETE OR TERRA COTTA, OR PVC OR ABS ACCEPTED. IF TOP OF SEPTIC TANK IS DEEPER THAN 3 FEET MANHOLE TO GRADE REQUIRED.

***INSTALLER IS RESPONSIBLE FOR OBTAINING FINAL APPROVAL ON THIS PERMIT**

CALL 992-2330 FOR INSPECTION OF SEPTIC SYSTEMS.

A 24161

A24161

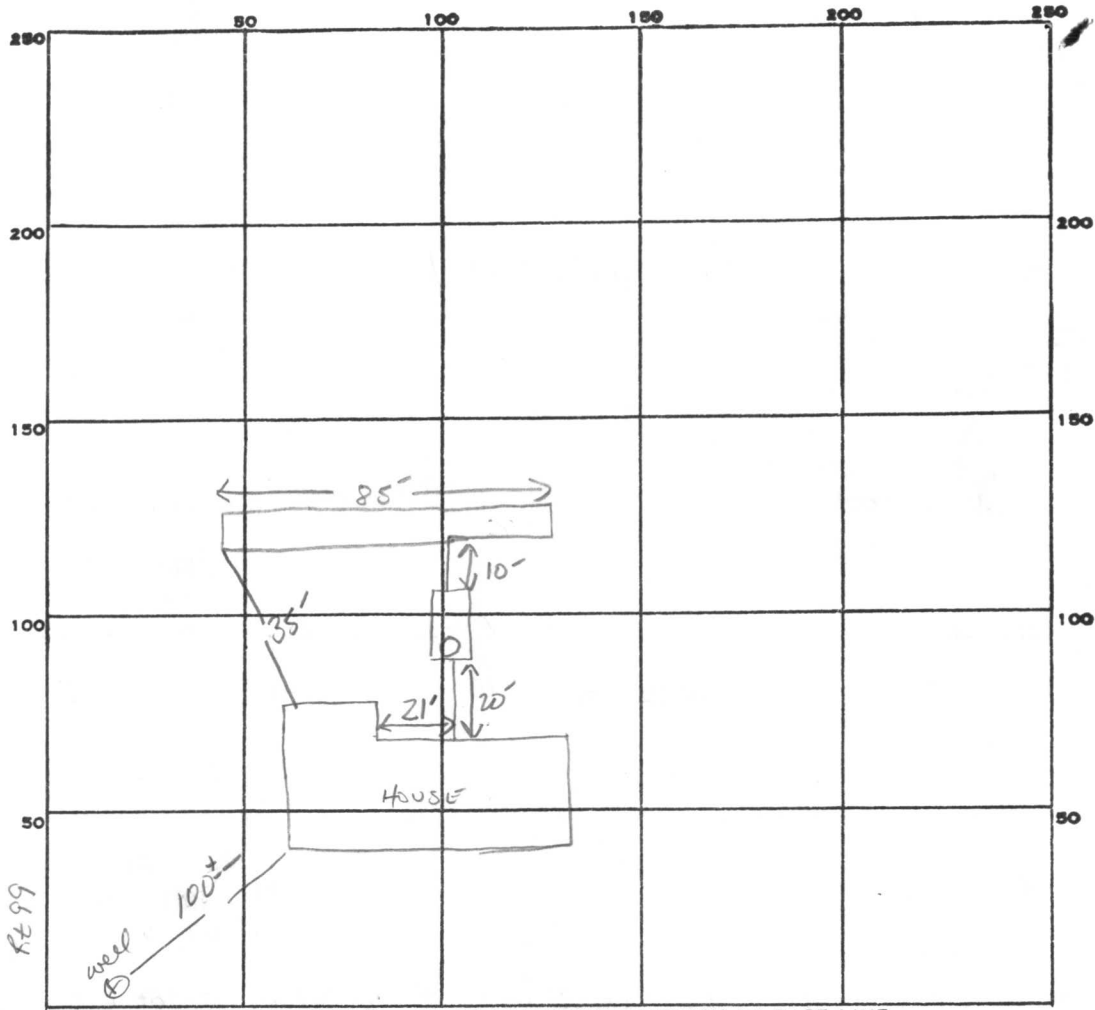

228
168
3/4
504
84
6/504
48
24

INDICATE NORTH. - NAME ADJOINING ROADWAY AS BASE LINE.

GRINSTEAD Ct.

PERMIT CARD

SEPTIC TANK, LEVEL 1000 GAL

CLEANOUTS

DISTRIBUTION BOX, LEVEL N/A

TILE FIELD, DEPTH 10 FT. TRENCH WIDTH 2 FT.

INLET 4"

GRAVEL DEPTH 6 FT IN. TOTAL LENGTH 85 FT.

NUMBER OF TRENCHES 1 ONE SIDE WAL TOTAL BOTTOM AREA 510 ϕ

SEEPAGE PITS, INSIDE DIAMETER _____ FT. DEPTH BELOW INLET _____ FT.

ABSORBENT AREA 510 SQ. FT.

REMARKS 4-14-86 OK TO ADD STONE TO TRENCH, S. Abel

DATE SYSTEM APPROVED 4-14-86

INSPECTOR S. Abel

12/8/98
10:00

APPLICATION

PERCOLATION TESTING

A _____

P 511126

HOWARD COUNTY HEALTH DEPARTMENT
BUREAU OF ENVIRONMENTAL HEALTH
3525-H ELLICOTT MILLS DRIVE/ELLICOTT CITY, MARYLAND 21043
TELEPHONE: 313-2640

DISTRICT _____

DATE 12/2/98

TO: THE COUNTY HEALTH OFFICER
ELLICOTT CITY, MARYLAND

I HEREBY APPLY FOR THE NECESSARY TEST PRIOR TO APPLICATION FOR PERMIT TO CONSTRUCT (OR RECONSTRUCT) A SEWAGE DISPOSAL SYSTEM.

PROPERTY OWNER John Frank PRAGER (410) 934-1316

ADDRESS 13351 Grinstead Ct. PHONE (410) 489-2737

AGENT OR PROSPECTIVE BUYER _____

ADDRESS _____ PHONE _____

PROPERTY LOCATION:

SUBDIVISION Annandale LOT NO. 6 sect. II

ROAD AND DESCRIPTION 13351 Grinstead Court

TAX MAP _____ PARCEL # _____

SIZE OF LOT _____ TYPE BLDG. _____
(SINGLE FAMILY DWELLING OR COMMERCIAL)

BLDG. PERMIT SIGNED

AND RETURNED 1-11-99
Serial # Bro 11 53-43
garage deleted

THE SYSTEM INSTALLED UNDER THIS APPLICATION IS ACCEPTABLE ONLY UNTIL PUBLIC FACILITIES BECOME AVAILABLE. I FULLY UNDERSTAND THE FEE CONNECTED WITH THE FILING OF THIS PERC TEST APPLICATION IS NON-REFUNDABLE UNDER ANY CIRCUMSTANCES. I ALSO AGREE TO COMPLY WITH ALL M.O.S.H.A. REQUIREMENTS IN TESTING THIS LOT.

(SIGNATURE OF APPLICANT)

APPROVED BY _____ FOR _____ DATE _____

DISAPPROVED BY _____ FOR _____ DATE _____

HOLD PENDING FURTHER TESTS _____

REASONS FOR REJECTION OR HOLDING _____

PERCOLATION TEST PLAT/PRELIMINARY PLAT - TITLE OR I.D. # _____ DATE _____

SITE DEVELOPMENT PLAN/FINAL PLAT - TITLE OR I.D. # _____ DATE _____

THIS IS NOT A PERMIT

COUNTY #

SOIL PROFILE

0' (1)
topsoil
1' org brn cl Lm
4' pale org tan si Lm
15' 35% rock frag

-Route 99-

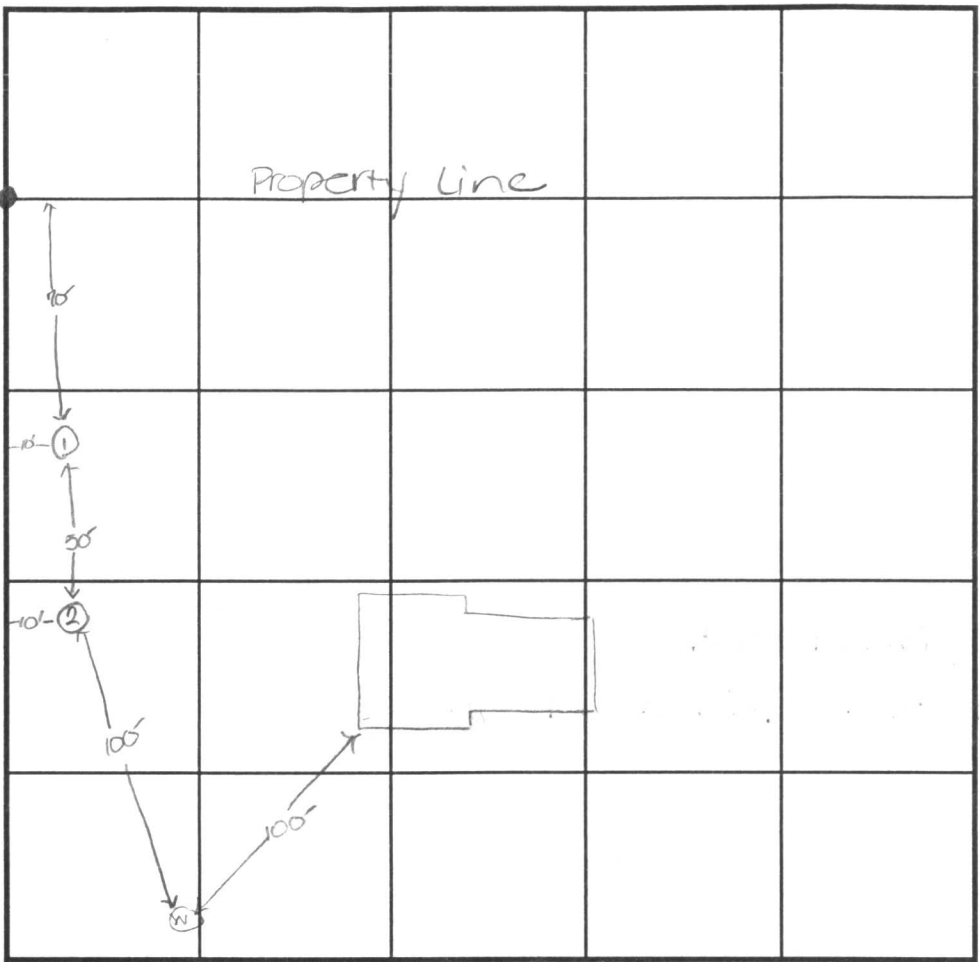

SOIL PROFILE

0'

INDICATE NORTH - NAME ADJOINING ROADWAY AS BASE LINE.

Grinstead Court

0' (2)
1' topsoil
red org brn cl Lm
4' pale org tan si Lm
14' 10-15% rock frag

DATE	TEST NO.	DEPTH	PRE-WET		TEST - 1" DROP		TIME
			START	STOP	START	STOP	
12-8-98	1	15.0'	Visual	- See profile			OK
	2	14.0'	Visual	- See profile			OK

REMARKS _____

TYPE OF SOIL _____

TESTED BY D. Soe ALSO PRESENT owner, K. Schissler

TRENCH DESIGN DATA: AVERAGE PERCOLATION TIME _____ TRENCH WIDTH _____

INLET DEPTH _____ MAXIMUM BOTTOM DEPTH _____ SQ. FT/BEDROOM _____

... to Howard County, Maryland for the purpose of Public Road - 0.550 A.C. ±

FREDERICK

Varies

WICK ROAD

$885^{\circ}45'12"E = 425.09'$

$335^{\circ}45'12"E = 425.09'$

(17)

(18)

$R = 842.44', L = 189.60'$

$R = 817.44', L = 178.15'$

(32)

(33)

(31)

(30)

(29)

Original Field Garage (24x36)

Notes by Environmental Health Dept

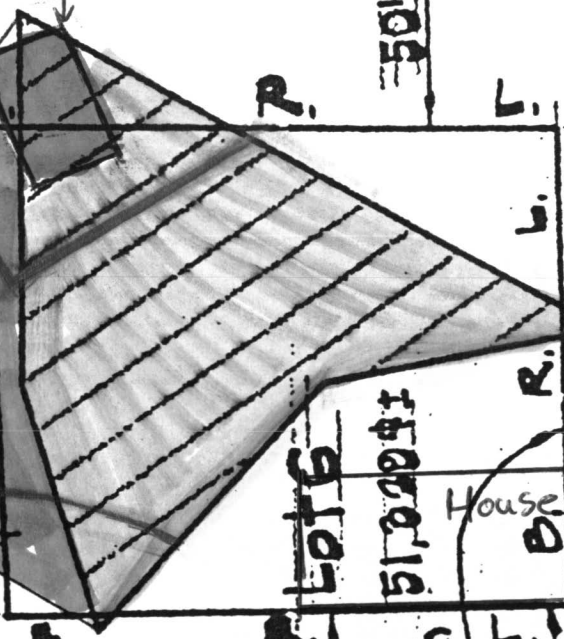

Lot 6

51,020 sq ft

House

Building Restriction Line

$N 50^{\circ}00'15" E = 35.89'$

$75'$

$178.31'$

$50'$

R/W

$S 95^{\circ}46'58"W = 418'$

$S 05^{\circ}46'58"W = 418'$

$S 84^{\circ}19'01"E$

$R = 250.00' L$

Building Restriction

$75'$

30' Drainage Easement

Lot 24

135,791 sq ft

$S N 96^{\circ}56'28"W = 599.27'$

1/11/99
Proposed garage location as shown

RECEIVED
HOWARD COUNTY HEALTH DEPT.
ENVIRONMENTAL HEALTH

1998 DE 23 PM 12:19

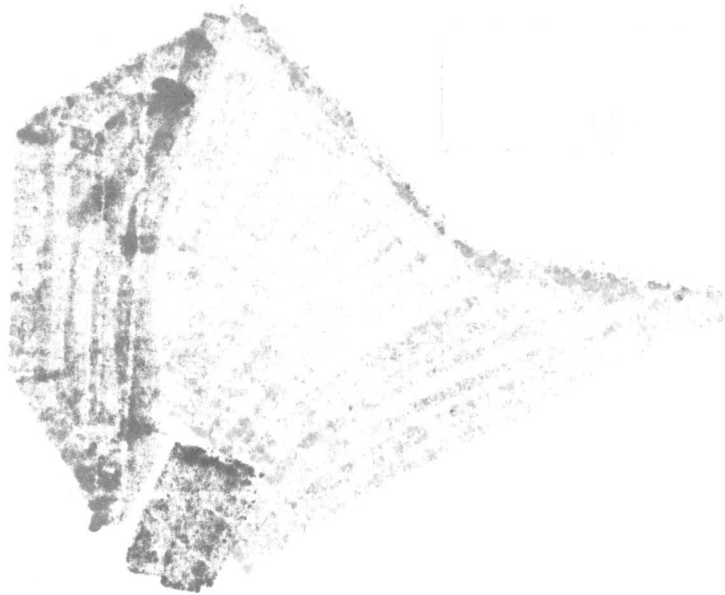

OLD FREDRICK RD.



GRINTEAD CT.

12/20/98 ±

highlighted septic area is approvable based upon test holes - ok to proceed w/BP. DCB

APPLICATION

A 24162

SEWAGE DISPOSAL TESTING

P _____

STATE OF MARYLAND - DEPARTMENT OF HEALTH AND MENTAL HYGIENE

HOWARD COUNTY HEALTH DEPARTMENT
ENVIRONMENTAL HEALTH SERVICES
P. O. BOX 476, ELLICOTT CITY, MARYLAND 21043
TELEPHONE: 465-5000, EXT. 356

DISTRICT 3rd.

DATE 9/21/76

TO: THE COUNTY HEALTH OFFICER
ELLICOTT CITY, MARYLAND

I, HEREBY, APPLY FOR THE NECESSARY TEST IN ORDER TO CONSTRUCT (OR RECONSTRUCT) A SEWAGE DISPOSAL SYSTEM.

PROPERTY OWNER Fred James Pipes

ADDRESS 13555 Old Frederick Road, Sykesville, Md. PHONE _____
21784

PROPERTY LOCATION:

SUBDIVISION Annandale LOT NO. 5

ROAD AND DESCRIPTION Grinstead Ct.

SIZE OF LOT 40,000 sq. ft. TYPE BLDG. 3 or 4

IF NOT SINGLE RESIDENCE DESCRIBE _____
NUMBER OF BEDROOMS single family dwelling

THE SYSTEM INSTALLED UNDER THIS APPLICATION IS ACCEPTABLE ONLY UNTIL PUBLIC FACILITIES BECOME AVAILABLE.

SIGNATURE OF APPLICANT /s/ Fred James Pipes

APPROVED BY _____ FOR _____ DATE _____
(KIND OF SYSTEM)

REJECTED BY _____ FOR _____ DATE _____
(KIND OF SYSTEM)

HOLD PENDING FURTHER TESTS _____ DATE _____

REASONS FOR REJECTION OR HOLDING _____

THIS IS NOT A PERMIT

A 24162

Quinton CT

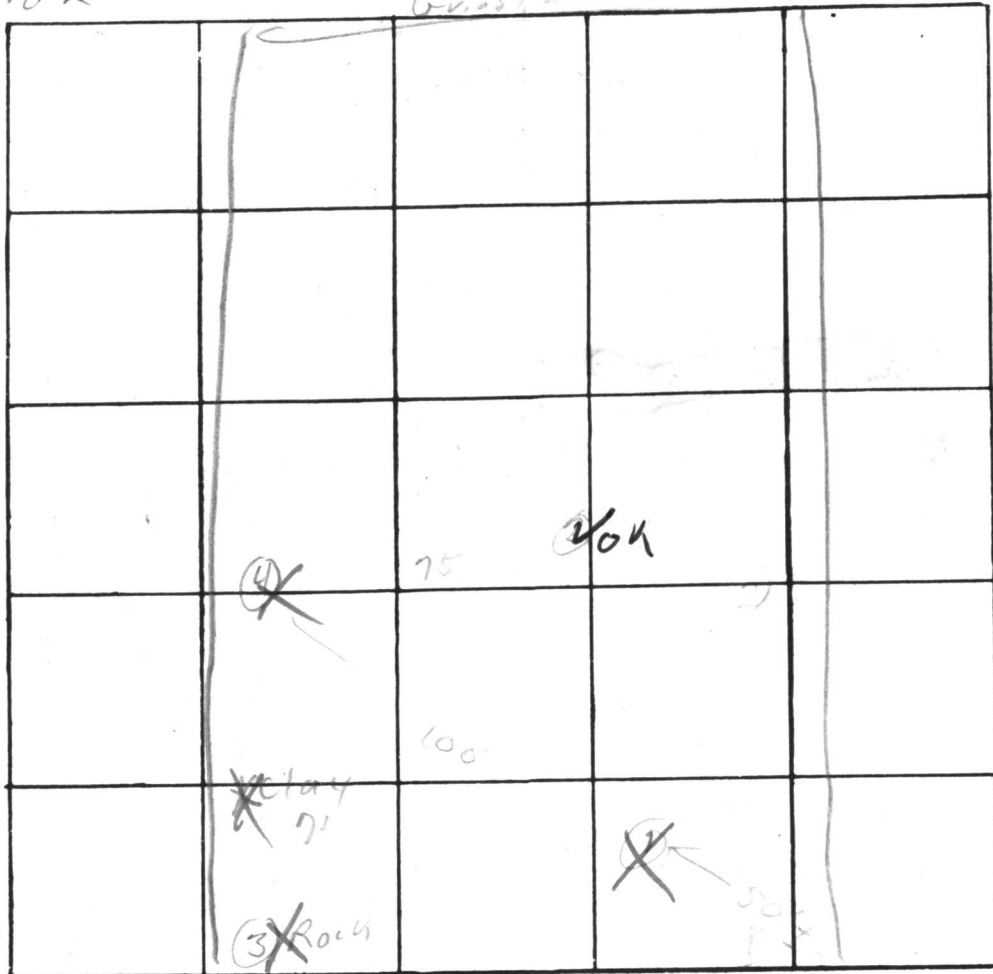

INDICATE NORTH. - NAME ADJOINING ROADWAY AS BASE LINE.

DATE	TEST NO.	DEPTH	PRE-WET		TEST - 1" DROP		TIME
			START	STOP	START	STOP	
10/17/42	1s	6 1/4'	10 19	—	Fail	1" 30m	
	d	11'	11 05				
	4s	5 1/4'	10 25	10 32	10 32	10 40	8
	d	14'	10 31	—	Fail	1" 30m	
	2s	6'	10 43	11 00	11 00	11 30	30
	d	19'	11 15	11 22	11 22	11 30	8

REMARKS _____

TYPE OF SOIL _____

TESTED BY ADJ _____ ALSO PRESENT: _____

APPLICATION

24761

A 24161

P _____

SEWAGE DISPOSAL TESTING

STATE OF MARYLAND - DEPARTMENT OF HEALTH AND MENTAL HYGIENE

HOWARD COUNTY HEALTH DEPARTMENT
ENVIRONMENTAL HEALTH SERVICES
P. O. BOX 476, ELLICOTT CITY, MARYLAND 21043
TELEPHONE: 465-5000, EXT. 356

DISTRICT 3rd

DATE 9/21/76

TO: THE COUNTY HEALTH OFFICER
ELLICOTT CITY, MARYLAND

I, HEREBY, APPLY FOR THE NECESSARY TEST IN ORDER TO CONSTRUCT (OR RECONSTRUCT) A SEWAGE DISPOSAL SYSTEM.

PROPERTY OWNER Fred James Pipes

ADDRESS 13555 Old Frederick Road, Sykesville, Md. PHONE _____
21784

PROPERTY LOCATION:

SUBDIVISION Annandale LOT NO. 4

ROAD AND DESCRIPTION Grinstead Ct. and Old Frederick Rd.

SIZE OF LOT 41,500 sq. ft. TYPE BLDG. 3 or 4

IF NOT SINGLE RESIDENCE DESCRIBE _____
single family dwelling

THE SYSTEM INSTALLED UNDER THIS APPLICATION IS ACCEPTABLE ONLY UNTIL PUBLIC FACILITIES BECOME AVAILABLE.

SIGNATURE OF APPLICANT /s/ Fred James Pipes

APPROVED BY _____ FOR _____ DATE _____
(KIND OF SYSTEM)

REJECTED BY _____ FOR _____ DATE _____
(KIND OF SYSTEM)

HOLD PENDING FURTHER TESTS _____ DATE _____

REASONS FOR REJECTION OR HOLDING _____

THIS IS NOT A PERMIT

C1 0831

SEQUENCE NO. (OEP USE ONLY)

STATE OF MARYLAND WELL COMPLETION REPORT

THIS REPORT MUST BE SUBMITTED WITHIN 45 DAYS AFTER WELL IS COMPLETED.

(THIS NUMBER IS TO BE PUNCHED IN COLS. 3-6 ON ALL CARDS)

COUNTY NUMBER A24161

DATE Received

DATE WELL COMPLETED 1/2/83

Depth of Well 85 (TO NEAREST FOOT)

PERMIT NO. FROM "PERMIT TO DRILL WELL" 40-81-0311

OWNER Pipes last name Grinstead Court first name Fred TOWN Sykesville SECTION 2 LOT 6

WELL LOG Not required for driven wells STATE THE KIND OF FORMATIONS PENETRATED, THEIR COLOR, DEPTH, THICKNESS AND IF WATER BEARING

Table with columns: DESCRIPTION, FEET (FROM, TO), Check if water bearing. Rows include Top Soil, Brown Shale, Brown Sandstone, Granite, etc.

Table for #1 Dry hole with columns: DESCRIPTION, FEET (FROM, TO), Check if water bearing. Rows include Top Soil, Brown Shale, Brown Sandstone, Granite.

Table for #2 Dry hole with columns: DESCRIPTION, FEET (FROM, TO), Check if water bearing. Rows include Top Soil, Brown Shale, Brown Sandstone, Granite.

* Dry holes were back filled and cemented

GROUTING RECORD WELL HAS BEEN GROUTED (Circle Appropriate Box) TYPE OF GROUTING MATERIAL CEMENT CM BENTONITE CLAY BC NO. OF BAGS 8 NO. OF POUNDS 752

CASING RECORD casing types insert appropriate code below MAIN CASING TYPE ST Nominal diameter top (main) casing (nearest inch) 6 Total depth of main casing (nearest foot) 44

OTHER CASING (if used) diameter inch depth (feet) from to

SCREEN RECORD screen type or open hole insert appropriate code below SCREEN RECORD ST BR HO STEEL BRASS OPEN HOLE PLASTIC OTHER

DEPTH (nearest ft.) 42 85 SLOT SIZE 1 2 3 DIAMETER OF SCREEN (NEAREST INCH)

GRAVEL PACK IF WELL DRILLED WAS FLOWING WELL INSERT F IN BOX 68

OEP USE ONLY (NOT TO BE FILLED IN BY DRILLER) T (E.R.O.S.) WQ TELESCOPE CASING LOG INDICATOR OTHER DATA

PUMPING TEST HOURS PUMPED (nearest hour) 3 PUMPING RATE (gal. per min. to nearest gal.) 12 METHOD USED TO MEASURE PUMPING RATE BUCKET WATER LEVEL (distance from land surface) BEFORE PUMPING 46 WHEN PUMPING 47 TYPE OF PUMP USED (for test) A air P piston T turbine C centrifugal R rotary O other (describe below) J jet S submersible

PUMP INSTALLED DRILLER WILL INSTALL PUMP YES NO (CIRCLE) (YES or NO) IF DRILLER INSTALLS PUMP, THIS SECTION MUST BE COMPLETED FOR ALL WELLS EXCEPT HOME USE TYPE OF PUMP INSTALLED PLACE (A,C,J,P,R,S,T,O) IN BOX - SEE ABOVE: CAPACITY: GALLONS PER MINUTE (to nearest gallon) PUMP HORSE POWER PUMP COLUMN LENGTH (nearest ft.) CASING HEIGHT (circle appropriate box and enter casing height) LAND SURFACE (nearest foot)

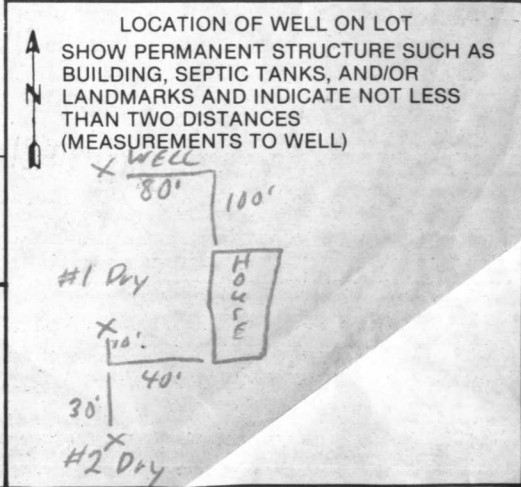

CIRCLE APPROPRIATE LETTER A A WELL WAS ABANDONED AND SEALED WHEN THIS WELL WAS COMPLETED E ELECTRIC LOG OBTAINED P TEST WELL CONVERTED TO PRODUCTION WELL

I HEREBY CERTIFY THAT THIS WELL HAS BEEN CONSTRUCTED IN ACCORDANCE WITH COMAR 10.17.13 "WELL CONSTRUCTION" AND IN CONFORMANCE WITH ALL CONDITIONS STATED IN THE ABOVE CAPTIONED PERMIT, AND THAT THE INFORMATION PRESENTED HEREIN IS ACCURATE AND COMPLETE TO THE BEST OF MY KNOWLEDGE.

DRILLERS IDENT. NO. 308 DRILLERS SIGNATURE (MUST MATCH SIGNATURE ON APPLICATION)

SITE SUPERVISOR (sign. of driller or journeyman responsible for sitework if different from permittee)

1" = 50'

GRINSTEAD COURT
EX 50' RW

MD. ROUTE 99

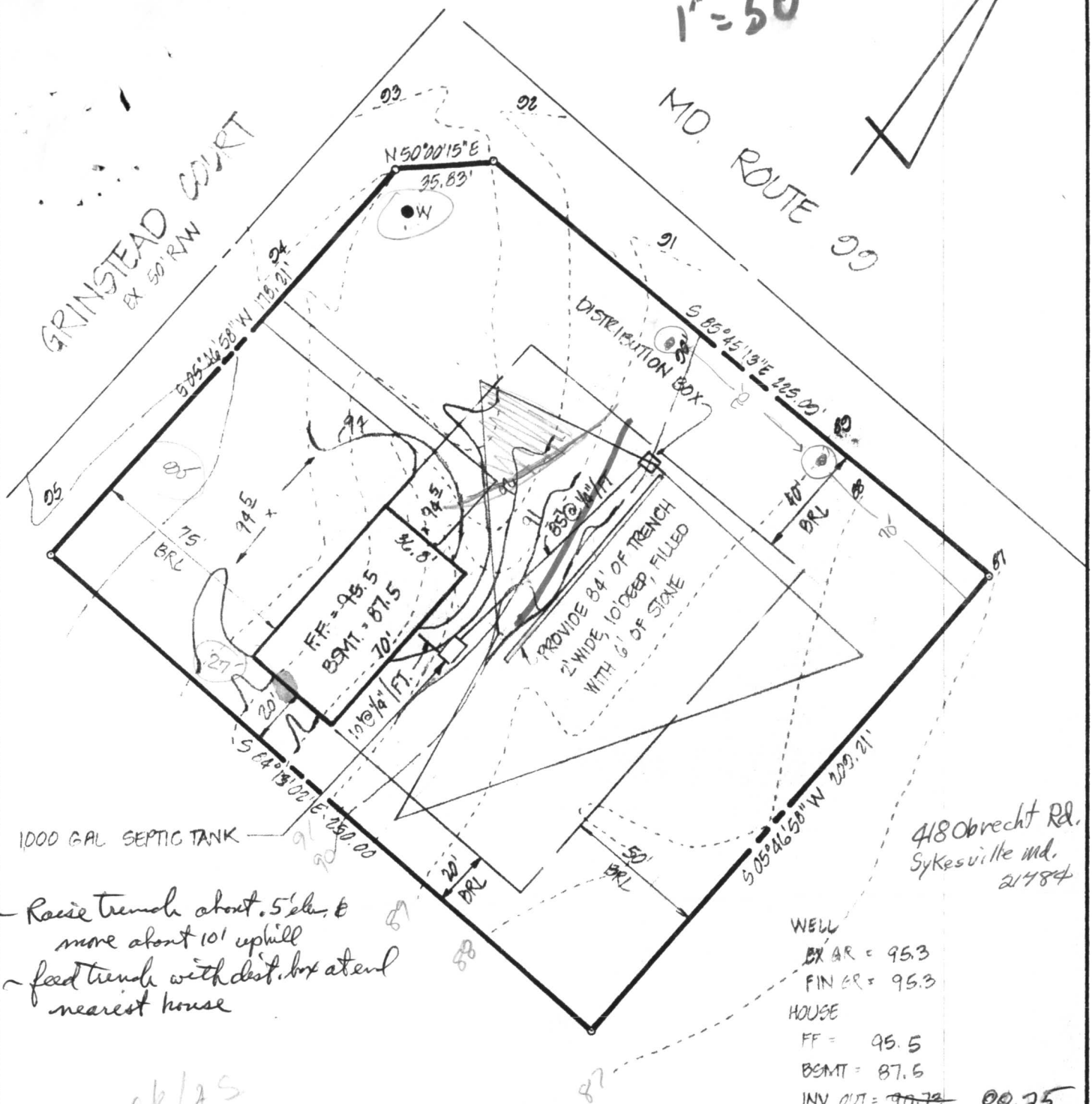

418 Obrecht Rd.
Sykesville Md.
21784

WELL	
EX GR =	95.3
FIN GR =	95.3
HOUSE	
FF =	95.5
BSMT =	87.5
INV. OUT =	90.75 88.25
SEPTIC TANK	
EX GR =	90.7
FIN GR =	91.5
INV. IN =	88.02 88.02
INV. OUT =	87.77
DISTRIBUTION BOX	
EX GR =	90.0 90.5
FIN GR =	90.0 90.5
INV. IN =	86.0 86.5

1000 GAL SEPTIC TANK

Raise trench about .5' elev. & more about 10' uphill feed trench with dist. box at end nearest house

NOTE:
NO GRAVITY SEWER SERVICE TO BASEMENT

well/AS

B.P. # 67078

TITLE: GRADING STUDY

PROJECT: ANNANDALE-SECTION 2, LOT 6

boender associates inc.