

LAYOUT 12/7/2010

INSP 1 12/7 INSP 3 \_\_\_\_\_

INSP 2 \_\_\_\_\_ INSP 5 \_\_\_\_\_

ISSUE DATE: 12/1/10

APPROVAL DATE:

4/5/2011

# PERMIT SHARED SEPTIC SYSTEM

P 534003

A 534003

## Tax ID # HOUSE SEWER LINE CONNECTION

### HOWARD COUNTY HEALTH DEPARTMENT BUREAU OF ENVIRONMENTAL HEALTH

South Carroll Backhoe IS PERMITTED TO INSTALL  ALTER

ADDRESS: 4410 Salem Bottom Road Westminster MD 21157 PHONE NUMBER: 410-875-4197

SUBDIVISION Walnut Grove LOT NUMBER: 7

ADDRESS: 12355 Preakness Circle Lane PROPERTY OWNER: Trinity Quality Homes

NUMBER OF BEDROOMS: 4

#### HOUSE SERVED BY PUBLIC WATER? NO

LOCATION:	Install 4" house sewer line connection per the approved site plan.
NOTES:	This permit is limited to the installation of the individual house sewer line connection and installation of the grinder pump, if applicable. The Howard County Bureau of Utilities must be contacted for scheduling of inspection of these items as well, at 410-313-4900.

PLANS APPROVED: Dana Bernard DATE: 7/7/10

#### PERMIT VOID AFTER 2 YEARS

1. CONTRACTOR IS RESPONSIBLE FOR SCHEDULING A PRE-CONSTRUCTION INSPECTION FOR ALL INSTALLATIONS.
2. ALL PARTS OF SEPTIC SYSTEM SHALL BE 100 FEET FROM ANY WATER WELL UNLESS SPECIFICALLY AUTHORIZED.
3. MANHOLE RISERS REQUIRED ON ALL SEPTIC TANKS AND PUMP CHAMBERS UNLESS SPECIFICALLY AUTHORIZED.
4. CONTRACTOR RESPONSIBLE FOR COMPLIANCE WITH APPLICABLE REGULATIONS, GUIDELINES AND THE TERMS OF THIS PERMIT.
5. NEITHER THE HOWARD COUNTY COUNCIL NOR THE HEALTH DEPARTMENT IS RESPONSIBLE FOR THE SUCCESSFUL OPERATION OF ANY SYSTEM.
6. PERMITTEE RESPONSIBLE FOR OBTAINING FINAL APPROVAL ON THIS PERMIT.  
CALL 410-313-1771 FOR INSPECTION HOUSE CONNECTION

HO-94-4186

NOT TO SCALE

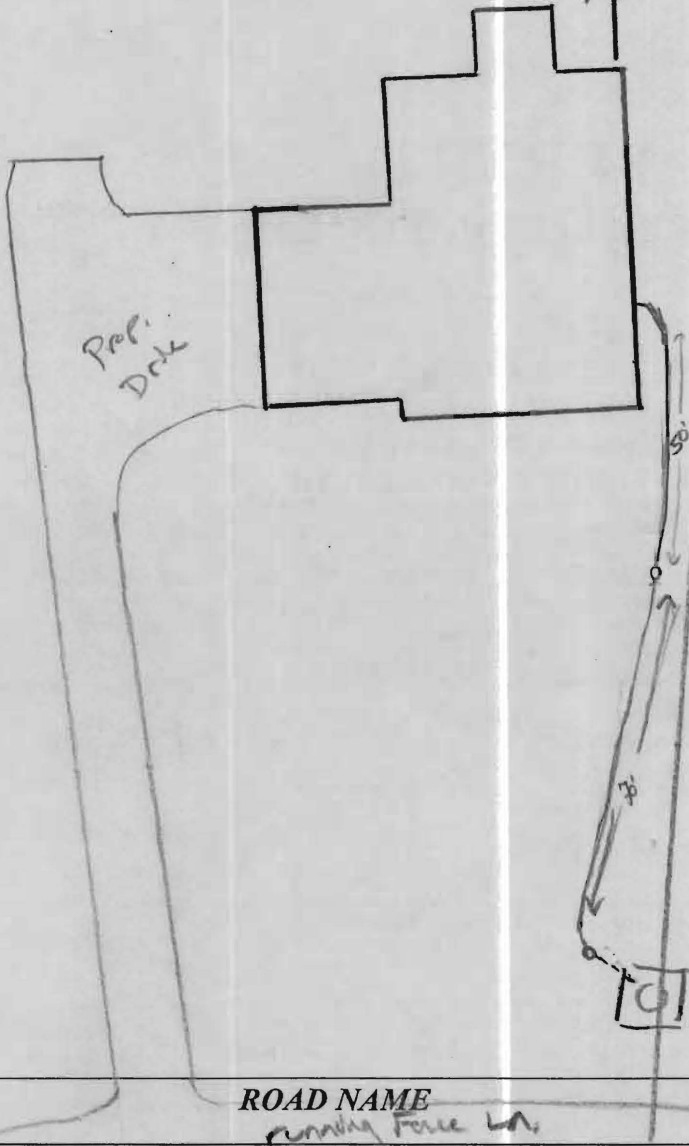

**TRENCH/DRAINFIELD DATA**

WIDTH	INLET	BOTTOM
_____	_____	_____
NUMBER OF TRENCHES _____		
TOTAL LENGTH _____		
ABSORPTION AREA _____		
DISTRIBUTION BOX LEVEL _____		
DISTRIBUTION BOX BAFFLE _____		
DISTRIBUTION BOX PORT _____		

**SEPTIC TANK DATA**

SEPTIC TANK I LEVEL \_\_\_\_\_

MANUFACTURER \_\_\_\_\_

CAPACITY \_\_\_\_\_ GAL

SEAM LOC \_\_\_\_\_

TANK LID DEPTH \_\_\_\_\_

BAFFLES \_\_\_\_\_

BAFFLE FILTER \_\_\_\_\_

MANHOLE LOC \_\_\_\_\_

6" PORT LOC \_\_\_\_\_

WATERTIGHT TEST \_\_\_\_\_

SLOTTED \_\_\_\_\_

DATE ON LID \_\_\_\_\_

PUMP/SEPTIC TANK LEVEL \_\_\_\_\_

MANUFACTURER \_\_\_\_\_

CAPACITY \_\_\_\_\_ GAL

SEAM LOC \_\_\_\_\_

TANK LID DEPTH \_\_\_\_\_

BAFFLES \_\_\_\_\_

BAFFLE FILTER \_\_\_\_\_

MANHOLE LOC \_\_\_\_\_

6" PORT LOC \_\_\_\_\_

WATERTIGHT TEST \_\_\_\_\_

SLOTTED \_\_\_\_\_

DATE ON LID \_\_\_\_\_

PRE-CONSTRUCTION:

\_\_\_\_\_

\_\_\_\_\_

\_\_\_\_\_

\_\_\_\_\_

INSTALLATION: 12/7/10 SHC made. 1% bid all the way  
 Well was verified as well. Costs ok. OK to back fill all water

4/5/2011 Received approval from utilities for grinder pump operation, etc. BB

FINAL INSPECTOR B. Baker DATE OF APPROVAL 4/5/2011

