

7  
0 S.F.  
ED  
KQ

LOT 8  
S.F.  
EPMS

32  
50' BRL

900  
4A  
30' BRL  
901  
802  
20A  
30' BRL

LOT 13  
45,636 S.F.

FRONT

FRONT

FRONT

FRONT

FRONT

LOT 6  
33,000 S.F.  
SHARED SEPTIC

LOT 5  
33,000 S.F.  
SHARED SEPTIC

LOT 9  
33,000 S.F.  
SHARED SEPTIC

FRONT

FRONT

FRONT

FRONT

FRONT

FRONT

FRONT

FRONT

FRONT

FRONT

FRONT

FRONT

FRONT

RYON

FRONT

FRONT

FRONT

FRONT

FRONT

FRONT

FRONT

FRONT

FRONT

FRONT

FRONT

FRONT

FRONT

FRONT

FRONT

FRONT

FRONT

FRONT

FRONT

FRONT

FRONT

FRONT

FRONT

FRONT

FRONT

FRONT

FRONT

FRONT

FRONT

FRONT

FRONT

FRONT

FRONT

FRONT

FRONT

FRONT

FRONT

FRONT

FRONT

FRONT

FRONT

FRONT

FRONT

FRONT

FRONT

FRONT

FRONT

FRONT

FRONT

FRONT

FRONT

FRONT

FRONT

FRONT

FRONT

FRONT

FRONT

FRONT

FRONT

FRONT

FRONT

FRONT

FRONT

FRONT

FRONT

FRONT

FRONT

FRONT

FRONT

FRONT

FRONT

FRONT

FRONT

FRONT

FRONT

FRONT

FRONT

FRONT

FRONT

FRONT

FRONT

FRONT

FRONT

FRONT

FRONT

FRONT

FRONT

FRONT

FRONT

FRONT

FRONT

FRONT

FRONT

FRONT

FRONT

FRONT

FRONT

FRONT

FRONT

FRONT

FRONT

FRONT

FRONT

FRONT

FRONT

FRONT

FRONT

FRONT

FRONT

FRONT

FRONT

FRONT

FRONT

FRONT

FRONT

FRONT

FRONT

FRONT

FRONT

FRONT

FRONT

FRONT

FRONT

FRONT

FRONT

FRONT

FRONT

FRONT

FRONT

FRONT

FRONT

FRONT

FRONT

FRONT

FRONT

FRONT

FRONT

FRONT

FRONT

FRONT

FRONT

FRONT

FRONT

FRONT

FRONT

FRONT

FRONT

FRONT

FRONT

FRONT

FRONT

FRONT

FRONT

FRONT

FRONT

FRONT

FRONT

FRONT

FRONT

FRONT

FRONT

FRONT

FRONT

FRONT

FRONT

FRONT

FRONT

FRONT

FRONT

FRONT

FRONT

FRONT

FRONT

FRONT

FRONT

FRONT

FRONT

FRONT

FRONT

FRONT

FRONT

FRONT

FRONT

FRONT

FRONT

FRONT

FRONT

FRONT

FRONT

FRONT

FRONT

FRONT

FRONT

FRONT

FRONT

FRONT

FRONT

FRONT

FRONT

FRONT

FRONT

FRONT

FRONT

FRONT

FRONT

FRONT

FRONT

FRONT

FRONT

FRONT

FRONT

FRONT

FRONT

FRONT

FRONT

FRONT

FRONT

FRONT

FRONT

FRONT

FRONT

FRONT

FRONT

FRONT

FRONT

FRONT

FRONT

FRONT

FRONT

FRONT

FRONT

FRONT

FRONT

FRONT

FRONT

FRONT

FRONT

FRONT

FRONT

FRONT

FRONT

FRONT

FRONT

FRONT

FRONT

FRONT

FRONT

FRONT

FRONT

FRONT

FRONT

FRONT

FRONT

FRONT

FRONT

FRONT

FRONT

FRONT

FRONT

FRONT

FRONT

FRONT

FRONT

FRONT

FRONT

FRONT

FRONT

FRONT

FRONT

FRONT

FRONT

FRONT

FRONT

FRONT

FRONT

FRONT

FRONT

FRONT

FRONT

FRONT

FRONT

FRONT

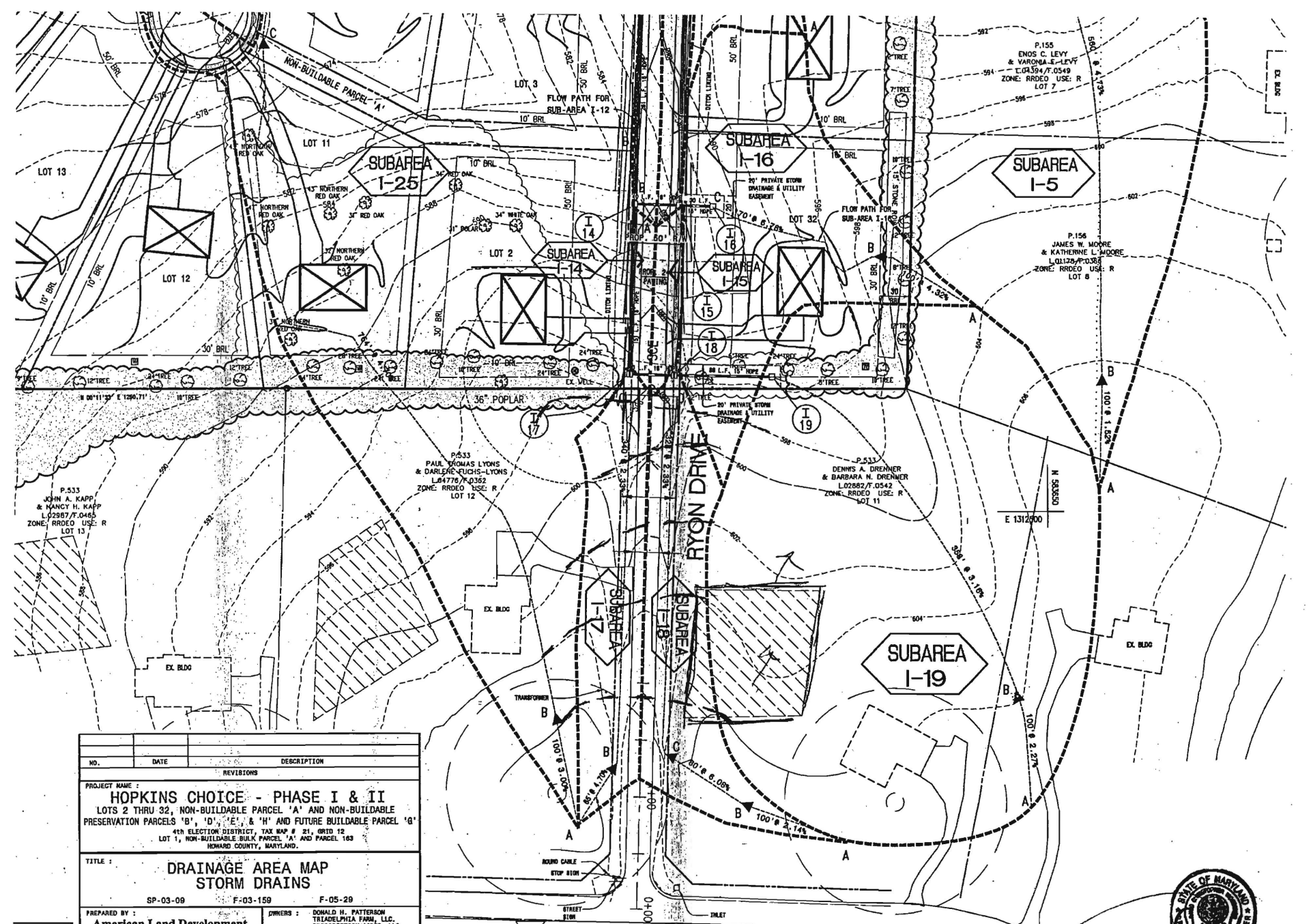

NO.	DATE	DESCRIPTION
REVISIONS		
PROJECT NAME :		
<b>HOPKINS CHOICE - PHASE I &amp; II</b>		
LOTS 2 THRU 32, NON-BUILDABLE PARCEL 'A' AND NON-BUILDABLE PRESERVATION PARCELS 'B', 'D', 'E', & 'H' AND FUTURE BUILDABLE PARCEL 'G'		
4th ELECTION DISTRICT, TAX MAP # 21, GRID 12		
LOT 1, NON-BUILDABLE BULK PARCEL 'A' AND PARCEL 163		
HOWARD COUNTY, MARYLAND.		
TITLE :		
<b>DRAINAGE AREA MAP</b>		
<b>STORM DRAINS</b>		
SP-03-09	F-03-159	F-05-29
PREPARED BY :	OWNERS :	
<b>American Land Development and Engineering, Inc.</b>	DONALD H. PATTERSON TRIADDELPHIA FARM, LLC PRESCRIPTION MOSES, LLC c/o DONALD H. PATTERSON PO BOX 1 GLEBELS, MD. 21737	
10748 BIRMINGHAM WAY WOODSTOCK, MD. 21153 TEL. (410) 465-7903 FAX. (410) 465-3946	DEVELOPER : TRIADDELPHIA FARM, LLC. 6239 CARDINAL LANE COLUMBIA, MD. 21044	
DES. : JHE/AVG	JOB :	SCALE :
DRW. : AVG	PROJ. :	1" = 60'
CHK. : DCW	DATE : MAY 17, 2005	SHEET 7 OF 22



**DRAINAGE AREA MAP - STORM DRAINS**

F-05-29