

APPLICATION

PERCOLATION TESTING

A 516084

P _____

DISTRICT _____

DATE _____

HOWARD COUNTY HEALTH DEPARTMENT
BUREAU OF ENVIRONMENTAL HEALTH
3525-H ELLICOTT MILLS DRIVE/ELLICOTT CITY, MARYLAND 21043
TELEPHONE: 313-2640

TO: THE COUNTY HEALTH OFFICER
ELLICOTT CITY, MARYLAND

I HEREBY APPLY FOR THE NECESSARY TEST PRIOR TO APPLICATION FOR PERMIT TO CONSTRUCT (OR RECONSTRUCT) A SEWAGE DISPOSAL SYSTEM.

PROPERTY OWNER Security Development

ADDRESS P.O. Box 417, Ellicott City, MD 21041 PHONE (410) 465-4244

AGENT OR PROSPECTIVE BUYER _____

ADDRESS _____ PHONE _____

PROPERTY LOCATION:

SUBDIVISION Homewood LOT NO. _____

ROAD AND DESCRIPTION Homewood Road

TAX MAP 23+29 PARCEL # 20+86

SIZE OF LOT 1 Acre ± TYPE BLDG. SFD
(SINGLE FAMILY DWELLING OR COMMERCIAL)

THE SYSTEM INSTALLED UNDER THIS APPLICATION IS ACCEPTABLE ONLY UNTIL PUBLIC FACILITIES BECOME AVAILABLE. I FULLY UNDERSTAND THE FEE CONNECTED WITH THE FILING OF THIS PERC TEST APPLICATION IS NON-REFUNDABLE UNDER ANY CIRCUMSTANCES. I ALSO AGREE TO COMPLY WITH ALL M.O.S.H.A. REQUIREMENTS IN TESTING THIS LOT.

(SIGNATURE OF APPLICANT)

APPROVED BY _____ FOR _____ DATE _____

DISAPPROVED BY _____ FOR _____ DATE _____

HOLD PENDING FURTHER TESTS _____

REASONS FOR REJECTION OR HOLDING _____

PERCOLATION TEST PLAT/PRELIMINARY PLAT - TITLE OR I.D. # _____ DATE _____

SITE DEVELOPMENT PLAN/FINAL PLAT - TITLE OR I.D. # _____ DATE _____

THIS IS NOT A PERMIT

COUNTY #

SOIL PROFILE

0' (828)

25'-3" Red Br Heavy Loam and Topsoil

Red Br SiCl Loam

Trace Rock

5'-5.5" Tan Sa Loam ~15% Saprolite

14'

(829)

Or and Gray Mottled Br Heavy Loam

3' Red Br and Or Br SiCl Loam and Sa Cl Loam

Trace Rock

4.5'-5" Dense Tan Sa Loam 5-10% Saprolite

15' Water

(65B)

Red Br Sa Cl Loam and Topsoil

9' Dense Red Br Sa Loam Some Clay

3' Trace Rock

4.5' Tan Sa Loam 15-20% Saprolite

13.5' Water

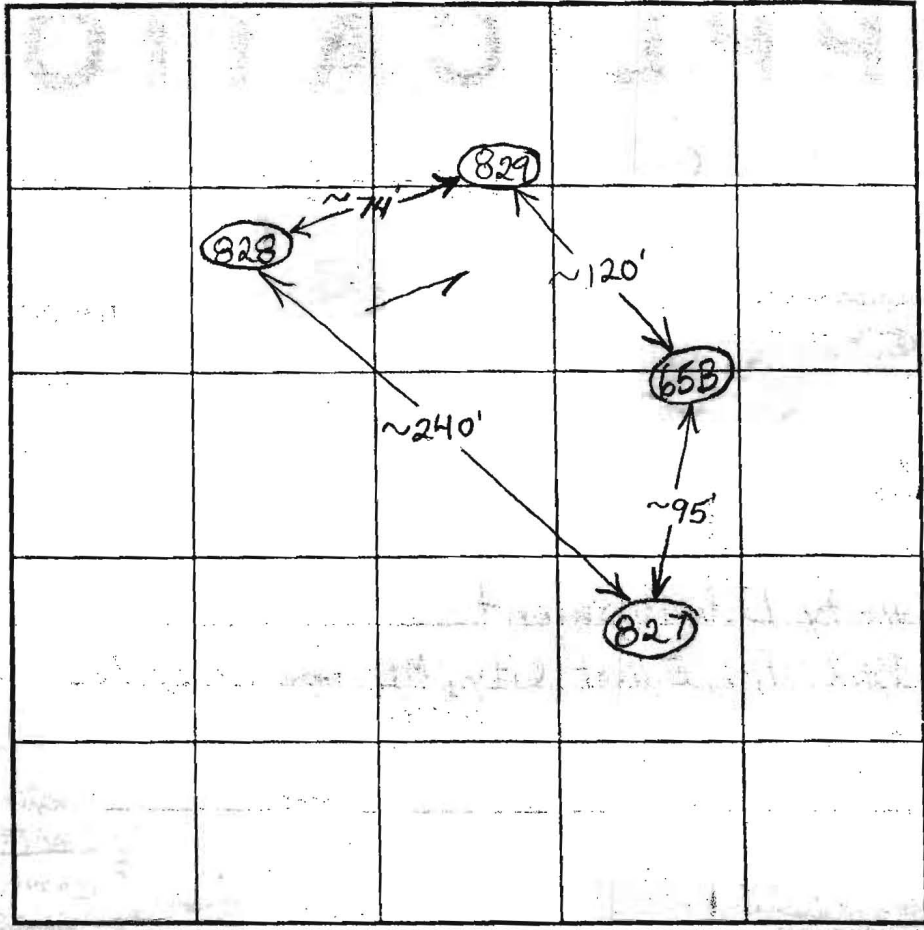

SOIL PROFILE

0' (827)

Red Br Heavy Loam and Topsoil 25'-3'

Red Br SiCl Loam 10-15% Rock 4'-5'

Red Br SiCl Loam and Sa Cl Loam ~20% Rock 5.5'-6'

Or Br Loam ~25% Rock 9'-10'

Beige Sa Loam ~25% Rock 14'

INDICATE NORTH - NAME ADJOINING ROADWAY AS BASE LINE.

DATE	TEST NO.	DEPTH	PRE-WET		TEST - 1" DROP		TIME	
			START	STOP	START	STOP		
2/17/04	828	5'4" / 14'V	12:20	12:24:30	12:24:30	12:34:30	10	O.K.
		6'8"	12:20	12:21:10	12:21:10	12:23:45	2 1/2	
	829	4.5' / 15'V	12:33:30	~ 15/16" in 25 minutes				Slow (F)
		6.5'	12:33	12:47	12:47	~ 15/16" in 30 min		slow
	65B	4.5' / 13.5'V	1:00	1:12:30	1:12:30	1:36:30	24	O.K.
		6'10"	12:53	12:56:30	12:56:30	1:05:30	9	
	827	6'2" / 14'V	1:20	~ 15/16" in 30 minutes				Slow (F)
		7'	1:21	1:37	1:37	~ 15/16" in 30 min		slow

REMARKS _____

TYPE OF SOIL _____

TESTED BY B. Baker ALSO PRESENT _____

TRENCH DESIGN DATA: AVERAGE PERCOLATION TIME _____ TRENCH WIDTH _____

INLET DEPTH _____ MAXIMUM BOTTOM DEPTH _____ SQ FT/BEDROOM _____

APPLICATION

PERCOLATION TESTING

A 516084
P _____

HOWARD COUNTY HEALTH DEPARTMENT
BUREAU OF ENVIRONMENTAL HEALTH
3525-H ELLICOTT MILLS DRIVE/ELLICOTT CITY, MARYLAND 21043
TELEPHONE: 313-2640

DISTRICT _____
DATE _____

TO: THE COUNTY HEALTH OFFICER
ELLICOTT CITY, MARYLAND

I HEREBY APPLY FOR THE NECESSARY TEST PRIOR TO APPLICATION FOR PERMIT TO CONSTRUCT (OR RECONSTRUCT) A SEWAGE DISPOSAL SYSTEM.

PROPERTY OWNER SECURITY DEVELOPMENT, L.L.C.
P.O. BOX 417
ADDRESS ELLICOTT CITY, MD 21041 PHONE 410-465-4244

AGENT OR PROSPECTIVE BUYER _____
ADDRESS _____ PHONE _____

PROPERTY LOCATION:
SUBDIVISION HOMEWOOD LOT NO. 67
ROAD AND DESCRIPTION HOMEWOOD ROAD

TAX MAP 23 & 29 PARCEL # 20 & 86
SIZE OF LOT 1 ACRE ± TYPE BLDG. SINGLE FAMILY DETACHED
(SINGLE FAMILY DWELLING OR COMMERCIAL)

THE SYSTEM INSTALLED UNDER THIS APPLICATION IS ACCEPTABLE ONLY UNTIL PUBLIC FACILITIES BECOME AVAILABLE. I FULLY UNDERSTAND THE FEE CONNECTED WITH THE FILING OF THIS PERC TEST APPLICATION IS NON-REFUNDABLE UNDER ANY CIRCUMSTANCES. I ALSO AGREE TO COMPLY WITH ALL M.O.S.H.A. REQUIREMENTS IN TESTING THIS LOT.

SECURITY DEVELOPMENT LLC
BY: [Signature] MEMBER
(SIGNATURE OF APPLICANT) STEVEN K. BISHOP

APPROVED BY _____ FOR _____ DATE _____

DISAPPROVED BY _____ FOR _____ DATE _____

HOLD PENDING FURTHER TESTS _____

REASONS FOR REJECTION OR HOLDING _____

PERCOLATION TEST PLAT/PRELIMINARY PLAT - TITLE OR I.D. # _____ DATE _____

SITE DEVELOPMENT PLAN/FINAL PLAT - TITLE OR I.D. # _____ DATE _____

THIS IS NOT A PERMIT

APPLICATION

PERCOLATION TESTING

A 516084

P _____

HOWARD COUNTY HEALTH DEPARTMENT
BUREAU OF ENVIRONMENTAL HEALTH
3525-H ELLICOTT MILLS DRIVE/ELLICOTT CITY, MARYLAND 21043
TELEPHONE: 313-2640

DISTRICT _____

DATE _____

TO: THE COUNTY HEALTH OFFICER
ELLICOTT CITY, MARYLAND

I HEREBY APPLY FOR THE NECESSARY TEST PRIOR TO APPLICATION FOR PERMIT TO CONSTRUCT (OR RECONSTRUCT) A SEWAGE DISPOSAL SYSTEM.

PROPERTY OWNER SECURITY DEVELOPMENT, L.L.C.
P.O. BOX 417
ADDRESS ELLICOTT CITY, MD 21041 PHONE 410-465-4244

AGENT OR PROSPECTIVE BUYER _____
ADDRESS _____ PHONE _____

PROPERTY LOCATION:
SUBDIVISION HOMEWOOD LOT NO. 66
ROAD AND DESCRIPTION HOMEWOOD ROAD

TAX MAP 23 & 29 PARCEL # 20 & 86
SIZE OF LOT 1 ACRE ± TYPE BLDG. SINGLE FAMILY DETACHED
(SINGLE FAMILY DWELLING OR COMMERCIAL)

THE SYSTEM INSTALLED UNDER THIS APPLICATION IS ACCEPTABLE ONLY UNTIL PUBLIC FACILITIES BECOME AVAILABLE. I FULLY UNDERSTAND THE FEE CONNECTED WITH THE FILING OF THIS PERC TEST APPLICATION IS NON-REFUNDABLE UNDER ANY CIRCUMSTANCES. I ALSO AGREE TO COMPLY WITH ALL M.O.S.H.A. REQUIREMENTS IN TESTING THIS LOT.

SECURITY DEVELOPMENT LLC
BY: [Signature]
(SIGNATURE OF APPLICANT) STEVEN K BIRBAUM

APPROVED BY _____ FOR _____ DATE _____

DISAPPROVED BY _____ FOR _____ DATE _____

HOLD PENDING FURTHER TESTS _____

REASONS FOR REJECTION OR HOLDING _____

PERCOLATION TEST PLAT/PRELIMINARY PLAT - TITLE OR I.D. # _____ DATE _____

SITE DEVELOPMENT PLAN/FINAL PLAT - TITLE OR I.D. # _____ DATE _____

THIS IS NOT A PERMIT

516084

COUNTY #

SOIL PROFILE

(66E)

Strong
brn
hvy cl
Lm

black
bluish
wk org brn
white
y brn
micaceous
SAND

micaceous
Hard Qtz
saprolite

Water 14'

(66D)

Red Br
Heavy Loam

3.5'

Med Br
Dense
Micaceous
SaLoam

~5%
Rock

(66C)

Red Br
Heavy Loam

2'-3' 5'

Light Br
Sa Loam

2'-3' Wide
Vein of

30-40%
Quartz
Fragments

3.5' to
Bottom

~10% Rock
Overall

14'

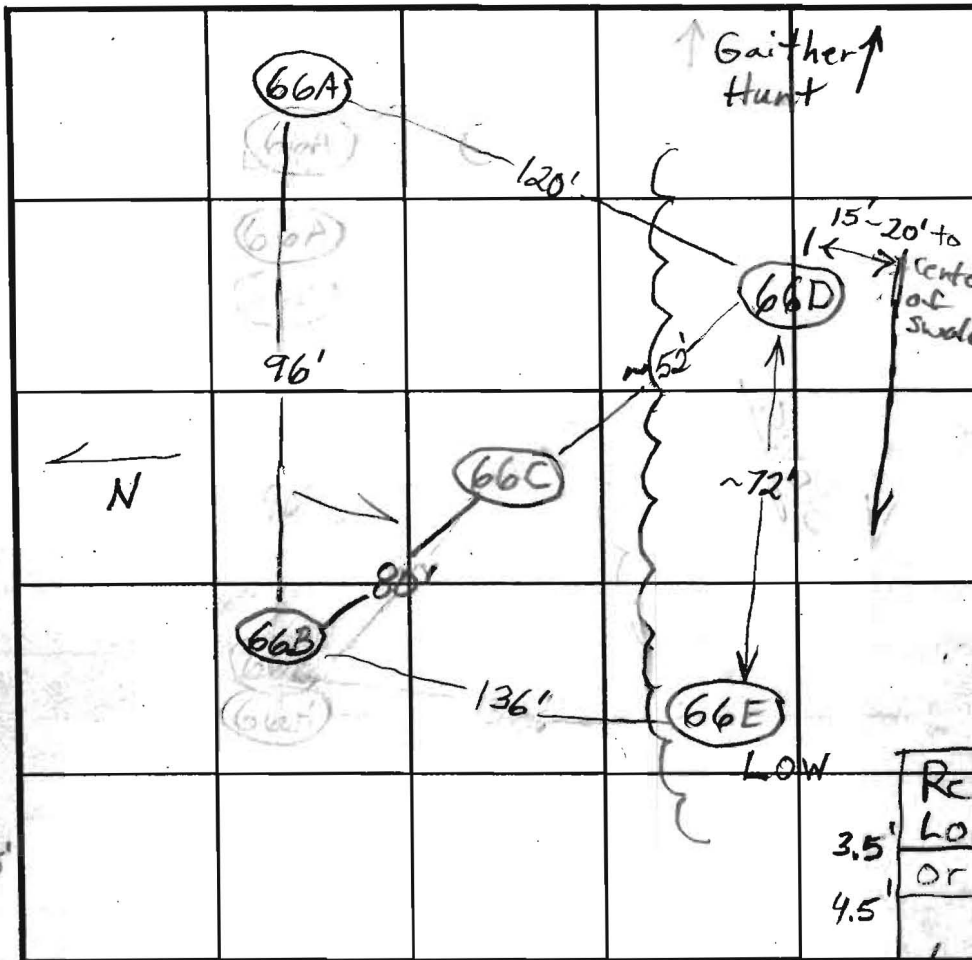

SOIL PROFILE

(66B)

Red Br
Heavy Loam

4'
H brn
Loamy
Sand-
Sand

5%
Rock

14'

(66A)

Red Br Heavy
Loam

3.5'

Or Br Loam

4.5'

Tan Sa
Loam 5-10%
Saprolite

14'

INDICATE NORTH - NAME ADJOINING ROADWAY AS BASE LINE.

DATE	TEST NO.	DEPTH	PRE-WET		TEST - 1' DROP		TIME	
			START	STOP	START	STOP		
7-16-02	66E	5' / 14'	10:25					WS
	Repour	6' 2"	10:28:30	10:30	10:30	10:32	2	
	66D	5' / 15' V	10:44:30	10:45	10:45	10:52	7	WS
		7'	10:44	10:46	10:46	10:54:30	8 1/2	
	66C	4' / 14' V	11:03	11:05:30	11:05:30	11:12	6 1/2	O.K.
		6' 3"	10:54:30	10:56	10:56	10:58:30	~3	
	66B	5' / 14' V	11:24:10	11:28	11:28	11:36	8	OK
		7.5'	11:10:15	11:12	11:12	11:14:40	2 1/2	
	66A	6' 10" / 14' V	11:41:45	11:43:15	11:43:15	11:45:45	2 1/2	OK
		4' 2"	11:45:45	11:57	11:57	7' 8" in	30 min	

REMARKS Holes Dug Per Plan 66E+66D are Wet Season

TYPE OF SOIL _____

TESTED BY B. Baker / K. Noonan ALSO PRESENT Hatfields

TRENCH DESIGN DATA: AVERAGE PERCOLATION TIME _____ TRENCH WIDTH _____

INLET DEPTH _____ MAXIMUM BOTTOM DEPTH _____ SQ. FT./BEDROOM _____

E103

LOT 61
151,793 S.F.

70-D
440.8

83-B
448.6

83-C
445.2

83-D
444.5

84-A
439.8

84-B
435.0

84-C
434.15

85-A
431.6

85-B
430.8

85-C
427.1

85-D
427.1

85-E
425.6

86-A
422.5

86-B
420.5

86-C
420.7

87-A
418.4

87-B
417.6

87-C
418.1

88-A
414.9

88-B
415.1

88-C
413.3

88-D
413.6

89-A
409.7

89-B
409.5

89-C
406.7

89-D
409.5

89-E
404.0

LOT 60
43,423 S.F.
COMMUNITY SEPTIC LOT

69-A
429.6

69-B
429.8

69-C
424.0

69-D
422.4

69-E
421.3

69-F
420.6

69-G
418.6

69-H
418.6

69-I
418.6

69-J
418.6

69-K
418.6

69-L
418.6

69-M
418.6

69-N
418.6

69-O
418.6

69-P
418.6

69-Q
418.6

69-R
418.6

69-S
418.6

69-T
418.6

69-U
418.6

69-V
418.6

69-W
418.6

69-X
418.6

69-Y
418.6

69-A
429.6

69-B
429.8

69-C
424.0

69-D
422.4

69-E
421.3

69-F
420.6

69-G
418.6

69-H
418.6

69-I
418.6

69-J
418.6

69-K
418.6

69-L
418.6

69-M
418.6

69-N
418.6

69-O
418.6

69-P
418.6

69-Q
418.6

69-R
418.6

69-S
418.6

69-T
418.6

69-U
418.6

69-V
418.6

69-W
418.6

69-X
418.6

69-Y
418.6

Mgc3

Chc3

Chc3

Chp3

Chc3

EnB2

EnB2

EnB2

CASTLEBRIDGE ROAD
EX. PUBLIC MINOR COLLECTOR
(50' R/W, 24' PAVING, F-04-B2)

CASTLEBRIDGE ROAD

Signed per cert
1/22/07