

4/15/85  
11:30 AM

OS-357357

approved  
4/15/85

# PERMIT

P 35247  
A REPAIR

SEWAGE DISPOSAL SYSTEM

MARYLAND STATE DEPARTMENT OF HEALTH\*

HOWARD COUNTY  
BUREAU OF ENVIRONMENTAL HEALTH  
992-2330

ELLICOTT CITY  
DISTRICT \_\_\_\_\_

INDEXED

DATE 4/4/85

Arnold Septic Tank Service IS PERMITTED TO INSTALL \_\_\_\_\_ ALTER

ADDRESS Jacobs Road, Mt. Airy, Maryland 21771 PHONE 795-7873

SUBDIVISION Cisrel Farms ROAD 6910 Deer Valley LOT 10-1

PROPERTY OWNER Oliver J. Lawless

ADDRESS 6910 Deer Valley Road  
Highland, Maryland 21771

IF GARBAGE GRINDER IS USED INCREASE SEPTIC TANK CAPACITY BY 50% AND ABSORPTION AREA BY 22%.

GARBAGE GRINDER? YES \_\_\_\_\_ NO \_\_\_\_\_

SEPTIC TANK CAPACITY \_\_\_\_\_ GALLONS NUMBER OF BEDROOMS \_\_\_\_\_

6x6  
390

REPAIR - CALL FOR INSPECTION WHEN GROUND IS OPENED UP SO SANITARIAN CAN RECOMMEND REPAIR.

REPAIR TO FIX FAILING SYSTEM WAS CONDITION OF SALE OF PROPERTY.

SOIL GOOD 4-14' - INSTALL 60' TRENCH w/ 6' STONE. CW

PLANS APPROVED BY Craig Williams DATE 4/3/85

COVER NO WORK UNTIL INSPECTED AND APPROVED.

NEITHER THE HOWARD COUNTY COUNCIL NOR THE HEALTH DEPARTMENT IS RESPONSIBLE FOR THE SUCCESSFUL OPERATION OF ANY SYSTEM.

NOTE: IF TRENCH IS USED CALL FOR INSPECTION BEFORE AND AFTER PLACING GRAVEL IN TRENCH.

NOTE: NO DRY WELL SHALL EXCEED 15 FOOT IN DIAMETER. NO ABSORPTION TRENCH TO EXCEED 100 FEET IN LENGTH.

NOTE: ALL PIPE FROM HOUSE TO SEPTIC TANK MUST BE CAST IRON OR SCHEDULE 40 PVC OR ABS.

PERMIT VOID AFTER THREE YEARS.

NOTE: INSTALL STAND PIPE ON SEPTIC TANK AND DRY WELL. STAND PIPES MUST BE 6 INCHES IN DIAMETER. CAST IRON, CONCRETE OR TERRA COTTA, OR PVC OR ABS ACCEPTED. IF TOP OF SEPTIC TANK IS DEEPER THAN 3 FEET MANHOLE TO GRADE REQUIRED.

**\*INSTALLER IS RESPONSIBLE FOR OBTAINING FINAL APROVAL ON THIS PERMIT**

\*CALL 992-2330 FOR INSPECTION OF SEPTIC SYSTEMS.

EH - 2-1082

P 35247

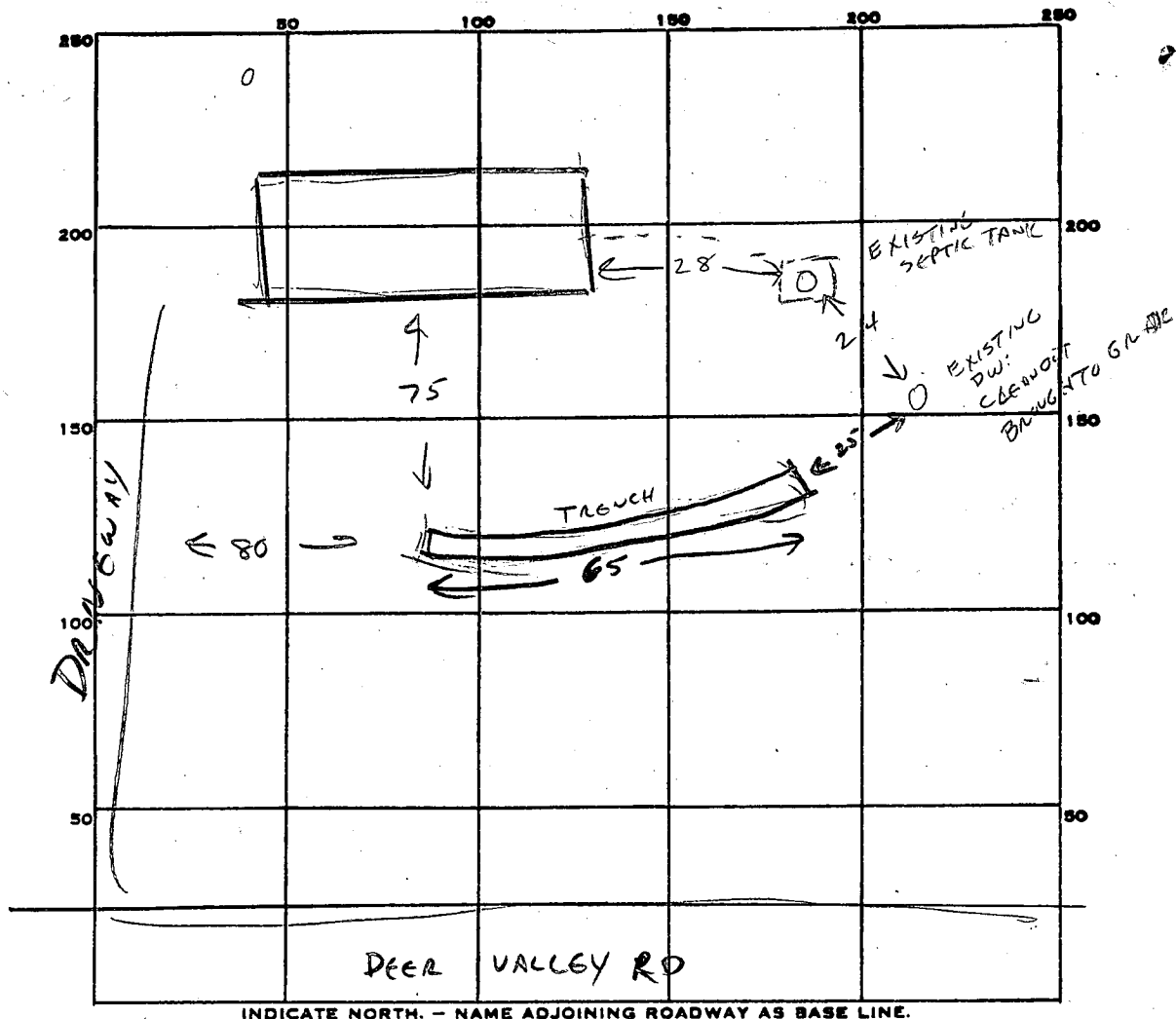

INDICATE NORTH. - NAME ADJOINING ROADWAY AS BASE LINE.

PERMIT CARD

SEPTIC TANK, LEVEL EXISTING

CLEANOUTS \_\_\_\_\_

DISTRIBUTION BOX, LEVEL \_\_\_\_\_

TILE FIELD, DEPTH 10 FT. TRENCH WIDTH 2 FT.

GRAVEL DEPTH 6 FT TOTAL LENGTH 65 FT.

NUMBER OF TRENCHES 1 ONE SIDEWALL TOTAL BOTTOM AREA 390

SEEPAGE PITS, INSIDE DIAMETER \_\_\_\_\_ FT. DEPTH BELOW INLET \_\_\_\_\_ FT.

ABSORBENT AREA 390 SQ. FT. + EXISTING DW.

REMARKS \_\_\_\_\_

\_\_\_\_\_  
 \_\_\_\_\_  
 \_\_\_\_\_  
 \_\_\_\_\_

DATE SYSTEM APPROVED

4/15/85

INSPECTOR

C. Williams