

11/10/92
11/13/92 10:30
10:00 + 12:30
No inspection
per supervisor

01/12 (3) P.C.O.
C.B.S.

PERMIT

SEWAGE DISPOSAL SYSTEM

DEPARTMENT OF HEALTH AND MENTAL HYGIENE

HOWARD COUNTY HEALTH DEPARTMENT
BUREAU OF ENVIRONMENTAL HEALTH

461-8933 313-2640

INDEXED

05-40012

P 48592

A 26619

DISTRICT 5th

DATE 10/3/92

DATE SYSTEM APPROVED 11/16/92

INSPECTOR C.W. [Signature]

Paul Schissler/South Carroll Backhoe IS PERMITTED TO INSTALL ALTER

ADDRESS 4410 Salem Bottom Road, Westminster, Maryland 21157 PHONE 875-4197

SUBDIVISION Dayton Meadows LOT 12 ROAD 13814 Dayton Meadows Court

PROPERTY OWNER Trinity Builders

ADDRESS

SEPTIC TANK CAPACITY 1500 GALLONS

NUMBER OF BEDROOMS 5

220 SQUARE FEET PER BEDROOM

LINEAR FEET OF TRENCH REQUIRED 275

TRENCHES - Trench to be 2 feet wide. Inlet 4 1/2 feet below original grade. Bottom maximum depth 8 1/2 feet below original grade. Effective area begins at 4 1/2 feet below original grade. 4 feet of stone below distribution pipe.

LOCATION - Beginning from the left front lot corner, place 1st trench 120 feet down the left (375') lot line and 190 feet off the left line as seen when facing property from Dayton Meadows Court. Run trenches along contour towards the front (450') lot line.

NOTES - No trench to exceed 100 feet in length. Provide 6" - 8" diameter cleanout and cap to grade or above on septic tank. OK 01/26/92 RH

PLANS APPROVED BY Bert Nixon DATE 6/25/87

COVER NO WORK UNTIL INSPECTED AND APPROVED

NEITHER THE HOWARD COUNTY COUNCIL NOR THE HEALTH DEPARTMENT IS RESPONSIBLE FOR THE SUCCESSFUL OPERATION OF ANY SYSTEM

NOTE: CLEANOUT REQUIRED EVERY 70 FEET OF SEWER LINE AND/OR AT 90° SWEEPS IN LINES FROM HOUSE TO DRAIN FIELDS, 90° ELBOWS NOT ACCEPTABLE.

NOTE: ALL PARTS OF SEPTIC SYSTEMS (I.E. TANK, DISTRIBUTION BOX TRENCHES) TO BE 100 FEET FROM WELL (UNLESS OTHERWISE SPECIFICALLY AUTHORIZED)

NOTE: IF DEEP TRENCH(ES) ARE USED CALL FOR INSPECTION BEFORE AND AFTER PLACING GRAVEL IN TRENCH(ES)

NOTE: NO DRY WELL SHALL EXCEED 15 FOOT IN DIAMETER NO ABSORPTION TRENCH TO EXCEED 100 FEET IN LENGTH

NOTE: ALL PIPE FROM HOUSE TO SEPTIC TANK MUST BE CAST IRON OR SCHEDULE 35/40 PVC OR ABS

PERMIT VOID AFTER TWO YEARS

NOTE: INSTALL STAND PIPE ON SEPTIC TANK AND DRY WELL STAND PIPES MUST BE 6 INCHES IN DIAMETER CAST IRON. CONCRETE OR TERRA COTTA OR PVA OR ABS ACCEPTED. IF TOP OF SEPTIC TANK IS DEEPER THAN 3 FEET. MANHOLE TO GRADE REQUIRED.

NOTE: DISTRIBUTION BOXES MUST HAVE BAFFLES

***INSTALLER IS RESPONSIBLE FOR OBTAINING FINAL APPROVAL ON THIS PERMIT**

HD-260(6-90)

***CALL 461-8933 FOR INSPECTION OF SEPTIC SYSTEM.**

A 26619

HOWARD ROAD

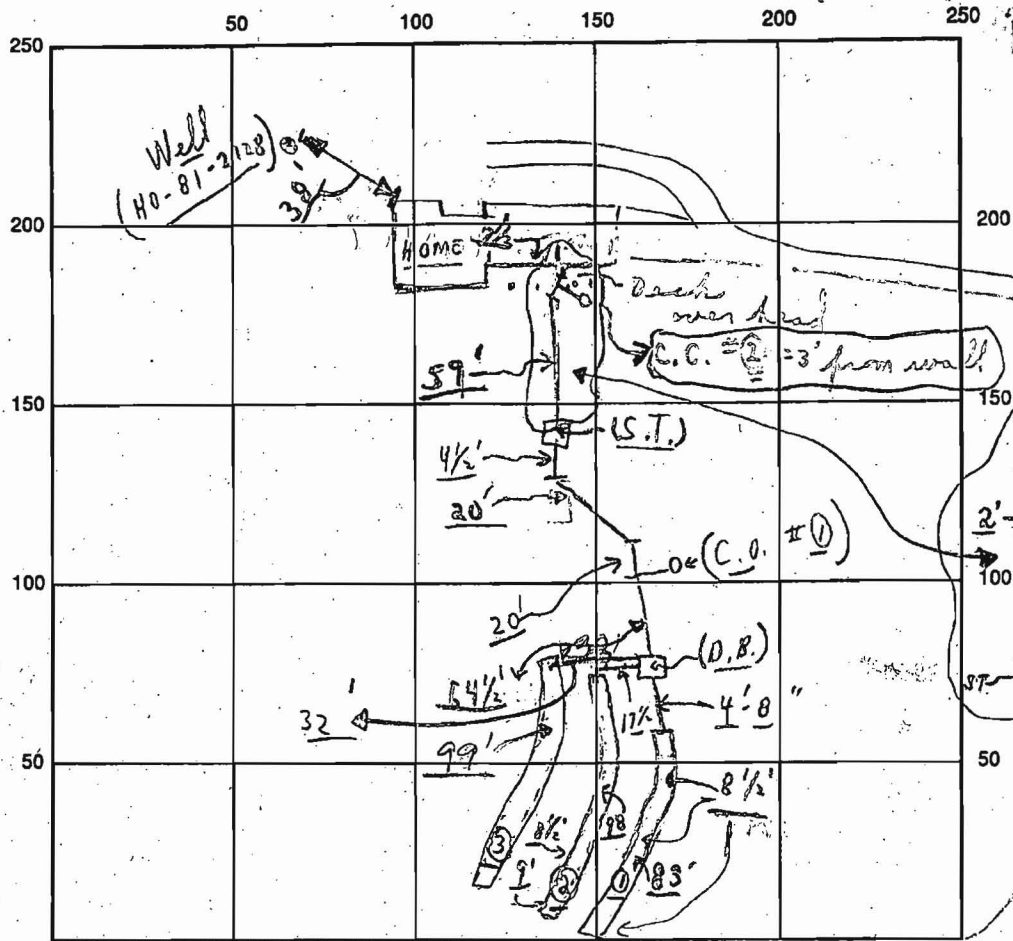

INDICATE NORTH - NAME ADJOINING ROADWAY AS BASE LINE

DAYTON MEADOWS COURT S.T. CO.#1 C.O.#3

SEPTIC TANK LEVEL OK CLEANOUTS OK CO.#1 OK C.O.#3 OK

DISTRIBUTION BOX LEVEL OK (Baffles in in) Near house

DRAIN FIELD/TITLE DEPTH 8 1/2 FT. TRENCH WIDTH 2 FT. INLET DEPTH 4 1/2 FT.

EFFECTIVE GRAVEL DEPTH 4 + FT. TOTAL LENGTH 280 FT. (83+98+99) 280

NUMBER OF TRENCHES 3 ONE SIDEWALL/BOTTOM AREA 1120 SQ. FT. 4
1120

DRYWALL INSIDE DIAMETER — FT. EFFECTIVE DEPTH BELOW INLET — FT.

ABSORBENT AREA — SQ. FT.

REMARKS: 9.A.M. 11/12/92 (1) ok to continue # (1) Trench as reworked; partial Early P.M. Partial ok for stones, etc. in # (1) trench oil to cover from house to dist. look only; C.B.D. (HOLD FOR A CALL)

11/12 LATE P.M. - # (2) Trench ok to finish & cover from D. Box to # (2) Trench; partial; C.B.D. (Need to see (3) trench & pipes to same from 2nd trench)

11/13/92 OK TO FINISH FINAL TRENCH & COVER WITHOUT INSP. C.D.

DATE SYSTEM APPROVED 11/13/92 INSPECTOR Craig Well

I certify that trench # 3 is 99 FT. long, 4 FT + OF stone
Ken Schuel

6/25/84
SUBDIVISION:

DAYTON MEADOWS
DAYTON MEADOWS CT.
SEC 1 AREA 1
DRY WELL OR DRY WELL AND TRENCH

A 26619

LOT NUMBER: 12

_____ sq. ft./bedroom

	Septic Tank	Minimum Total Square Feet
3 bedroom	1000 gallon	_____
4 bedroom	1250 gallon	_____
5 bedroom	1500 gallon	_____

Inlet _____ feet below original grade.
 Bottom maximum depth _____ feet below original grade.
 Effective area begins at _____ feet below original grade.

NOTE: If trench is used to make up absorbent area, run the trench on level ground and leave a 5-foot earth buffer between dry well and trench. No trench is to exceed 100 feet in length. Trench inlet to be same as dry well, with _____ feet of stone below distribution pipe.

TRENCHES

220 sq. ft./bedroom
 55 LINEAR FT 1 BEDROOM
 220 LINEAR FT
 PER 4 BEDROOMS

Trench to be 2 wide.
 Inlet 4 1/2 feet below original grade.
 Bottom maximum depth 8 1/2 feet below original grade.
 Effective area begins at 4 1/2 feet below original grade.
4 feet of stone below distribution pipe.

- NOTE:
- (1) No trench to exceed 100 feet in length.
 - (2) If more than one trench used, a distribution box is required.
 - (3) Trenches to be installed on level ground.
 - (4) Call for inspection of trench before gravel is installed.
 - (5) Provide 6" - 8" diameter cleanout and cap to grade or above on septic tank and drywell.
 - (6) If a garbage disposal is used, increase septic tank capacity by 50% and increase absorbent sidewall area by 22%.

LOCATION: BEGINNING FROM THE LEFT FRONT LOT CORNER
 PLACE 1ST TRENCH 120' DOWN THE LEFT (375') LOT LINE
 AND 190' OFF THE LEFT LINE AS SEEN WHEN FACING
 PROPERTY FROM DAYTON MEADOWS CT. RUN TRENCHES
 ALONG CONTOUR TOWARDS THE FRONT (450') LOT LINE.