

APPLICATION

66 68 69
67

PERCOLATION TESTING

A 518964-Q

F _____

HOWARD COUNTY HEALTH DEPARTMENT
BUREAU OF ENVIRONMENTAL HEALTH
3525-H ELLICOTT MILLS DRIVE/ELLICOTT CITY, MARYLAND 21043
TELEPHONE: 313-2640

DISTRICT 4TH

DATE 5/13/03
5/22/03

TO: THE COUNTY HEALTH OFFICER
ELLICOTT CITY, MARYLAND

I HEREBY APPLY FOR THE NECESSARY TEST PRIOR TO APPLICATION FOR PERMIT TO CONSTRUCT (OR RECONSTRUCT) A SEWAGE DISPOSAL SYSTEM.

PROPERTY OWNER EDGEWOOD FARM, INC.

ADDRESS 14919 ROXBURY RD GLENELG MD 21737 PHONE _____

AGENT OR PROSPECTIVE BUYER TOLL BROTHERS, INC.

ADDRESS 7164 COLUMBIA GATEWAY DR SUITE 230
COLUMBIA, MD 21046 PHONE (410) 872-9105

PROPERTY LOCATION:

SUBDIVISION EDGEWOOD FARM LOT NO. 1720

ROAD AND DESCRIPTION ROXBURY RD

TAX MAP 21 PARCEL # 90

SIZE OF LOT 1 Ac ± TYPE BLDG. SINGLE FAMILY
(SINGLE FAMILY DWELLING OR COMMERCIAL)

THE SYSTEM INSTALLED UNDER THIS APPLICATION IS ACCEPTABLE ONLY UNTIL PUBLIC FACILITIES BECOME AVAILABLE. I FULLY UNDERSTAND THE FEE CONNECTED WITH THE FILING OF THIS PERC TEST APPLICATION IS NON-REFUNDABLE UNDER ANY CIRCUMSTANCES. I ALSO AGREE TO COMPLY WITH ALL M.O.S.H.A. REQUIREMENTS IN TESTING THIS LOT.

Bruce R. Oyley
BRUCE R. OYLEY (SIGNATURE OF APPLICANT)

APPROVED BY _____ FOR _____ DATE _____

DISAPPROVED BY _____ FOR _____ DATE _____

HOLD PENDING FURTHER TESTS _____

REASONS FOR REJECTION OR HOLDING _____

PERCOLATION TEST PLAT/PRELIMINARY PLAT - TITLE OR I.D. # _____ DATE _____

SITE DEVELOPMENT PLAN/FINAL PLAT - TITLE OR I.D. # _____ DATE _____

THIS IS NOT A PERMIT

518964

COUNTY #

SOIL PROFILE

70

DL Brown
Lm

Yellow
Brown
Clay Lm

Brown
S.lm
Ls 90
Rock

1'
2'
13'

SOIL PROFILE

(66)

Topsoil
Str red
Yellow
s.lm
Rx ~ 5-10%

2' brn
fine
sand
s.g.
Trace
Rx

13 1/2'
Bottom



INDICATE NORTH - NAME ADJOINING ROADWAY AS BASE LINE.

(67) (68)

MED Brn
SBK Lm
with Clay
SKINS
& roots

Med
S.lm
S.g.

Med
S.lm
S.g.

Sand. Fine
wk platy
Struct.

Refusal

Brn
CL Lm
Sbk Structure
roots

Brown
crumbly
structure
CL Lm

Str. org
Lm si +
Lms

ybrn wk
org sand
some wk.
Platy
structure
+ Rx frags
10-15%
Bottom

10'
3'
5 1/2'
12'
1-1 1/2'
2 1/2-3'
4 1/2'
13 1/2'

DATE	TEST NO.	DEPTH	PRE-WET		TEST - 1" DROP		TIME
			START	STOP	START	STOP	
7/9/03	69	5 1/2' S	9:02	9:04	9:04	9:06	2min P
		13 1/2' B					
	67	5' S	9:08	9:10	9:10	9:13	3min OK
	68	5' R	@ 6:37	wk Flagstone			
	68	5 1/2' S	9:13 ⁴⁵	9:16 ⁵⁰	9:16 ⁵⁰	9:20	3 min OK
	70	4 1/2' B	12:19	12:22	12:22	12:25	3min
	66	5' S	10:41	10:44	10:44	10:46	2min P

REMARKS: Holes dug per plan field-locate dirt road

TYPE OF SOIL: _____

TESTED BY: FA + KN ALSO PRESENT: Bob S.

TRENCH DESIGN DATA: AVERAGE PERCOLATION TIME _____ TRENCH WIDTH _____

INLET DEPTH _____ MAXIMUM BOTTOM DEPTH _____ SQ. FT./BEDROOM _____

APPLICATION

60 59 58
57

PERCOLATION TESTING

A 5189640

F _____

HOWARD COUNTY HEALTH DEPARTMENT
BUREAU OF ENVIRONMENTAL HEALTH
3525-H ELLICOTT MILLS DRIVE/ELLICOTT CITY, MARYLAND 21043
TELEPHONE: 313-2640

DISTRICT 4TH

DATE 5/13/03
5/28/03

TO: THE COUNTY HEALTH OFFICER
ELLICOTT CITY, MARYLAND

I HEREBY APPLY FOR THE NECESSARY TEST PRIOR TO APPLICATION FOR PERMIT TO CONSTRUCT (OR RECONSTRUCT) A SEWAGE DISPOSAL SYSTEM.

PROPERTY OWNER EDGEWOOD FARM, INC.

ADDRESS 14919 ROXBURY RD GLENELG MD 21737 PHONE _____

AGENT OR PROSPECTIVE BUYER TOLL BROTHERS, INC.

7164 COLUMBIA GATEWAY DR SUITE 230
ADDRESS COLUMBIA, MD 21046 PHONE (410) 872-9105

PROPERTY LOCATION:

SUBDIVISION EDGEWOOD FARM LOT NO. 1518

ROAD AND DESCRIPTION ROXBURY RD

TAX MAP 21 PARCEL # 20

SIZE OF LOT 1 Ac ± TYPE BLDG. SINGLE FAMILY
(SINGLE FAMILY DWELLING OR COMMERCIAL)

THE SYSTEM INSTALLED UNDER THIS APPLICATION IS ACCEPTABLE ONLY UNTIL PUBLIC FACILITIES BECOME AVAILABLE. I FULLY UNDERSTAND THE FEE CONNECTED WITH THE FILING OF THIS PERC TEST APPLICATION IS NON-REFUNDABLE UNDER ANY CIRCUMSTANCES. I ALSO AGREE TO COMPLY WITH ALL M.O.S.H.A. REQUIREMENTS IN TESTING THIS LOT.

Bruce R. O'Neil
BRUCE R. O'NEIL (SIGNATURE OF APPLICANT)

APPROVED BY _____ FOR _____ DATE _____

DISAPPROVED BY _____ FOR _____ DATE _____

HOLD PENDING FURTHER TESTS _____

REASONS FOR REJECTION OR HOLDING _____

PERCOLATION TEST PLAT/PRELIMINARY PLAT - TITLE OR I.D. # _____ DATE _____

SITE DEVELOPMENT PLAN/FINAL PLAT - TITLE OR I.D. # _____ DATE _____

THIS IS NOT A PERMIT

518964

COUNTY #

SOIL PROFILE

0' 60

6'

7'

12' HB

6m
clay
wk red
Lmsi
Qtz frags
~5%
yellow
SAND
30-40%
RX

(50)

12'

5'

line
D
SAND
BRN

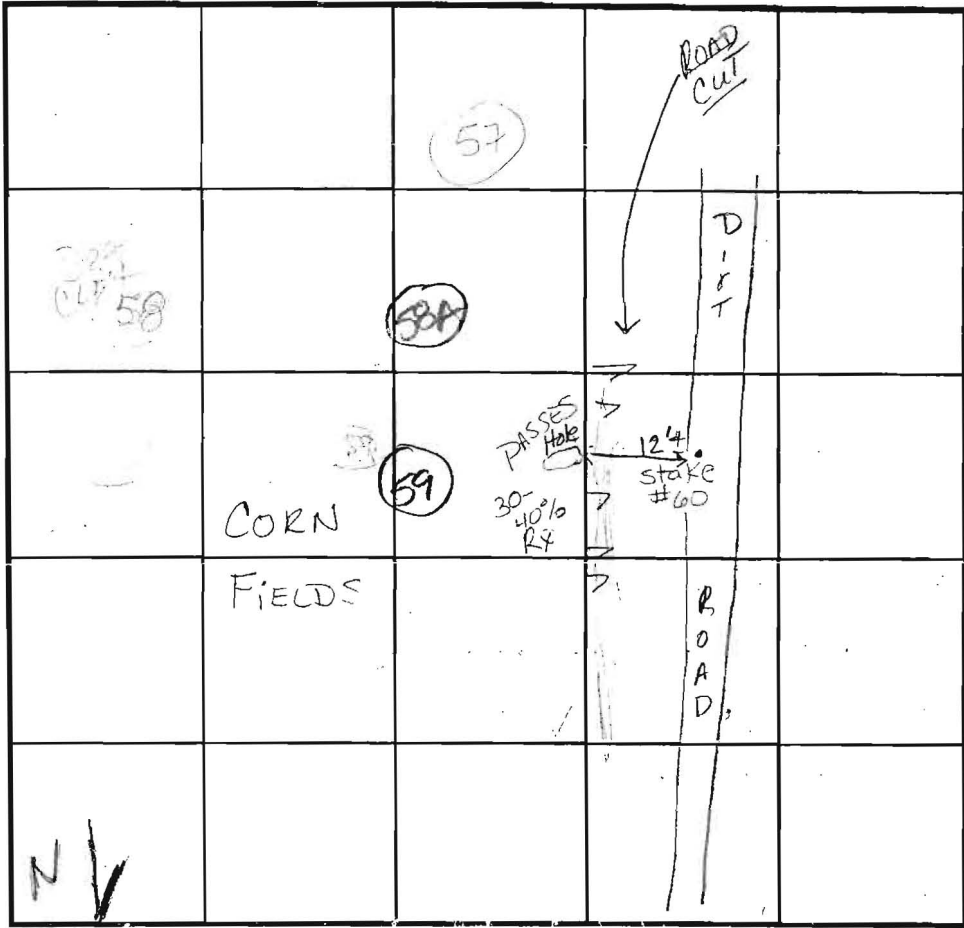

SOIL PROFILE

0' (57)

6-7 1/2'

13'

NE Lm SW

1/6' long

majenta
s'Lm
trace
RX
Bottom

58A

Brown
Clay loam 4 1/2-5'

Brown
Silty
loam 6 1/2'

Brown
Silt loam 8'

Loamy
Sand 13'

INDICATE NORTH - NAME ADJOINING ROADWAY AS BASE LINE.

DATE	TEST NO.	DEPTH	PRE-WET		TEST - 1" DROP		TIME	
			START	STOP	START	STOP		
7-9-03	60	7'M	10:26	10:30	10:30	10:36	6 min P	
		TESTED	in Tx zone					
	59	5'M	1:35	1:40	1:40	1:46	6 min P	
	58	8'	1:58	2:16	only moved 1/8"		(F)	
	57	8'	2:06	2:12 ¹⁰	2:12 ¹⁰	2:24	12 min	
3/10/03	58A	6' / 13'	8:31	8:36	8:36	8:43	7 min	
(See lot 14 for description)								

REMARKS Hole #60 dug in cornfield, 12' ± from stake

TYPE OF SOIL _____

TESTED BY KN/FA ALSO PRESENT Bob S.

TRENCH DESIGN DATA: AVERAGE PERCOLATION TIME _____ TRENCH WIDTH _____

INLET DEPTH _____ MAXIMUM BOTTOM DEPTH _____ SQ. FT/BEDROOM _____

APPLICATION

65 64
63
62 61

PERCOLATION TESTING

A 518964P

F _____

HOWARD COUNTY HEALTH DEPARTMENT
BUREAU OF ENVIRONMENTAL HEALTH
3525-H ELLICOTT MILLS DRIVE/ELLICOTT CITY, MARYLAND 21043
TELEPHONE: 313-2640

DISTRICT 4TH

DATE 5/13/03
5/22/03

TO: THE COUNTY HEALTH OFFICER
ELLICOTT CITY, MARYLAND

I HEREBY APPLY FOR THE NECESSARY TEST PRIOR TO APPLICATION FOR PERMIT TO CONSTRUCT (OR RECONSTRUCT) A SEWAGE DISPOSAL SYSTEM.

PROPERTY OWNER EDGEWOOD FARM, INC.

ADDRESS 14919 ROXBURY RD GLENELG MD 21737 PHONE _____

AGENT OR PROSPECTIVE BUYER TOLL BROTHERS, INC.

ADDRESS 7164 COLUMBIA GATEWAY DR SUITE 230
COLUMBIA, MD 21046 PHONE (410) 872-9105

PROPERTY LOCATION:

SUBDIVISION EDGEWOOD FARM LOT NO. 20

ROAD AND DESCRIPTION ROXBURY RD

TAX MAP 21 PARCEL # 20

SIZE OF LOT 1 Ac ± TYPE BLDG. SINGLE FAMILY
(SINGLE FAMILY DWELLING OR COMMERCIAL)

THE SYSTEM INSTALLED UNDER THIS APPLICATION IS ACCEPTABLE ONLY UNTIL PUBLIC FACILITIES BECOME AVAILABLE. I FULLY UNDERSTAND THE

FEE CONNECTED WITH THE FILING OF THIS PERC TEST APPLICATION IS NON-REFUNDABLE UNDER ANY CIRCUMSTANCES. I ALSO AGREE TO

COMPLY WITH ALL M.O.S.H.A. REQUIREMENTS IN TESTING THIS LOT. Bruce R. O'Neil
BRUCE R. O'NEIL (SIGNATURE OF APPLICANT)

APPROVED BY _____ FOR _____ DATE _____

DISAPPROVED BY _____ FOR _____ DATE _____

HOLD PENDING FURTHER TESTS _____

REASONS FOR REJECTION OR HOLDING _____

PERCOLATION TEST PLAT/PRELIMINARY PLAT - TITLE OR I.D. # _____ DATE _____

SITE DEVELOPMENT PLAN/FINAL PLAT - TITLE OR I.D. # _____ DATE _____

THIS IS NOT A PERMIT

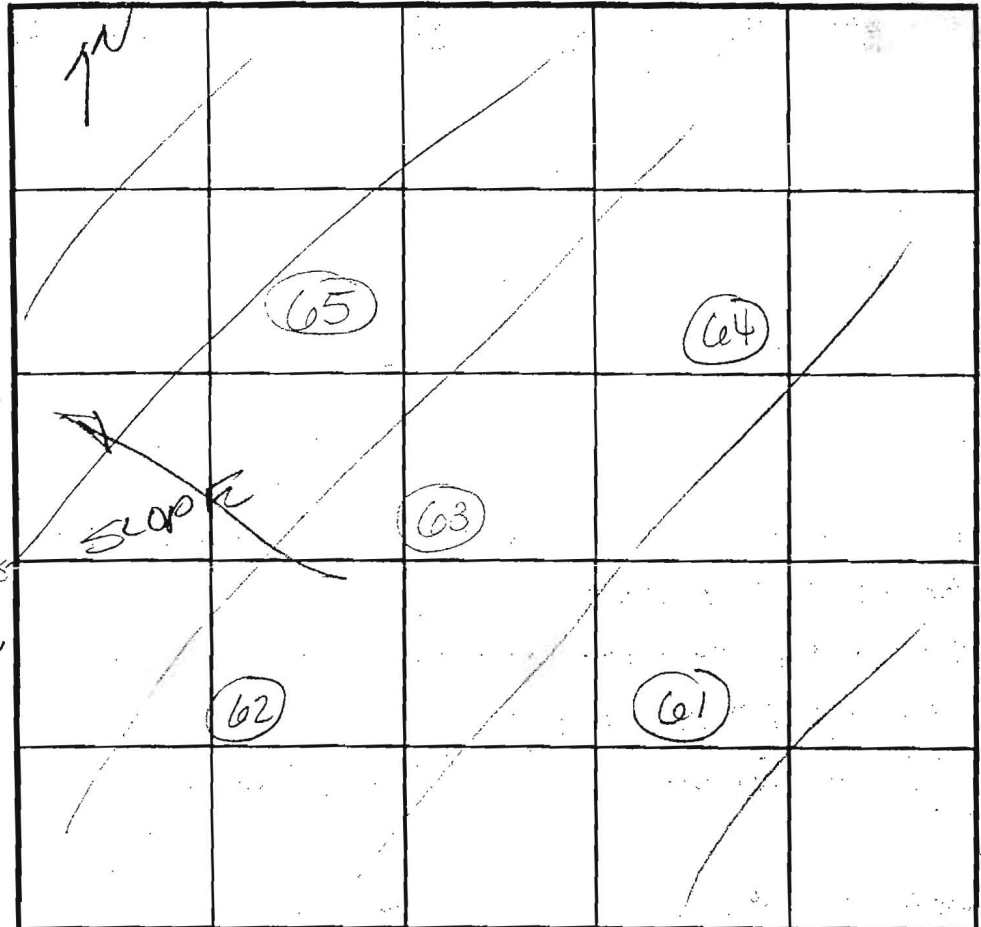

INDICATE NORTH - NAME ADJOINING ROADWAY AS BASE LINE.

SOIL PROFILE
65
0' Brn SbK Lm WITH CLAY SKINS
1 1/2' Wkd CL Lm
E 4 1/2' Strong yellow Lm si s.g. fine
4 1/2' yellow fine Lm S to S
11 1/2' Refusal

Trace Rx 65
8" DE Brown LOAM
2' Red Clay loam
Yellow Brown Ss loam
1590 ROCK
HARD BOTTOM 11'

62
8' DE BROWN LOAM
1 1/2' Red Brown Si Clay loam
Yellow Brown Ss loam
1590 ROCK

SOIL PROFILE
61
0' DE Brown LOAM
1 1/2' Orange Brown Si Clay loam
2' Brown-Red Brown Ss loam
1590 ROCK

64
1' DE BROWN LOAM
1' Red Brown Si Clay loam
4' Brown/Yellow Brown Ss loam
2'

DATE	TEST NO.	DEPTH	PRE-WET		TEST - 1" DROP		TIME	
			START	STOP	START	STOP		
7/9/03	63	5 1/2' / 11'	9:48	9:51	9:51	9:55	4mins	P
	65	5' / 11 1/2'	9:58	10:00	10:00	10:04	4mins	P
	62	5' / 13'	10:00	10:06	10:06	10:11	5mins	P
	61	5' / 13'	10:15	10:17	10:17	10:21	4mins	P
	64	5' / 12'	9:40	9:43	9:43	9:47	4mins	P

REMARKS _____
 TYPE OF SOIL _____
 TESTED BY FA/KN ALSO PRESENT Rob S. Johnson
 TRENCH DESIGN DATA: AVERAGE PERCOLATION TIME _____ TRENCH WIDTH _____
 INLET DEPTH _____ MAXIMUM BOTTOM DEPTH _____ SQ. FT/BEDROOM _____

APPLICATION

60 59 58
57

PERCOLATION TESTING

A 5189640

P _____

HOWARD COUNTY HEALTH DEPARTMENT
BUREAU OF ENVIRONMENTAL HEALTH
3525-H ELLICOTT MILLS DRIVE/ELLICOTT CITY, MARYLAND 21043
TELEPHONE: 313-2640

DISTRICT 4TH

DATE 5/13/03
5/22/03

TO: THE COUNTY HEALTH OFFICER
ELLICOTT CITY, MARYLAND

I HEREBY APPLY FOR THE NECESSARY TEST PRIOR TO APPLICATION FOR PERMIT TO CONSTRUCT (OR RECONSTRUCT) A SEWAGE DISPOSAL SYSTEM.

PROPERTY OWNER EDGEWOOD FARM, INC.

ADDRESS 14919 ROXBURY RD GLENELG MD 21737 PHONE _____

AGENT OR PROSPECTIVE BUYER TOLL BROTHERS, INC.

7164 COLUMBIA GATEWAY DR SUITE 230
ADDRESS COLUMBIA, MD 21046 PHONE (410) 872-9105

PROPERTY LOCATION:

SUBDIVISION EDGEWOOD FARM LOT NO. 1518

ROAD AND DESCRIPTION ROXBURY RD

TAX MAP 21 PARCEL # 20

SIZE OF LOT 1 Ac ± TYPE BLDG. SINGLE FAMILY
(SINGLE FAMILY DWELLING OR COMMERCIAL)

THE SYSTEM INSTALLED UNDER THIS APPLICATION IS ACCEPTABLE ONLY UNTIL PUBLIC FACILITIES BECOME AVAILABLE. I FULLY UNDERSTAND THE

FEE CONNECTED WITH THE FILING OF THIS PERC TEST APPLICATION IS NON-REFUNDABLE UNDER ANY CIRCUMSTANCES. I ALSO AGREE TO

COMPLY WITH ALL M.O.S.H.A. REQUIREMENTS IN TESTING THIS LOT.

Bruce R. Oyley
BRUCE R. OYLEY (SIGNATURE OF APPLICANT)

APPROVED BY _____ FOR _____ DATE _____

DISAPPROVED BY _____ FOR _____ DATE _____

OLD PENDING FURTHER TESTS _____

REASONS FOR REJECTION OR HOLDING _____

PERCOLATION TEST PLAT/PRELIMINARY PLAT - TITLE OR I.D. # _____ DATE _____

FINAL DEVELOPMENT PLAN/FINAL PLAT - TITLE OR I.D. # _____ DATE _____

THIS IS NOT A PERMIT

307, 308, 309, 310, 311 LOT #65

COUNTY #

SOIL PROFILE
308

0"
Drk brn
hvy L-L
18"
str y brn
org brn
fine rd brn
grained
SL
3 1/2-4'
lt brn
Fine
Sand
w/ some
small
pockets
of silt
13'
Rock ~ 5%
Bottom

310
Brown
Red
Brown
loam
1'
Red Brown
Si Clay
loam
1/2'
Yellow
Brown
Red
(loam)
Silt loam
15-20
Cobbly
Gravel
2'

309
Brown
Red Brown
loam
1/2'
Si Clay
loam
2'
Yellow
Brown
Red
(loam)
Silt loam
15%
Cobbly
Quartz
14'

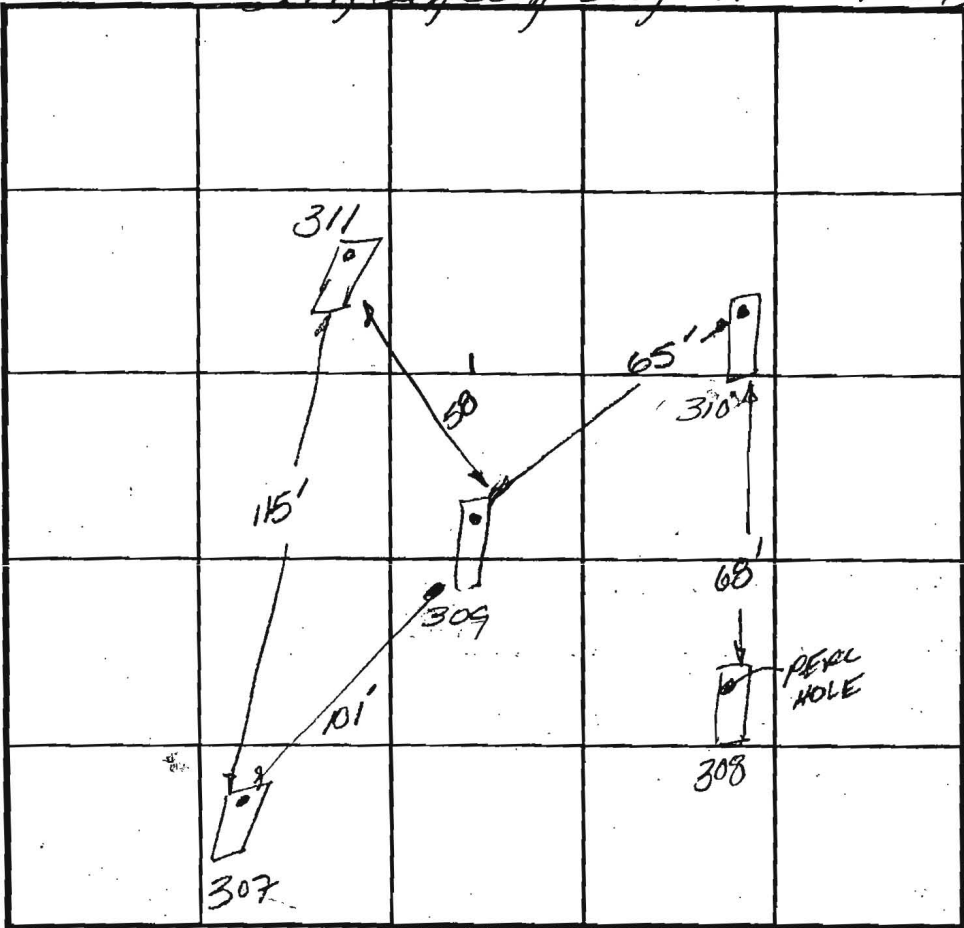

INDICATE NORTH - NAME ADJOINING ROADWAY AS BASE LINE.

SOIL PROFILE
307

0"
Brown
Heavy
loam
2'
Yellow
Brown
Si Clay
loam
4'
Chestnut
Clay loam
6'
Red
Yellow
loam
Silt loam
Silt loam
12 1/2'

311
Red Brown
Clay loam
2'
Yellow
Silt loam
Dotted
pebbles
4-6'
Yellow
loam
Sand
15% Rock
13'

DATE	TEST NO.	DEPTH	PRE-WET		TEST - 1" DROP		TIME
			START	STOP	START	STOP	
11/3/03	308	5 1/2 / 13 1/2	9 28	9 31	9 31	9 34	3 min
	310	5 1/2 / 13'	9 32	9 35	9 35	9 38	3 min
	309	6 1/2 / 14'	9 43	9 45	9 45	9 49	4 min
	307	7' / 12 1/2	9 56	10 02	10 02	10 09	7 min
	311	8' / 13'	10 10	10 14	10 14	10 20	6 min

REMARKS _____
 TYPE OF SOIL _____
 TESTED BY KC/FA ALSO PRESENT Willie
Bob Sheskey
Mark Johnson
Chloe Johnson
 TRENCH DESIGN DATA: AVERAGE PERCOLATION TIME _____ TRENCH WIDTH _____
 INLET DEPTH _____ MAXIMUM BOTTOM DEPTH _____ SQ. FT./BEDROOM _____

ADDITIONAL HOLES TESTED FOR LOT 19, 23

A/P
 223A
 Brown/Red
 Brown Loam 2'
 Red Brown
 Silky Loam 2 1/2'
 Red
 Yellow Silom
 Silom
 L590
 Rock
 HARD
 BOTTOM 12'

221A
 Red
 Brown Loam 2 1/2'
 Yellow
 Brown Silom
 L590
 Rock
 HARD
 BOTTOM 12'

BIA
 Brown
 Loam 18"
 Red
 Brown
 Silky Loam 4 1/2'
 Red
 Silom
 Light
 Brown
 Silom
 L590
 Rock
 HARD
 BOTTOM 11'

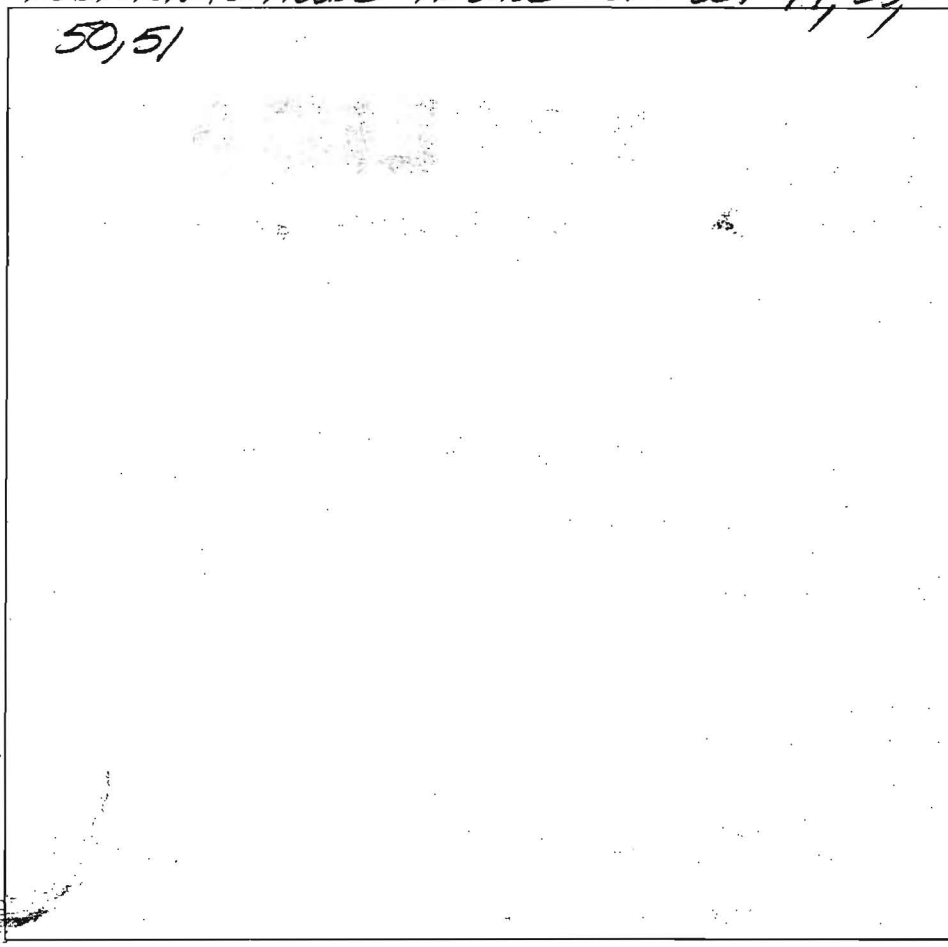

63A
 Brown
 Loam 1'
 Red
 Brown
 Gravelly
 Silky
 Loam 4'
 Red
 Silom 5 1/2'
 Yellow
 Silom
 L590
 Rock
 HARD
 BOTTOM 1 1/2'

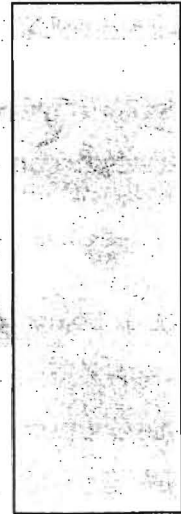

DATE	TEST #	DEPTH	START	BREAK 1" DROP	STOP 2" DROP	TIME OF 2nd INCH	P/F/H
3/12/04	223A	5' / 12'	10 ⁰³	10 ⁰⁸	10 ¹³	5min	P
	221A	5' / 12'	10 ¹⁶	10 ¹⁹	10 ²⁵	6min	P
3/12/04	BIA	5 1/2' / 11'	10 ⁴²	10 ⁴⁶	10 ⁵⁴	6min	P
	63A	6 1/2' / 11 1/2'	11 ⁰⁴	11 ⁰⁷	11 ¹⁰	3min	P

REMARKS _____

SANITARIAN FR BACKHOE Willie Encarter OTHERS Mark Johnson
Bob Strinsky

TEST HOLES USED IN SDA _____ AVG. PERC TIME _____ SQ. FT/BR _____

TRENCH WIDTH _____ INLET DEPTH _____ MAX. BOT DEPTH _____ EFFECTIVE S/W _____

